

# RETAIL SPACE FOR LEASE

160 CENTENNIAL PARKWAY NORTH,  
STONE CREEK, ONTARIO



## Len Goudy

Broker of Record  
Goudy Real Estate Corp.  
Real Estate Brokerage  
(416) 830-0880

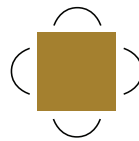

**Goudy Real Estate Corp.**  
Real Estate Brokerage  
Commercial Real Estate  
Sales & Leasing

14 Bigwood Court, Toronto, ON M1H 1Z9 | (905) 477-3000

The information contained herein has been provided to Goudy Real Estate Corp. by others. We do not warrant its accuracy. You are advised to independently verify the information prior to submitting an Offer and to provide for sufficient due diligence in an offer. The information contained herein may change from time to time without notice. The property may be withdrawn from the market at any time without notice.

# AREA & UNIT DETAILS

## 160 CENTENNIAL PARKWAY NORTH



Position your business at the high-visibility corner of Centennial Pkwy N & Violet Dr. This plaza is strategically located in a high-growth corridor, directly benefiting from the Eastgate Square redevelopment and the future Hamilton LRT terminus.

### LOCATION HIGHLIGHTS:

- **High-Traffic Corner:** 24,000+ vehicles daily at Centennial & Violet Dr.
- **Massive Growth:** Adjacent to proposed Eastgate Square & Parkway Plaza redevelopments (5,300+ total units planned).
- **Transit-Linked:** 1.2 km to QEW; Confederation GO Station close by.
- **Future LRT:** Steps from the planned Hamilton LRT Eastern Terminus.

### AVAILABLE UNITS:

- **Unit 1:** 1,164 SF
- **Unit 7:** 1,836 SF



# FLOOR PLAN UNIT 7 160 CENTENNIAL PARKWAY NORTH

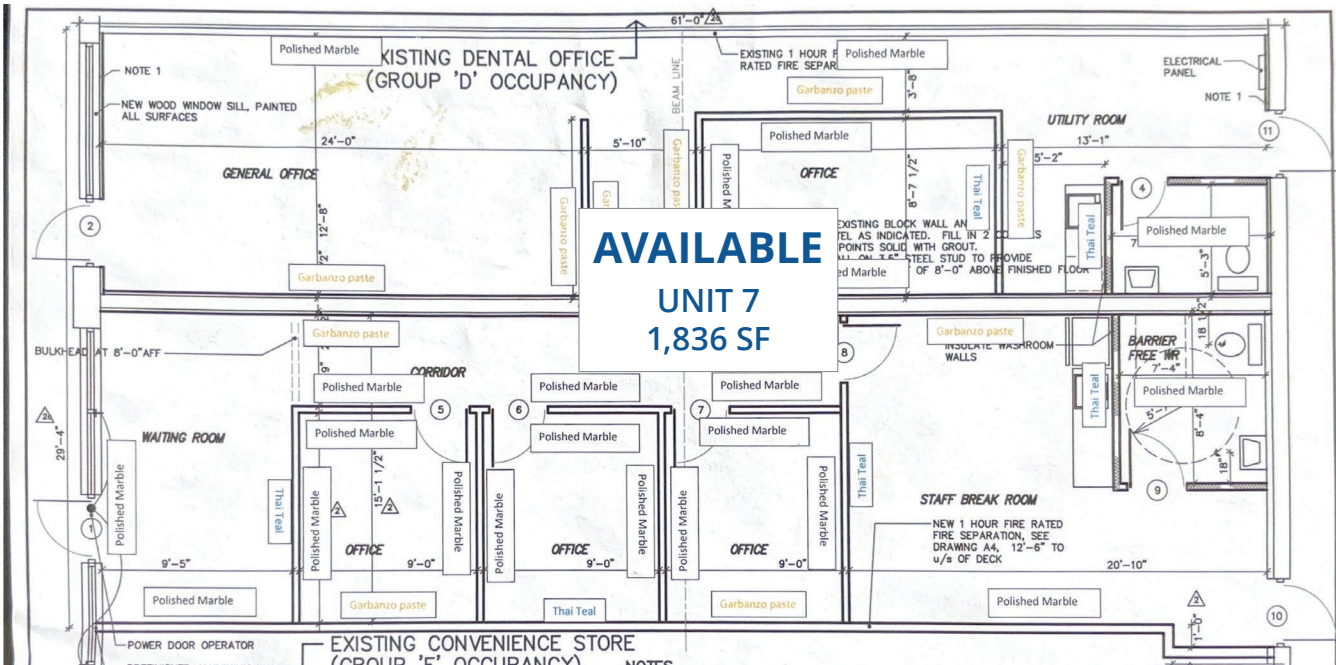

## AVAILABLE UNIT DETAILS:

|               |                    |
|---------------|--------------------|
| <b>UNIT 7</b> | 1,836 Sq. Ft.      |
| <b>RENT</b>   | \$35.00 PSF PA NET |
| <b>TMI</b>    | \$16.04 PSF PA     |

# TRADE AREA MAP

## 160 CENTENNIAL PARKWAY NORTH

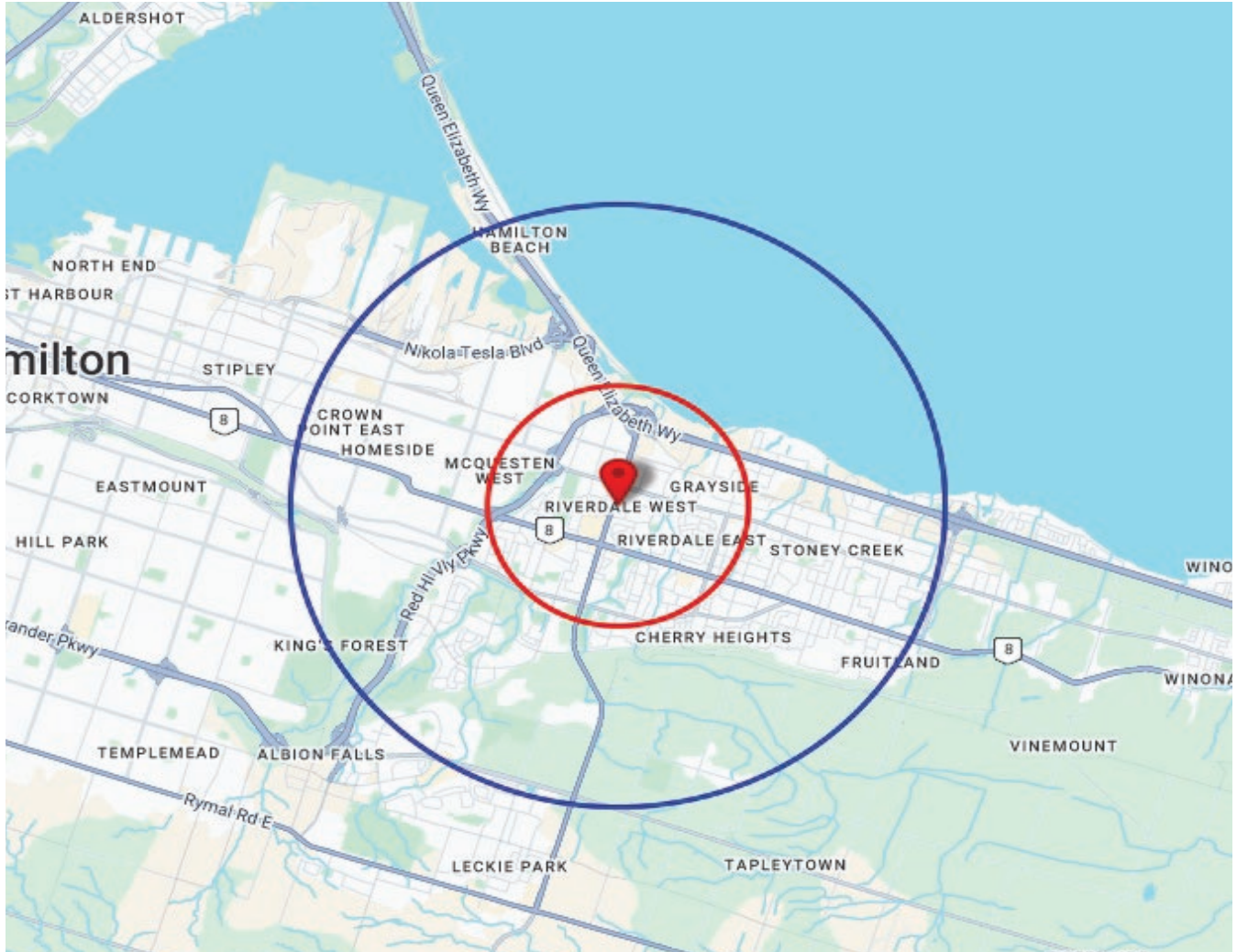

| 2025 Daytime Population           | 160 Centennial Pkwy N,<br>Hamilton, ON L8E 1H9<br>0 - 2 km |       | 160 Centennial Pkwy N,<br>Hamilton, ON L8E 1H9<br>0 - 5 km |       |
|-----------------------------------|--|-------|--|-------|
|                                   |  | %     |  | %     |
| <b>Total Estimated Population</b> | <b>31,915</b>  |       | <b>129,665</b>   |       |
| <b>Total Daytime Population</b>   | <b>36,490</b>  |       | <b>127,001</b>   |       |
| Daytime Population at Home        | 17,922   | 49.1% | 66,671   | 52.5% |
| 0 to 14 years                     | 4,702  | 12.9% | 19,660   | 15.5% |
| 15 to 64 years                    | 6,499  | 17.8% | 24,636   | 19.4% |
| 65 years and over                 | 6,721  | 18.4% | 22,374   | 17.6% |
| Daytime Population at Work        | 18,923   | 51.9% | 60,650   | 47.8% |
| Work At Usual Place               | 14,239   | 39.0% | 43,261   | 34.1% |
| Work Mobile                       | 2,726  | 7.5%  | 7,849  | 6.2%  |
| Work At Home                      | 1,958  | 5.4%  | 9,541  | 7.5%  |

# DEMOGRAPHICS SNAPSHOT

## 160 CENTENNIAL PARKWAY NORTH

| 2025 Demographic Snapshot                      | 160 Centennial Pkwy N,<br>Hamilton, ON L8E 1H9<br>0 - 2 km |       | 160 Centennial Pkwy N,<br>Hamilton, ON L8E 1H9<br>0 - 5 km |       |
|--|--|-------|--|-------|
|  |  | %     |  | %     |
| <b>Total Population</b>                        |  |       |  |       |
| 2020 estimated                                 | 30,572   |       | 121,766  |       |
| 2025 estimated                                 | 31,915   |       | 129,665  |       |
| 2030 Projected                                 | 33,429   |       | 135,495  |       |
| % Pop. Change (2020-2025)                      | 4.4%   |       | 6.5%   |       |
| % Pop. Change (2025-2030)                      | 4.7%   |       | 4.5%   |       |
| <b>2025 Total Population by Age</b>            | <b>31,915</b>  |       | <b>129,665</b>   |       |
| 0 to 4 years                                   | 1,544  | 4.8%  | 6,623  | 5.1%  |
| 5 to 19 years                                  | 4,722  | 14.8% | 19,415   | 15.0% |
| 20 to 24 years                                 | 1,805  | 5.7%  | 7,234  | 5.6%  |
| 25 to 34 years                                 | 4,526  | 14.2% | 19,992   | 15.4% |
| 35 to 44 years                                 | 4,188  | 13.1% | 19,355   | 14.9% |
| 45 to 54 years                                 | 3,454  | 10.8% | 14,457   | 11.1% |
| 55 to 64 years                                 | 4,091  | 12.8% | 16,677   | 12.9% |
| 65 to 74 years                                 | 3,824  | 12.0% | 14,190   | 10.9% |
| 75 years & over                                | 3,761  | 12%   | 11,720   | 9%    |
| <b>Median Age</b>                              | 42.9   |       | 40.6   |       |
| <b>2025 Total Census Families</b>              | <b>7,809</b>   |       | <b>33,773</b>  |       |
| Average Persons Per Family                     | 3.0  |       | 3.0  |       |
| Total Couples                                  | 5,804  | 74.3% | 26,122   | 77.3% |
| Without children at home                       | 2,770  | 35.5% | 12,145   | 36.0% |
| With children at home                          | 3,034  | 38.9% | 13,978   | 41.4% |
| Lone-parent families                           | 2,005  | 25.7% | 7,651  | 22.7% |
| Children Per Census Family                     | 1.2  |       | 1.1  |       |
| <b>2025 Educational Attainment (15 years+)</b> | <b>26,788</b>  |       | <b>109,326</b>   |       |
| Less than a bachelor degree                    | 22,690   | 84.7% | 88,405   | 80.9% |
| Bachelor degree & higher                       | 4,098  | 15.3% | 20,921   | 19.1% |
| <b>2025 Households</b>                         | <b>13,283</b>  |       | <b>51,466</b>  |       |
| Persons per household                          | 2.37   |       | 2.51   |       |
| Average household income                       | \$ 89,890  |       | \$ 110,189   |       |
| <b>2025 Occupied Dwellings</b>                 | <b>13,283</b>  |       | <b>51,466</b>  |       |
| Owned dwellings                                | 5,730  | 43.1% | 33,186   | 64.5% |
| Rented dwellings                               | 7,554  | 56.9% | 18,279   | 35.5% |

# DEMOGRAPHICS

## 160 CENTENNIAL PARKWAY NORTH

| 2025 Estimates<br>Visible Minority                          | 160 Centennial Pkwy N,<br>Hamilton, ON L8E 1H9<br>0 - 2 km |              | 160 Centennial Pkwy N,<br>Hamilton, ON L8E 1H9<br>0 - 5 km |              |
|---|--|--------------|--|--------------|
|   |  | %            |  | %            |
| <b>2025 Household Population by visible minority groups</b> | <b>31,460</b>  | <b>%base</b> | <b>128,986</b>   | <b>%base</b> |
| Total visible minority population                           | 9,555  | 30.4%        | 31,124   | 24.1%        |
| Chinese   | 192  | 0.6%         | 715  | 0.6%         |
| South Asian   | 3,521  | 11.2%        | 10,331   | 8.0%         |
| Black   | 1,602  | 5.1%         | 6,311  | 4.9%         |
| Filipino  | 435  | 1.4%         | 2,396  | 1.9%         |
| Latin American  | 658  | 2.1%         | 2,952  | 2.3%         |
| Southeast Asian   | 1,177  | 3.7%         | 2,521  | 2.0%         |
| Arab  | 1,351  | 4.3%         | 3,014  | 2.3%         |
| West Asian  | 249  | 0.8%         | 906  | 0.7%         |
| Korean  | 11   | 0.0%         | 225  | 0.2%         |
| Japanese  | 19   | 0.1%         | 104  | 0.1%         |
| Visible minority, n.i.e.                                    | 123  | 0.4%         | 613  | 0.5%         |
| Multiple visible minorities                                 | 219  | 0.7%         | 1,035  | 0.8%         |
| Not a visible minority                                      | 21,904   | 69.6%        | 97,862   | 75.9%        |

| 2028 Projections<br>Visible Minority                        | 160 Centennial Pkwy N,<br>Hamilton, ON L8E 1H9<br>0 - 2 km |              | 160 Centennial Pkwy N,<br>Hamilton, ON L8E 1H9<br>0 - 5 km |              |
|---|--|--------------|--|--------------|
|   |  | %            |  | %            |
| <b>2028 Household Population by visible minority groups</b> | <b>32,244</b>  | <b>%base</b> | <b>132,008</b>   | <b>%base</b> |
| Total visible minority population                           | 10,267   | 31.8%        | 33,709   | 25.5%        |
| Chinese   | 203  | 0.6%         | 763  | 0.6%         |
| South Asian   | 3,791  | 11.8%        | 11,310   | 8.6%         |
| Black   | 1,715  | 5.3%         | 6,689  | 5.1%         |
| Filipino  | 468  | 1.5%         | 2,599  | 2.0%         |
| Latin American  | 710  | 2.2%         | 3,224  | 2.4%         |
| Southeast Asian   | 1,240  | 3.8%         | 2,676  | 2.0%         |
| Arab  | 1,467  | 4.6%         | 3,336  | 2.5%         |
| West Asian  | 282  | 0.9%         | 1,046  | 0.8%         |
| Korean  | 13   | 0.0%         | 233  | 0.2%         |
| Japanese  | 20   | 0.1%         | 109  | 0.1%         |
| Visible minority, n.i.e.                                    | 128  | 0.4%         | 635  | 0.5%         |
| Multiple visible minorities                                 | 229  | 0.7%         | 1,090  | 0.8%         |
| Not a visible minority                                      | 21,978   | 68.2%        | 98,299   | 74.5%        |