

795 H STREET CHULA VISTA CA

Click here to take
flight and see what
GATEWAY AT THE BAY
has to offer!



FOR LEASE

197,257 SF MANUFACTURING | WAREHOUSE | R&D – AVAILABLE NOW



Future Gaylord Hotel / Convention Center at Chula Vista Bayfront

Future Development at The Bay

Point Loma

Collins Aerospace Site/Campus

Na

795 H Street



H Street

H Street Trolley Station



Downtown San Diego

Navy Shipyards

THE HIGHLIGHTS

Square Footage

197,257 SF available now

Largest manufacturing/warehouse space near Downtown San Diego

Prime Location

Just off I-5 with freeway visibility

Excellent access via H St and E St

Only 10 minutes from Naval shipyards, 15 minutes from Downtown San Diego & San Diego Airport

Excellent freeway access via I-5, I-805, I-15, SR 54, and Hwy 94

Renovations

Major building renovations/upgrades planned

Renovated building will feature 22' clear height, 7 grade level doors, 10 loading docks, 4,000 Amps, 3-Phase Power and ESFR sprinklers

Historical Site

Former Rohr site. Located in Chula Vista. For the first time in its history, it's on the market for lease

Scalability Options

Adjacent redevelopment coming, delivering up to 500,000 SF in the next 3 years

Amenities

Close proximity to the Gaylord Pacific Hotel and The Bay. \$1 Billion + development featuring restaurants, hotels, convention and meeting space

Rental Rate

Contact Broker

THE SITEPLAN



[Click here to take a Virtual Tour](#)

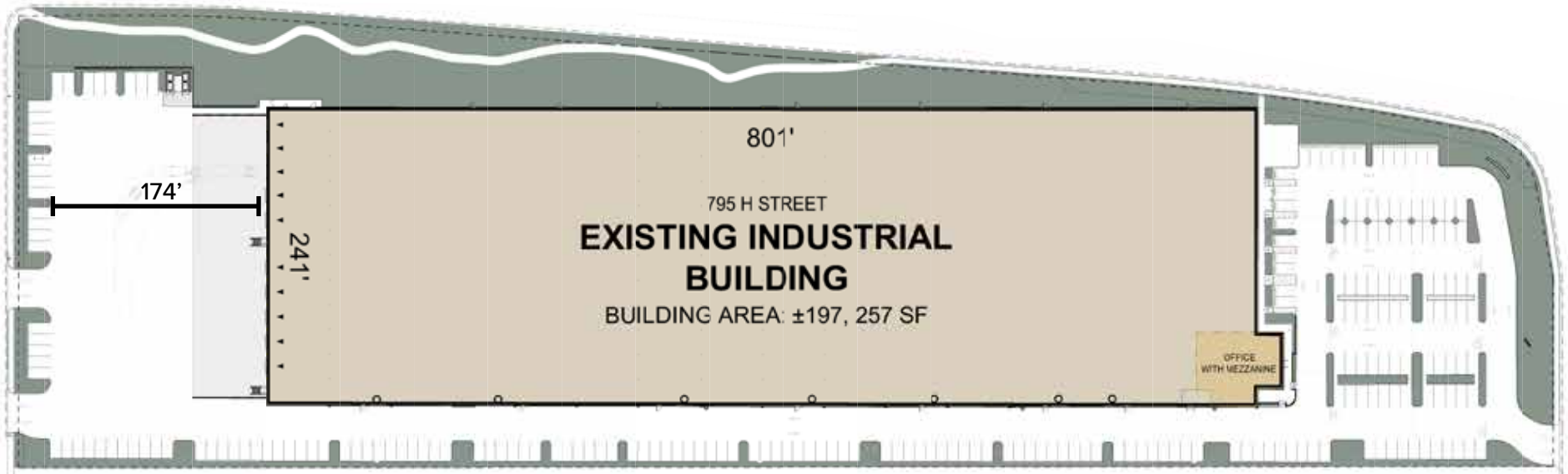

- ▲ Dock-High Doors (10)
- Grade-Level Doors (7)

Ground Floor Office	3,778 SF
2nd Story Office/Mezzanine	3,069 SF
Total Office SF	6,847 SF

IT'S ABOUT THE **LOCATION**

Drive Times



Naval Shipyards

10 minutes

Downtown San Diego

15 minutes

San Diego Airport

15 Minutes

US/Mexico Border

18 minutes

UTC/UCSD

25 minutes



EXTERIOR **PHOTOS**



INTERIOR **PHOTOS**

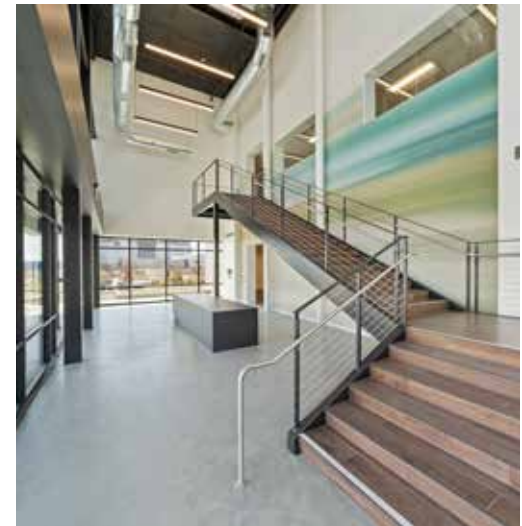

BEFORE & AFTER **PHOTOS**



SW CORNER FACADE - BEFORE



SW CORNER FACADE - AFTER



W ELEVATION - BEFORE



W ELEVATION - AFTER

BEFORE & AFTER **PHOTOS**



W ROLLUP DOOR - BEFORE



W ROLLUP DOOR - AFTER



S INTERIOR WAREHOUSE - BEFORE



S INTERIOR WAREHOUSE - AFTER

CHULA VISTA BAYFRONT GAYLORD PACIFIC HOTEL

The Gaylord Pacific Resort Hotel and Convention Center will be a new destination resort located on prime bayfront property in Chula Vista, CA.

To be built by RIDA Chula Vista, LLC in collaboration with the Port and City of Chula Vista, the Gaylord Pacific Resort and Convention Center will be the centerpiece and the catalyst project of the Chula Vista Bayfront. It will include up to 1,600 hotel rooms, a convention center with four ballrooms, three levels of meeting space and two outdoor meeting and event lawns; public promenades and public amenities; and associated retail and resort-level amenities such as a pool with a lazy river, a spa, and more.





Lounge



Pool with lazy river



The Gaylord Pacific Resort Hotel will be host to 1,600 rooms.



The hotel rises 22-stories with breathtaking views of the San Diego Bay and the Pacific Ocean beyond.



Restaurant

CHULA VISTA BAYFRONT REDEVELOPMENT

A partnership between the Port of San Diego and City of Chula Vista, the Chula Vista Bayfront redevelopment envisions a world-class destination in the South Bay – a unique place for people to live, work and play. It is designed to create new public parks and recreational adventures, improve the natural habitat, offer new dining and shopping options, provide a world-class hotel and convention center, and more – all for residents and coastal visitors to enjoy.

Additional Bayfront projects include:

- Sweetwater Park
- Harbor park
- Sun Outdoors San Diego Bay RV Resort
- Sweetwater Bicycle Path & Promenade
- Pacifica





AN ICONIC LANDMARK

This historic site produced the fuel tanks on site for Charles Lindbergh's "Spirit of St. Louis", the famous first transatlantic flight from New York to Paris in 1927.

- Born in 1896—before the Wright Brothers made their first airplane flight—Fred Rohr grew up to become a leader in the aircraft industry. His company changed Chula Vista from a small farming community to one that employed thousands making airplane parts during and after World War II.
- Rohr designed a machine called a “drop hammer” which produced thinner and lighter metal for airplanes. The machine had a dramatic effect on the aircraft industry.





Operating around-the-clock, assembly lines at Rohr in the 1940s built airplane engine components. This assembly line was for the B-24 bomber.



Factory workers used Rohr's "drop hammer" machine to produce thinner and lighter metal for airplanes. The machine had a dramatic effect on the aircraft industry.



During World War II, thousands of women worked in factories building the planes, tanks and guns needed in the war effort. They became known as "Rosie the Riveter."



JOE ANDERSON

Sr. Managing Director
+1 858 410 6360
Joe.Anderson@jll.com
RE Lic # 01509782

JAY ALEXANDER

Managing Director
+1 858 410 1188
Jay.Alexander@jll.com
RE Lic # 01019910

GREG MOORE

Vice President
+1 858 410 6367
Greg.Moore@jll.com
RE Lic # 02068852



Although information has been obtained from sources deemed reliable, neither Owner nor JLL makes any guarantees, warranties or representations, express or implied, as to the completeness or accuracy as to the information contained herein. Any projections, opinions, assumptions or estimates used are for example only. There may be differences between projected and actual results, and those differences may be material. The Property may be withdrawn without notice. Neither Owner nor JLL accepts any liability for any loss or damage suffered by any party resulting from reliance on this information. If the recipient of this information has signed a confidentiality agreement regarding this matter, this information is subject to the terms of that agreement. ©2024. Jones Lang LaSalle IP, Inc. All rights reserved.