

### SUITE 1018

**7,124 rsf**

- + Market ready traditional suite
- + Fantastic views
- + 2 conference rooms
- + 2 private offices
- + 3 breakout rooms
- + 2 phone rooms
- + Kitchen/break room
- + Floor to ceiling window line

### SUITE 1004

**5,160 rsf**

- + Brand new creative spec suite
- + Partly plug-and-play opportunity
- + Exposed ceilings
- + Boardroom
- + 2 meeting rooms
- + 3 phone rooms
- + Kitchen
- + Floor-to-ceiling window line
- + Fantastic Market Street views

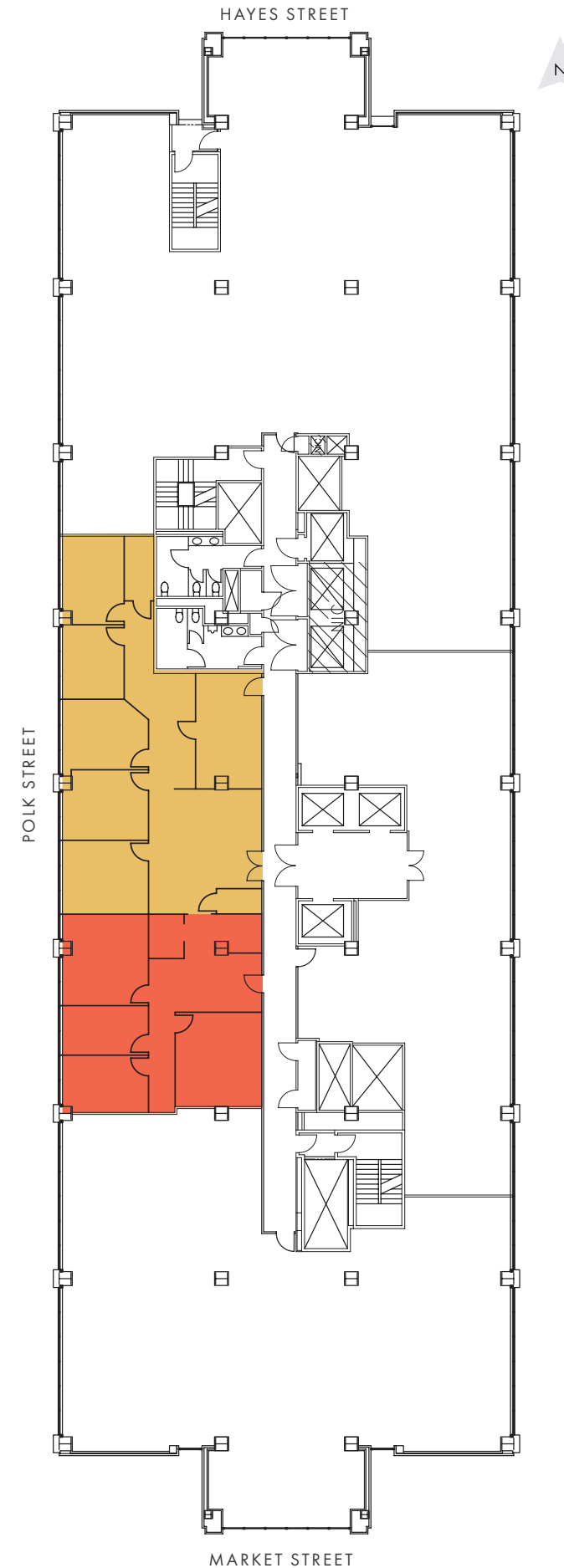

### SUITE 1008

**1,415 rsf**

- + Traditional suite
- + 2 private offices
- + 2 conference rooms
- + IT/storage

### SUITE 1010

**2,295 rsf**

- + Traditional suite
- + 5 private offices
- + Kitchen/break room
- + IT/storage
- + Double-door identity right off elevator