

# Valley View Farms Business Center

±9,400 SF AVAILABLE

13953 VALLEY VIEW AVENUE  
LA MIRADA, CA 90638



## BUILDING FEATURES

- ±9,400 SF Available
- ±1,376 SF Office Area
- 18' Clear Height
- 400 Amps, 277/480 Volt Power (verify)
- 1 Dock High Door & 1 Grade Level Door
- Fire Sprinklers
- Close Proximity to the 5 and 91 Freeways
- Centrally Located Between LA and OC
- Excellent Distribution Space
- High Image Business Park
- Fully Renovated and Available Now

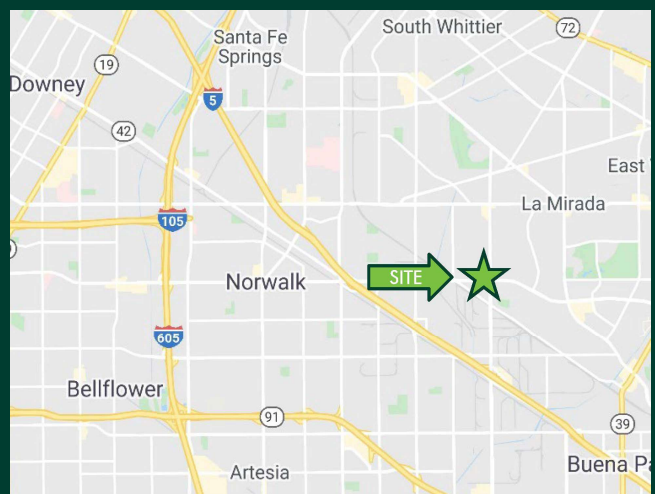

# Valley View Farms Business Center

For Lease

±9,400 SF AVAILABLE

13953 VALLEY VIEW AVENUE  
LA MIRADA, CA 90638



# Valley View Farms Business Center

For Lease

±9,400 SF AVAILABLE

13953 VALLEY VIEW AVENUE  
LA MIRADA, CA 90638

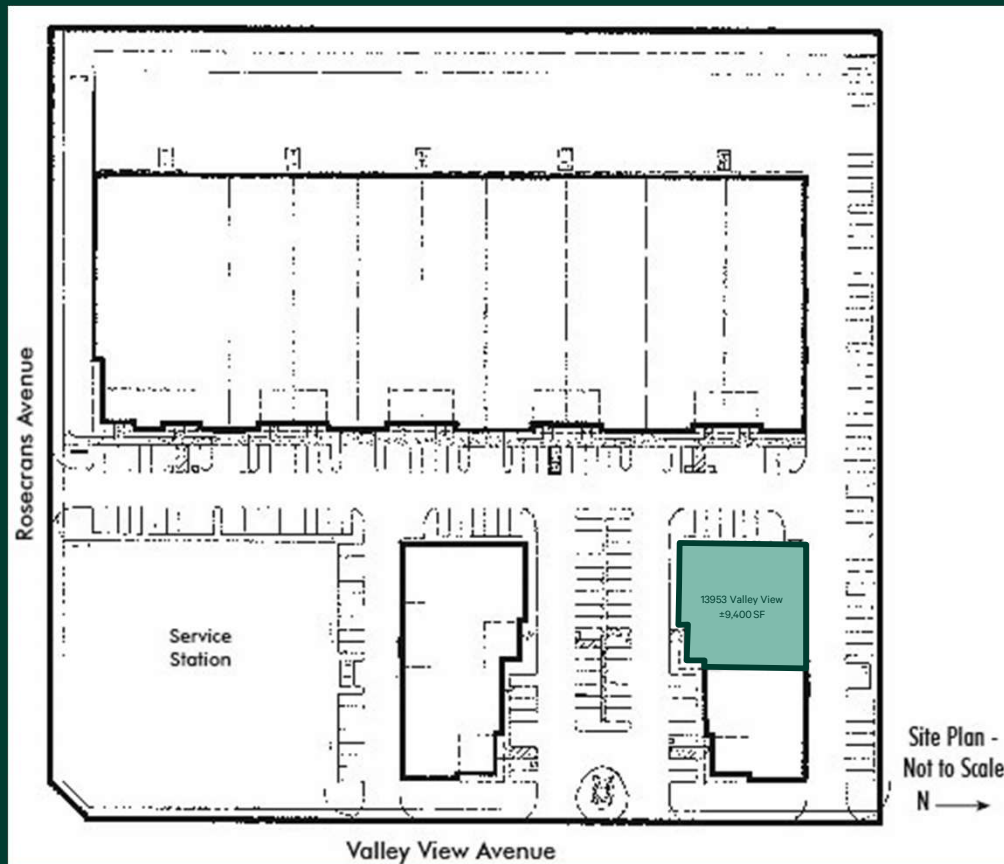

## CONTACT US

Laird A. Perkins  
Senior Vice President

Lic. 00966207

+1 310 363 4920

laird.perkins@cbre.com

Blake Wade  
Senior Associate

Lic. 02118407

+1 949 878 2933

blake.wade@cbre.com

© 2026 CBRE, Inc. All rights reserved. This information has been obtained from sources believed reliable, but has not been verified for accuracy or completeness. You should conduct a careful, independent investigation of the property and verify all information. Any reliance on this information is solely at your own risk. CBRE and the CBRE logo are service marks of CBRE, Inc. All other marks displayed on this document are the property of their respective owners, and the use of such logos does not imply any affiliation with or endorsement of CBRE. Photos herein are the property of their respective owners. Use of these images without the express written consent of the owner is prohibited.

**CBRE**