

# SUBLEASE OPPORTUNITY

6,722 RSF MIXED-USE OFFICE/LAB

12250 El Camino Real, Suite 140  
San Diego, CA 92130



**NEWMARK**

# PROPERTY OVERVIEW

12250 El Camino Real, Suite 140

Located in GENESIS-Del Mar, Suite 140 offers 6,722 SF of hyper efficient biology lab and office space. Ideally situated minutes from One Paseo and Del Mar Highlands Town Center, the campus provides immediate access to I-5 and SR-56, coastal amenities, and a wide range of dining and retail options.

On-site features include an open-air courtyard for collaboration, shared conference facilities, service elevator, backup generator, EV charging stations, and a 2.5/1,000 parking ratio, creating an efficient, connected environment that supports innovation and growth.

## Monthly Base Rate

\$4.10 NNN

## Sublease Term

Through December 31, 2028

## Available

August 1, 2026

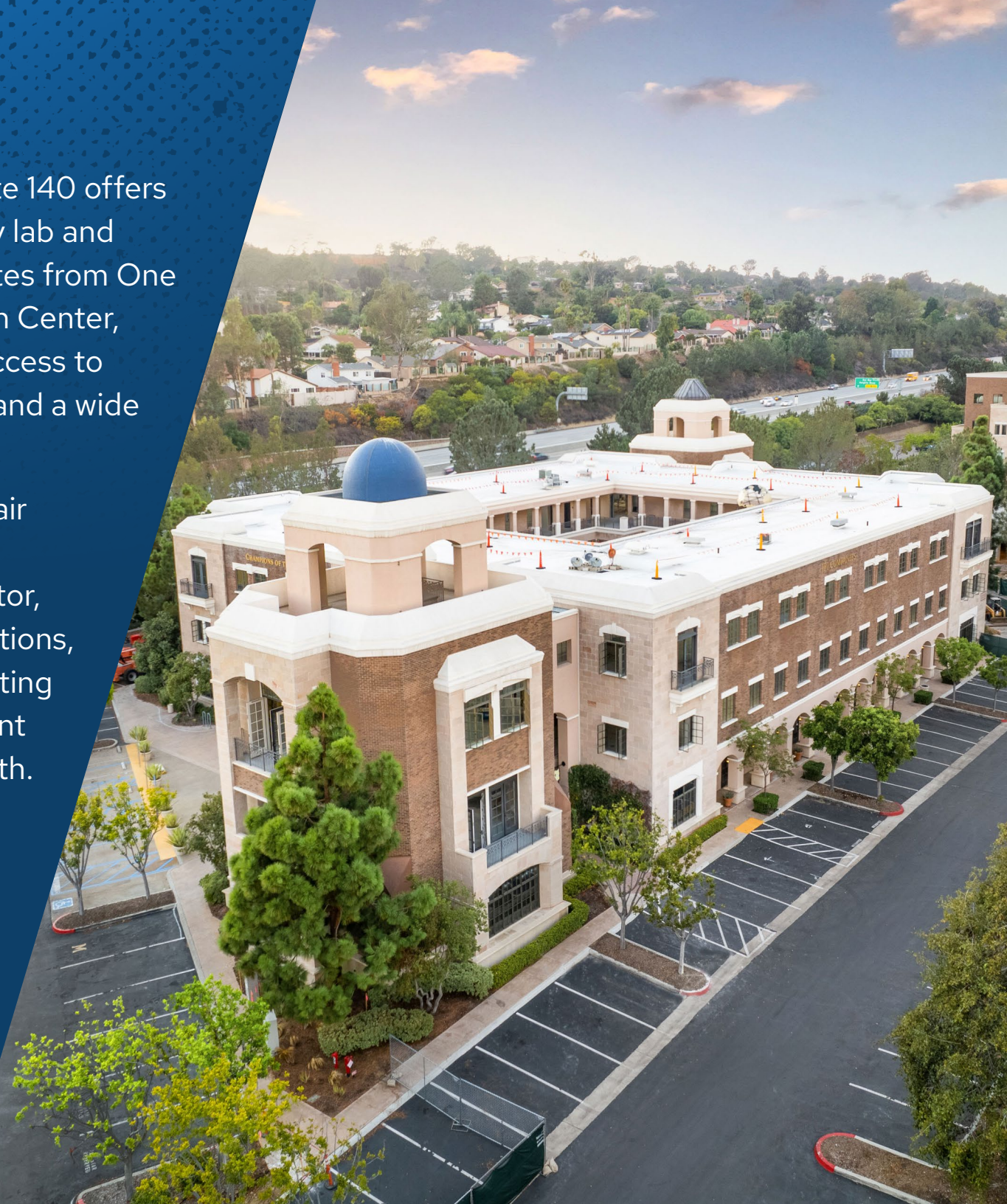



12250 El Camino Real

El Camino Real



**Project**  
Life Science and Office



**Convenient Access**  
I-5 and SR-56



**On-Site Amenities**  
EV Charging Stations, open courtyard with lounge furniture and free Wifi, and fully equipped shared conferencing



**Amenity Rich Location**  
Walking distance to Del Mar Highlands, One Paseo and Piazza Carmel



**Hospitals & Research Centers**  
Close to Sharp Rees-Stealy Carmel Valley, Scripps Clinic Del Mar and Kaiser Permanente Carmel Valley

# FLOOR PLAN

12250 El Camino Real, Suite 140

## Highlights

- ± 50/50 lab to office ratio
- Open office space, 2 private offices, 2 modular offices, and 1 conference room
- Existing FFE included
- On-site parking
- 2.5/1,000 SF parking ratio

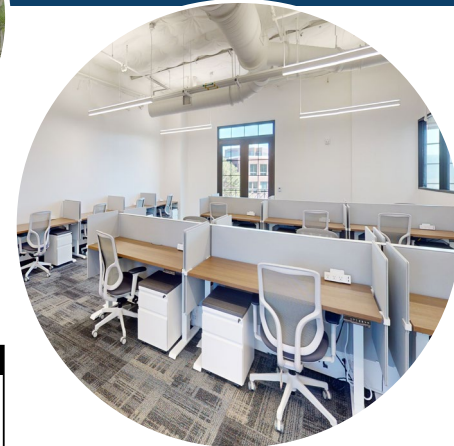

## Lab Infrastructure

- 4 Benches
- 24 Bench Seats
- 3 Lab Support Rooms
- 1 6ft Chemical Fume Hood
- 3 Lab Support Sink with 2 RO/DI Systems

## \*Office Infrastructure

- 20 Workstations
- 2 Private Offices
- 2 Modular Offices
- 1 Conference Room
- 1 Break Room

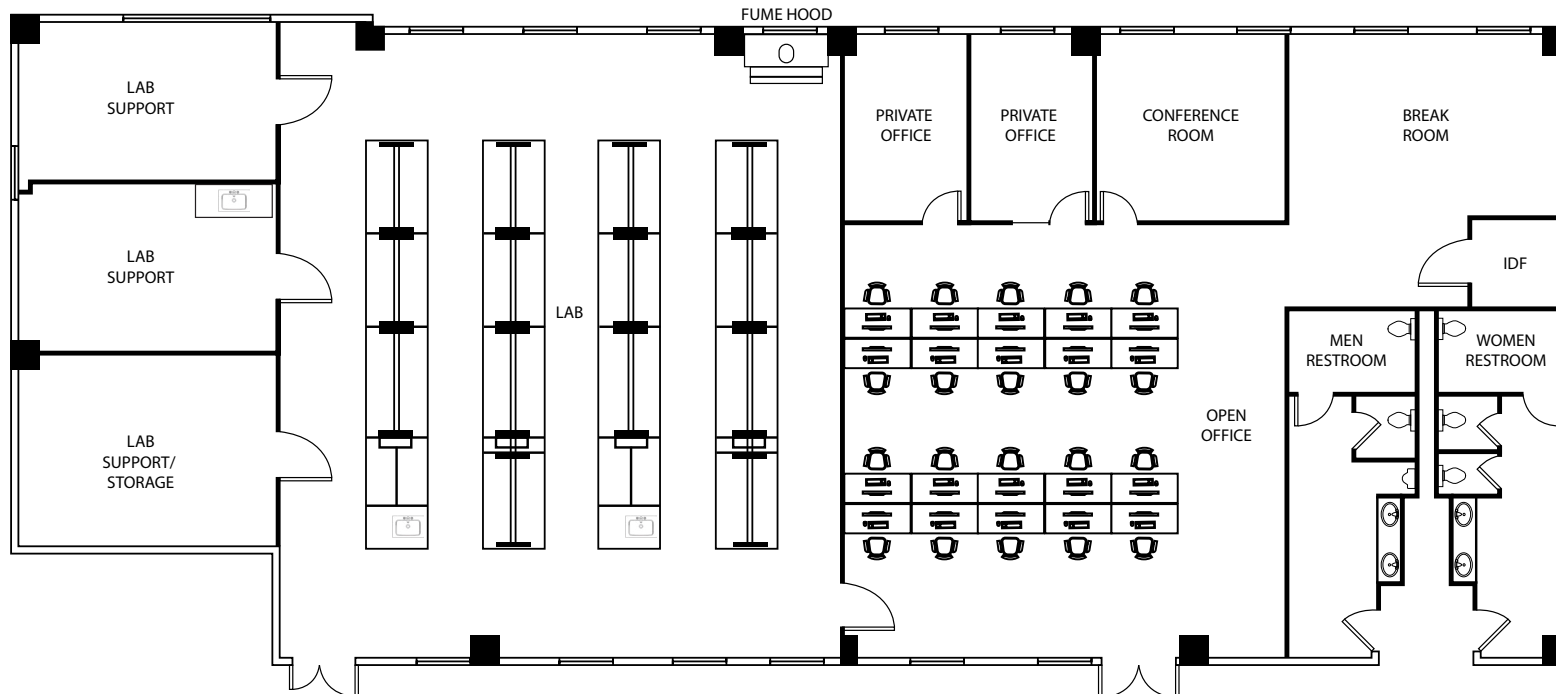

*\*Floor plan is hypothetical.  
Space includes two modular  
offices in the open office area.*



## CONTACT US:



JOHN C. HUNDLEY  
t 619-325-9110  
john.hundley@nmrk.com  
CA RE Lic. #01365206

JON ENGLE  
t 858-692-3503  
jon.ingle@nmrk.com  
CA RE Lic. #01904111



4655 Executive Dr, Suite 800  
San Diego, CA 92121  
t 858-875-3600  
Corporate License #01355491



[nmrk.com](http://nmrk.com)

# NEWMARK

Corporate License #01355491

The information contained herein has been obtained from sources deemed reliable but has not been verified and no guarantee, warranty or representation, either express or implied, is made with respect to such information. Terms of sale or lease and availability are subject to change or withdrawal without notice.

