

## INDUSTRIAL SPACE FOR LEASE

75 Westmore Dr # B,  
Toronto



### COMMENTS

Half of a freestanding building. Easy access to public transit and Hwys. 407 and 27. Located a few minutes north of Pearson airport. Professionally owned and managed complex. Great for warehousing or light manufacturing.

### DETAILS

**Total Size:** 36092 Sq. Ft.

**Office Area:** 722 Sq. Ft.

**Industrial Area:** 35370 Sq. Ft.

**Zoning:** E 2

**List Rate:** \$14.95

**TMI:** \$4.50 (2026)

**Clear Height:** 19'6"

**Loading:** - 1 Drive – In Door and 3 Truck Lever door

**Sprinklers:** Yes

**Heat:** Radiant

**Available:** Immediate

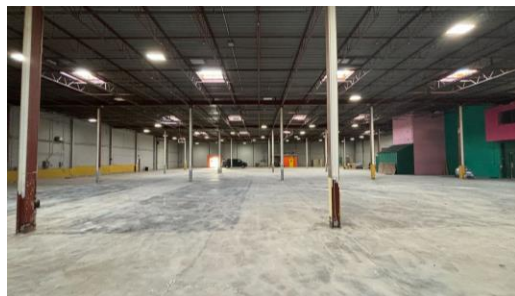
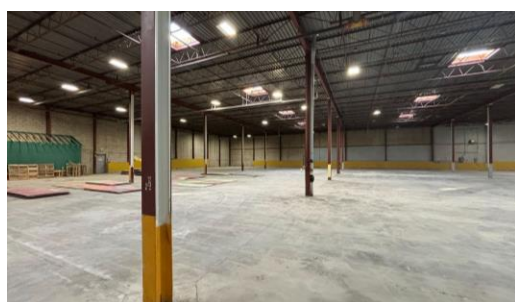

**Jason Gilbert**

Broker

Cell: (416) 419-2115

[jasongilbert@induspacerealty.com](mailto:jasongilbert@induspacerealty.com)

[www.induspacerealty.com](http://www.induspacerealty.com)



**John S. Gilbert**

Broker of Record/Owner

Cell: (416) 828-5547

[jgilbert@induspacerealty.com](mailto:jgilbert@induspacerealty.com)

5800 Ambler Drive, Suite 210, Mississauga, Ontario L4W 4J4 | T:(905) 277 4747

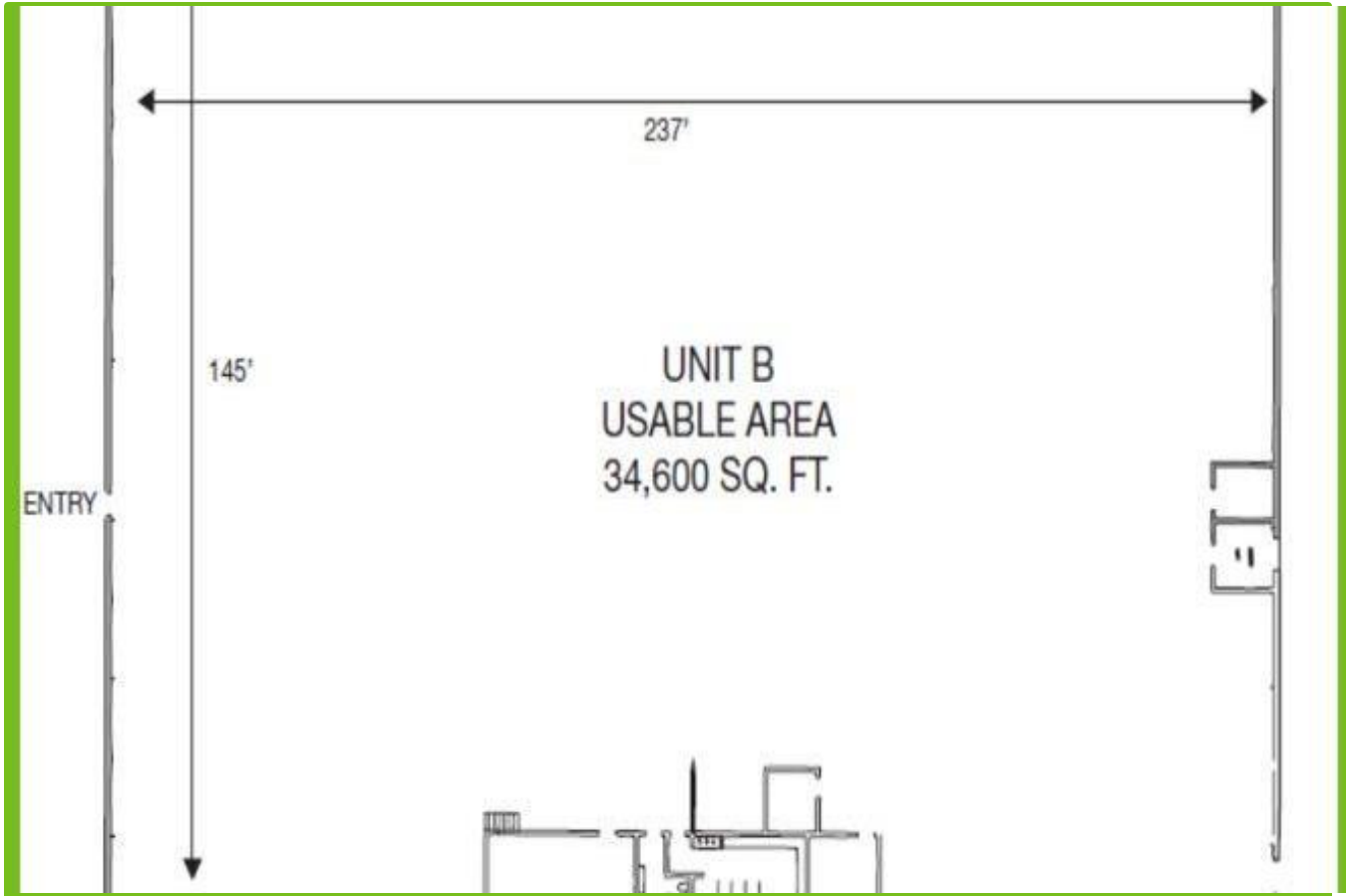

INDUSPACE REALTY INC., Brokerage