



FOR LEASE ±37,491 SF INDUSTRIAL BUILDING

**41995
ZEVO DRIVE
TEMECULA, CA 92590**



Located in Westside Business Center



Expandable Power







New Ownership and New Capital Improvements Underway



Can be expanded with adjacent unit to accommodate users up to 100-120ksf.

AVAILABILITY

FOR **±37,491 SF**
LEASE INDUSTRIAL BUILDING

	Available Suite	Suite B
	Available Square Feet	±37,491 SF
	Office Square Feet	±2,571 SF
	Clear Height	±24'-26'
	Loading	11 Dock High Doors 1 Grade Level
	Parking	2.03/1,000 SF
	Sprinklers	Yes

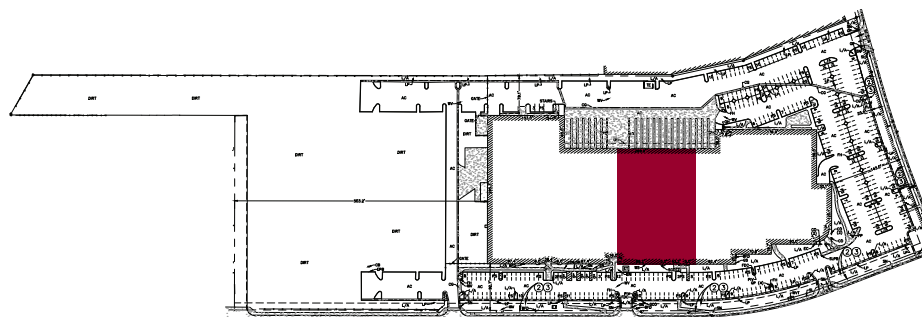

 = Available Space

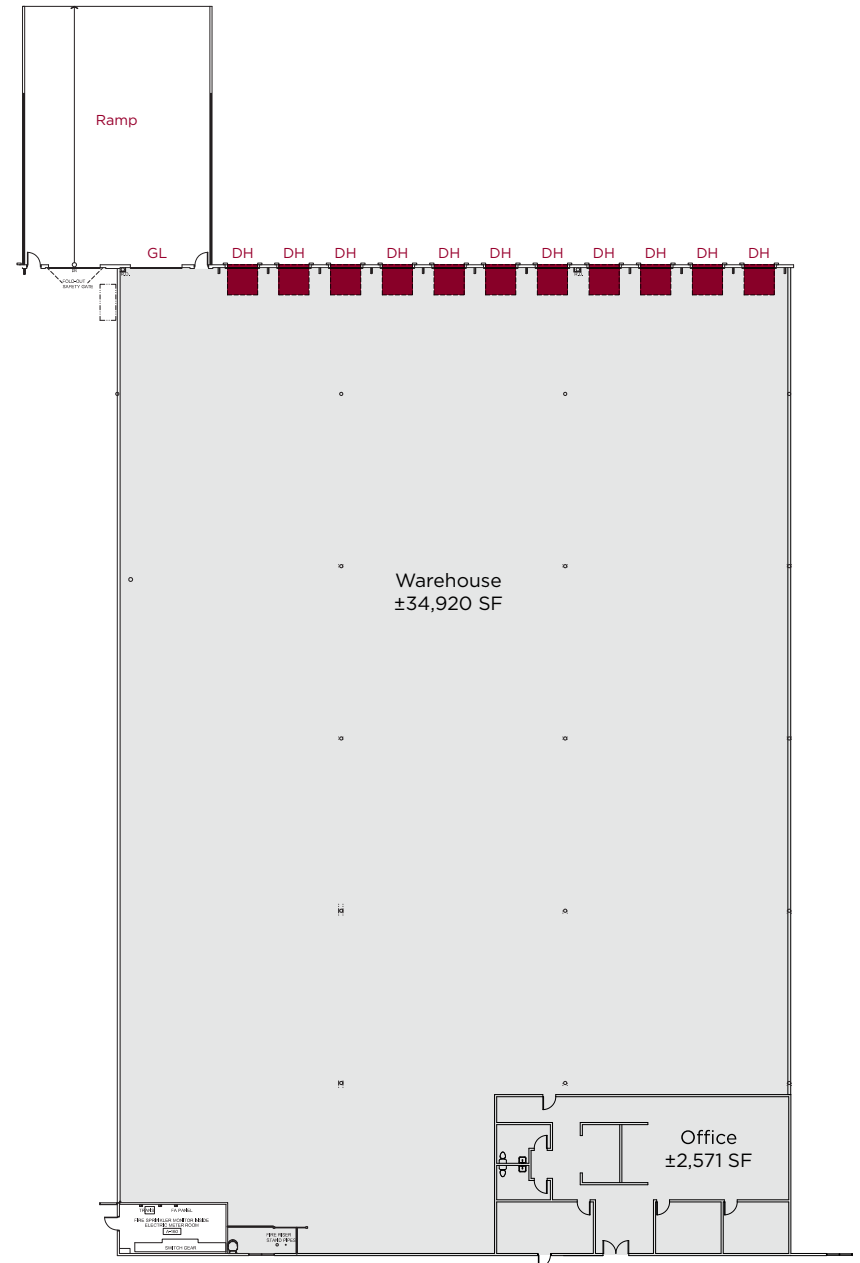

HIGHLIGHTS

FOR **±37,491 SF**
LEASE INDUSTRIAL BUILDING



Total Square Feet ±228,830 SF



Available Square Feet ±37,491 SF



Year Built 1998



Site Area ±15.11 Acres (±658,192 SF) including ±5.54 acres of excess land (±241,324 SF)



Zoning LI (Light Industrial)



Clear Height ±24'-26'



Loading 21 Dock High Doors / 4 Grade Level



Parking 2.03/1,000 SF (461 Auto Stalls)



Sprinklers Yes



Power 4,000a/277 - 480v Heavy



POTENTIAL 100,000-120,000 SF EXPANSION OPTION

FOR **±37,491 SF**
LEASE INDUSTRIAL BUILDING

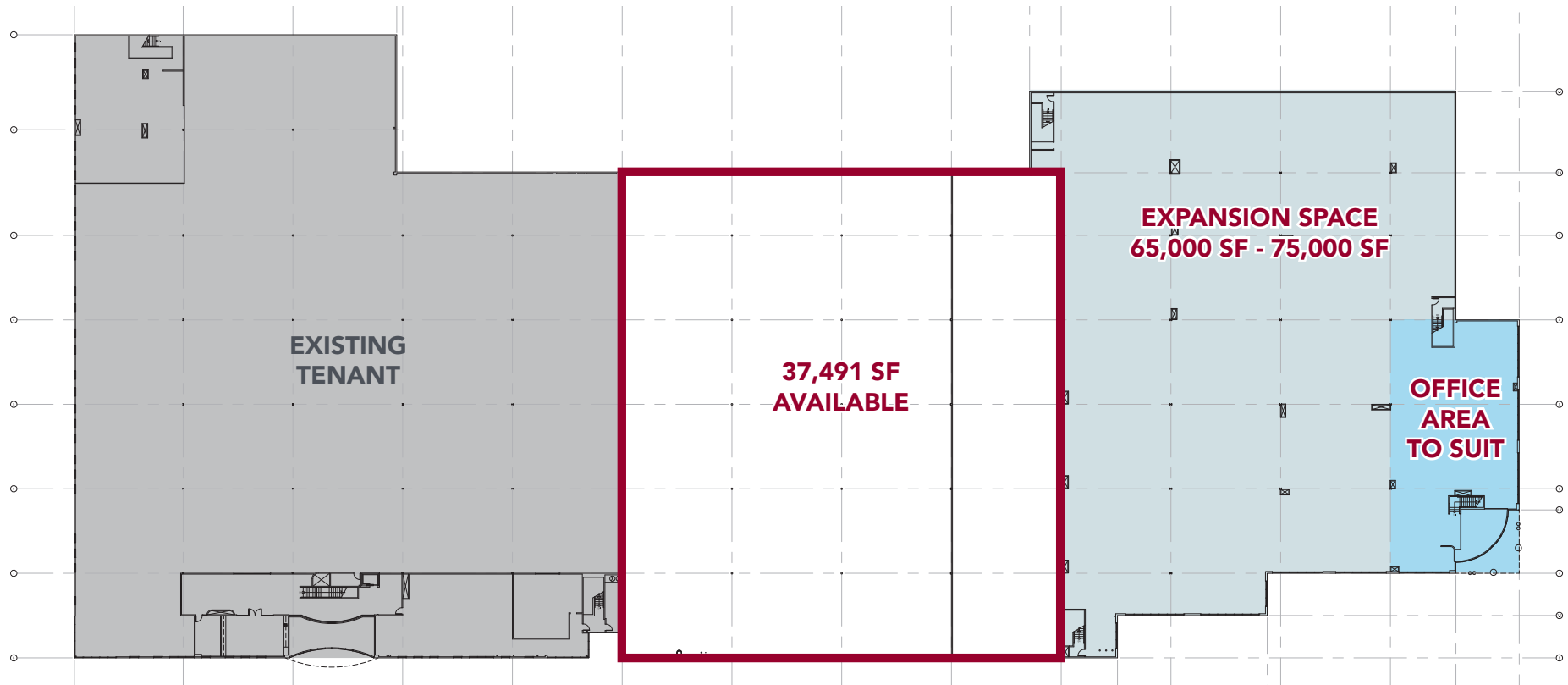

FEATURES:

- **Offices to Suit**
- **Clear Height:** 24'-26'
- **Loading:**
 - 1 grade-level door
 - 14 dock-high doors
- **Sprinkler:** ESFR ready
- **Power:** 4,000 amps (expandable)
- **Yard:** Fenced & paved yard available
- **Lighting:** T-5 with 2% skylights
- **Parking Ratio:** 2.0 per 1,000 SF
- **Zoning:** Light Industrial
- **Extensive Glassline Views**



PHOTOS

FOR **±37,491 SF**
LEASE INDUSTRIAL BUILDING



LOCATION

FOR LEASE **±37,491 SF**
INDUSTRIAL BUILDING



FOR LEASE ±37,491 SF INDUSTRIAL BUILDING

41995 ZEVO DRIVE
TEMECULA, CA 92590



CONTACT AGENT FOR MORE INFORMATION

SCOTT STEWART

951.445.4514

sstewart@leetemecula.com

DRE#: 01342575



25240 Hancock Ave, Suite 100 - Murrieta, CA | 951.445.4500
Corporate DRE#: 01048055 | www.lee-associates.com

No warranty or representation has been made to the accuracy of the foregoing information.
Terms of sale or lease and availability are subject to change or withdrawal without notice.
Lee & Associates Commercial Real Estate Services, Inc. -Riverside.

