



±2,508 SF of
retail space
available for
sublease

14167 28 AVENUE SW
EDMONTON, AB T6W 4H2



POPULATION
137,026



PROJECTED
POPULATION
159,514



MEDIAN AGE
35.2



AVERAGE HH
INCOME
\$161,588



DISPOSABLE
INCOME
\$125,529





PROPERTY OVERVIEW

Civic Address Bay F-7, 14167 28 Avenue SW

Location Edmonton, AB

Rentable Area 2,508 SF

Year Built 2019

Neighborhood Heritage Valley

Parking Ample, scramble

Head Lease Expiry November 30, 2039

Asking Net Rent Market

Op Costs (2025) \$21.36 PSF (2025)

Anchor Tenants Co-op Grocery, Scotiabank, Tim Hortons and Dollarama

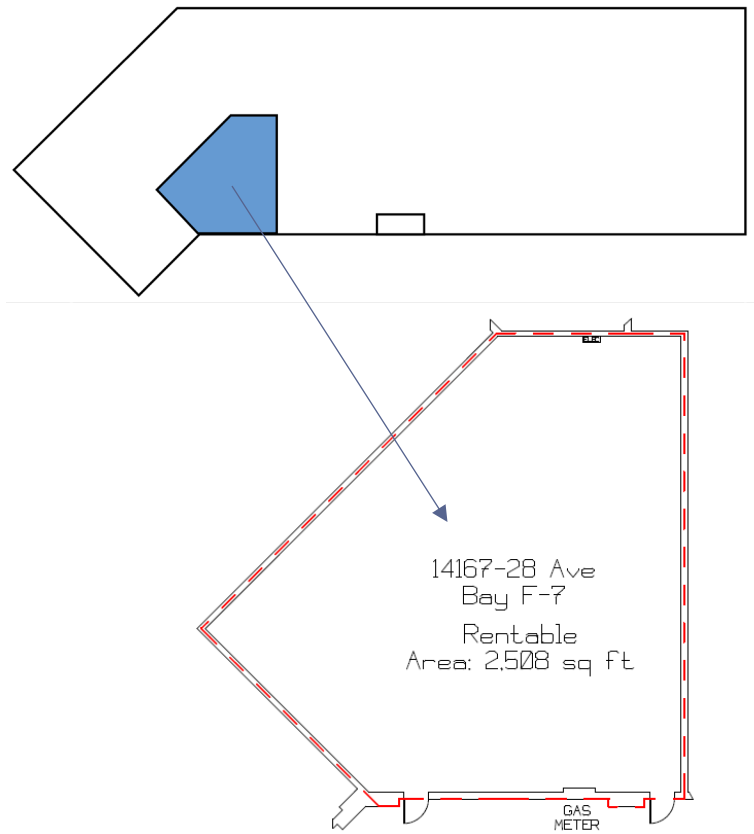

Tony Savchuk
Associate
+1 780 441 9740
tony.savchuk@colliers.com

Paul Raimundo
Senior Vice President
+1 780 420 1585
paul.raimundo@colliers.com

Bruce Peters
Vice President
+1 780 424 7830
bruce.peters@colliers.com

Colliers Canada
1700, 10104 103 Avenue,
Edmonton, Alberta
+1 780 420 1585

This document/email has been prepared by Colliers for advertising and general information only. Colliers makes no guarantees, representations or warranties of any kind, expressed or implied, regarding the information including, but not limited to, warranties of content, accuracy and reliability. Any interested party should undertake their own inquiries as to the accuracy of the information. Colliers excludes unequivocally all inferred or implied terms, conditions and warranties arising out of this document and excludes all liability for loss and damages arising there from. This publication is the copyrighted property of Colliers and /or its licensor(s). © 2026. All rights reserved. This communication is not intended to cause or induce breach of an existing listing agreement.