



# ETON BUSINESS PARK

21110 NORDHOFF ST, UNIT I  
CHATSWORTH, CA

**SPACE AVAILABLE | 1,704 SF**

**\$3,152 MG**  
PER MONTH (\$1.85 PSF)

**6 MONTHS HALF RENT**  
(SUBJECT TO TENANT'S  
CREDIT AND MINIMUM  
3-YEAR LEASE TERM)



**Jeff Abraham, SIOR**  
Executive Managing Director  
t 818-921-8528  
jeff.abraham@nmrk.com  
CA RE License #01830909

**Javier Galvan**  
Associate Director  
t 818-921-8532  
javier.galvan@nmrk.com  
CA RE License #02116539

Corporate License #01355491

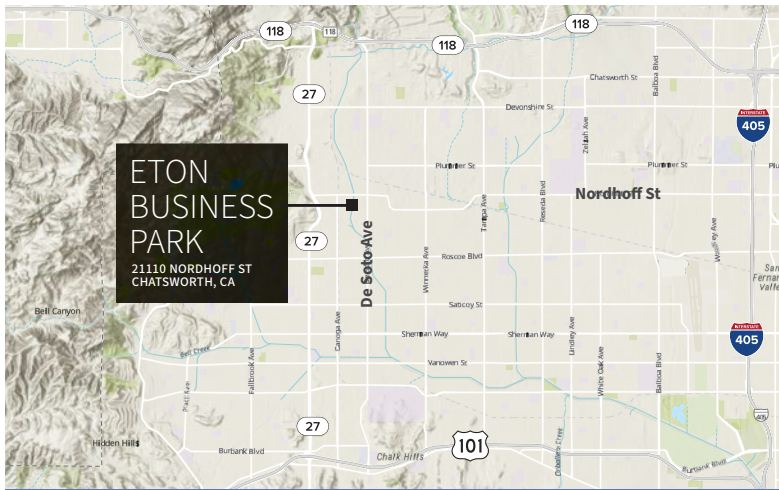

**ETON BUSINESS PARK**  
21110 NORDHOFF ST  
CHATSWORTH, CA

REGIONAL MAP

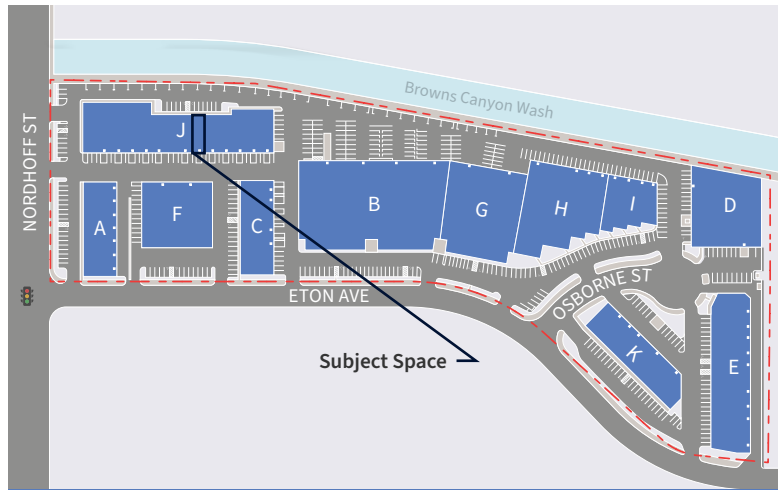

SITE PLAN

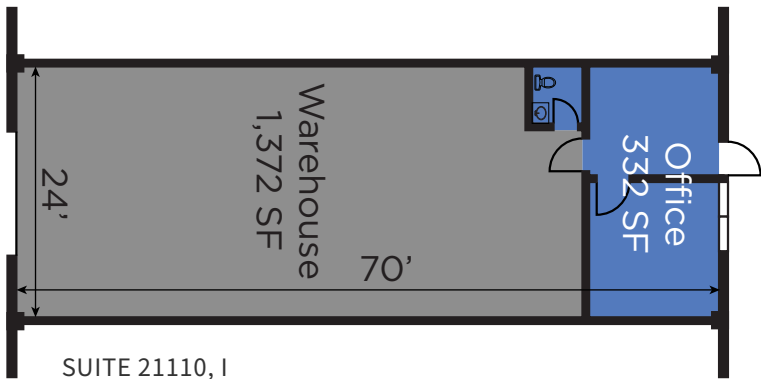

SUITE 21110, I  
**1,704 SF**

FLOOR PLAN



photo from another unit within Eton Business Park and represents renovations when complete

INTERIOR PHOTO

## SUITE ATTRIBUTES



1 rear ground level loading door



16-foot minimum warehouse clearance



Clear span warehouse



332 SF functional office space



200 Amps  
120/208 Volts



3.5 miles from 118 Freeway and 5.2 miles from 101 Freeway



1.53:1,000 SF parking (5 spaces)



20 minutes from 405 Freeway, providing access to Greater Los Angeles



3 miles from Westfield Topanga



**Jeff Abraham, SIOR**  
Executive Managing Director  
t 818-921-8528  
jeff.abraham@nmrk.com  
CA RE License #01830909

**Javier Galvan**  
Associate Director  
t 818-921-8532  
javier.galvan@nmrk.com  
CA RE License #02116539

Corporate License #01355491