

INDUSTRIAL FOR SUBLEASE

6201 Knott Ave, Buena Park, CA 90620 ±102,367 SF



For More Information, Please Contact:

John van Rossem • Managing Director • (949) 231-1741 • john.vanrossem@mohrpartnersca.com • LIC #00973840

Michael Massaro • Managing Partner • (714) 813-1174 • michael.massaro@mohrpartnersca.com • LIC #00941789

Sublease Overview

6201 Knott Ave
Buena Park, CA 90620

SUBLEASE HIGHLIGHTS

- 102,367 SF Industrial Building
- 7,548 SF Office Space
- Sublease Term Thru August 31, 2027
- 18 Dock High Doors
- 1 Ground Level Ramp
- 30' Minimum Clear Height
- 52' x 50' Bay Spacing
- 800 Amps of Well Distributed Power
- Immediate Access to the 5 & 91 Freeways

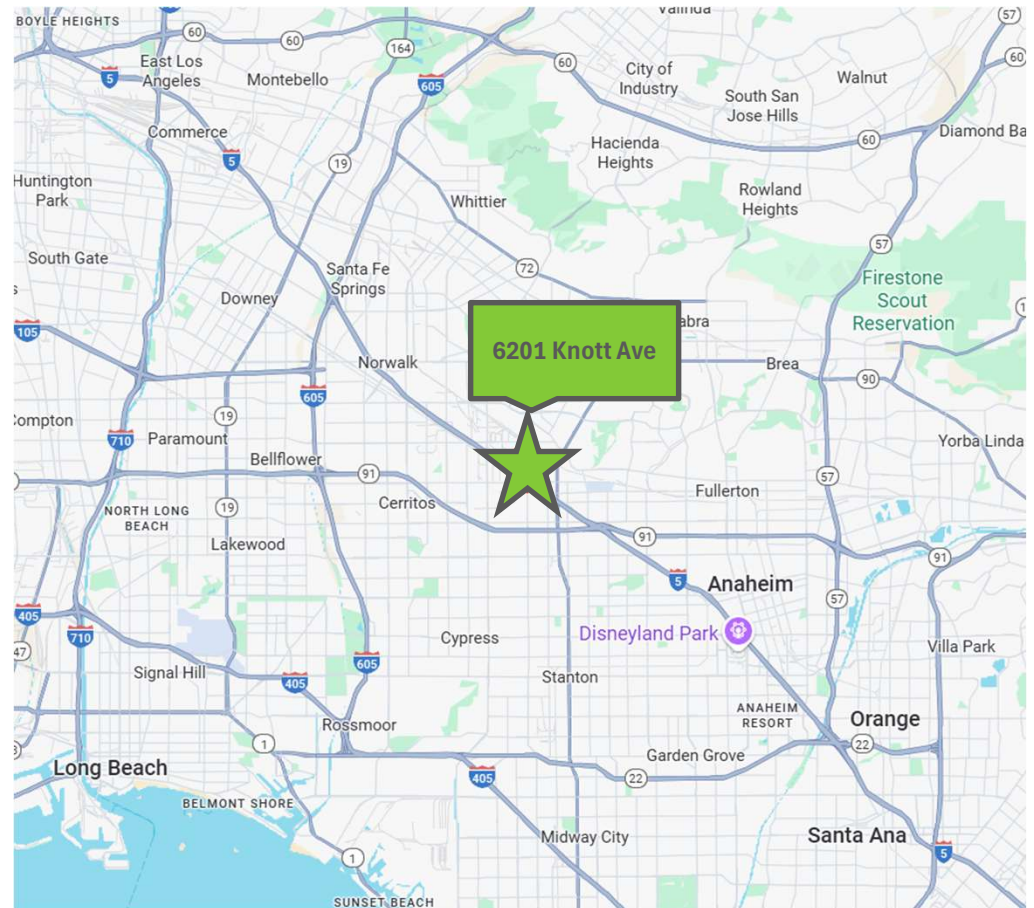

For More Information, Please Contact:

John van Rossem • Managing Director • (949) 231-1741 • john.vanrossem@mohrpartnersca.com • LIC #00973840

Michael Massaro • Managing Partner • (714) 813-1174 • michael.massaro@mohrpartnersca.com • LIC #00941789

Site Plan

6201 Knott Ave
Buena Park, CA 90620

±102,367 SF Available For Sublease

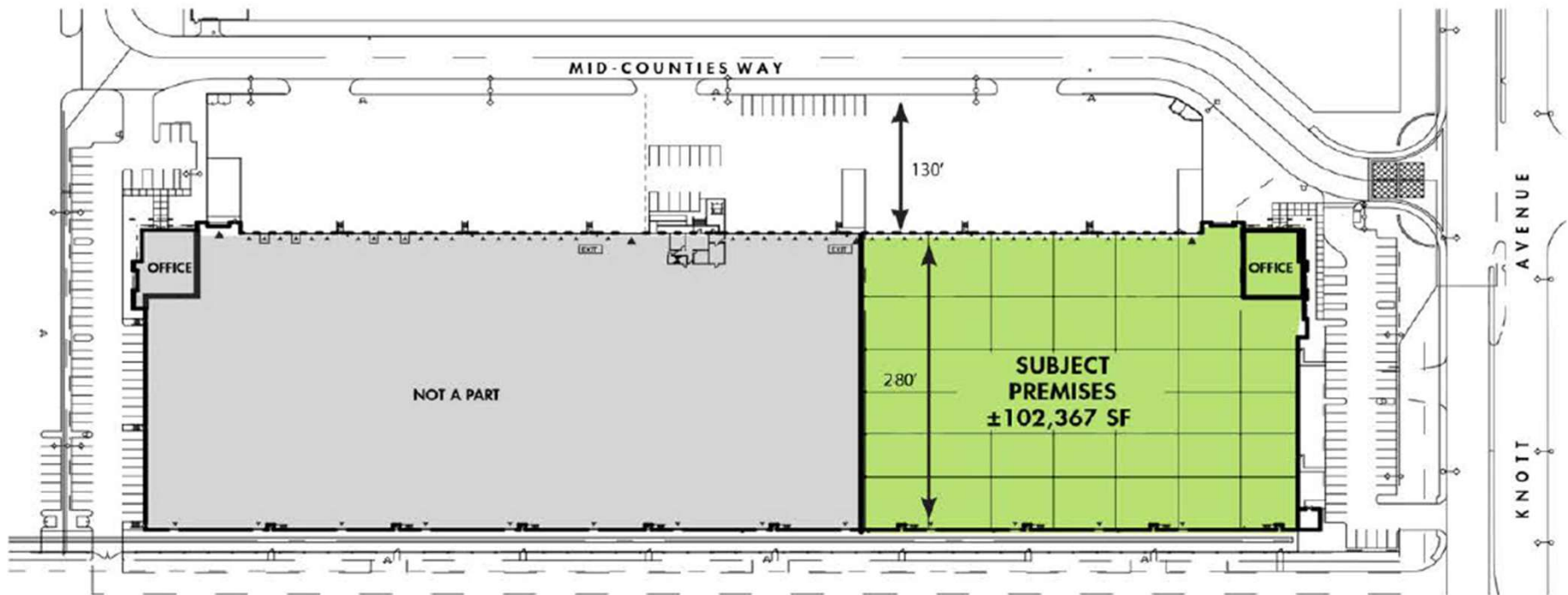

For More Information, Please Contact:

John van Rossem • Managing Director • (949) 231-1741 • john.vanrossem@mohrpartnersca.com • LIC #00973840

Michael Massaro • Managing Partner • (714) 813-1174 • michael.massaro@mohrpartnersca.com • LIC #00941789

Floor Plan

6201 Knott Ave
Buena Park, CA 90620

±102,367 SF Available For Sublease

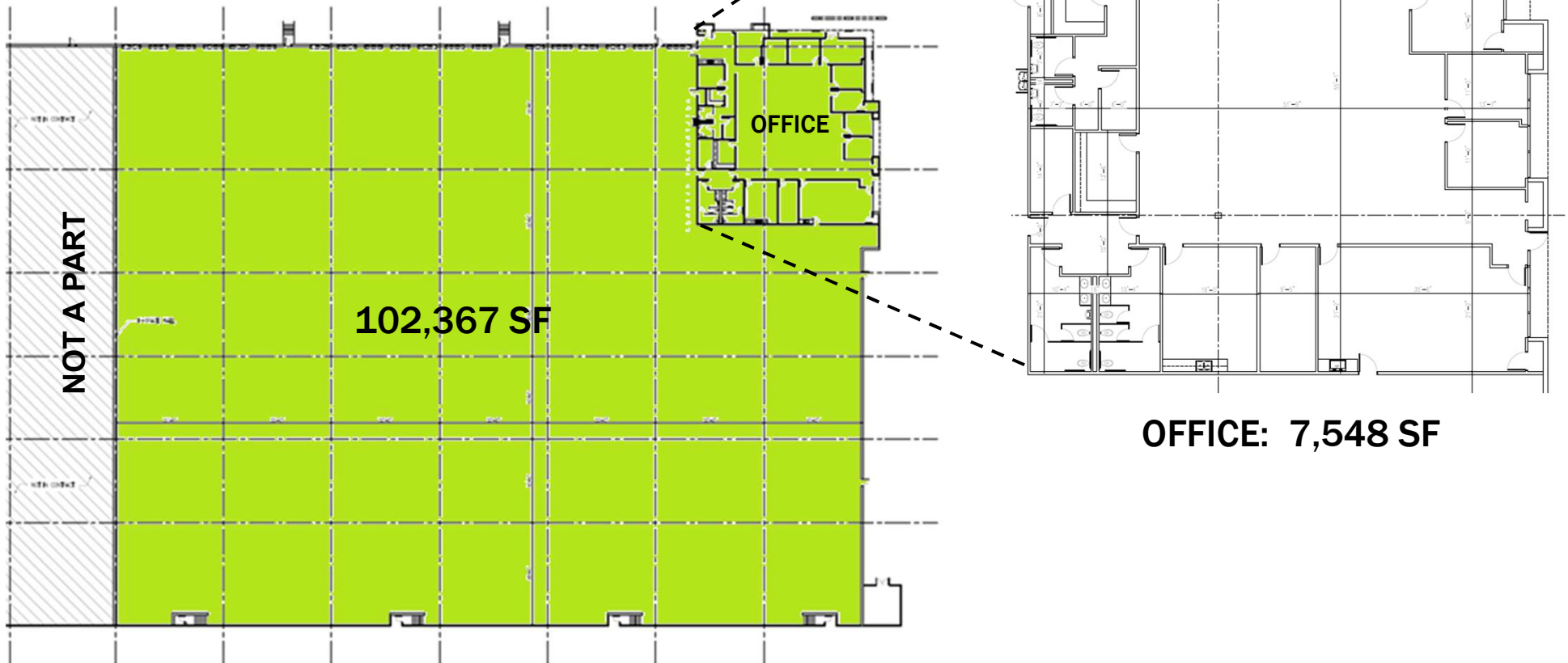

For More Information, Please Contact:

John van Rossem • Managing Director • (949) 231-1741 • john.vanrossem@mohrpartnersca.com • LIC #00973840

Michael Massaro • Managing Partner • (714) 813-1174 • michael.massaro@mohrpartnersca.com • LIC #00941789

Aerial

6201 Knott Ave
Buena Park, CA 90620

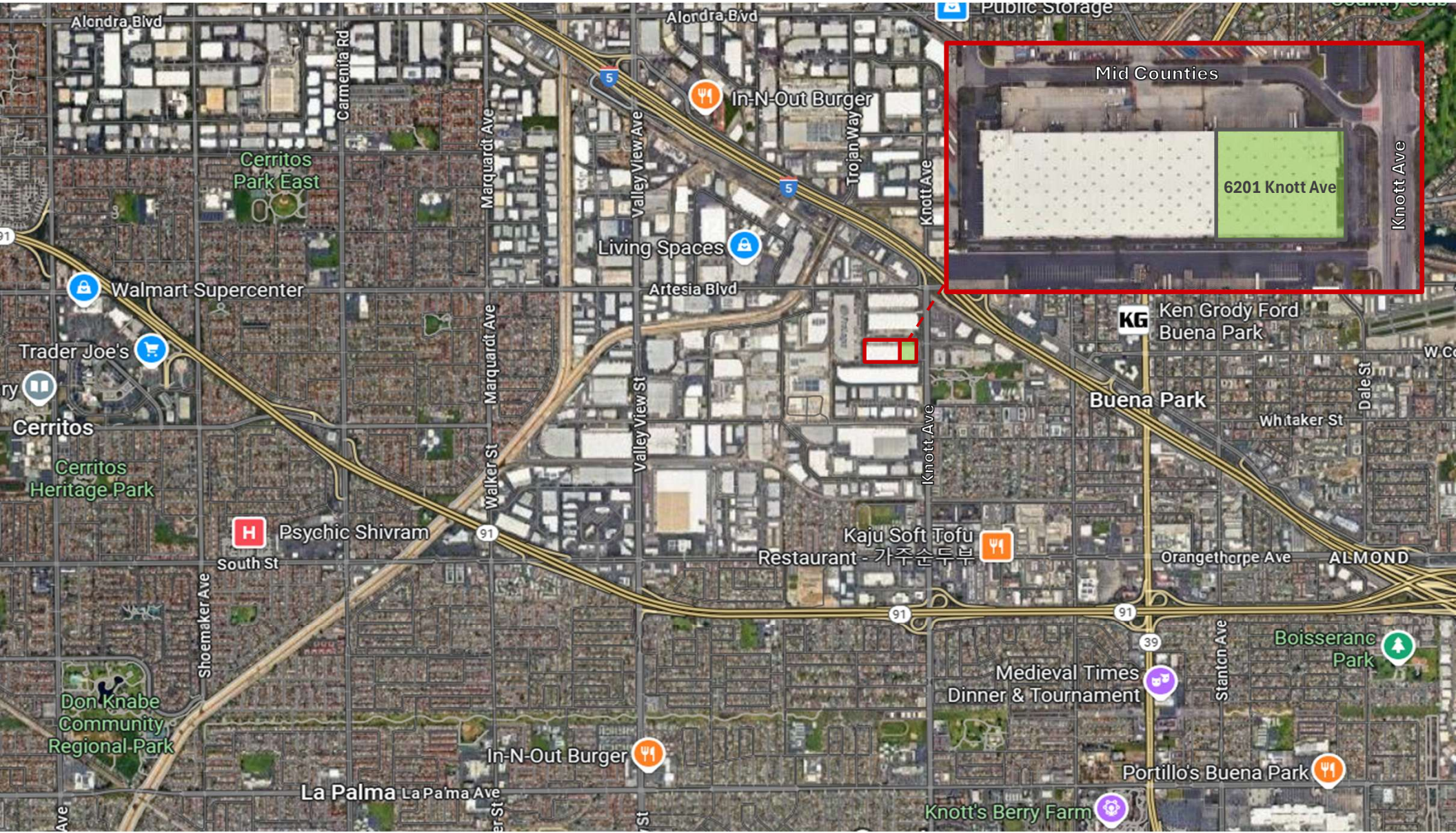

For More Information, Please Contact:

John van Rossem • Managing Director • (949) 231-1741 • john.vanrossem@mohrpartnersca.com • LIC #00973840

Michael Massaro • Managing Partner • (714) 813-1174 • michael.massaro@mohrpartnersca.com • LIC #00941789