

FOR LEASE

**MULTI-TENANT
INDUSTRIAL BUILDING**

9448

RICHMOND PL

RANCHO CUCAMONGA, CA



CBRE

22,073 - 38,016 SF



INTERSTATE
15

SUITE D
22,073 SF

SUITE E
38,016 SF

RICHMOND PL

9448

9448 Richmond Pl

is perfectly situated in the heart of Rancho Cucamonga, just ¾ mile from the I-15 freeway and 1.3 miles from the I-10 freeway. The multi-tenant distribution building features ample dock loading and clear height for logistics operations. This prime location offers easy access to a variety of retail and dining amenities.

Site Plan

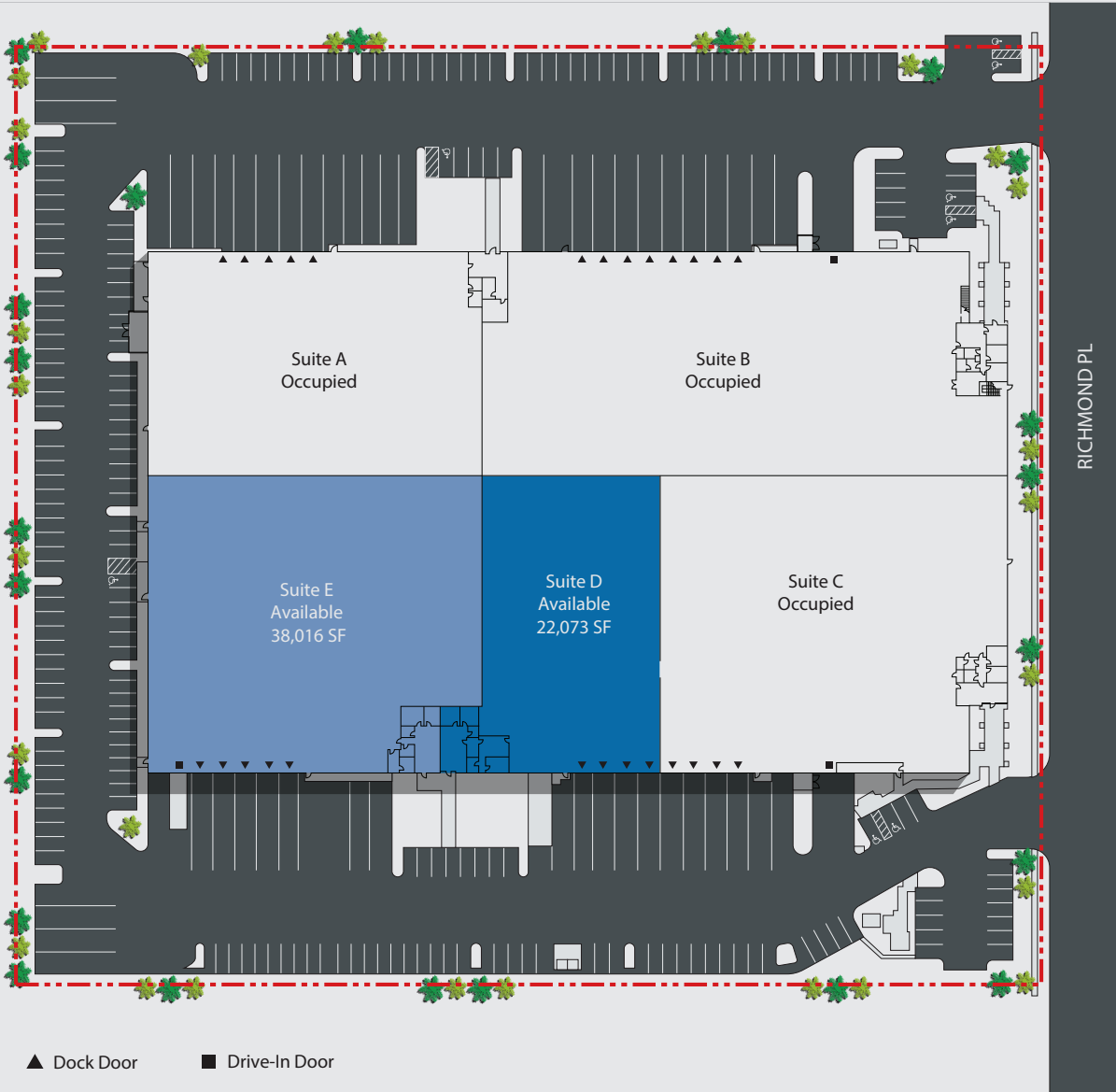

Suite E

38,016 SF

- ±1,147 SF Office
- 30' Clear Height at First Column
- 5 Dock-High Doors; 3 with Pit Levelers
- 1 Grade-Level Door

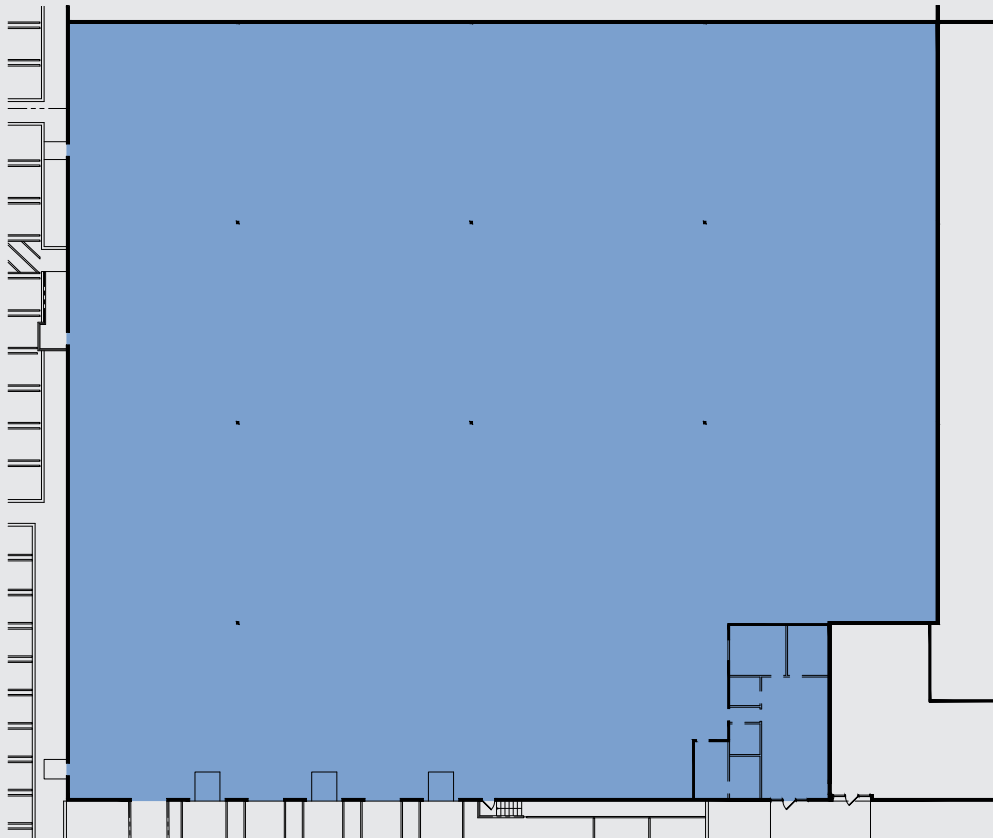

Suite D 22,073 SF

- ±1,471 SF Office
- 30' Clear Height at First Column
- 4 Dock-High Doors; 2 with Pit Levelers
- 1 Grade-Level Door

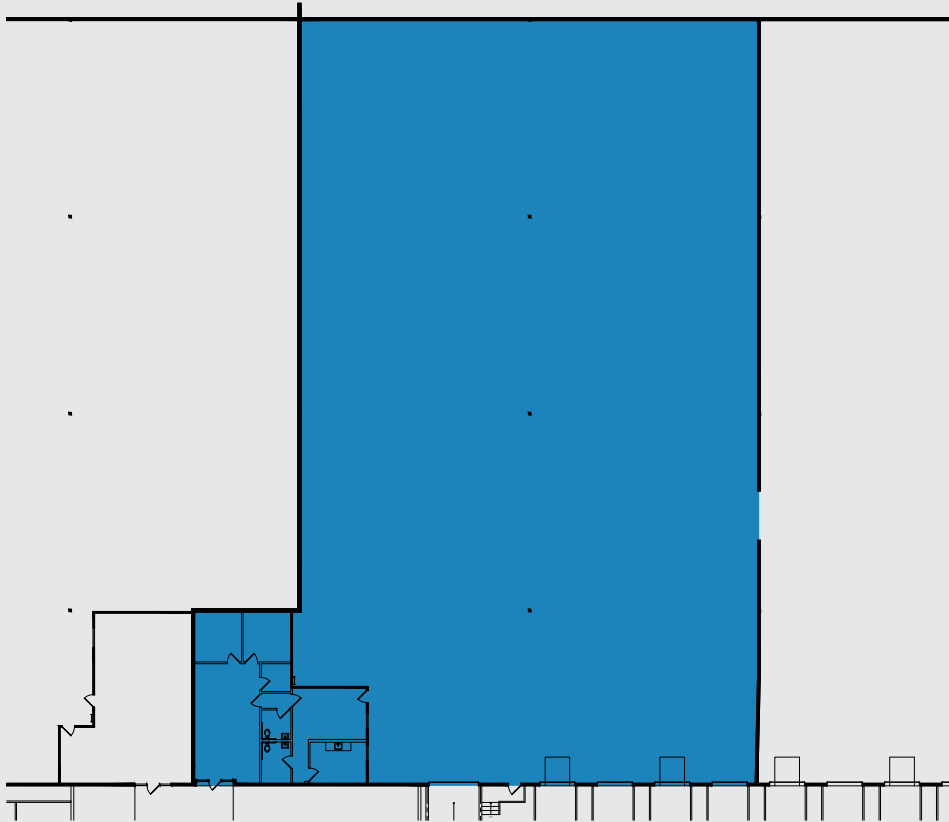

Location

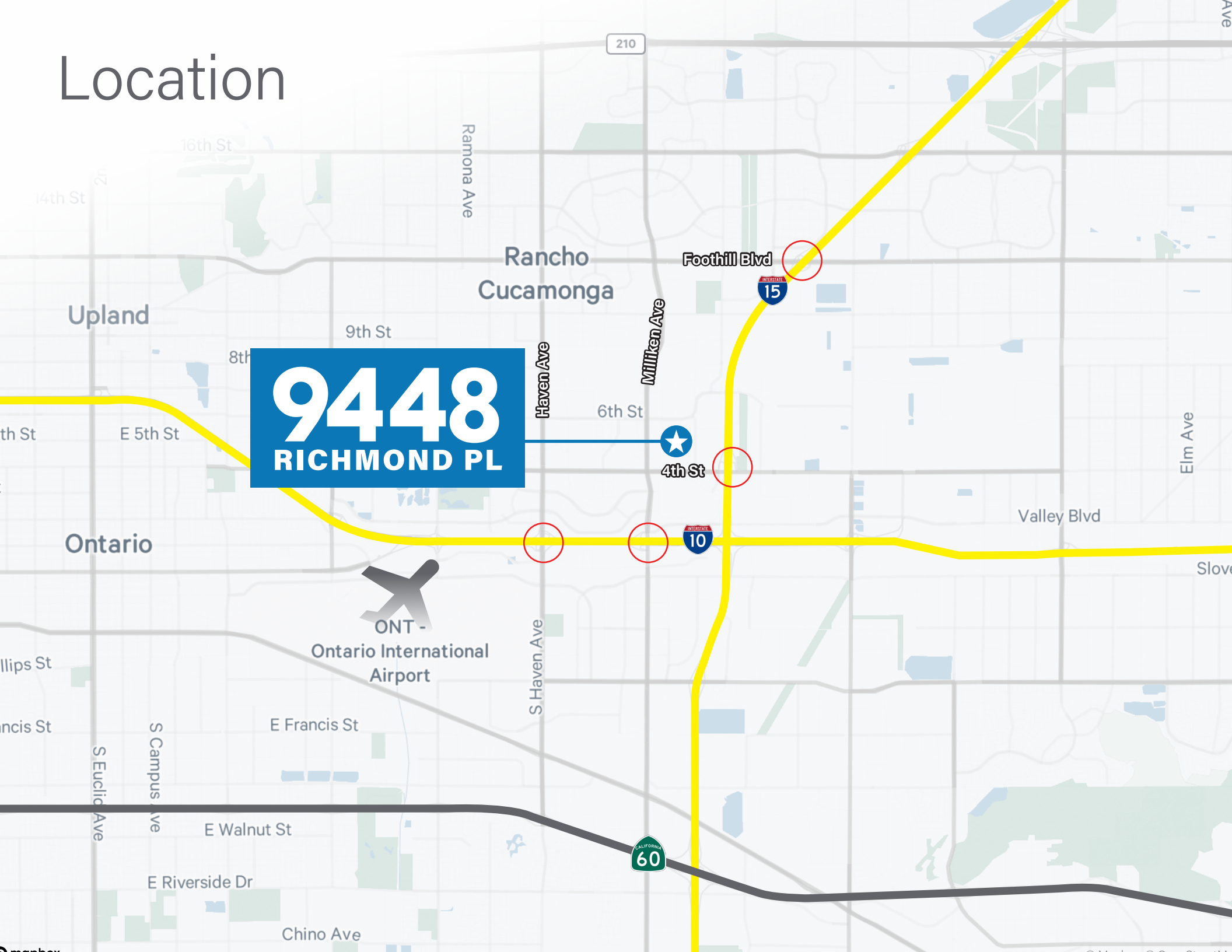

9448
RICHMOND PL



ONT -
Ontario International
Airport

9448
RICHMOND PL



ONTARIO
MILLS

HAVEN AVE

MILLIKEN AVE

Buffalo Ave

Santa Anita Ave

6th St

4TH ST

Concours St

N Milliken Ave

h St





9448
RICHMOND PL
RANCHO CUCAMONGA, CA

FOR MORE INFORMATION, PLEASE CONTACT

RYAN ATHENS

+1 909 418 2021
Lic 01387750
ryan.athens@cbre.com

JEFF FRITCH

+1 909 456 6106
Lic 01857956
jeffrey.fritch@cbre.com

ALEXANDER DAVIS

+1 909 418 2079
Lic 02221838
alexander.davis@cbre.com



© 2026 CBRE, Inc. All rights reserved. This information has been obtained from sources believed reliable but has not been verified for accuracy or completeness. You should conduct a careful, independent investigation of the property and verify all information. Any reliance on this information is solely at your own risk. CBRE and the CBRE logo are service marks of CBRE, Inc. All other marks displayed on this document are the property of their respective owners, and the use of such logos does not imply any affiliation with or endorsement of CBRE. Photos herein are the property of their respective owners. Use of these images without the express written consent of the owner is prohibited.