

# OAKLAND PARK WAREHOUSES

519 NE 34TH STREET, OAKLAND PARK, FL 33334

## UNIT 4

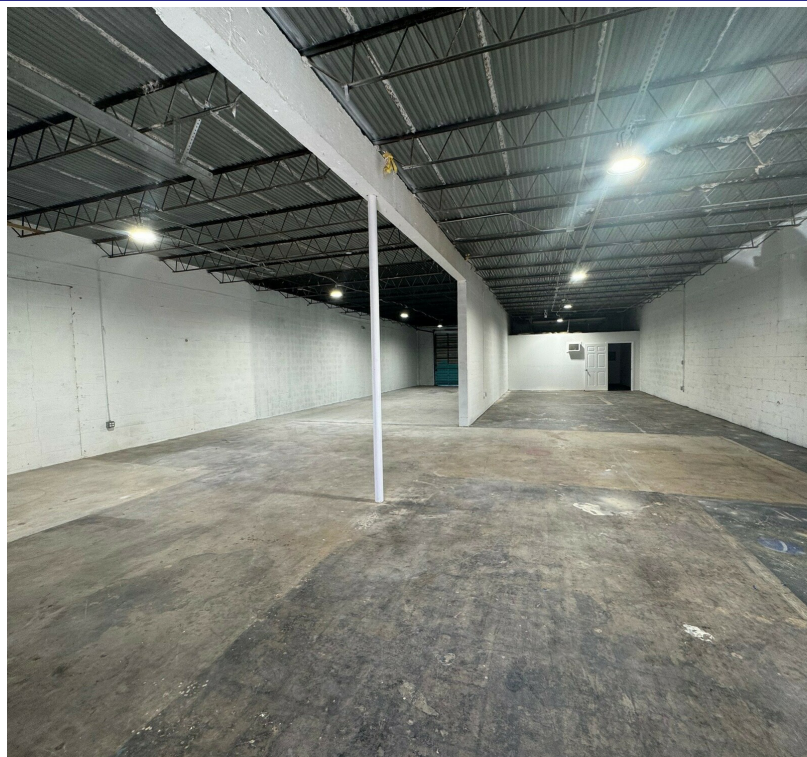

### SPACE HIGHLIGHTS

- 3,085 SF
- 254 SF air-conditioned office
- 2,831 SF warehouse
- Front 12' x 10' grade level overhead door
- Back 10' x 10' grade level overhead door
- Freshly painted and LED lighting
- +/- 11' clear in warehouse
- Small Yard



### ANGIE WEAVER

Lauderdale Lakes and Lauderhill Manager  
Direct: 954.485.9200 | Cell: 917.645.2339  
angie@levyrai.com

### HALEY PRESSER

Property Manager / Sales Associate  
Direct: 954.485.9200 | Cell: 954.254.5396  
Haley@levyrai.com



# OAKLAND PARK WAREHOUSES

519 NE 34TH STREET, OAKLAND PARK, FL 33334

## UNIT 4 FLOOR PLAN

OAKLAND PARK WAREHOUSES  
519-533 NE 34TH ST | OAKLAND PARK, FL 33334



### UNIT 4

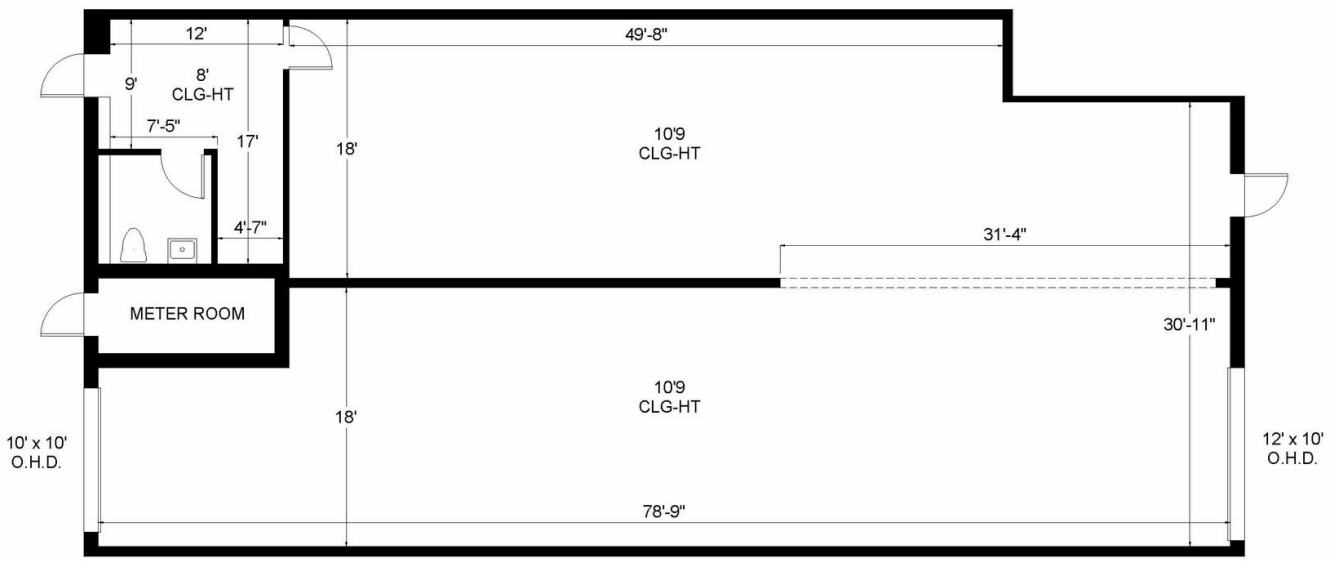

Office - 254 Sq. Ft.  
Warehouse - 2831 Sq. Ft.

3085 Rentable Sq. Ft.  
[www.LevyRealtyAdvisors.com](http://www.LevyRealtyAdvisors.com)

**ANGIE WEAVER**  
Lauderdale Lakes and Lauderhill Manager  
Direct: 954.485.9200 | Cell: 917.645.2339  
angie@levyrai.com

**HALEY PRESSER**  
Property Manager / Sales Associate  
Direct: 954.485.9200 | Cell: 954.254.5396  
Haley@levyrai.com

