

# FOR LEASE - Office Space

2063 N. WATERMAN AVE, EL CENTRO, CA

AVAILABLE: 14,567SF  
75 Exclusive Parking Spaces

## CURRENT TENANTS:



## SURROUNDED BY:



HIGH EXPOSURE ALONG HEAVILY TRAFFICKED

FOR MORE INFORMATION ABOUT THIS PROPERTY, PLEASE CONTACT:

Wesley Uyema  
M: 310-874.6189  
O: 310.471-2700 Ext. 201  
E: Wesley@MichaelCorp.com

Michael  
Development Corp.

# SITE PLAN

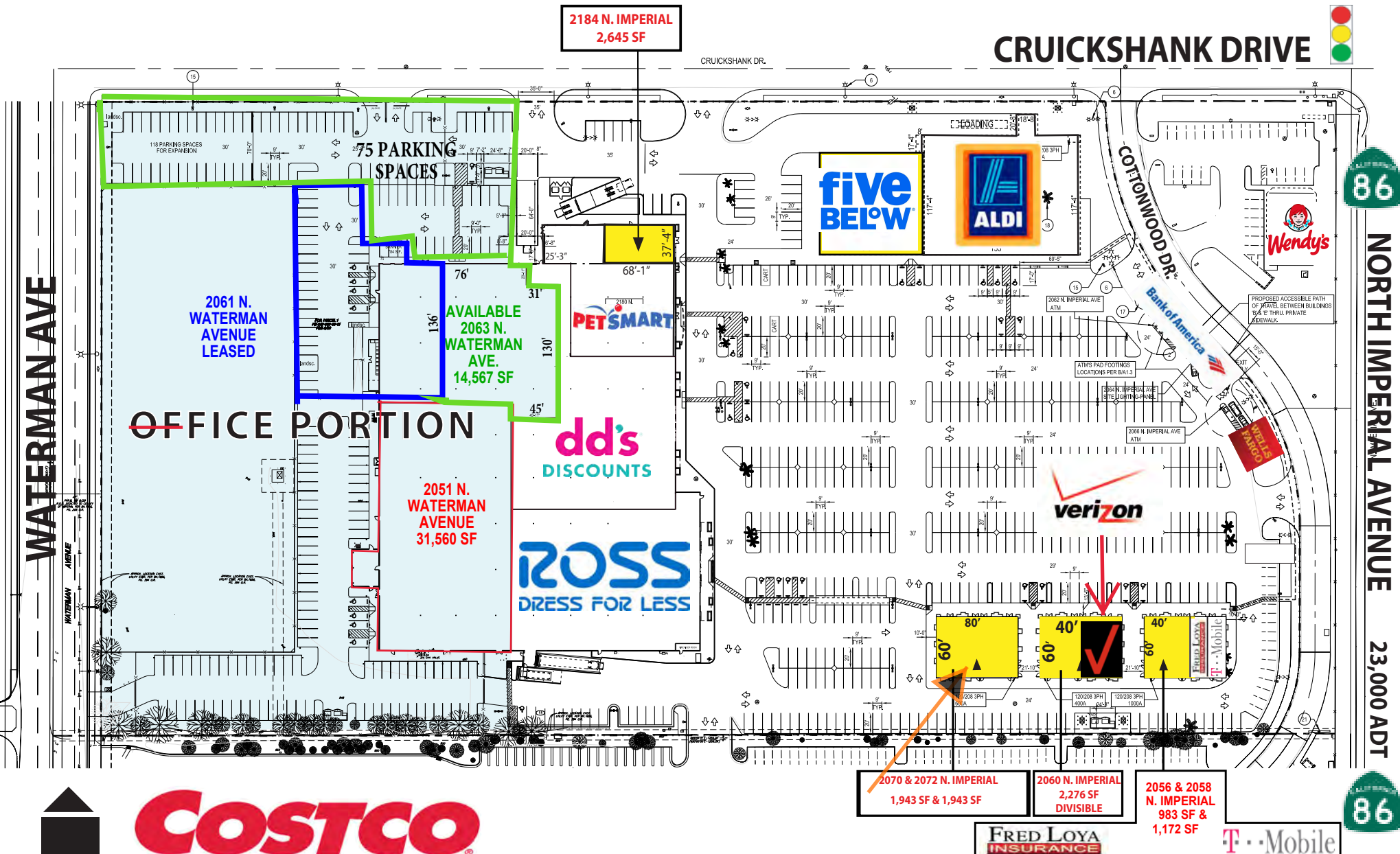

**Michael**  
Development Corp.

FOR MORE INFORMATION ABOUT THIS PROPERTY CONTACT:

Wesley Uyema  
M: 310-874.6189  
O: 310.471-2700 Ext. 201  
E: Wesley@MichaelCorp.com

# FLOOR PLAN - 2063 N. WATERMAN

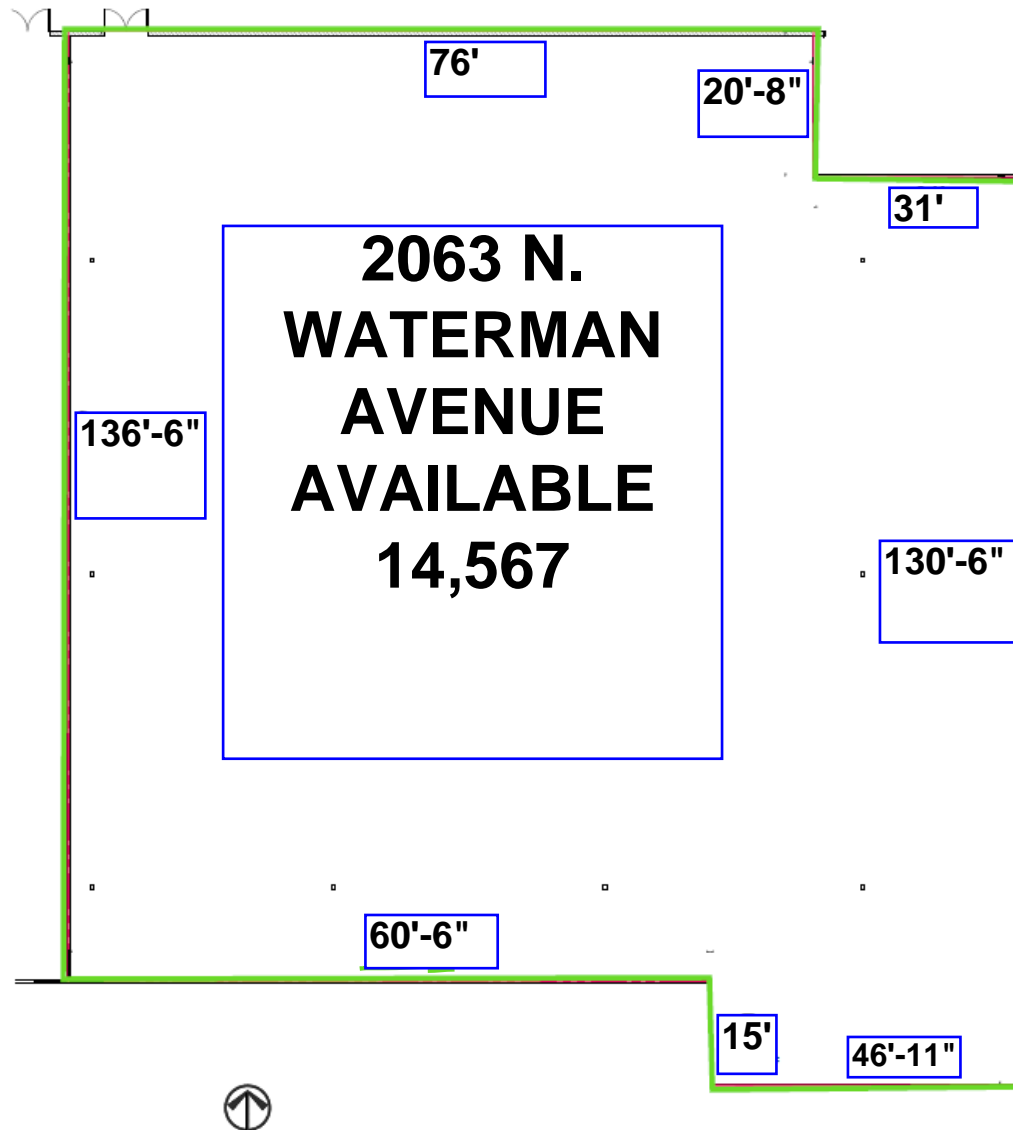

FOR MORE INFORMATION ABOUT THIS PROPERTY, PLEASE CONTACT:

**Wesley Uyema**  
M: 310-874.6189  
O: 310.471-2700 Ext. 201  
E: [Wesley@MichaelCorp.com](mailto:Wesley@MichaelCorp.com)

**Michael**  
Development Corp.

# AERIAL



FOR MORE INFORMATION ABOUT THIS PROPERTY, PLEASE CONTACT:

Wesley Uyema  
M: 310-874.6189  
O: 310.471-2700 Ext. 201  
E: [Wesley@MichaelCorp.com](mailto:Wesley@MichaelCorp.com)

Michael  
Development Corp.