

# EAST LAUDERDALE WAREHOUSES

4760-4875 NE 12 AVE, OAKLAND PARK, FL 33334

CUSTOM PAGE



## 4875 NE 12TH AVE

- 1,350 SF
- Storage Bay
- 11'2" clear ceiling in warehouse
- Rear 10' x 10' grade level overhead door
- LED lighting
- Private restroom
- Can build an office

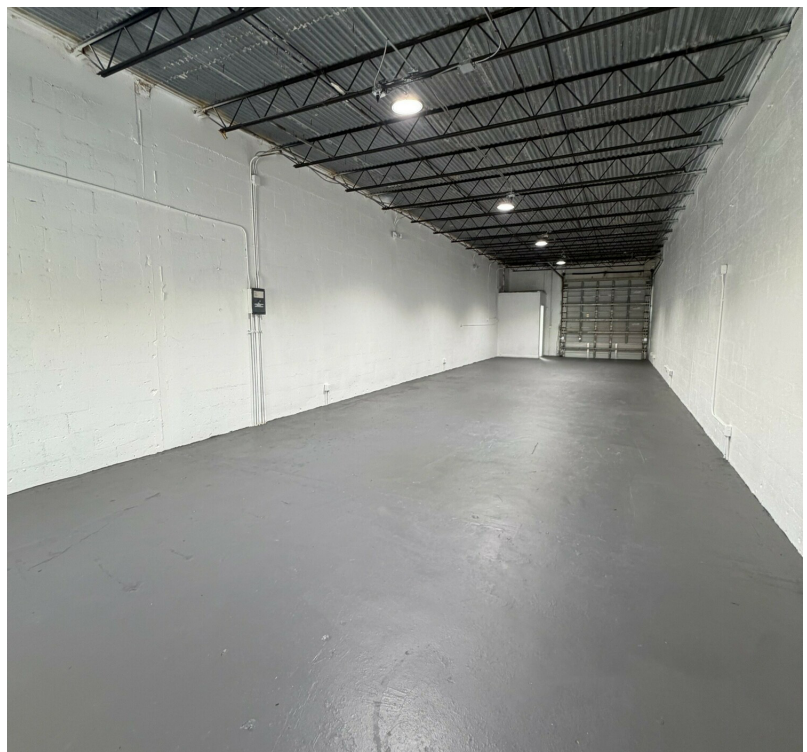

### HALEY PRESSER

Property Manager / Sales Associate  
Direct: 954.485.9200 | Cell: 954.254.5396  
Haley@levyrai.com

### ANGIE WEAVER

Lauderdale Lakes and Lauderdale Manager  
Direct: 954.485.9200 | Cell: 917.645.2339  
angie@levyrai.com



FOR LEASE

# EAST LAUDERDALE WAREHOUSES

4760-4875 NE 12 AVE, OAKLAND PARK, FL 33334

## FLOOR PLAN

### EAST LAUDERDALE WAREHOUSES

4875 NE 12th Avenue, Oakland Park, FL 33334

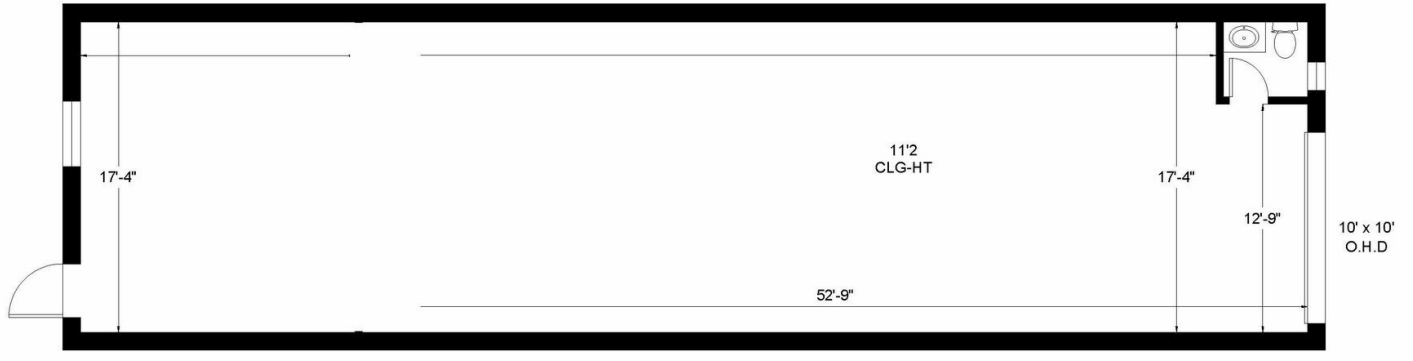

  
Total area - 1,350 Sq. Ft.

**HALEY PRESSER**  
Property Manager / Sales Associate  
Direct: 954.485.9200 | Cell: 954.254.5396  
Haley@levyrai.com

**ANGIE WEAVER**  
Lauderdale Lakes and Lauderdale Manager  
Direct: 954.485.9200 | Cell: 917.645.2339  
angie@levyrai.com

