

# 2971 – 2995 Mead Avenue

TERRENCE J. ROSE, INC.  
REAL ESTATE

INVESTMENT & DEVELOPMENT

S A N T A C L A R A , C A L I F O R N I A



## Warehouse Space for Lease

**5,040 sq. ft.**  
**\$1.85/sq. ft. IG**

**2971-2995 Mead Ave.**  
**Santa Clara, CA 95051**

- 8 Easy access to freeway, expressways and public transportation
- Convenient to hotels, banks and restaurants
- Near Santa Clara Convention Center
- 200 Amps, 3 phase
- One Grade Level Door
- One Covered Dock High Door
- Air-Conditioned Office
- Space Heater in warehouse
- 15 feet clear height

For Information Contact:

**Joan Jensen**

Phone 408 496 1234 • Fax 408 988 4768 • [www.tjrinc.com](http://www.tjrinc.com)  
3375 Scott Blvd., Suite 308, Santa Clara, California 95054

# Mead Avenue

## F L O O R P L A N S

### Floor Plan

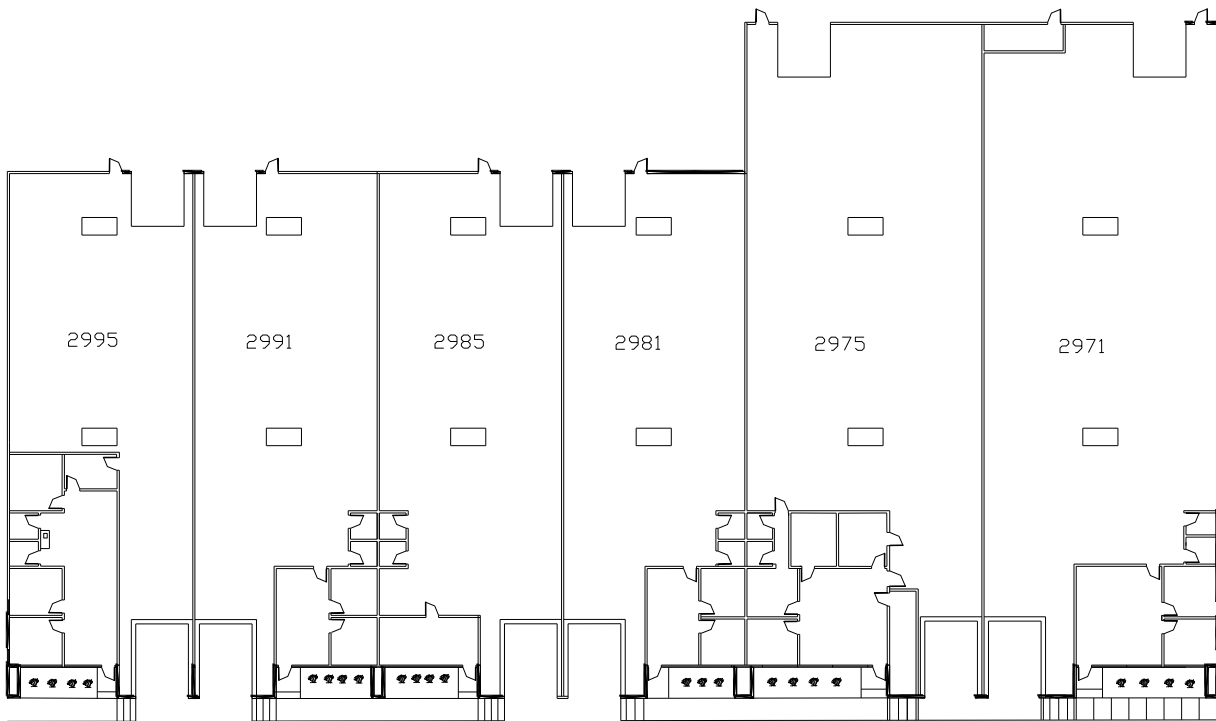

### Map

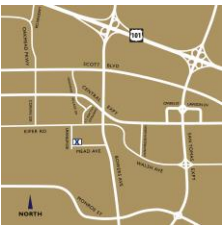

### Available Space:

**2995 Mead Ave – 5,040 sq. ft.**

TERRENCE J. ROSE, INC.  
REAL ESTATE

INVESTMENT & DEVELOPMENT

License No.  
01187284

Phone 408 496 1234 • Fax 408 988 4768 • [www.tjrinc.com](http://www.tjrinc.com)  
3375 Scott Blvd., Suite 308, Santa Clara, California 95054

For Information Contact:

**Joan Jensen**