

# 855 El Camino Real

San Bruno, CA

±9,590 SF Retail Space for Lease



# Market Overview

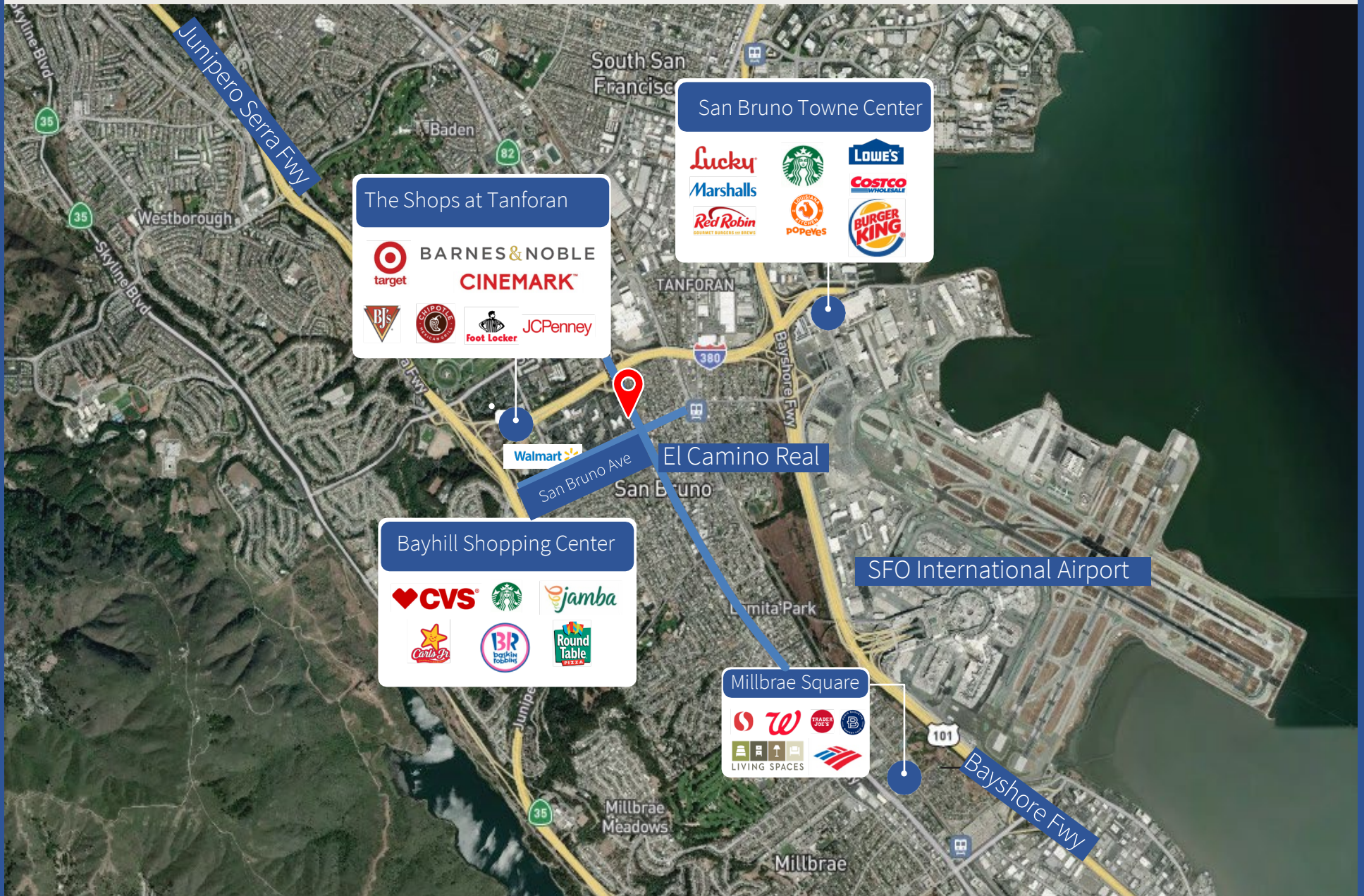

# Upcoming Developments

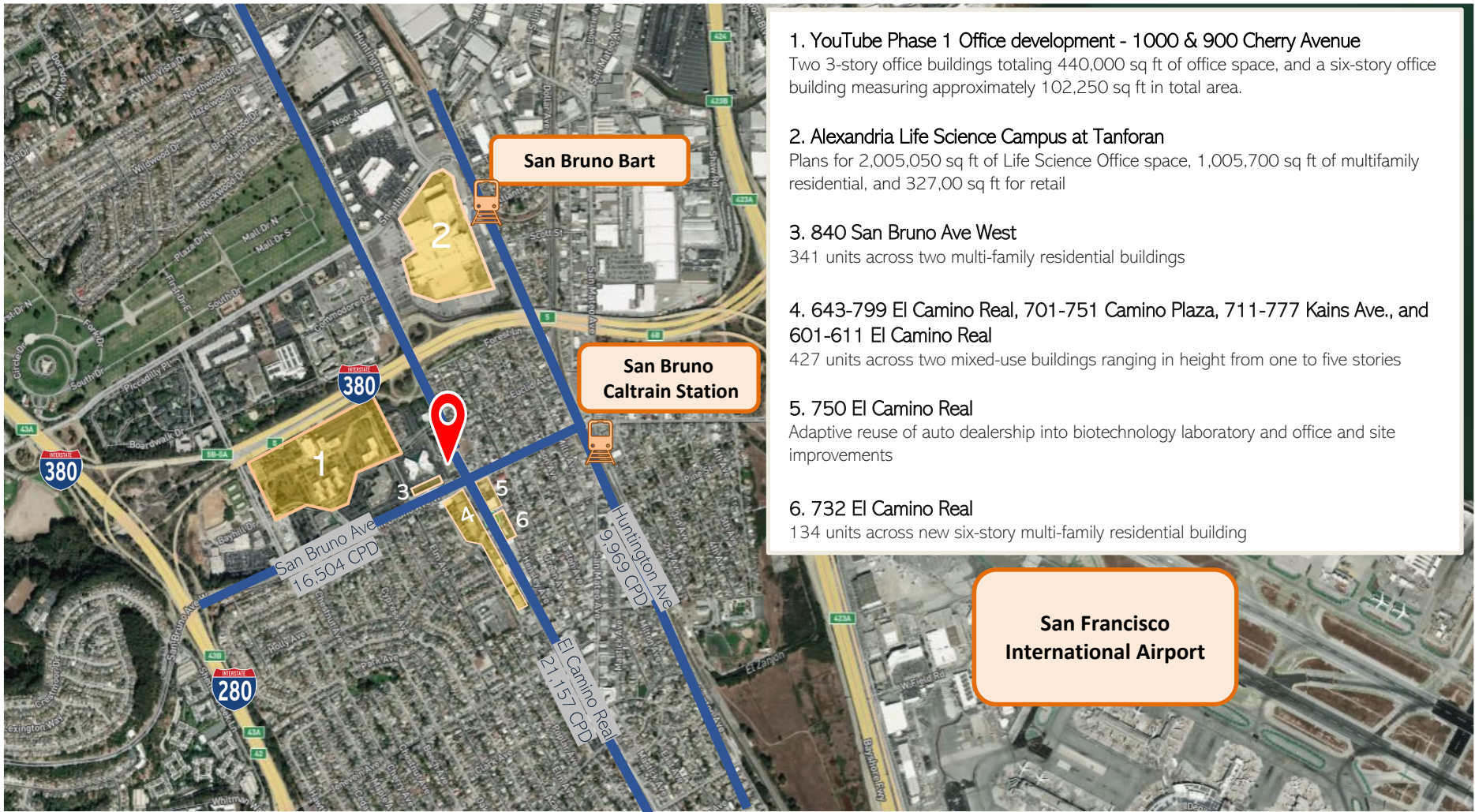

- 1. YouTube Phase 1 Office development - 1000 & 900 Cherry Avenue**  
Two 3-story office buildings totaling 440,000 sq ft of office space, and a six-story office building measuring approximately 102,250 sq ft in total area.
- 2. Alexandria Life Science Campus at Tanforan**  
Plans for 2,005,050 sq ft of Life Science Office space, 1,005,700 sq ft of multifamily residential, and 327,00 sq ft for retail
- 3. 840 San Bruno Ave West**  
341 units across two multi-family residential buildings
- 4. 643-799 El Camino Real, 701-751 Camino Plaza, 711-777 Kains Ave., and 601-611 El Camino Real**  
427 units across two mixed-use buildings ranging in height from one to five stories
- 5. 750 El Camino Real**  
Adaptive reuse of auto dealership into biotechnology laboratory and office and site improvements
- 6. 732 El Camino Real**  
134 units across new six-story multi-family residential building

**San Francisco  
International Airport**

# Market Close Up

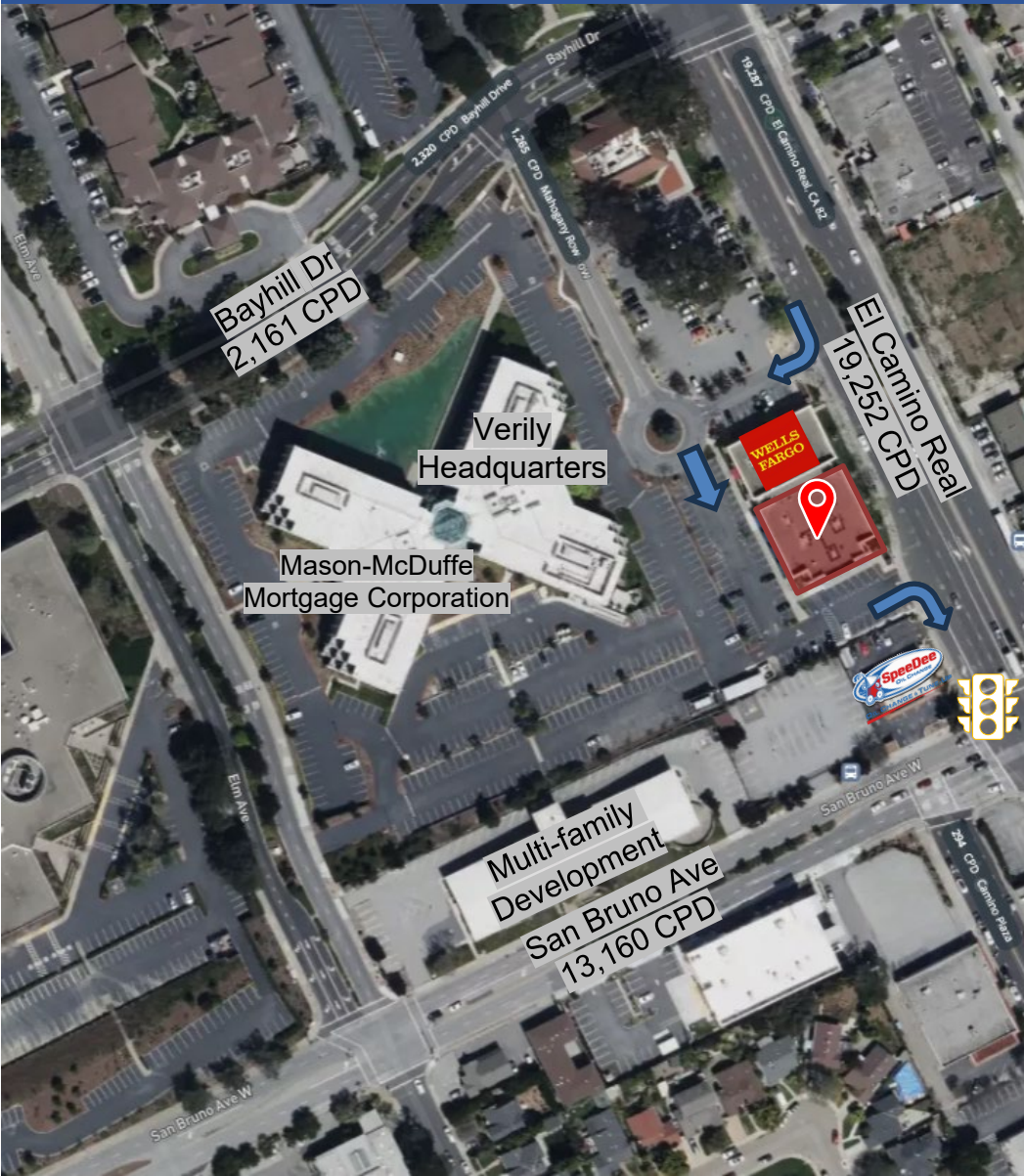

# Space Highlights

- 9,590 SF of retail space
- 73 onsite parking spots with 30 overflow

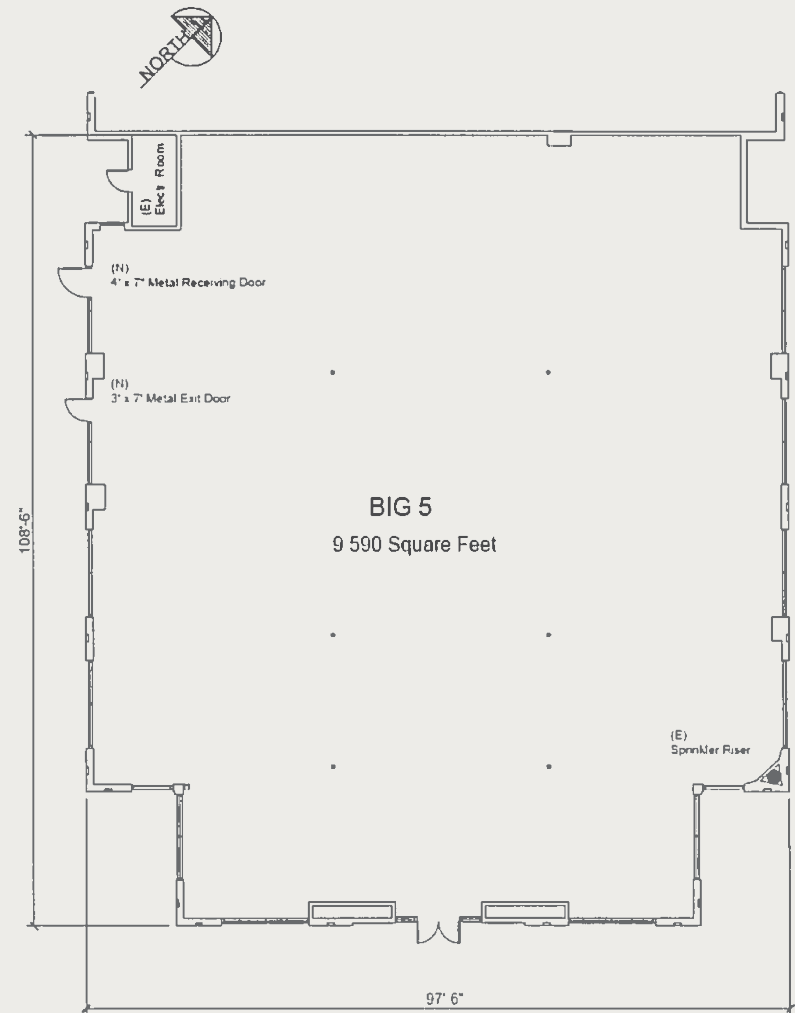

# The Space





**Justin Choi**

Vice President  
+1 415 395 7262  
[justin.choi@jll.com](mailto:justin.choi@jll.com)  
CA #02107928

**Jeff Badstubner**

Managing Director  
+1 415 395 4900  
[jeff.badstubner@jll.com](mailto:jeff.badstubner@jll.com)  
CA #01155279



Although information has been obtained from sources deemed reliable, JLL does not make any guarantees, warranties or representations, express or implied, as to the completeness or accuracy as to the information contained herein. Any projections, opinions, assumptions or estimates used are for example only. There may be differences between projected and actual results, and those differences may be material. JLL does not accept any liability for any loss or damage suffered by any party resulting from reliance on this information. If the recipient of this information has signed a confidentiality agreement with JLL regarding this matter, this information is subject to the terms of that agreement. ©2024 Jones Lang LaSalle Brokerage, Inc. All rights reserved.