

# 655

## AVENUE OF THE AMERICAS

ON THE NORTHWEST CORNER OF WEST 20TH STREET



**CBRE**

**Ground Floor**  
4,236 SF

**Possession**  
Arranged

**Sublease Term**  
Available Upon Request

## Highly Visible Corner Ground Floor Retail

### Comments

- Excellent branding and signage potential along 6th Avenue.
- Steps from the **1 F M** subway lines and easy access to the PATH at 23rd Street.
- **Consistent 7-day traffic:** driven my commuters, residents, and destination shoppers.

### Neighbors

Trader Joe's	The Container Store
Fuze House	Ulta
LifeTime	Old Navy
Bathhouse	Five Below
Barry's	Marshalls
F45	Blick Art Materials
T.J. Maxx	NY Cake

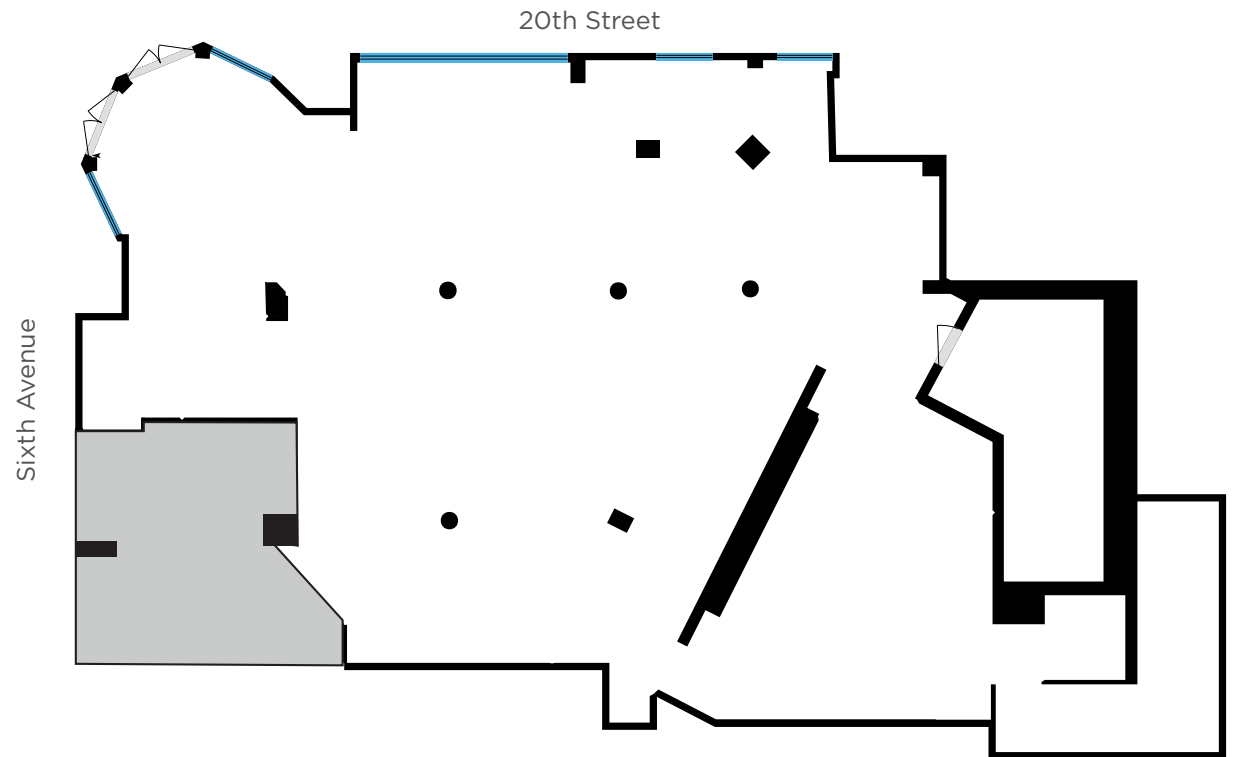



VENUE OF THE Americas  
W 20 St

ONE WAY

10

4

♿

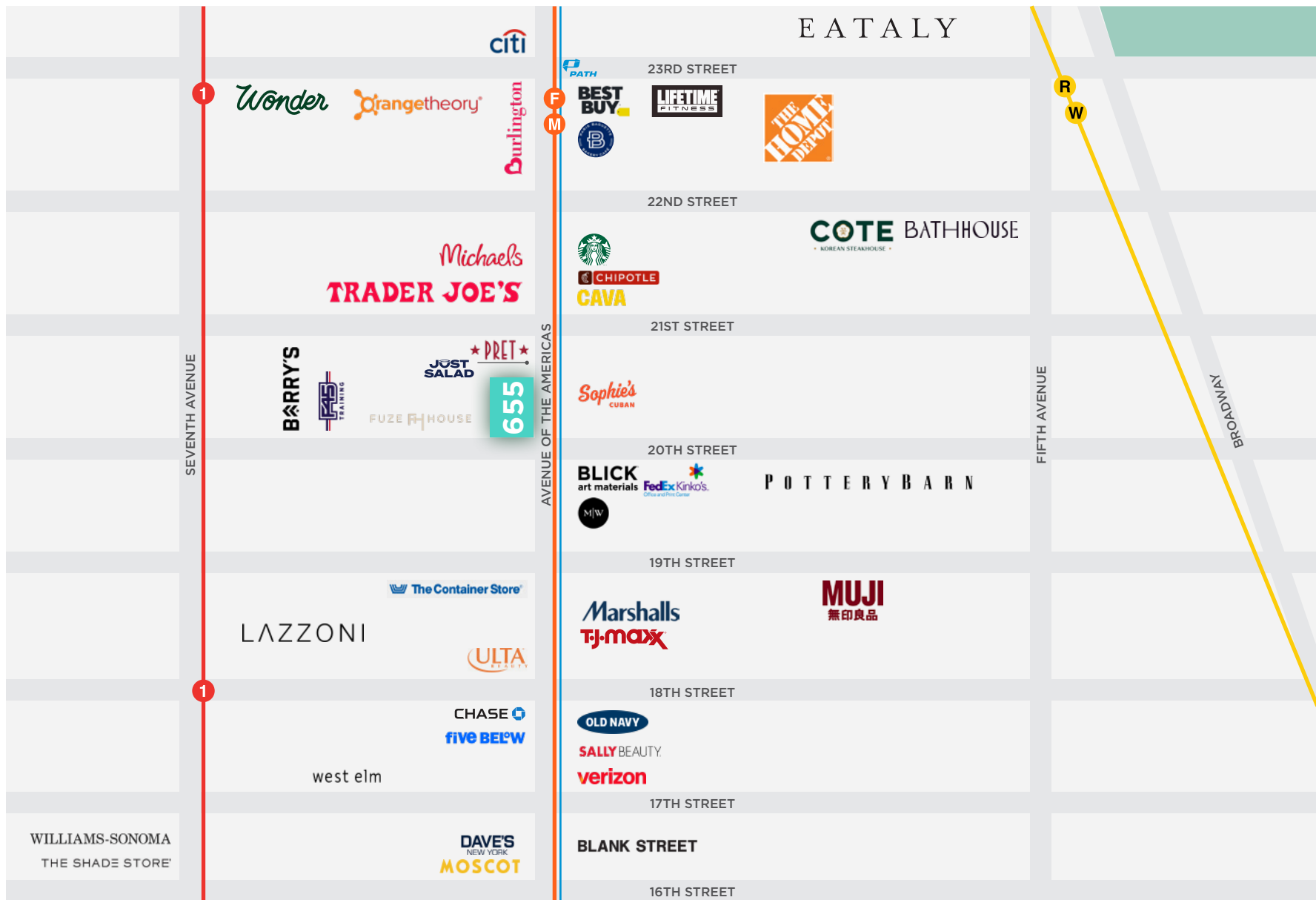

Stephen Surjset

212 984 7105

stephen.surjset@cbre.com

Duane Davis

212 984 7120

duane.davis@cbre.com

Cameron Carton

212 984 6632

cameron.carton@cbre.com

**CBRE**

© 2026 CBRE, Inc. All rights reserved. This information has been obtained from sources believed reliable, but has not been verified for accuracy or completeness. You should conduct a careful, independent investigation of the property and verify all information. Any reliance on this information is solely at your own risk. CBRE and the CBRE logo are service marks of CBRE, Inc. All other marks displayed on this document are the property of their respective owners, and the use of such logos does not imply any affiliation with or endorsement of CBRE.