



**savoy**

---

**Sunnyvale 1120 Kifer Road**

Premium retail leasing opportunity  
in the heart of Sunnyvale's most  
dynamic emerging communities



Unparalleled location  
UNMATCHED ACCESS.



## Property Highlights

- » Built in 2020 with a contemporary design
- » Ideal location in one of Sunnyvale's newest and most dynamic multi-family projects
- » 520 residential units on site
- » 216,159 suburban population within 3 miles
- » Central location to Hwy 101 and 82
- » In cold shell condition, TI package available





# In the heart of SUNNYVALE



# In the heart of SUNNYVALE



**Irvine Company**  
1,098 Units  
107 Townhomes,  
57 walk-up apartments,  
887 midrise apartments



**Olympic Residential**  
Proposed:  
mixed-use project with  
741 residential units



**Subject Property -  
Savoy**  
520 Units



**Nuevo by  
Summerhill Homes**  
994 residential units,  
20,000 SF retail;  
under construction



# A Bird's Eye View OF SAVOY

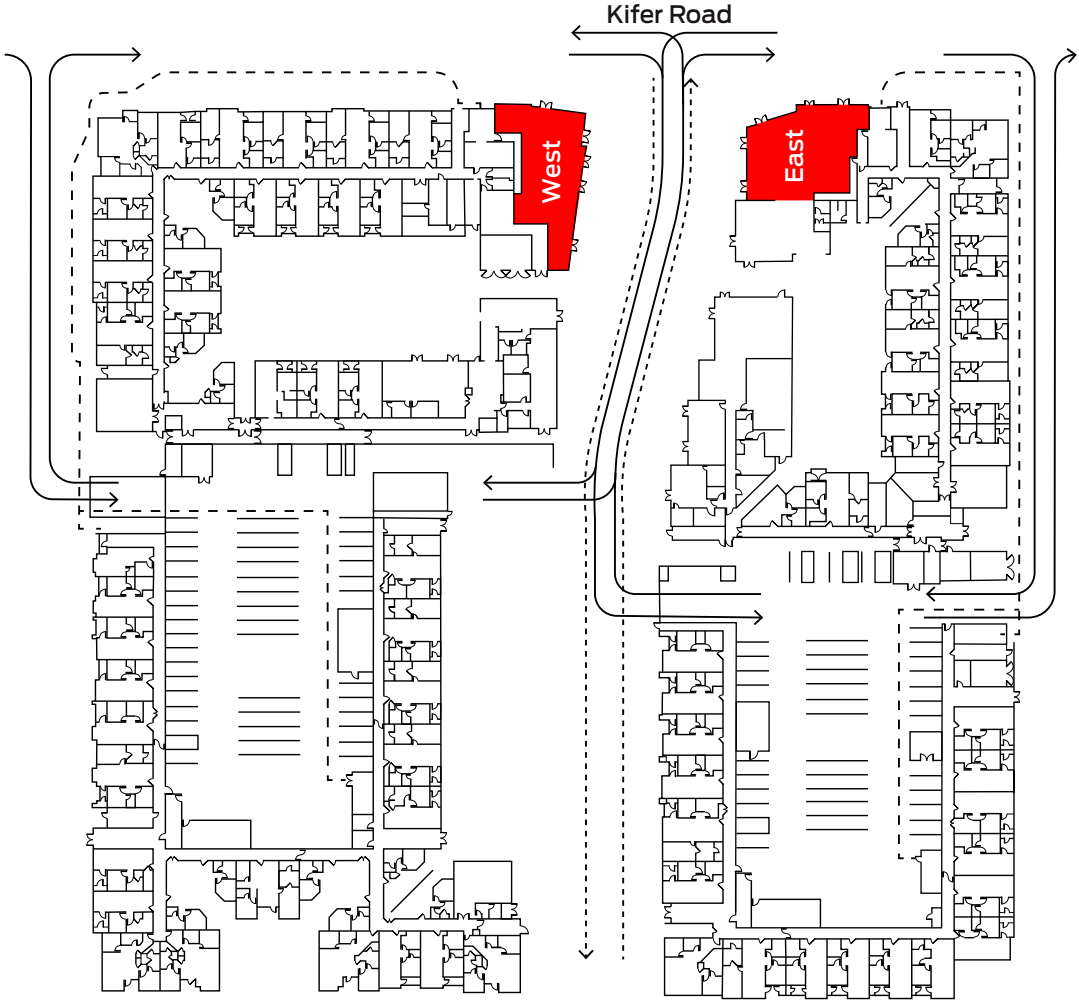

savoy

Sunnyvale 1120 Kifer Road



# Available Space

MODERN SANCTUARY.



Contains 520 residential apartments

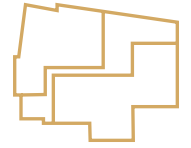

Cold Shell Condition

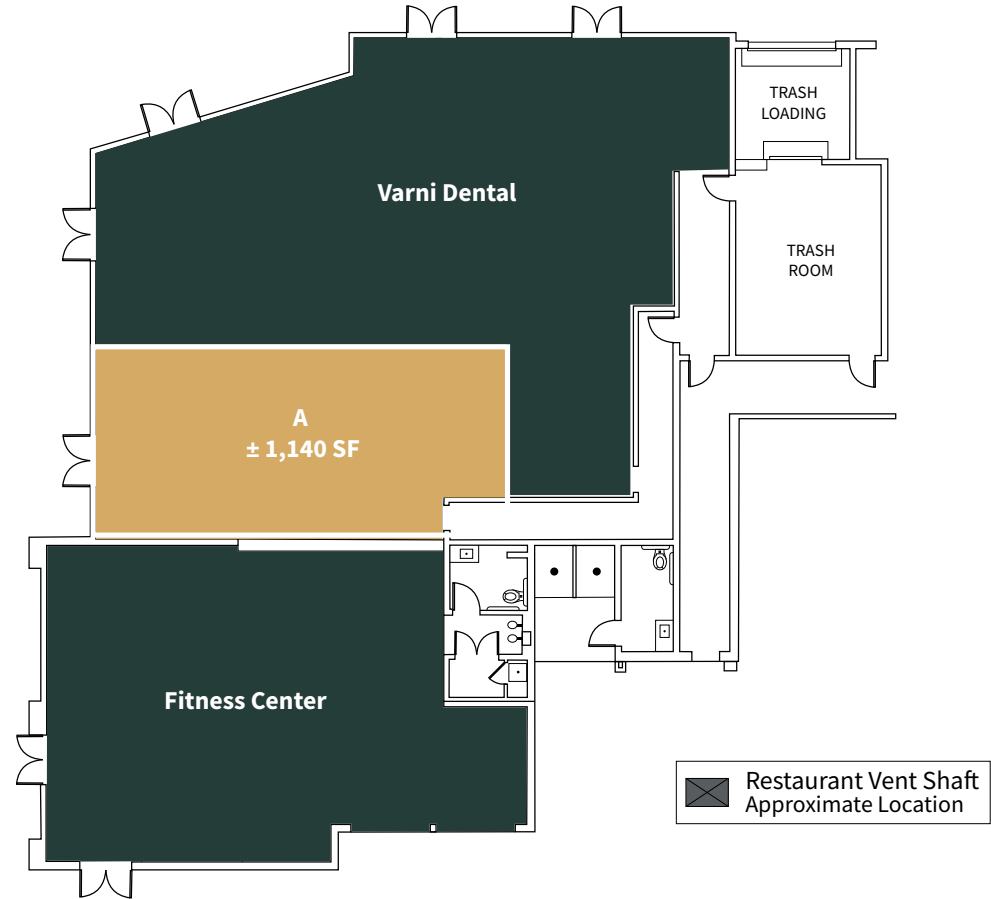
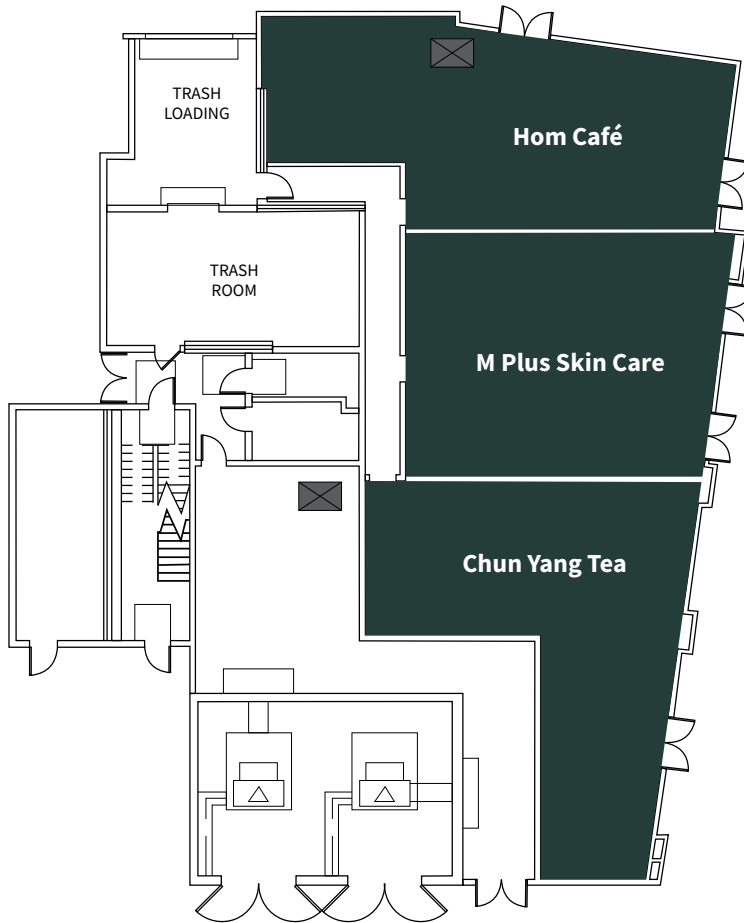

 Restaurant Vent Shaft  
Approximate Location

## West Suite

Ground Floor Retail

## East Suite 1,140 SF

Ground Floor Retail





LAURA TINETTI

Managing Director

415 228 3072

[laura.tinetti@jll.com](mailto:laura.tinetti@jll.com)

RE License: 01358500

JUSTIN CHOI

Vice President

925 858 6041

[justin.choi@jll.com](mailto:justin.choi@jll.com)

RE License: 02107928

VICTORIA VIET

Associate

936 676 4950

[victoria.viet@jll.com](mailto:victoria.viet@jll.com)

RE License: 02442228

