

# Kearny Point

78 John Miller Way, Suite 326 Kearny, NJ 07032

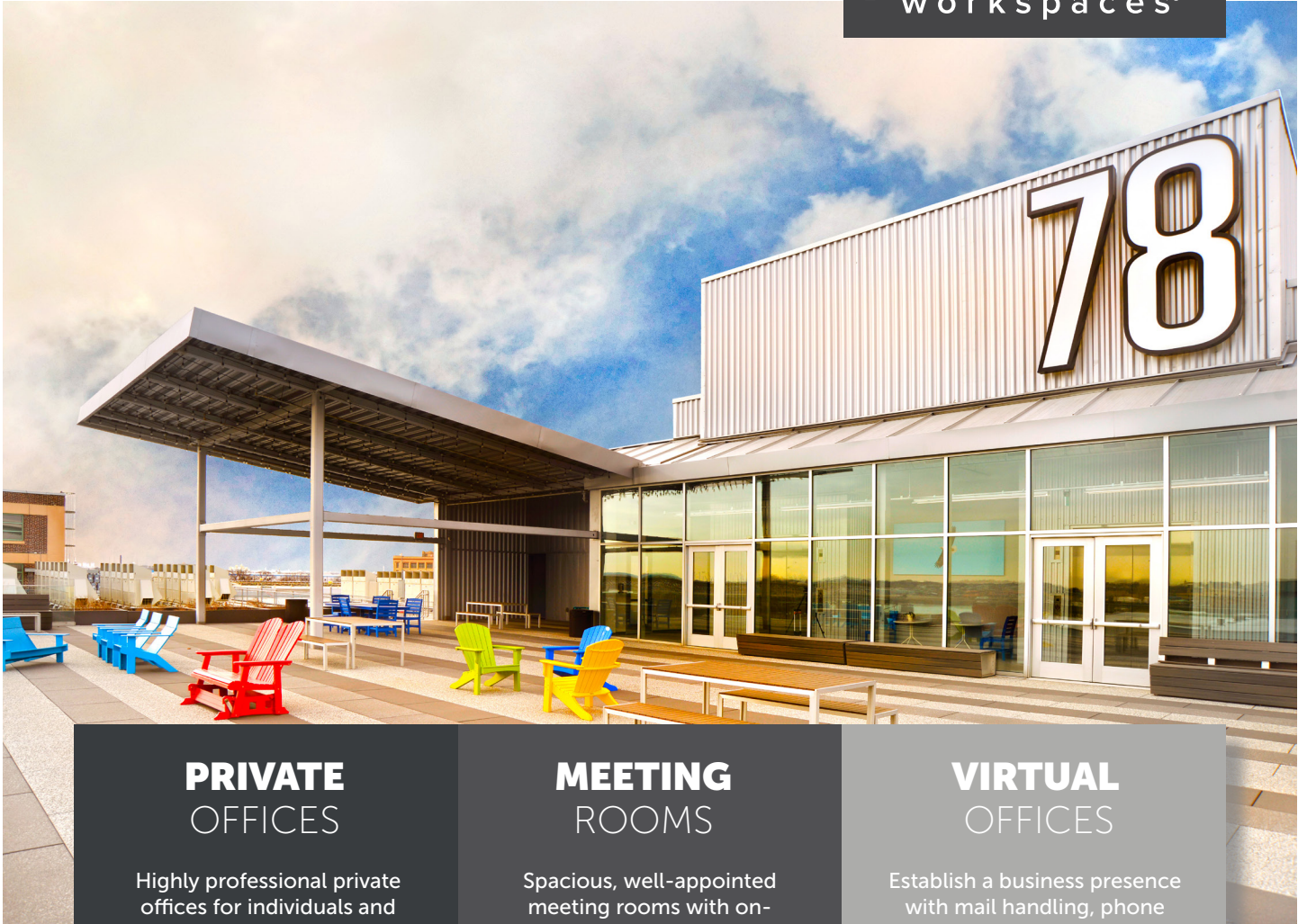

## PRIVATE OFFICES

Highly professional private offices for individuals and teams that are flexible and scaled for growth.

## MEETING ROOMS

Spacious, well-appointed meeting rooms with on-site administrative support. Available for an hour, day or longer.

## VIRTUAL OFFICES

Establish a business presence with mail handling, phone answering or meeting room time.

## ABOUT THIS LOCATION

Kearny Point has been reborn as a center for the pioneering companies of the new economy. It is a flexible, modern workplace, home to a diverse community of today's creators and is located in an Opportunity Zone that provides potential financial benefits, including Grow NJ and Kearny UEZ tax incentives and credits. Building 78's offices and rooftop terrace lounge offers views of the Hackensack River and the New York City skyline. With furnished office spaces, dedicated desks, and hot desks, this location provides everything you need to plug in and start running your business immediately.

## CONTACT US

Let's touch base! Contact the on-site General Manager at 973-510-0070 or [KPTmanager@premierworkspaces.com](mailto:KPTmanager@premierworkspaces.com) to schedule a tour.



# Kearny Point

78 John Miller Way, Suite 326 Kearny, NJ 070321



## PREMIER AMENITIES

Our private suites can be easily customized to fit your desired aesthetic and brand.

- Private Offices
- Team Rooms
- High Speed Internet
- Telephone Answering
- Mail Collection
- Equipped Kitchen
- Day Offices
- Meeting Rooms
- Daily Janitorial
- Furnished or Unfurnished

## PREMIER DIFFERENCE

We've been perfecting the professional workspace for over 20 years.

- Highly-Professional Atmosphere
- On-Site Manager & Support Staff
- Scalable Solutions for Individuals and Teams
- On-Site Billing
- 90+ Locations Nationwide

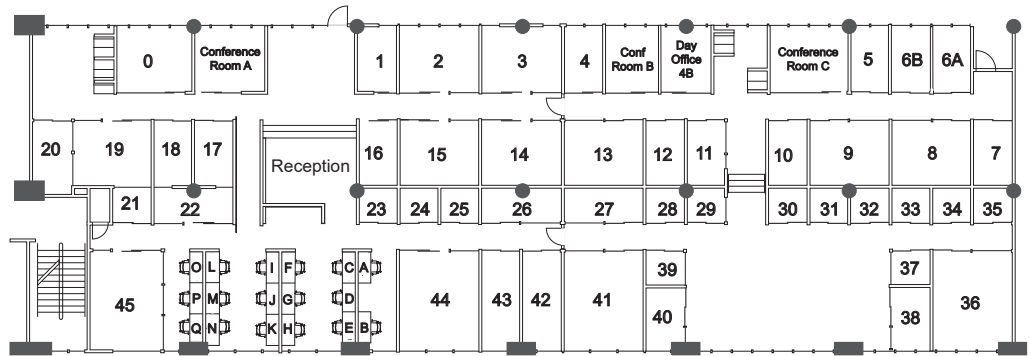

## NEARBY AMENITIES

Kearny Point has direct access to Manhattan, Port Elizabeth, Jersey City, NJ Turnpike, Newark, Hoboken, and the Lincoln/Holland Tunnel.

### Property Amenities:

- EV Car Charging
- Fitness Center
- On-Site Security
- On-Site Cafe
- Free Parking
- Rooftop Deck with 360° views

### Nearby Amenities:

- 15 minutes from Newark International Airport
- 10 minutes Newark Penn Station
- The Newark Museum of Art
- Branch Brook Park
- Newark Riverfront Park
- Dreyfuss Planetarium

## CONTACT US

Let's touch base! Contact the on-site General Manager at 973-510-0070 or [KPTmanager@premierworkspaces.com](mailto:KPTmanager@premierworkspaces.com) to schedule a tour.