

# Tontine

STUDIOS

GLASGOW



# Location

Set behind a historical facade fronting Trongate and following comprehensive refurbishment, the Tontine Building offers space suitable for pop-ups and start-ups to corporates and disrupters.

Tontine's location affords occupiers access to Glasgow's extensive transport network. Queen Street, High Street and Glasgow Central Train Stations are all within minutes' walk, while Buchanan Street Subway Station provides instant access to the West End and wider city. The prime position of the building is set to benefit from the Avenues Project and the ever evolving development of the east end.

# Accommodation

Tontine Studios is office accommodation located in the heart of Merchant City, providing a range of stylish, furnished suites, ready for immediate occupation with all-inclusive and flexible lease terms.

The studios provide contemporary accommodation with attractive exposed ceilings and suspended LED lighting with large attractive windows providing excellent levels of daylighting.

The studios benefit from informal breakout areas, co-working space, meeting rooms and shared kitchen facilities.

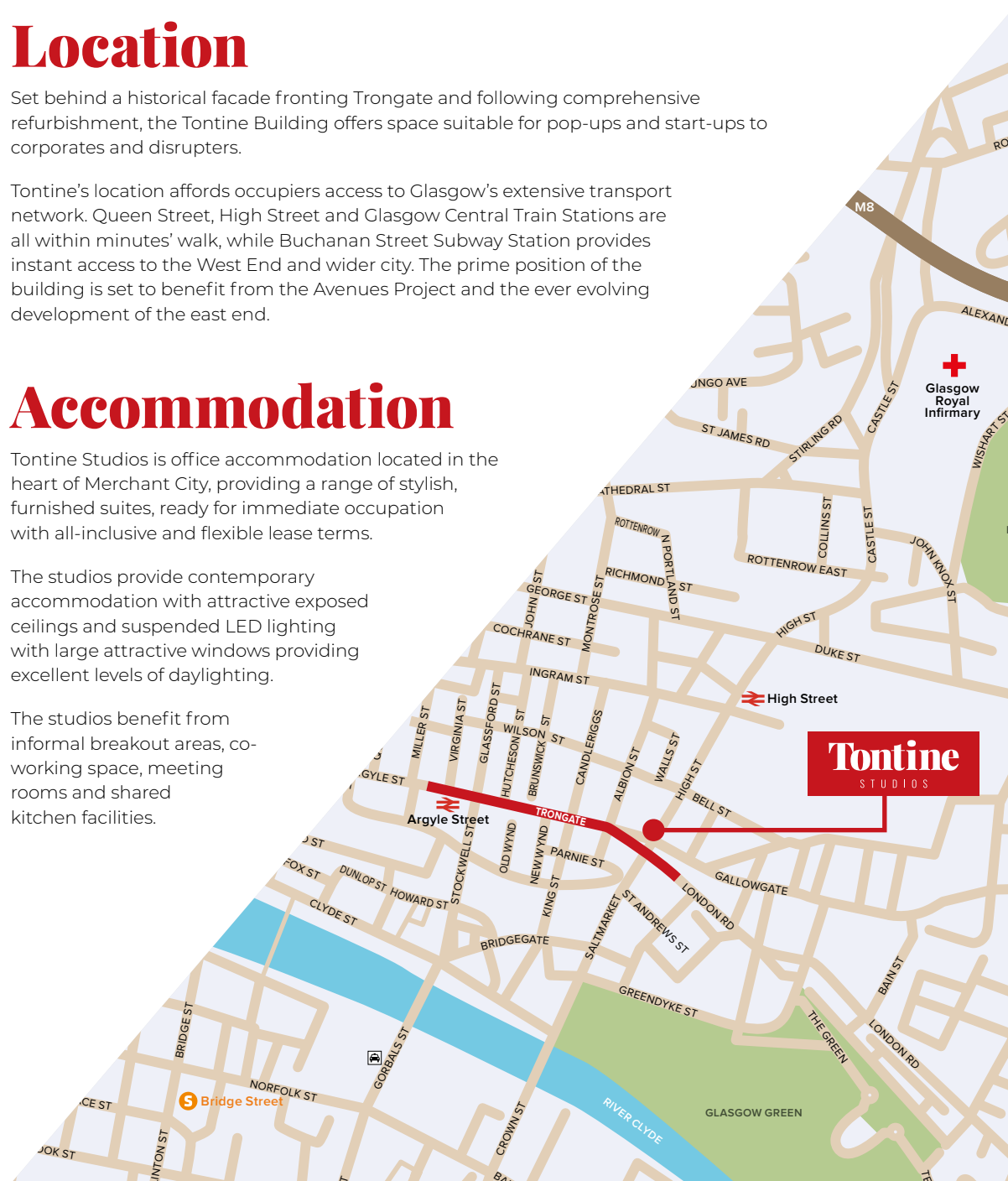

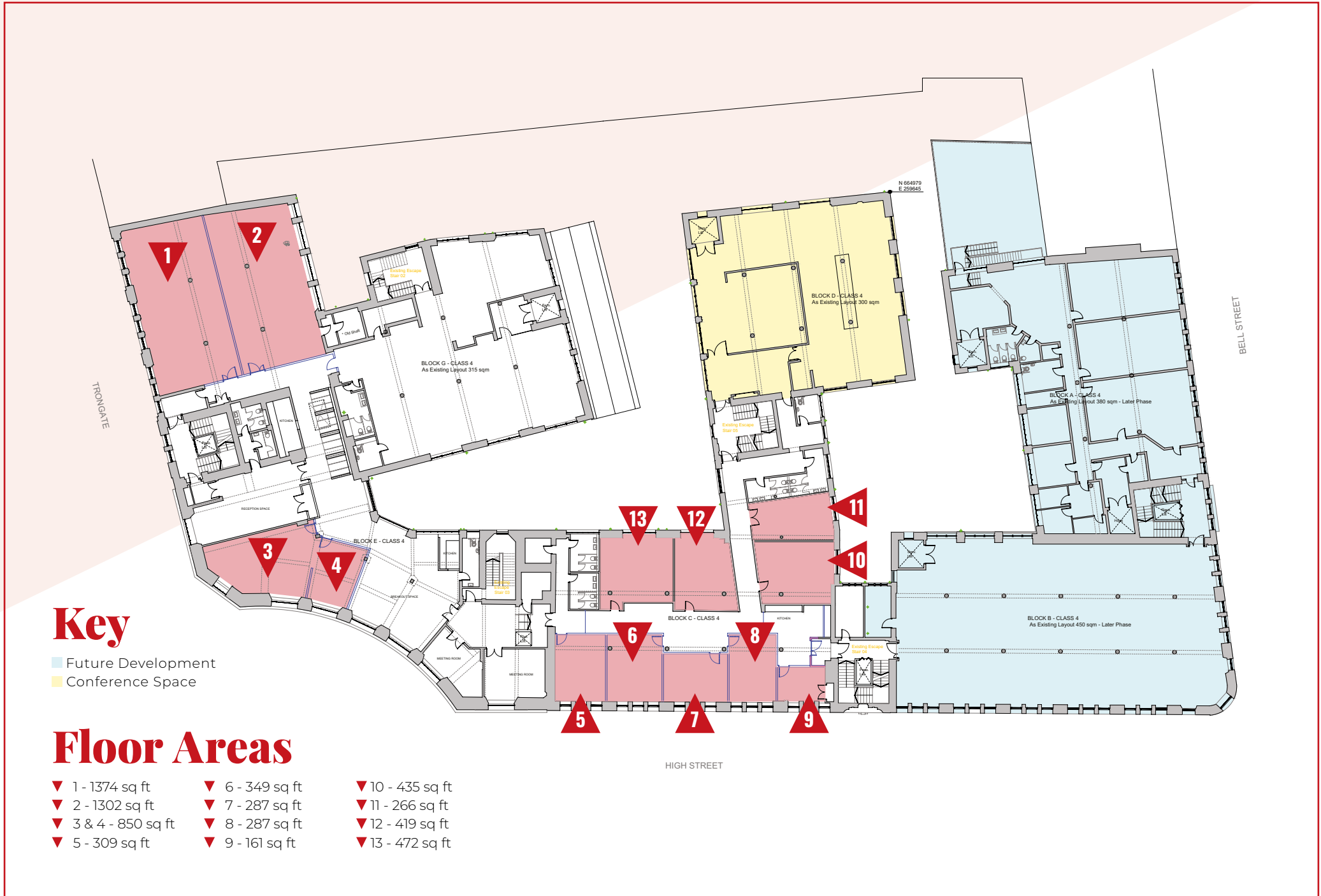

# Key

- Future Development
- Conference Space

# Floor Areas

- |                     |                 |                  |
|---------------------|-----------------|------------------|
| ▼ 1 - 1374 sq ft    | ▼ 6 - 349 sq ft | ▼ 10 - 435 sq ft |
| ▼ 2 - 1302 sq ft    | ▼ 7 - 287 sq ft | ▼ 11 - 266 sq ft |
| ▼ 3 & 4 - 850 sq ft | ▼ 8 - 287 sq ft | ▼ 12 - 419 sq ft |
| ▼ 5 - 309 sq ft     | ▼ 9 - 161 sq ft | ▼ 13 - 472 sq ft |

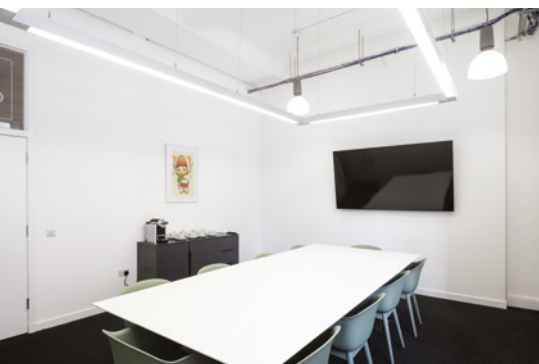

## General Info

### LEASE TERMS

Each floor is available on Full Repairing and Insuring Terms.

### VIEWING & FURTHER INFO

Strictly by prior arrangement with the joint letting agents.

**IMPORTANT NOTICE:** Ryden, CBRE for themselves and for the vendors or lessors of this property, whose agents they are, give notice that: (i) The particulars are set out as a general outline only for the guidance of intended purchasers or lessees and do not constitute, nor constitute part of, an offer or contract. (ii) All descriptions, dimensions, reference to condition and necessary permissions for use and occupation, and other details are given without responsibility and any intended purchasers or tenants should not rely on them as statement or representation of fact but must satisfy themselves by inspection or otherwise as to the correctness of each of them (iii) No person in the employment of Ryden or CBRE has any authority to make or give any representation or warranty whatever in relation to the property. (iv) All prices, premiums and rents quoted are exclusive of VAT. (v) The information contained in these particulars has been checked and, unless otherwise stated, it is understood to be materially correct at the date of publication. After these details have been printed, circumstances may change outside our control (vi) These particulars are provided for record purposes only and are not intended to create, nor to be relied upon as creating, any contractual relationship or commitment. Any contract shall only be entered into by way of our client's solicitors.

### VAT

All prices quoted are exclusive of VAT.

### EPC

A copy of the Energy Performance Certificate is available upon request.

**CBRE**

07880 455 948  
stefanie.tucker@cbre.com  
[www.cbre.co.uk](http://www.cbre.co.uk)

**Ryden**

07884 262 217  
holly.boyd@ryden.co.uk  
[www.ryden.co.uk](http://www.ryden.co.uk)