



THE CROSSROADS AT SHEPHERD RANCH

9525 N. Sommerville Drive Fresno, CA

AVAILABLE FOR LEASE

For information, please contact:

Kelsey McKenney
Retail California
t 559-447-6218
kelsey@retailcalifornia.com
CA RE Lic. #02217573

Coryne McKenney
Newmark Pearson Commercial
t 559-447-6239
cmckenney@pearsonrealty.com
CA RE Lic. #02200479

Troy A. McKenney
Newmark Pearson Commercial
t 559-447-6277
tmckenney@pearsonrealty.com
CA RE Lic. #00952671

Independently Owned and Operated

Corporate License #00020875

retailcalifornia.com

newmarkpearson.com

mckenneyinvestmentproperties.com



NEWMARK
PEARSON COMMERCIAL

MCKENNEY
Investment Properties

The distributor of this communication is performing acts for which a real estate license is required. The information contained herein has been obtained from sources deemed reliable but has not been verified and no guarantee, warranty or representation, either express or implied, is made with respect to such information. Terms of sale or lease and availability are subject to change or withdrawal without notice.

9525 N. SOMMERVILLE DRIVE - FRESNO, CA

HIGHLIGHTS

- 1,340± SF Available
 - Excellent Access & Street Visibility
 - Estimated Average Household Income: \$128,000 Within 1 Mile Radius
 - 2019 Estimated Population: 85,793 Within 3 Mile Radius
- Source: Claritas (2019)*

LOCATION DESCRIPTION

The property is located at the northwest corner of Sommersville Drive & Perrin Avenue in northeast Fresno, one of Fresno's most prominent neighborhoods. The shopping center benefits the surrounding neighborhood with many needed services in one convenient location.

ANCHORED BY



The distributor of this communication is performing acts for which a real estate license is required. The information contained herein has been obtained from sources deemed reliable but has not been verified and no guarantee, warranty or representation, either express or implied, is made with respect to such information. Terms of sale or lease and availability are subject to change or withdrawal without notice.

9525 N. SOMMERVILLE DRIVE - FRESNO, CA

Shopping Center Site Plan & Tenants

AVAILABILITY DETAILS

Suite 113 - 1,340± SF (*Dental Office*)

This space is improved as a dental office (*See Attached Floor Plan*)

9505 N. Sommerville Drive

- #1 - Starbucks Coffee Co.
- #2 - All American Barbershop
- #3 - 9 Round Kickboxing
- #4 - EECU ATM

9515 N. Sommerville Drive

- #5 - EECU Bank

9525 N. Sommerville Drive

- #101 - Ranchero's Mex. Rest.
- #103 - Habitat Hair Studio
- #104 - Juice Time
- #105 - The Grazing Table
- #107 - Milan Nail Salon
- #109 - The Little Gym
- #111 - Pizza 64
- #113 - Available**
- #115 - Liv's Donuts
- #117 - Kumon Learning Center
- #119 - Club Cleaners

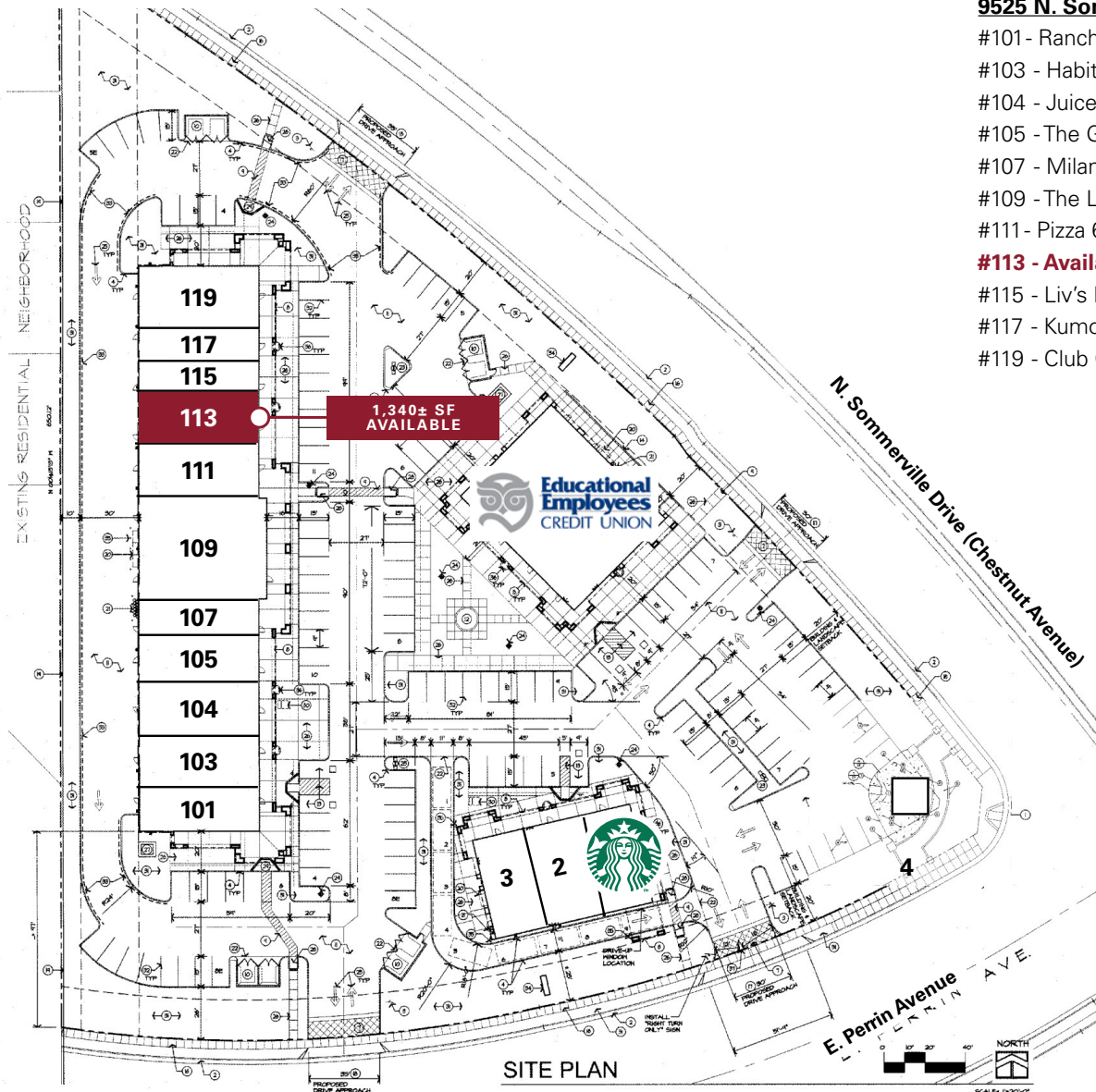

**Note: Available with 30 Days Notice to Tenant*



The distributor of this communication is performing acts for which a real estate license is required. The information contained herein has been obtained from sources deemed reliable but has not been verified and no guarantee, warranty or representation, either express or implied, is made with respect to such information. Terms of sale or lease and availability are subject to change or withdrawal without notice.

Floor Plan (Not to Scale)

Suite 113 - 1,340± SF (Dental Office)

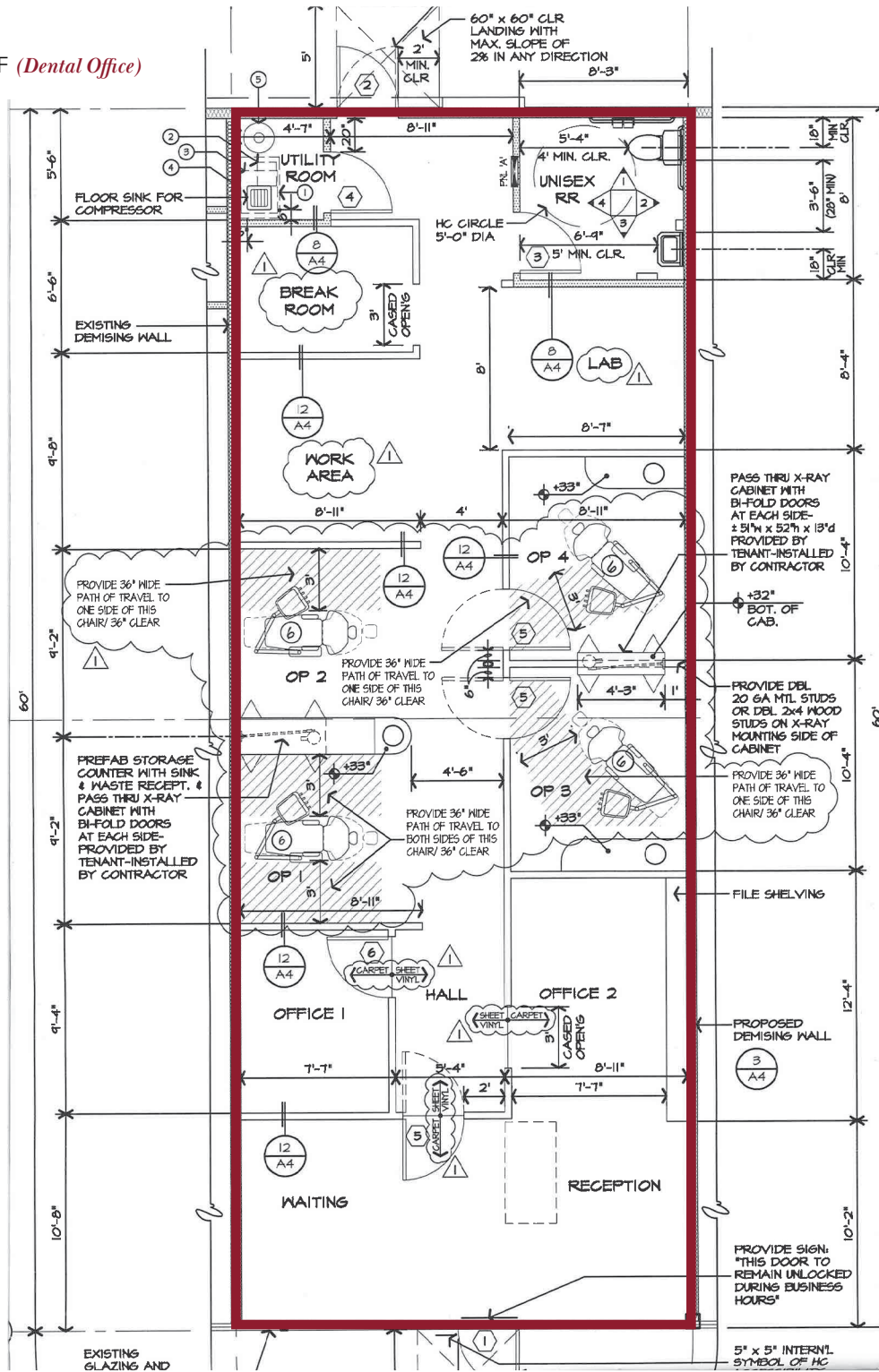



EXCLUSIVELY OFFERED BY:

Kelsey McKenney

Retail California

t 559-447-6218

kelsey@retailcalifornia.com

CA RE Lic. #02217573

Coryne McKenney

Newmark Pearson Commercial

t 559-447-6239

cmckenney@pearsonrealty.com

CA RE Lic. #02200479

Troy A. McKenney

Newmark Pearson Commercial

t 559-447-6277

tmckenney@pearsonrealty.com

CA RE Lic. #00952671



The distributor of this communication is performing acts for which a real estate license is required. The information contained herein has been obtained from sources deemed reliable but has not been verified and no guarantee, warranty or representation, either express or implied, is made with respect to such information. Terms of sale or lease and availability are subject to change or withdrawal without notice.