



Extremely Rare Opportunity
for Lease with Secure Yard & Docks

For Lease

2855 Mandela Parkway Oakland, CA 94608

Contact:

Greig Lagomarsino, SIOR

+1 510 433 5809
greig.lago@colliers.com
CA License No. 01063817

Nick Ousman, SIOR

+1 510 433 5820
nick.ousman@colliers.com
CA License No. 01908981

Chris Stauber

+1 510 287 3121
chris.stauber@colliers.com
CA License No. 02167419

John Lagomarsino

+1 510 433 5843
john.lago@colliers.com
CA Lic. No. 02348024

±51,754 SF Manufacturing/Industrial Space w/ Yard

- ±51,754 SF Manufacturing/Industrial Space Potentially Divisible (±10k, ±11k and ±18k SF)
- ±34,441 SF Yard
- Newly Paved Yard - Fenced and Secured
- 3 Grade Level Doors
- 3 Dock High Doors
- 15' To Bow Truss, 24' To Roof
- 20' x 70' Column Spacing
- Heavy Power
- Fully Sprinklered
- Skylights Throughout
- Motion Sensor Lighting
- Partially Insulated
- Off Street Parking
- Drive Through Access
- Location Provides Immediate Access to the Bay Bridge and the Port of Oakland
- Minutes from San Francisco

Asking Rate - \$0.99 NNN (\$0.19 operating expenses)



BALCO
PROPERTIES



Site Plan

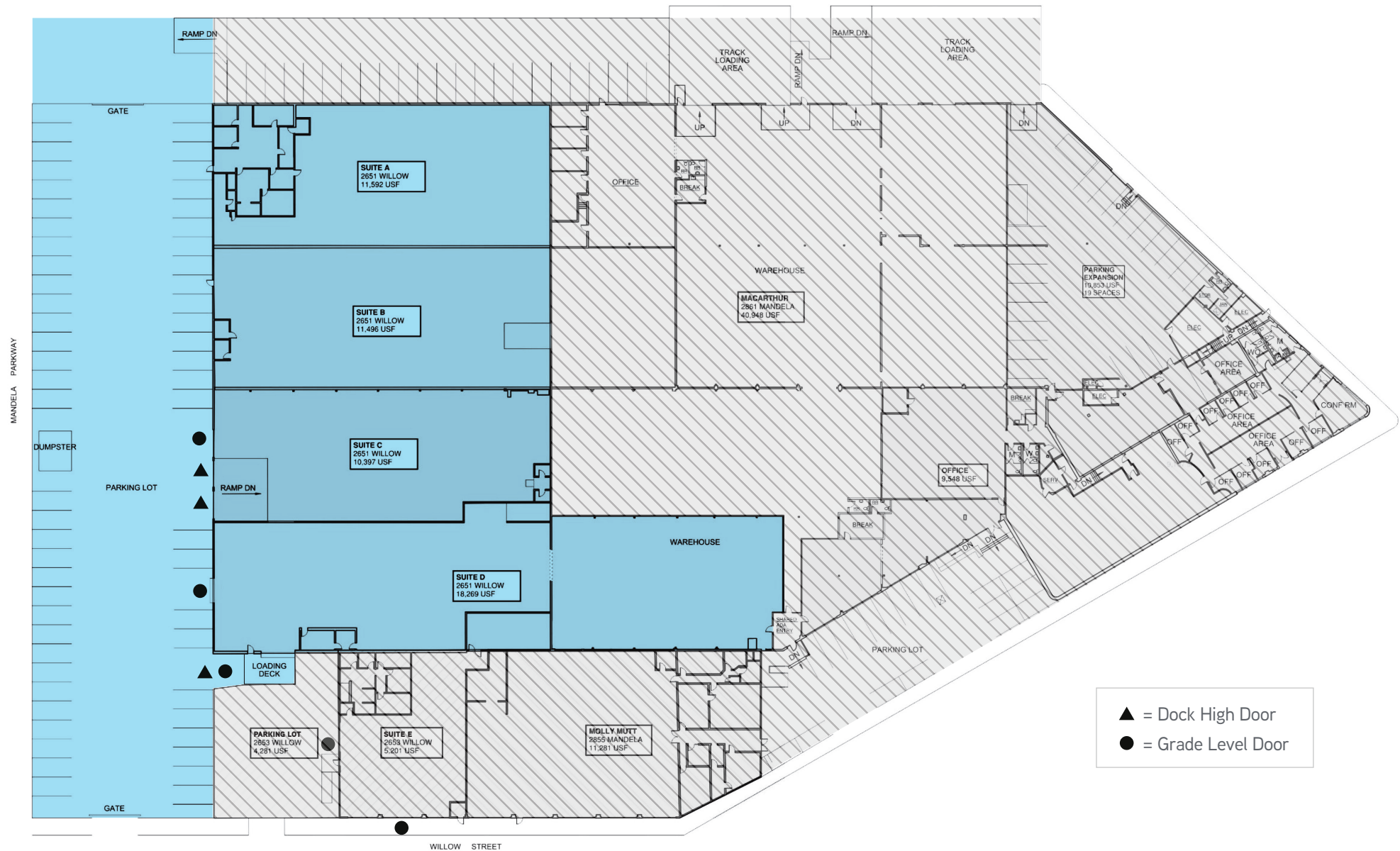

This document/email has been prepared by Colliers for advertising and general information only. Colliers makes no guarantees, representations or warranties of any kind, expressed or implied, regarding the information including, but not limited to, warranties of content, accuracy and reliability. Any interested party should undertake their own inquiries as to the accuracy of the information. Colliers excludes unequivocally all inferred or implied terms, conditions and warranties arising out of this document and excludes all liability for loss and damages arising there from. This publication is the copyrighted property of Colliers and /or its licensor(s). © 2026. All rights reserved. This communication is not intended to cause or induce breach of an existing listing agreement. Colliers International Group Inc.

2855 Mandela Parkway | Oakland

Colliers

Photo Gallery

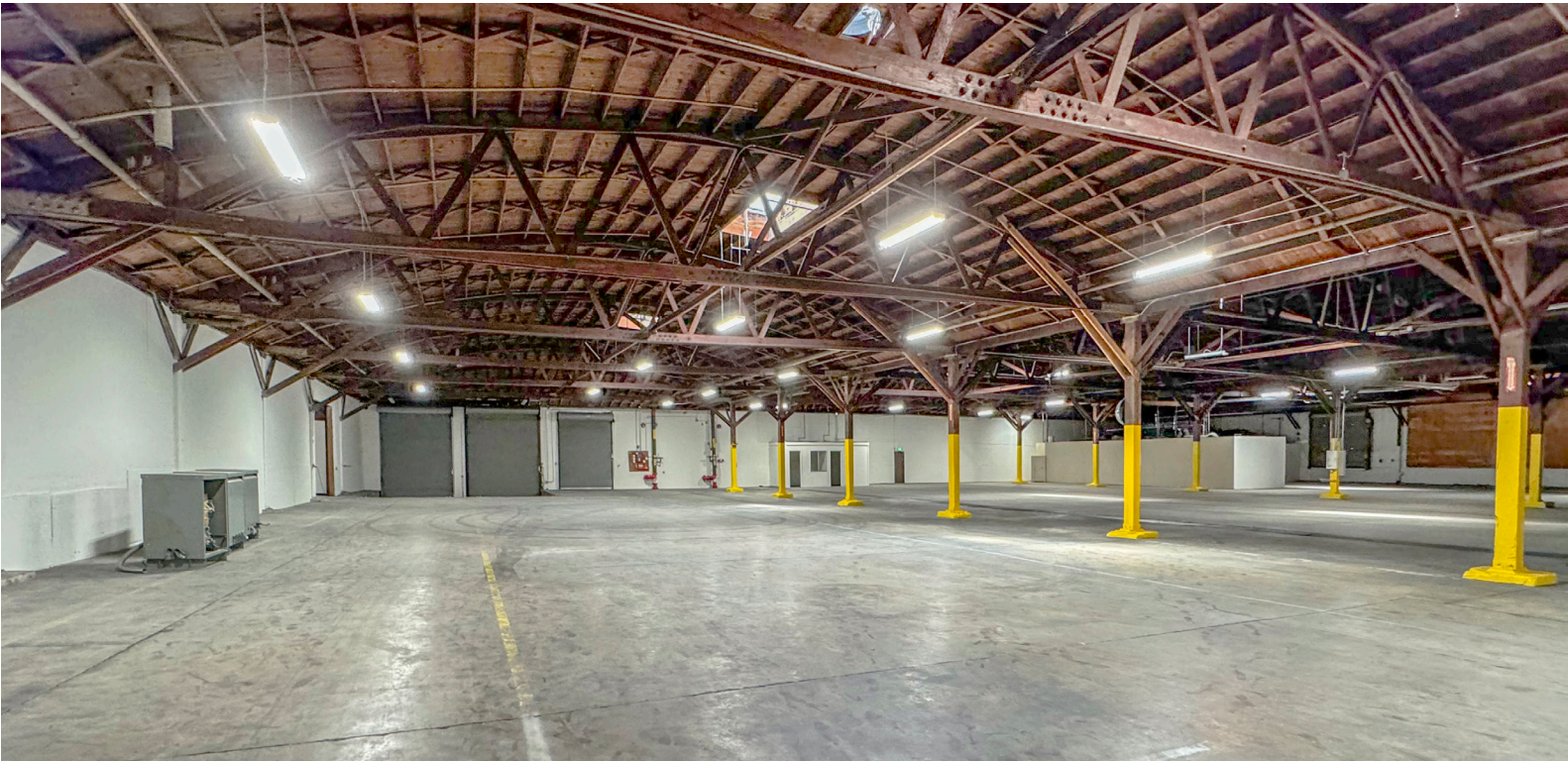

This document/email has been prepared by Colliers for advertising and general information only. Colliers makes no guarantees, representations or warranties of any kind, expressed or implied, regarding the information including, but not limited to, warranties of content, accuracy and reliability. Any interested party should undertake their own inquiries as to the accuracy of the information. Colliers excludes unequivocally all inferred or implied terms, conditions and warranties arising out of this document and excludes all liability for loss and damages arising there from. This publication is the copyrighted property of Colliers and /or its licensor(s). © 2026. All rights reserved. This communication is not intended to cause or induce breach of an existing listing agreement. Colliers International Group Inc.

Region

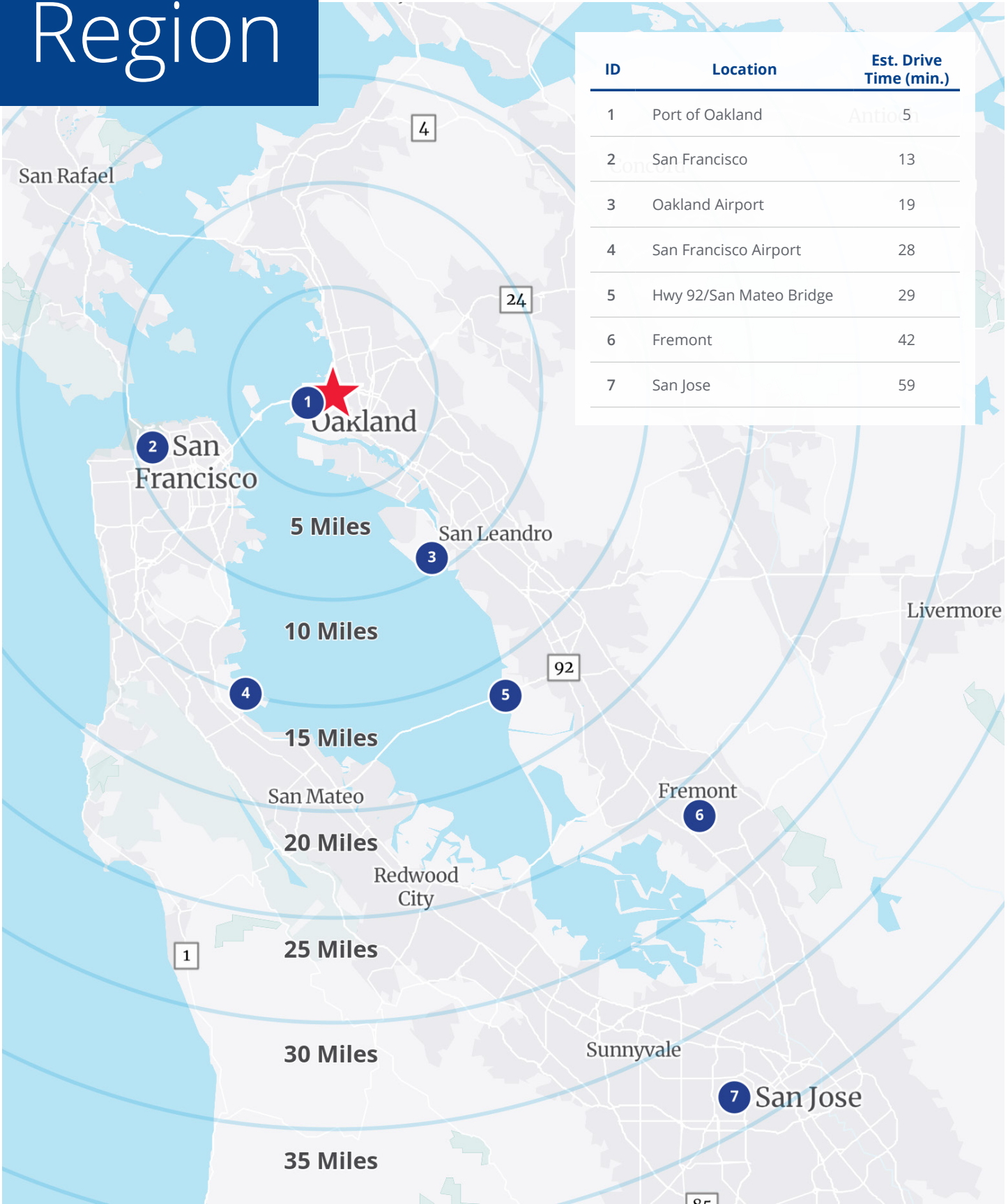



Colliers

2855 Mandela Pkwy

For Lease

Contact us:

Greig F. Lagomarsino, SIOR

Vice Chairman
+1 510 433 5809
greig.lago@colliers.com
CA Lic. No. 01063817

Nick Ousman, SIOR

Executive Vice President
+1 510 433 5820
nick.ousman@colliers.com
CA Lic. No. 01908981

Chris Stauber

Associate
+1 510 287 3121
chris.stauber@colliers.com
CA Lic. No. 02167419

John Lagomarsino

Associate
+1 510 433 5843
john.lago@colliers.com
CA Lic. No. 02348024



This document has been prepared by Colliers International for advertising and general information only. Colliers International makes no guarantees, representations or warranties of any kind, expressed or implied, regarding the information including, but not limited to, warranties of content, accuracy and reliability. Any interested party should undertake their own inquiries as to the accuracy of the information. Colliers International excludes unequivocally all inferred or implied terms, conditions and warranties arising out of this document and excludes all liability for loss and damages arising there from. This publication is the copyrighted property of Colliers International and/or its licensor(s). ©2026. All rights reserved.

Accelerating success.