

The Conrad Group, Inc.

Commercial Real Estate Services

**67 Sharp St
Hingham, MA**
FOR LEASE



Unit 1-4: 25,600_±SF
Unit 8-10: 15,600 _±SF

Disclaimer: All information is from sources deemed reliable, however no representation is made as to its accuracy and same is subject to prior sale, rental or removal from the market without notice.

FOR ADDITIONAL INFORMATION:

James McEvoy
(781) 249-9225

jhmcevoy@earthlink.net

Floor Plan - 67 Sharp St

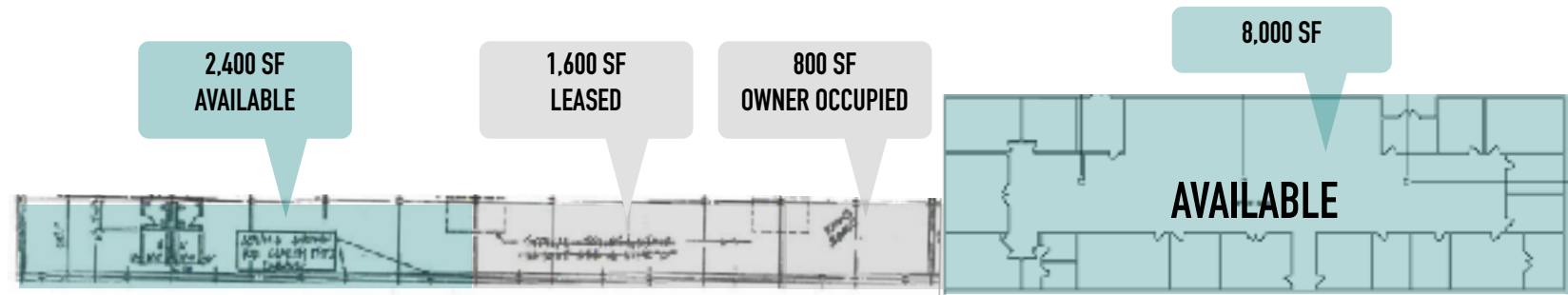
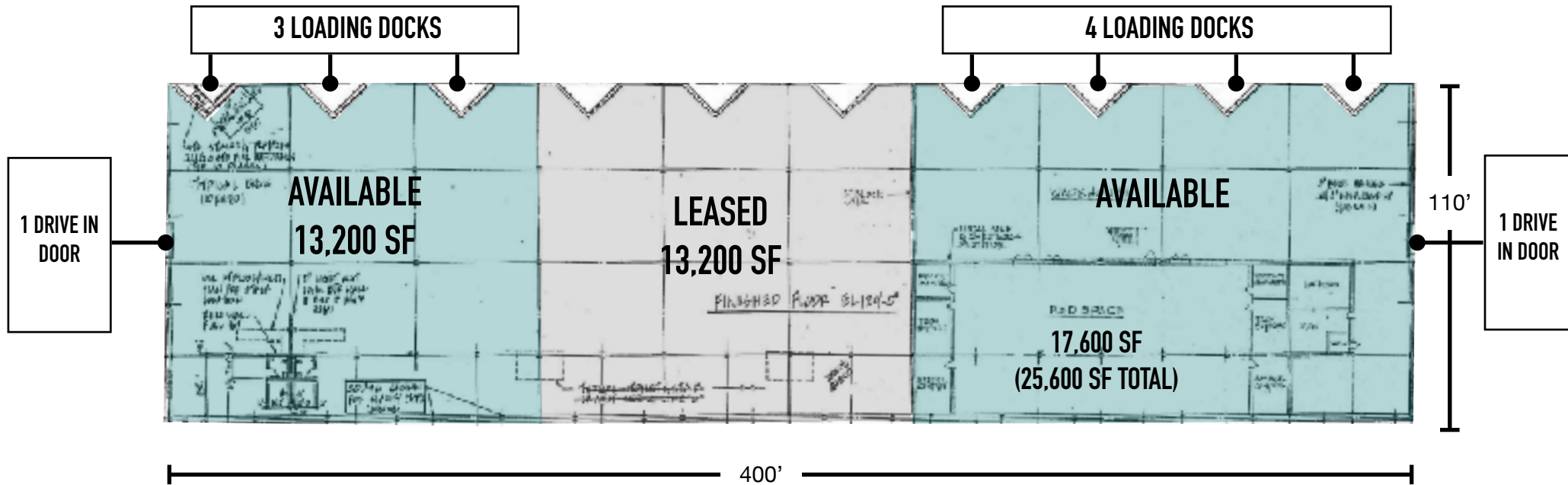

Total Building Size	56,800 \pmSF
Zoning	Industrial Park
Space Available	<u>Units 1-4</u> 25,600 \pmSF Office: 8,000 \pm SF Warehouse: 17,600 \pm SF <u>Units 8-10</u> 15,600 \pmSF Office: 2,400 \pm SF Warehouse: 13,200 \pm SF
Ceiling Height	24' Clear
HVAC	A/C in office area; gas heat
Loading	3 Docks 1 Drive-In
Sprinklers	Wet Pipe Throughout
RE Taxes	\$.80/SF (FY 2025)



Warehouse



Office



18

Union St



Liberty St

Sharp St

3

Weymouth St



The Conrad Group, Inc.

Commercial Real Estate Services

James McEvoy

(781) 249-9225

jhmcevoy@earthlink.net