

# FOR LEASE

6849 DUBLIN BOULEVARD, DUBLIN, CA

## NEW TENANT ANNOUNCEMENT!!



ONLY ONE  
SPACE LEFT!!



### DETAILS:



4,781 SF AVAILABLE



DUBLIN BLVD 30,000 ADT

JESSICA MAUSER

LIC.ID #01728720

jmauser@lee-associates.com

925.737.4168

SEAN OFFERS, SIOR

LIC.ID #01858116

soffers@lee-associates.com

925.737.4159

 **LEE &  
ASSOCIATES**  
COMMERCIAL REAL ESTATE SERVICES

**LEE  
RETAIL**  
LEE & ASSOCIATES

# FOR LEASE - 6849 DUBLIN BOULEVARD, DUBLIN, CA

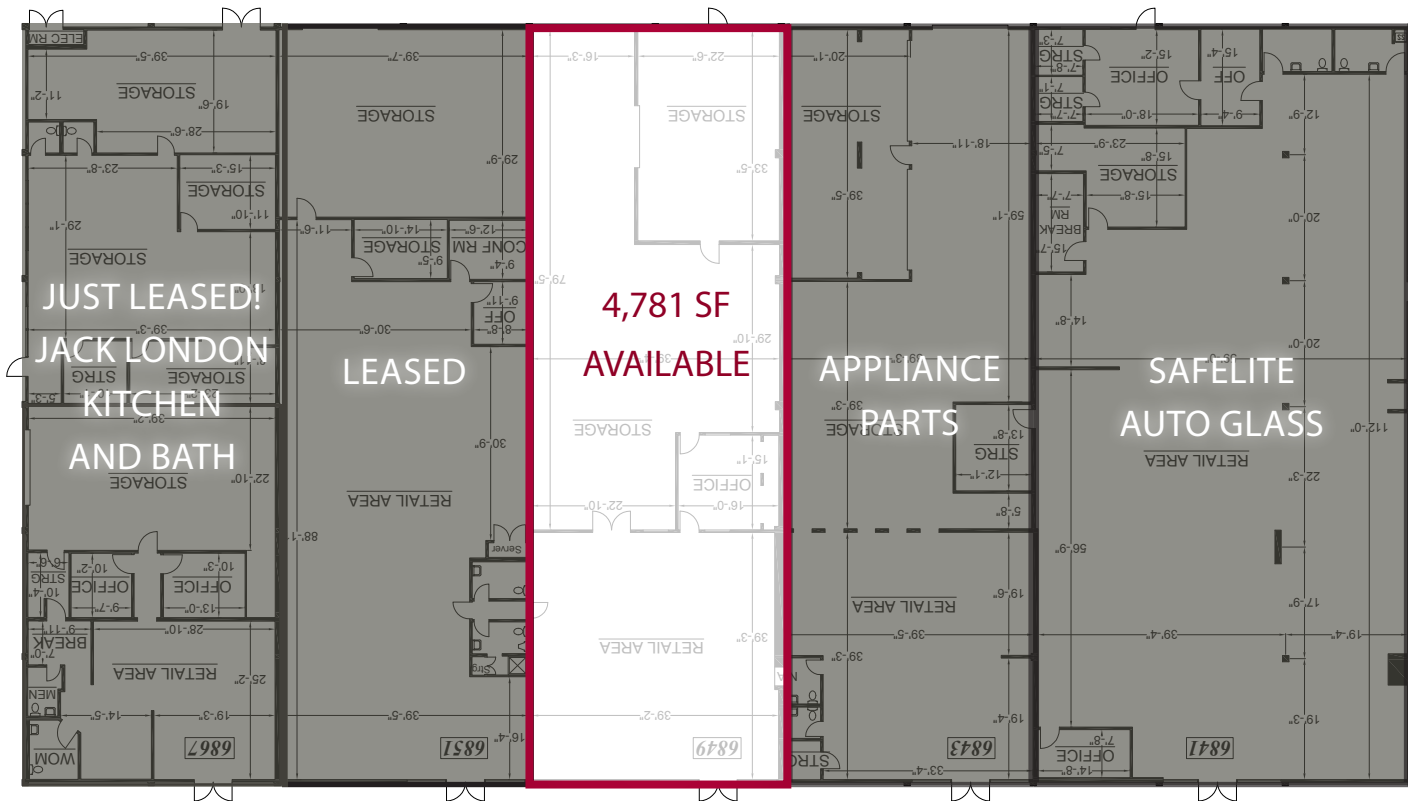

DUBLIN BLVD.

## LOCATION HIGHLIGHTS

- Retail with Warehouse in Central Dublin
- Great visibility on Dublin Boulevard near the I-580, I-680 interchange
- Across from Dublin City Hall, Public Library and Dublin Sports Ground
- Surrounded by densely populated neighborhoods and retail
- Potential uses: Industrial and Service Commercial

## PROPERTY HIGHLIGHTS

- 4,781 SF available w/grade level roll up doors
- 14-16' clear height
- New Seismic retrofits
- New Fire Sprinkler System
- New exterior upgrades: paint and channel lettering signage

**Asking: \$2.55/SF Modified Gross**

# FOR LEASE - 6849 DUBLIN BOULEVARD, DUBLIN, CA



## FLOOR PLAN

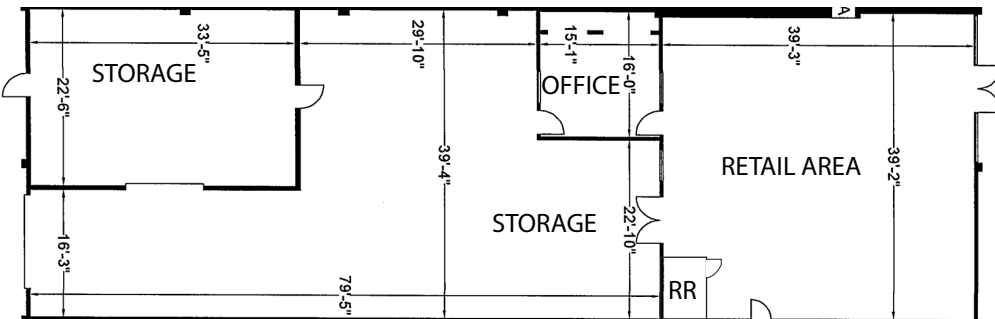

All information furnished regarding property for sale, rental or financing is from sources deemed reliable, but no warranty or representation is made to the accuracy thereof and same is submitted to errors, omissions, change of price, rental or other conditions prior to sale, lease or financing or withdrawal without notice. No liability of any kind is to be imposed on the broker herein.

# FOR LEASE - 6849 DUBLIN BOULEVARD, DUBLIN, CA

## DEMOGRAPHICS

	1 MILE	3 MILE	5 MILE
DAYTIME POPULATION	23,739	65,269	111,565
POPULATION	9,937	97,052	187,751
AVERAGE HH INCOME	\$117,864	\$150,642	\$161,695

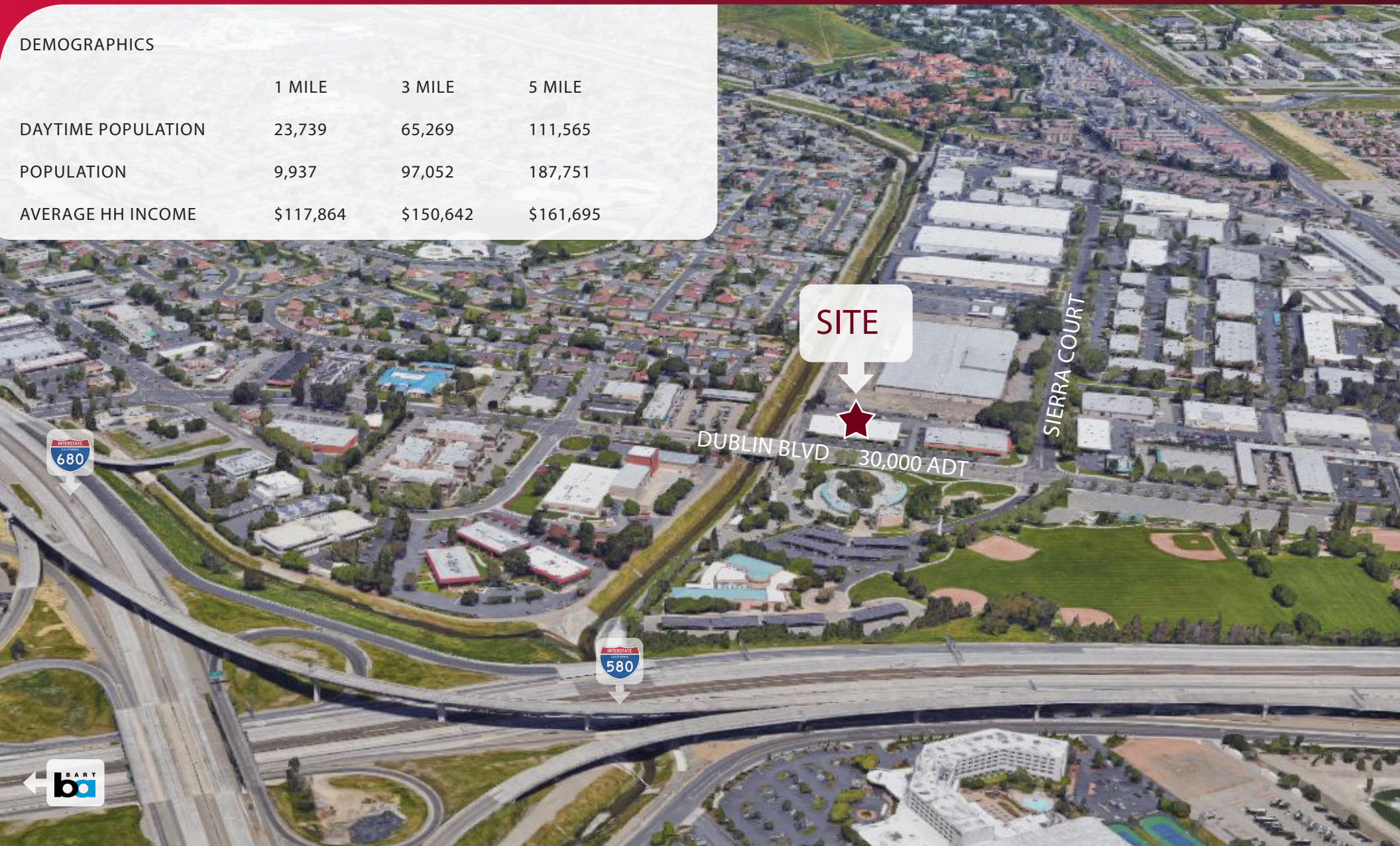

JESSICA MAUSER  
LIC.ID #01728720  
jmauser@lee-associates.com  
925.737.4168

SEAN OFFERS, SIOR  
LIC.ID #01858116  
soffers@lee-associates.com  
925.737.4159

**LEE & ASSOCIATES**  
COMMERCIAL REAL ESTATE SERVICES

**LEE RETAIL**  
LEE & ASSOCIATES