

As exclusive agents, we are pleased to offer the following prime space for sublease:

245 FIFTH AVENUE

JUSTIN MYERS

Exec. Managing Director | Principal
O: 212.776.1281 / M: 619.840.7360
jmyers@lee-associates.com

DENNIS SOMECK

Exec. Managing Director | Principal
O: 212.776.1270 / M: 917.653.1177
dsomeck@lee-associates.com

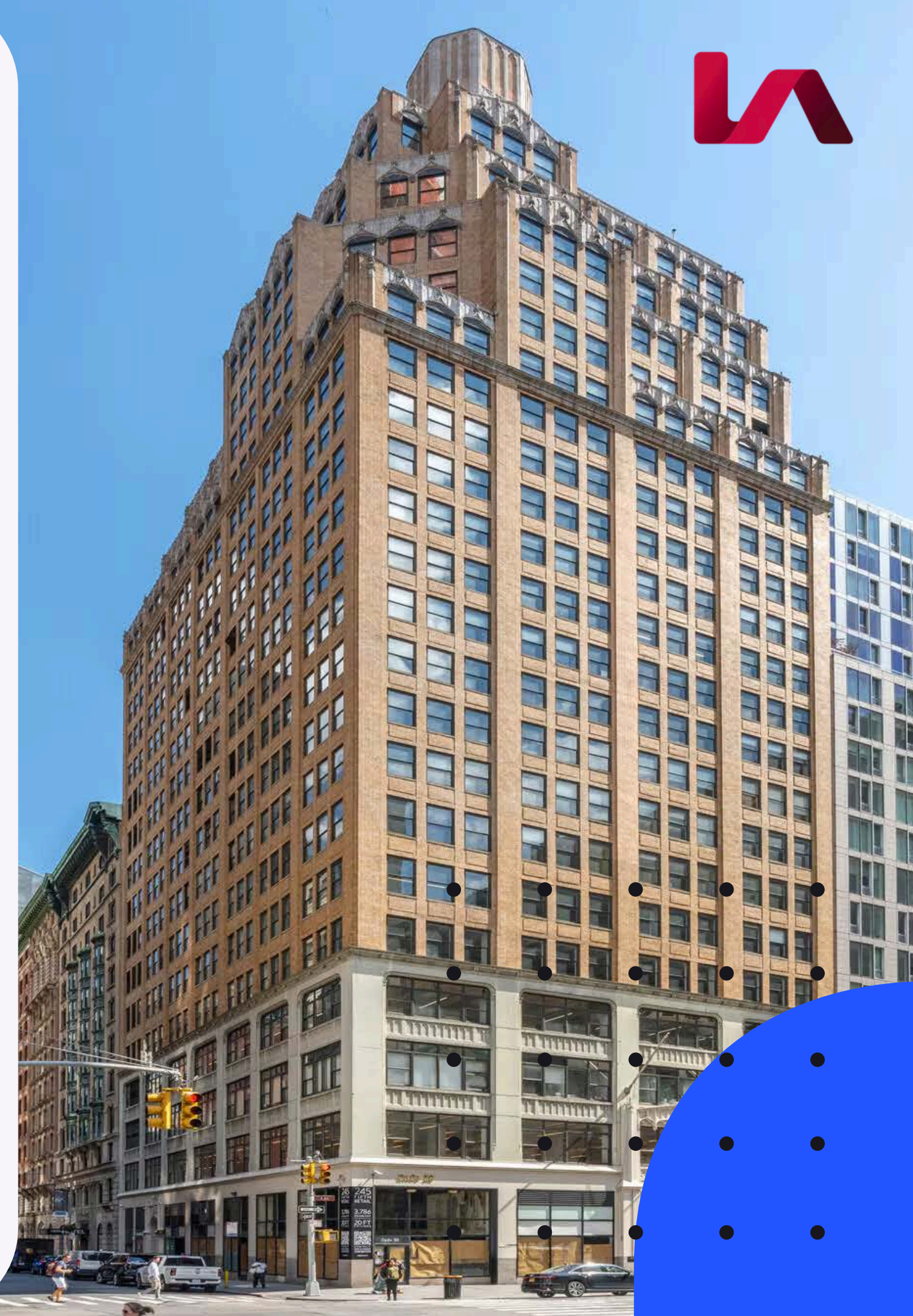

THE SPACE

Entire 17th floor | 13,627 RSF

Sublease through July 30, 2030

Great light and views

73 sit/stand desks

6 breakout rooms + 2 large conference rooms

Immediate possession

Inquire for pricing



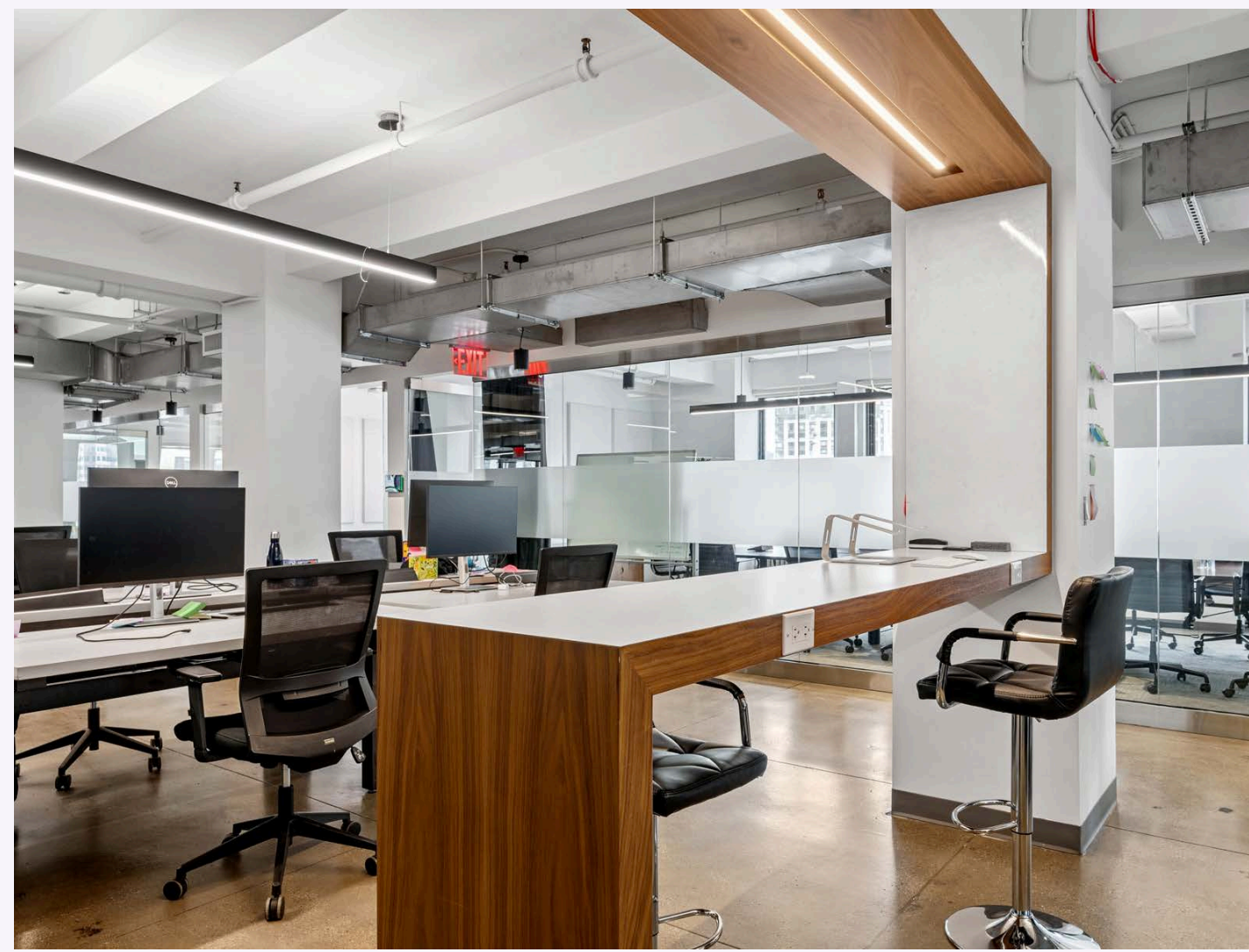
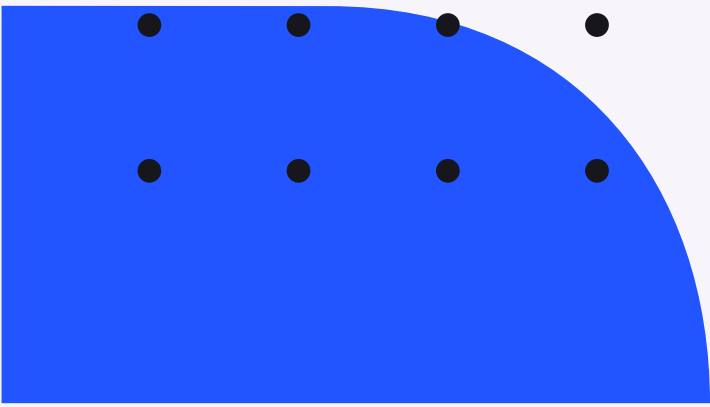
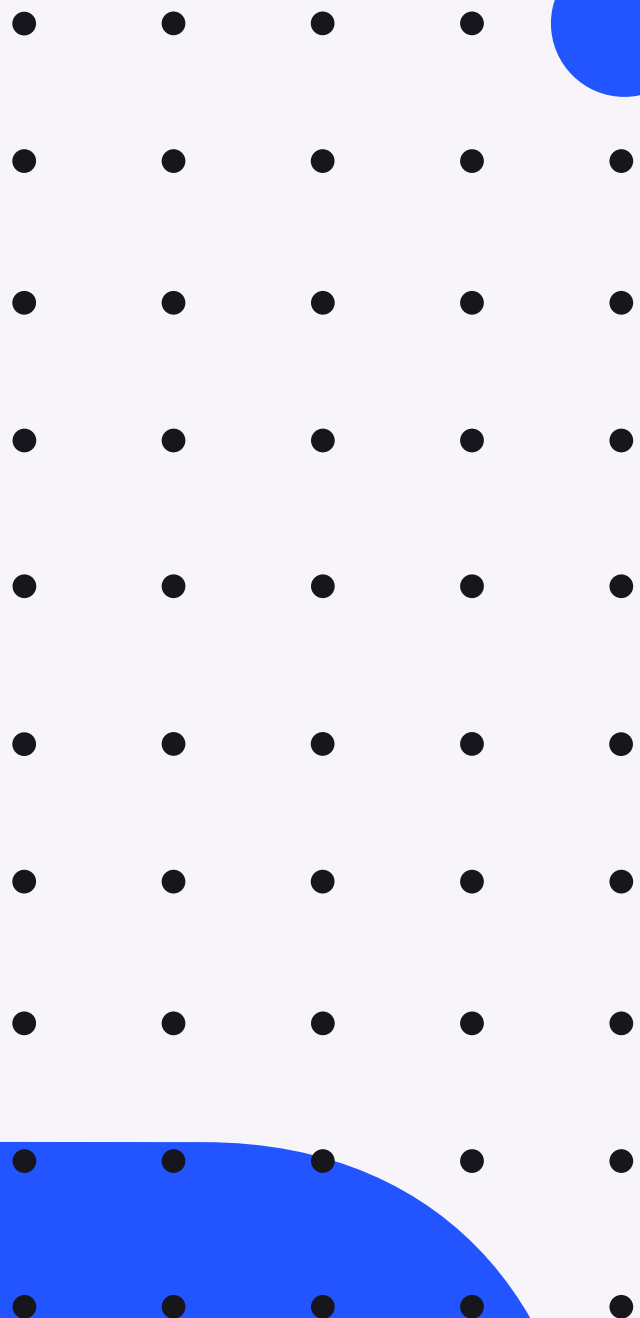

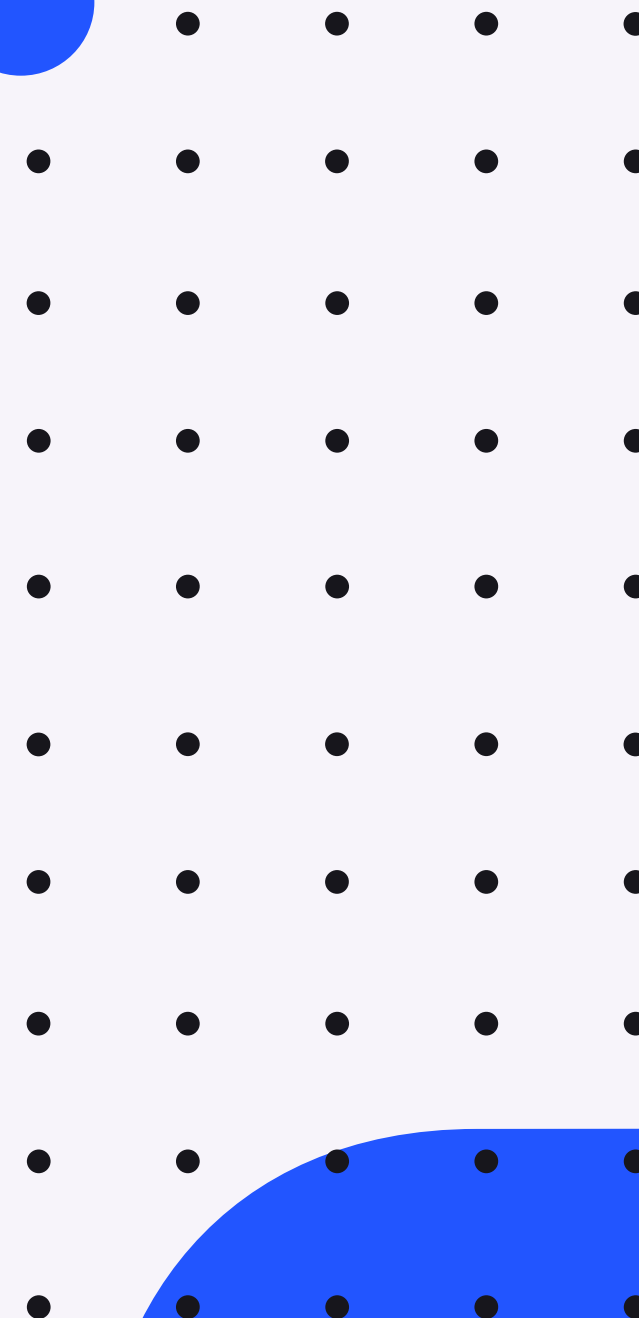

Floor Plan + Virtual Tour

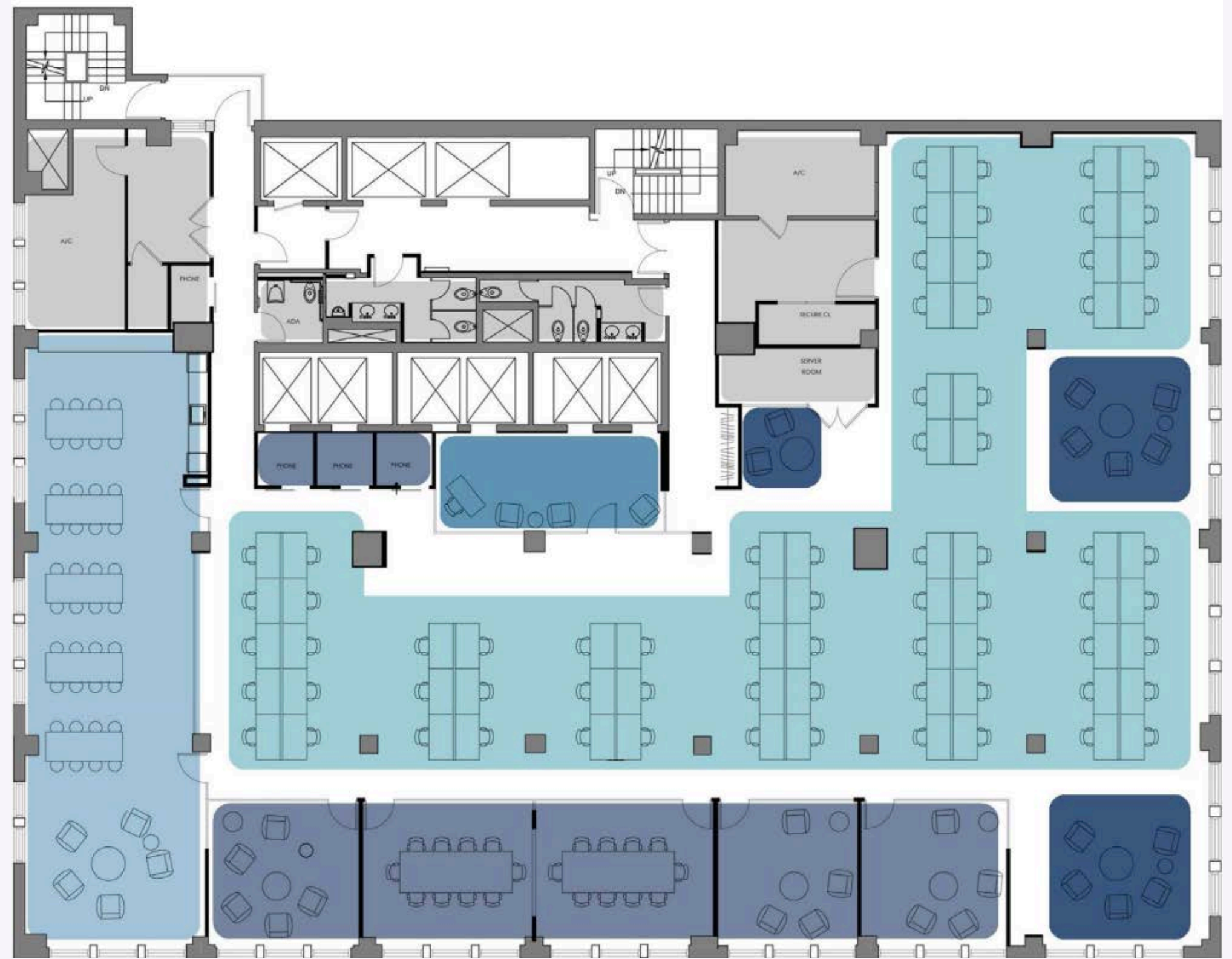
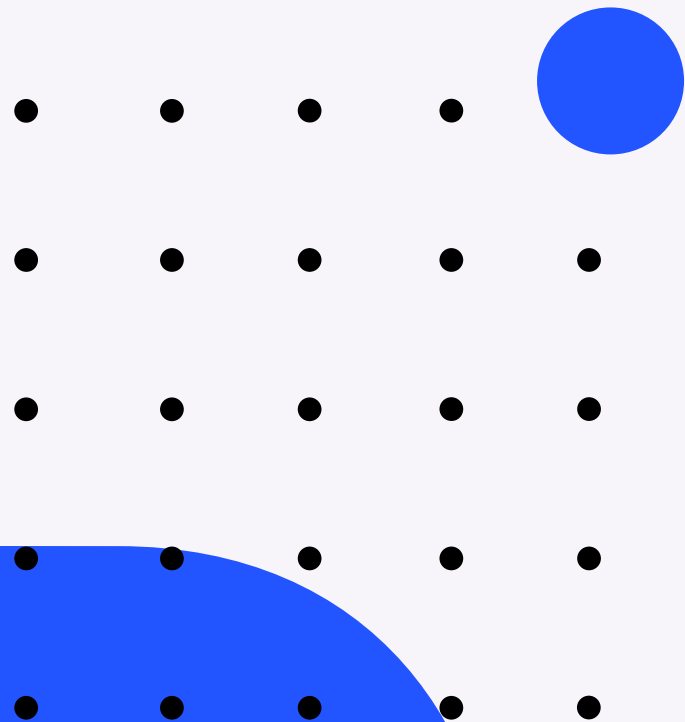

[click for virtual tour](#)

For more information, please **contact:**

JUSTIN MYERS

Exec. Managing Director | Principal
O: 212.776.1281 / M: 619.840.7360
jmyers@lee-associates.com

DENNIS SOMECK

Exec. Managing Director | Principal
O: 212.776.1270 / M: 917.653.1177
dsomeck@lee-associates.com

All information supplied is from sources deemed reliable and is furnished subject to errors, omissions, modifications, removal of the listing from sale or lease, and to any listing conditions, including the rates and manner of payment of commissions for particular offerings imposed by principals or agreed by this Company, the terms of which are available to principals or duly licensed brokers. Any square footage dimensions set forth are approximate.

