

# WAREHOUSE/WORKSHOP PREMISES - TO LET

Unit 14c, Jubilee Estate, Gorsey Lane, Coleshill, Birmingham, B46 1JU

2,862 SqFt (265.88 SqM) | £25,500 per annum exclusive

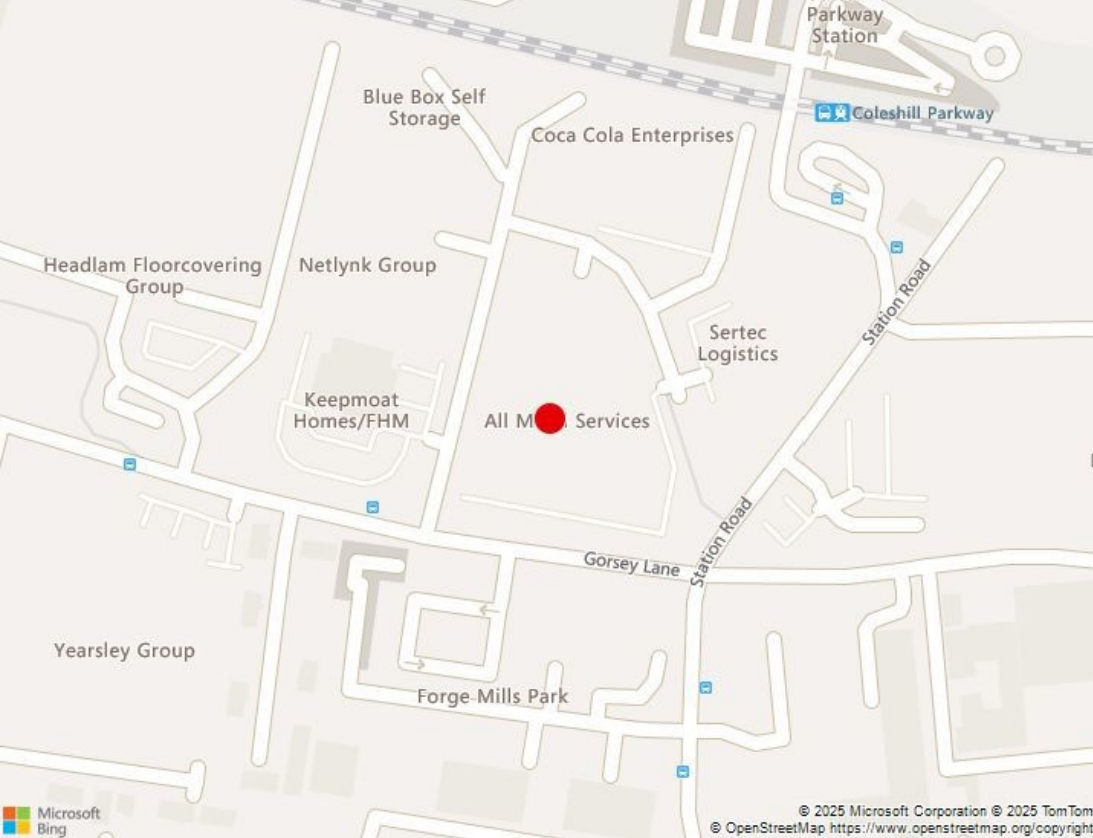



## KEY FEATURES

- Popular Industrial Estate
- On site parking
- Within driving distance of M42, M6 & M6 Toll Road
- Secure gated entrance
- Level loading access
- New Lease

## LOCATION

The subject property is situated within Jubilee Estate off Gorsey Lane in Coleshill. Gorsey Lane has nearby access from the traffic light controlled junction with Station Road and is within short driving distance of A446 which leads directly to both Junction 9 of the M42 Motorway and Junction 4 of the M6 together with the M6 Toll Road. Coleshill Parkway Railway Station is within walking distance and The National Exhibition Centre, Birmingham International Airport and Birmingham International Railway Station are all within 10 minute drive.

## DESCRIPTION

The subject property comprises a warehouse/industrial building which is situated within Jubilee Estate in Coleshill. The premises extend to provide predominantly warehouse accommodation with WC/changing room facilities. The main warehouse includes a roller shutter door to the front elevation with access from a shared courtyard. The location is within easy reach of the M42 Motorway at Junction 9 and M6 Toll Road.

Area	SqFt	SqM
WAREHOUSE/WORKSHOP	2,603.92	241.9
OFFICES/ANCILLARY	258.24	23.99
<b>Total Floor Area</b>	<b>2,862</b>	<b>265.88</b>



Unit 14c, Jubilee Estate, Gorsey Lane, Coleshill, Birmingham B46 1JU



## TERMS

The property is available on the basis of a new Full Repairing and Insuring Lease, the terms for which are to be agreed by negotiation.

## ASKING RENT

£25,500 per annum exclusive

## SERVICE CHARGE

A Service Charge will be payable for the shared maintenance of the estate. Further details are available on request.

## EPC

Energy Performance Asset Rating Band C - 73.

## BUSINESS RATES

Interested parties are advised to make their own enquiries with the Local Authority (North Warwickshire) for verification purposes.

## MONEY LAUNDERING

In accordance with Anti Money Laundering Regulations two forms of ID and confirmation of the source of funding will be required from the successful applicant. For a company, any person owning more than 25% must provide the same.

## LEGAL COSTS

Each party will be responsible for their own legal costs incurred in the transaction.

## VAT

All figures are quoted exclusive of VAT.

## VIEWING

Strictly by prior appointment, please contact:



Ben Nicholson MRICS  
DDI: 0121 362 1532  
Mob: 07889 407650  
E: [ben.nicholson@burleybrowne.co.uk](mailto:ben.nicholson@burleybrowne.co.uk)



Garry Johnson  
DDI: 0121 362 1535  
Mob: 07510 080210  
E: [garry.johnson@burleybrowne.co.uk](mailto:garry.johnson@burleybrowne.co.uk)



0121 321 3441  
www.burleybrowne.co.uk



Burley Browne gives notice that, (i) these particulars are intended as a general outline only for the guidance of prospective purchasers or lessees and do not constitute any part of any offer or contract, (ii) the accuracy of any description and or dimensions necessary for use and occupation cannot be guaranteed and any prospective purchasers or tenants should not rely on them as statements or representations of fact but must satisfy themselves by inspection or otherwise; (iii) no employee of the agents has any authority to make or give any representation or enter into any contract whatsoever in relation to the property; (iv) the agents will not be liable in negligence or otherwise for any loss arising from use of these particulars.

Misrepresentation Act 1967. Unfair Contract Terms 1977. Consumer Protection Regulations under Unfair Trading Regulations 2008. The Business Protection Regulations from Misleading Marketing Regulations 2008.

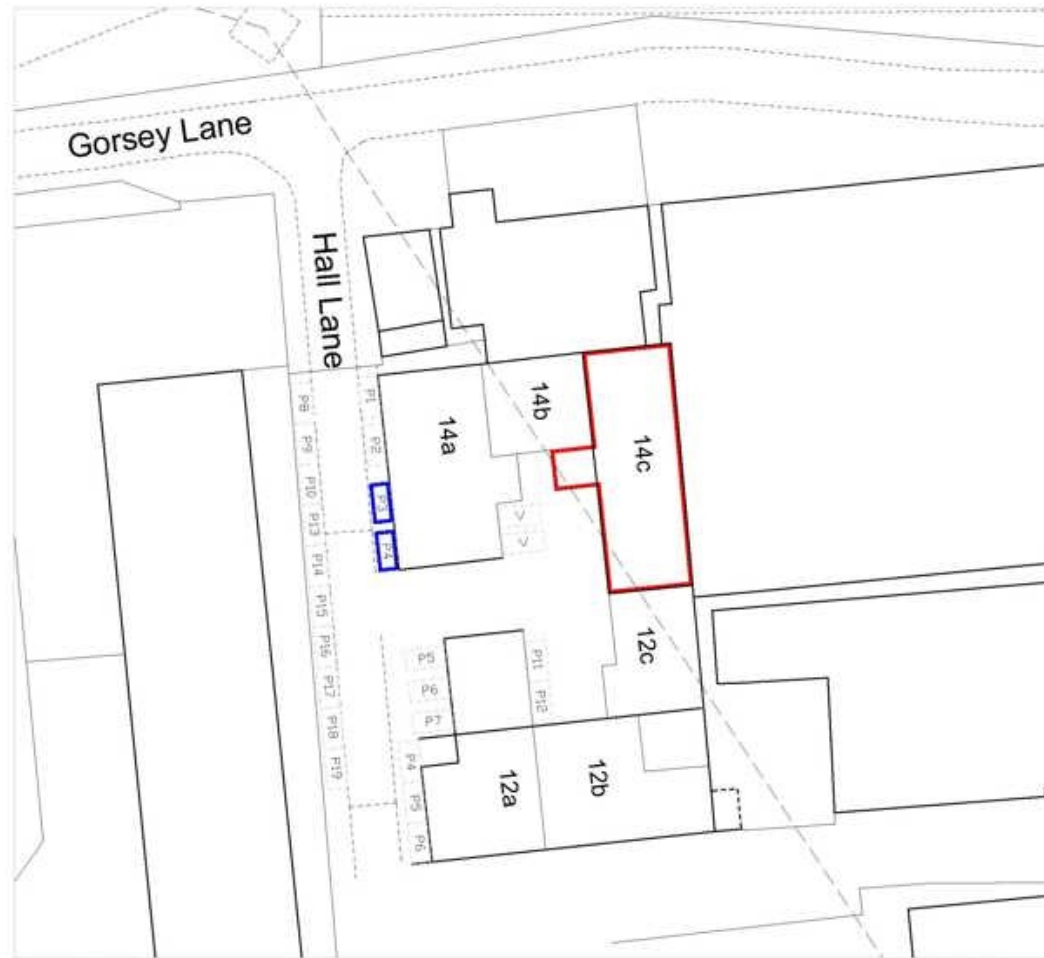

Ground Floor Plan

Scale 1:200

Ordinance Survey map data copyright Crown No. 10002143

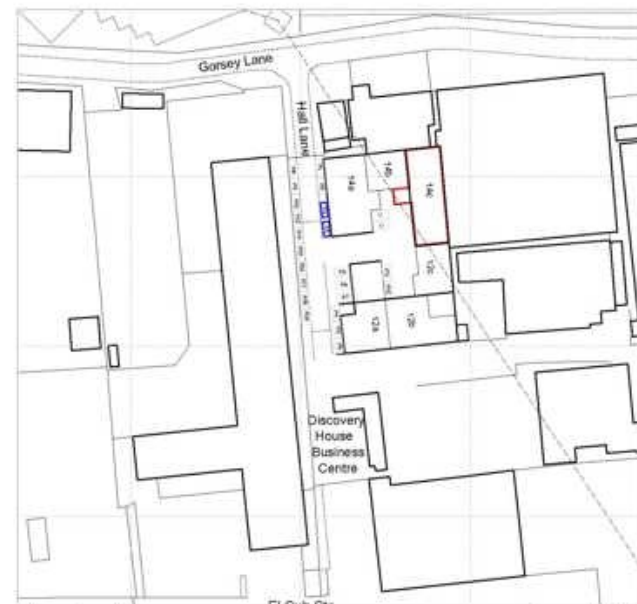

Location Plan

1:1250

Unit 14b, Jubilee Estate, Gorsey Lane, Coleshill, Birmingham B46 1JU	
Lease Plan	
Feb 2025	Scale 1:500/1:1250 @ A4

0121 321 3441  
 www.burleybrowne.co.uk



Burley Browne gives notice that, (i) these particulars are intended as a general outline only for the guidance of prospective purchasers or lessees and do not constitute any part of any offer or contract, (ii) the accuracy of any description and or dimensions necessary for use and occupation cannot be guaranteed and any prospective purchasers or tenants should not rely on them as statements or representations of fact but must satisfy themselves by inspection or otherwise; (iii) no employee of the agents has any authority to make or give any representation or enter into any contract whatsoever in relation to the property; (iv) the agents will not be liable in negligence or otherwise for any loss arising from use of these particulars.

Misrepresentation Act 1967. Unfair Contract Terms 1977. Consumer Protection Regulations under Unfair Trading Regulations 2008. The Business Protection Regulations from Misleading Marketing Regulations 2008.