



TURN-KEY RESTAURANT 6,113 SF Available

**739 South Clinton Avenue,
Rochester, NY 14620**

This high visibility, ground floor retail opportunity in the heart of the South Wedge neighborhood features an industrial interior with high ceilings, exposed brick and beams, a walk-in cooler, private office, and an open layout with plenty of seating/waiting room. An expansive bar with beautiful countertops and stonework welcomes guests as they enter.

PROPERTY

highlights

- ✓ Fully-Equipped Restaurant Space
- ✓ High Ceilings w/ Exposed Brick & Beams
- ✓ Expansive Dining Area
- ✓ Bar w/ Beautiful Stone Accents
- ✓ Walk-in Cooler
- ✓ Private Office & Restrooms

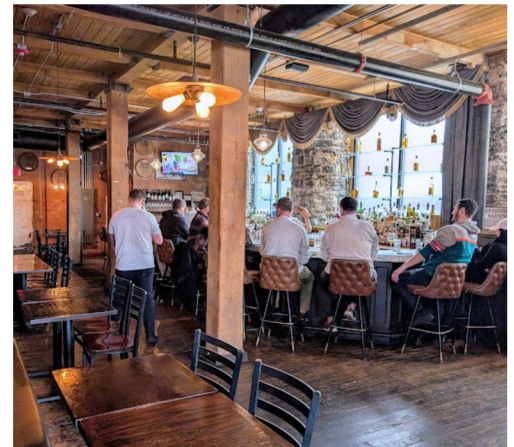

**BUCKINGHAM
PROPERTIES**



TOM LATTA

VP of Leasing & Tenant Relations

(585) 478-7824 | tlatta@buckprop.com

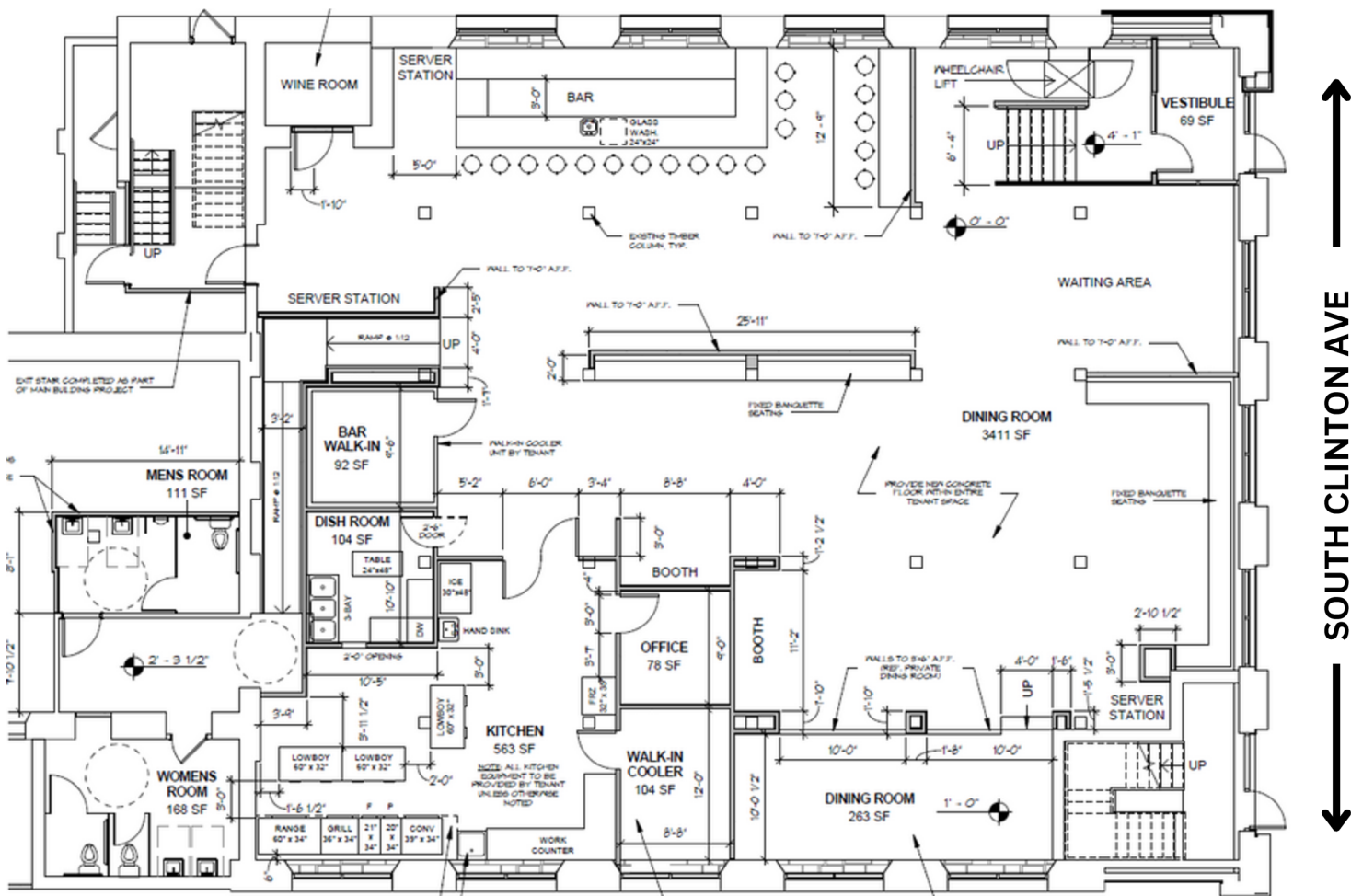

↑ SOUTH CLINTON AVE ↓



**BUCKINGHAM
PROPERTIES**



TOM LATTA

VP of Leasing & Tenant Relations

(585) 478-7824 | tlatta@buckprop.com