

VINEYARD POINTE SHOPPING CENTER



3031 Foothills Blvd, Suite 105

Features

- 1,920 square feet available
- Open Area with tile floor
- Plumbing / sink stub-outs in wall
- Near Denio's Auction with high weekend traffic

Demographics

	1 mile	3 mile	5 mile
Population	19,442	101,896	319,562
Income:	\$113,889	\$126,306	\$129,011

Traffic Counts

Foothills Blvd (@ Baseline Rd/Main St): 31,174 ADT



For Further Information,
Please Contact:

Brian English
benglish@centurymgmt.com

Keith Galliano
kgalliano@centurymgmt.com

1001 Enterprise Way,
Suite 250
Roseville, CA 95678
Phone: (916) 784-3666
Fax: (916) 784-3667



Roseville, CA

VINEYARD POINTE SHOPPING CENTER

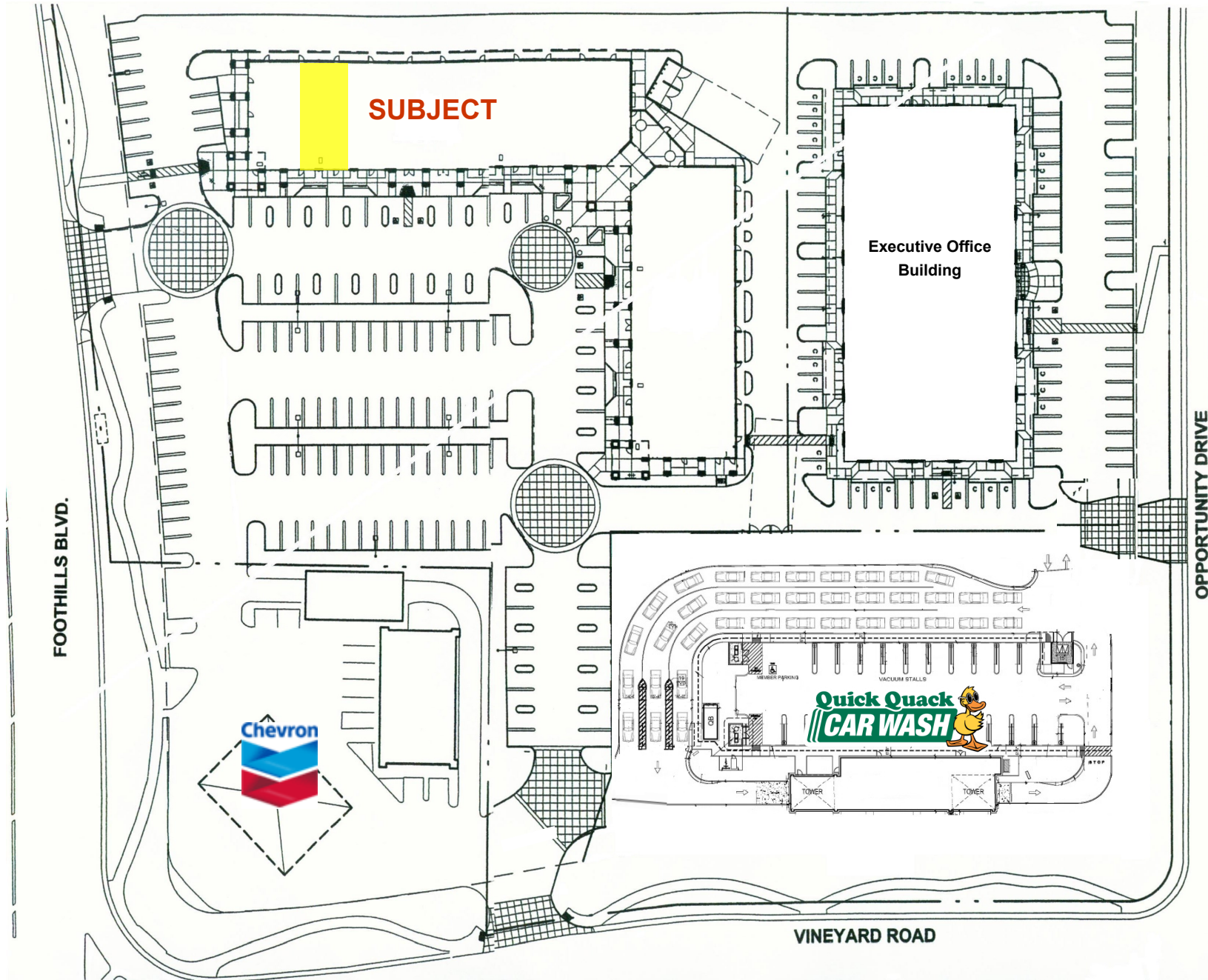

Roseville, CA

VINEYARD POINTE SHOPPING CENTER

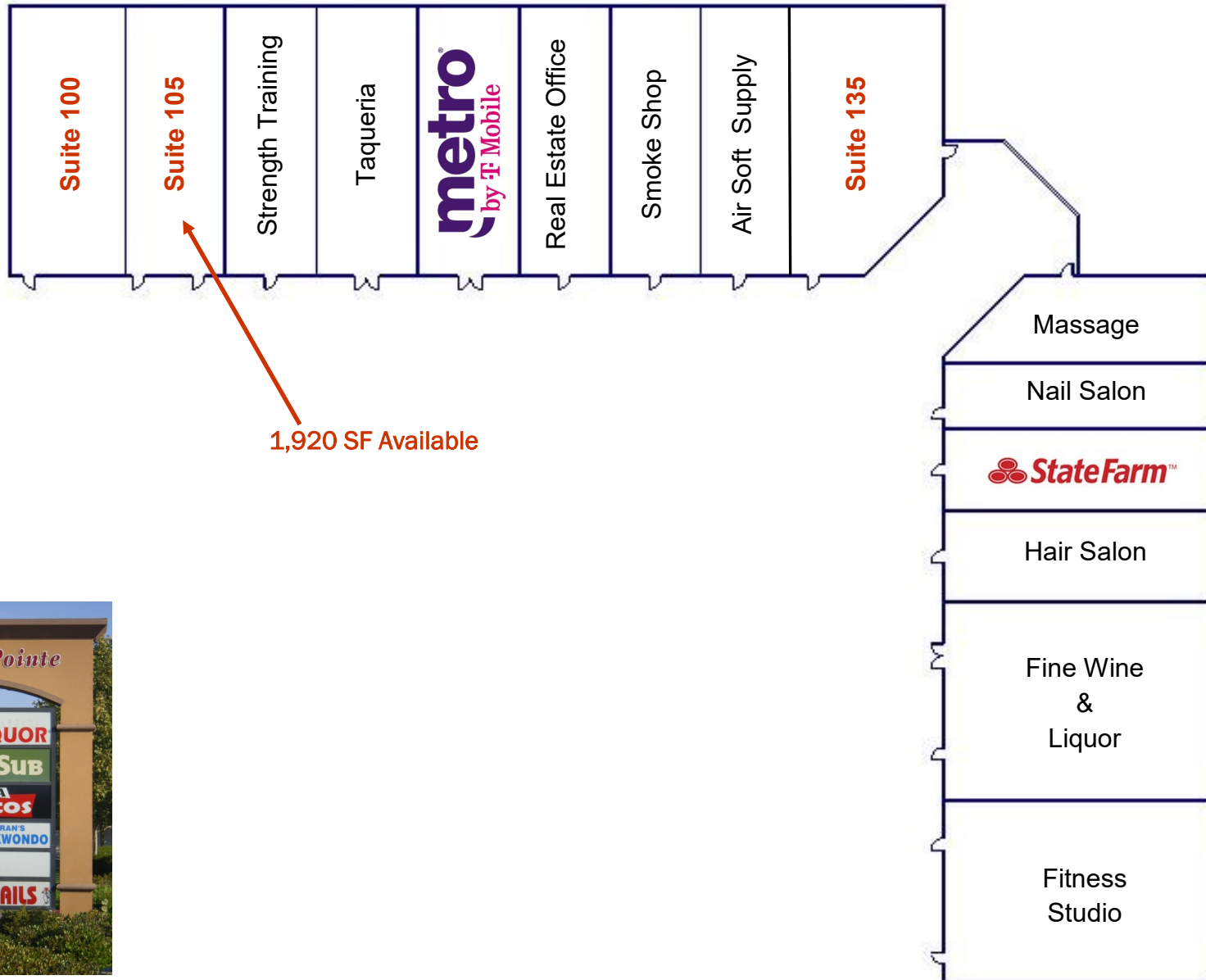

Roseville, CA

VINEYARD POINTE SHOPPING CENTER

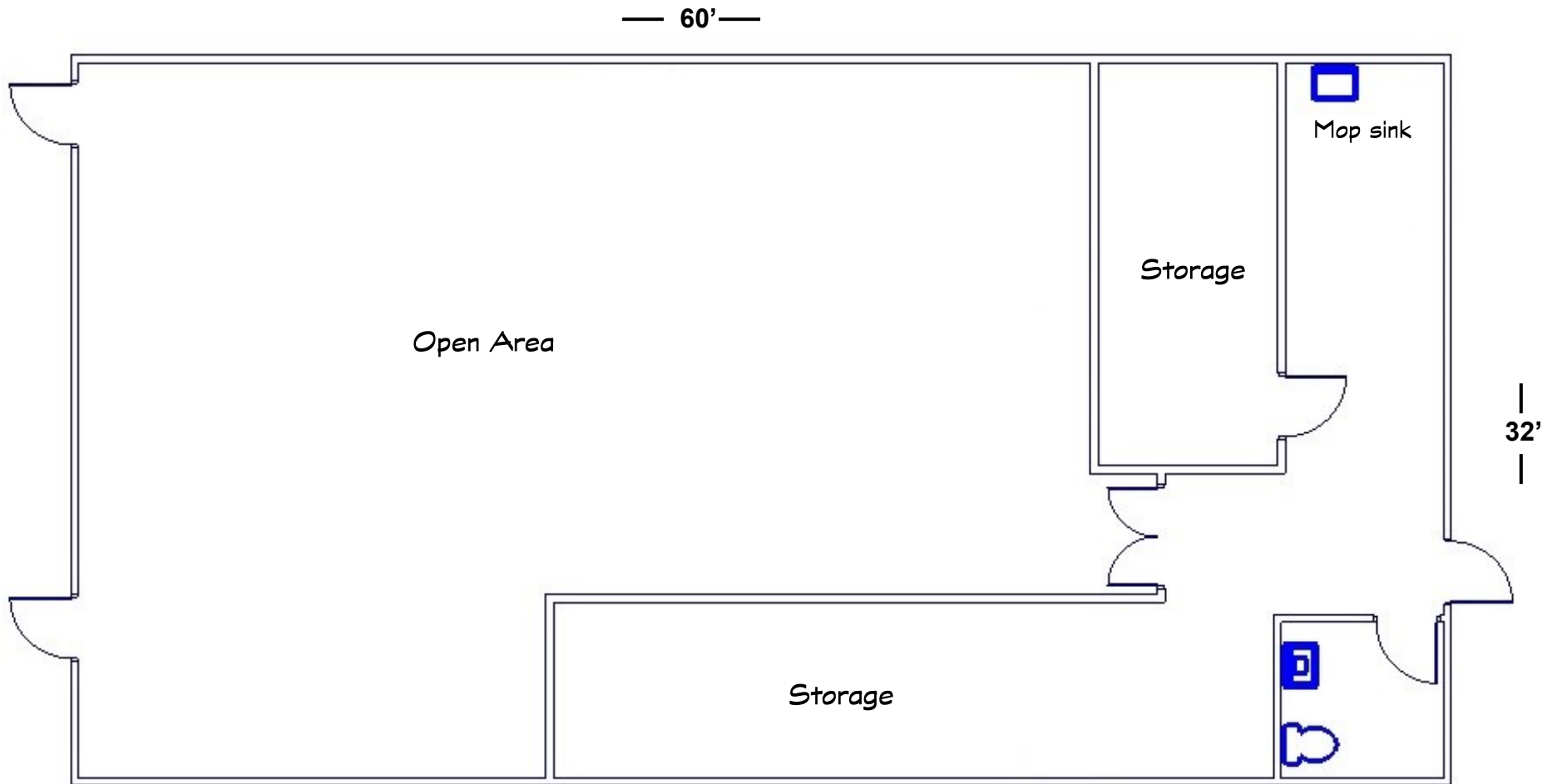

Not to Scale

Roseville, CA

VINEYARD POINTE SHOPPING CENTER

