

**FOR LEASE**  
21,624± SF  
INDUSTRIAL

**1460** LIVINGSTON AVE  
North Brunswick, NJ  
Building #600



## Property Features

- Space Available: 21,624± SF
- Building Size: 49,042± SF
- Drive-Ins for Unit: Two (2)
- Ceiling Height: 28'
- Cranes: Two (2) 30 Ton & One (1) 15 Ton
- Power: Heavy
- Air-Conditioning: Offices only
- TAX/CAM: \$4.50 PSF
- Excellent location. Easy access to Route 1



**Lorenzo Lambiase, MBA, CCIM | Vice President**

201 488 5800 x176 • llambiase@naihanson.com

**Patrick Lennon | Senior Vice President**

201 488 5800 x109 • plennon@naihanson.com

**Kenneth D. Lundberg, SIOR | Senior Vice President**



201 488 5800 x138 • klundberg@naihanson.com

**INQUIRE FOR LEASE RATE**

**NAI James E. Hanson**  
COMMERCIAL REAL ESTATE SERVICES, WORLDWIDE

A PROJECT BY:

**B&D  
HOLDINGS**

FOLLOW US!      | NJ Offices: Teterboro | Parsippany | [naihanson.com](http://naihanson.com) | Member of NAI Global with 325+ Offices Worldwide

### SERVICES OFFERED

Brokerage • Property Management • Corporate Services • Financing • Logistics • Government Services • Healthcare • Tenant Representation • Cold Storage • Investment Services

The information contained herein has been obtained from sources considered to be reliable, but no guarantee of its accuracy is made by NAI James E. Hanson

21,624± SF AVAILABLE | BUILDING 600

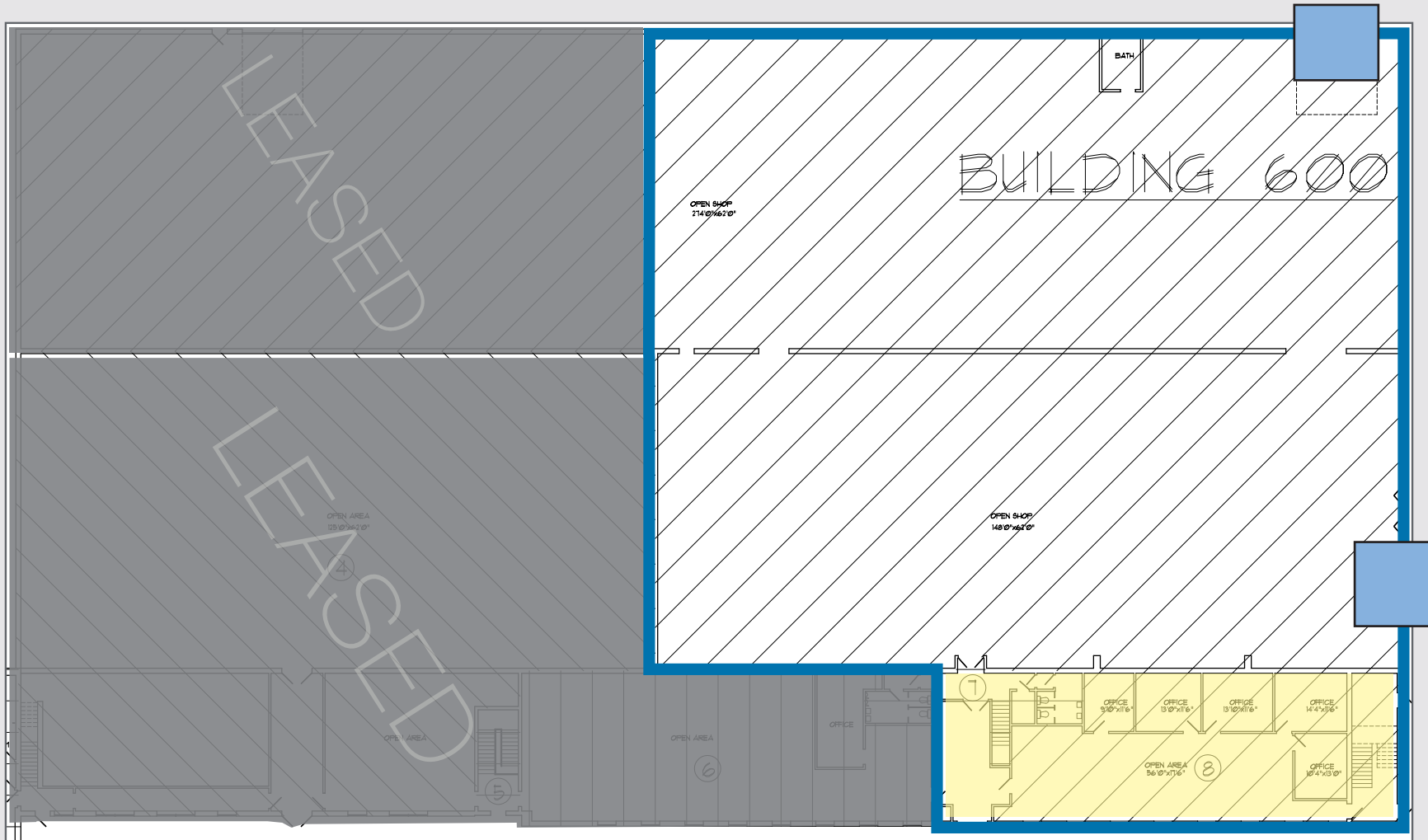

- OFFICE
- WAREHOUSE
- DRIVE-IN

AERIAL  
& HIGHWAY MAP

# 1460 LIVINGSTON AVE

North Brunswick, NJ  
Building #600

