

4601  
S. Boyle Ave.

VERNON | CA 90058



65,280 SF INDUSTRIAL BUILDING FOR LEASE

CBRE

# Property Highlights

65,280 SQ FT  
INDUSTRIAL BUILDING FOR LEASE

---



**Free Standing Building**



**Large Showroom**



**10 Dock High Loading Positions**



**Premium Offices/Showroom**



**Private/Fenced Yard**





# Site Plan

◀ SOTO STREET

46TH STREET

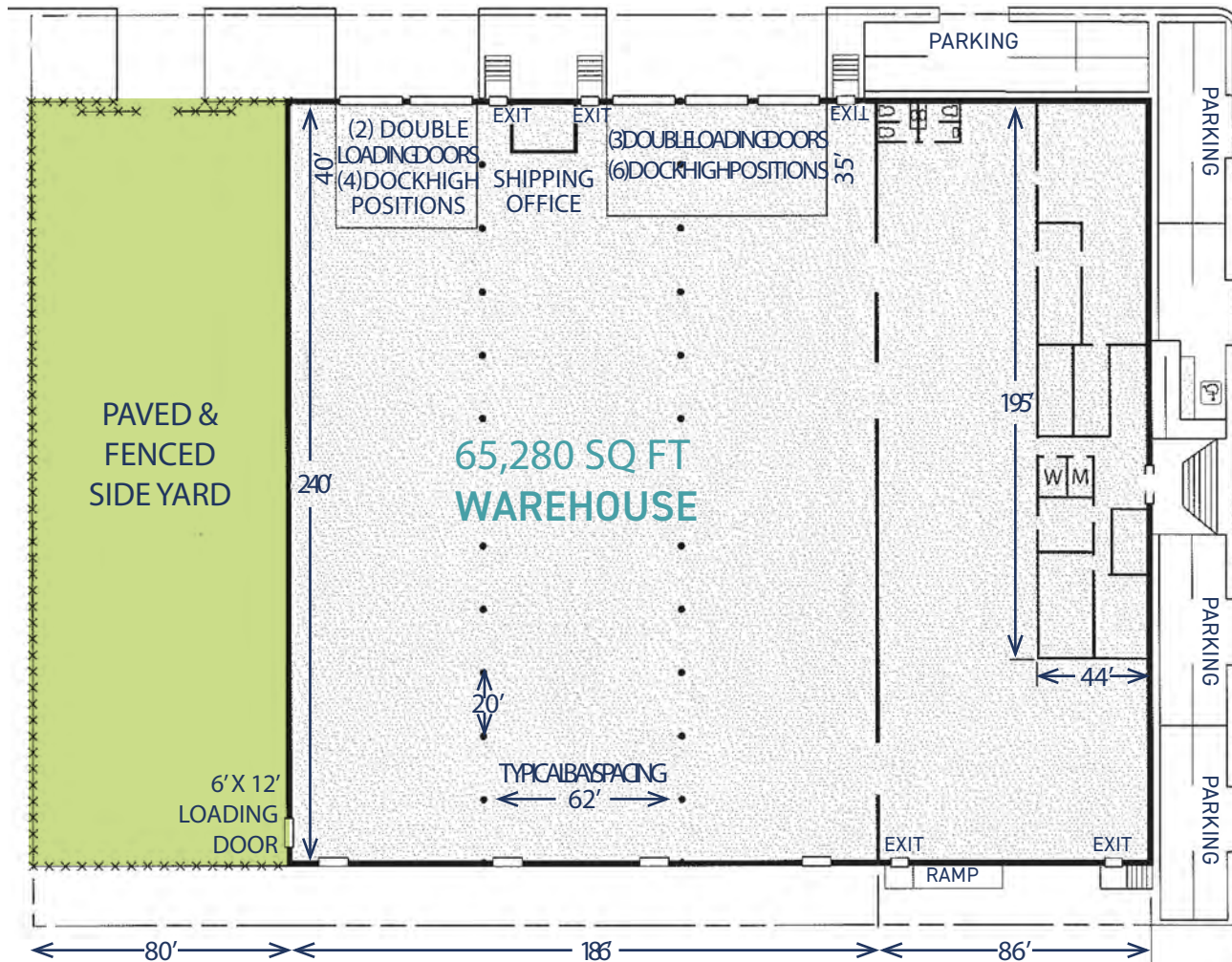

BOYLE AVENUE

# Location Map

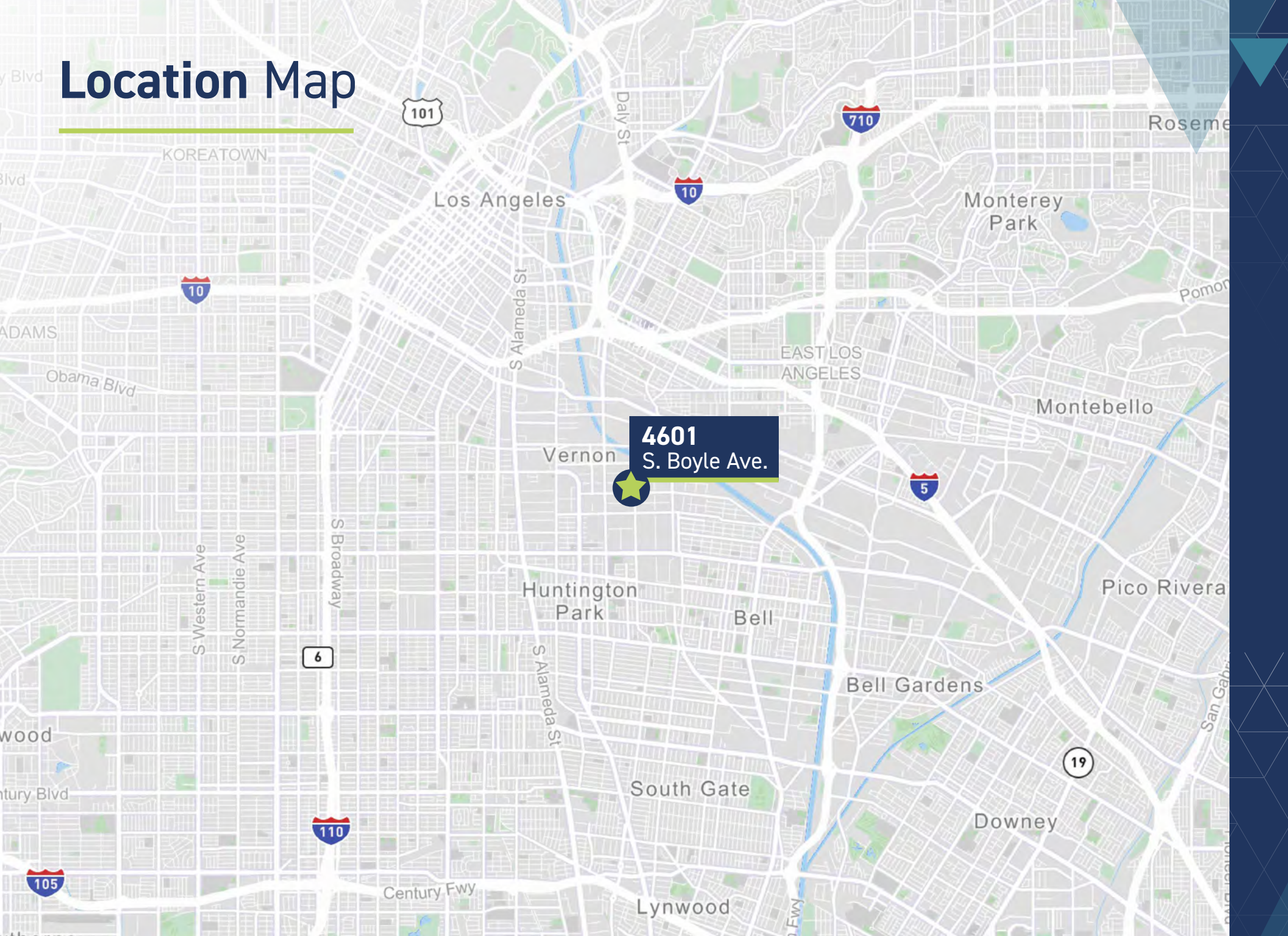

**4601**  
**S. Boyle Ave.**

# Regional Map

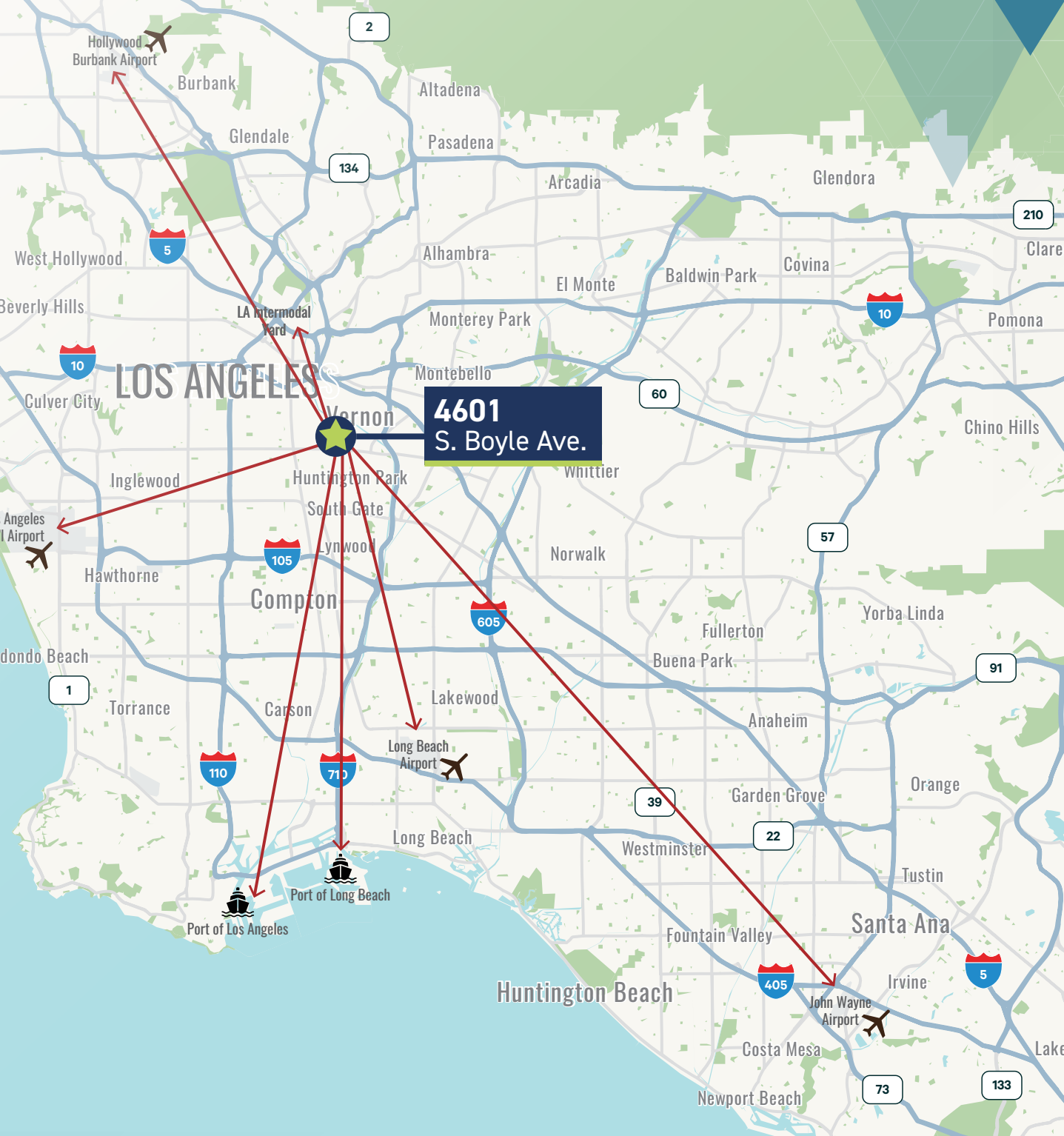

**4601  
S. Boyle Ave.**

## DISTANCE TO AIRPORTS/PORTS

	Miles	Minutes
Los Angeles Airport	22.4	34
Los Beach Airport	20.5	33
John Wayne Airport	34.8	9
Hollywood Burbank Airport	18.4	39
Port of Los Angeles	23.5	39
Port of Long Beach	22.2	38
LA Intermodal Yard	4.6	14

# 4601 S. Boyle Ave.

VERNON | CA 90058

## CONTACTS | LOCAL MARKET EXPERTS

### EVAN CRAWFORD

Senior Associate

Lic. 02105059

+1 213 613 3332

evan.crawford@cbre.com

### JEFF STEPHENS, SIOR

Executive Vice President

Lic. 01051764

+1 213 613 3761

jeffrey.stephens@cbre.com

### JACK MERGENTHALER, SIOR

Senior Vice President

Lic. 01942974

+1310 363 4946

jack.mergenthaler@cbre.com

### JOHN STEPHENS

Associate

Lic. 02159924

+1 213 613 3418

john.stephens@cbre.com

**CBRE**

© 2025 CBRE, Inc. All rights reserved. This information has been obtained from sources believed reliable but has not been verified for accuracy or completeness. CBRE, Inc. makes no guarantee, representation or warranty and accepts no responsibility or liability as to the accuracy, completeness, or reliability of the information contained herein. You should conduct a careful, independent investigation of the property and verify all information. Any reliance on this information is solely at your own risk. CBRE and the CBRE logo are service marks of CBRE, Inc. All other marks displayed on this document are the property of their respective owners, and the use of such marks does not imply any affiliation with or endorsement of CBRE. Photos herein are the property of their respective owners. Use of these images without the express written consent of the owner is prohibited.