

4237 SALISBURY RD - BUILDING 4

4237 SALISBURY ROAD, JACKSONVILLE, FL 32216



OFFERING SUMMARY

Available SF: 2,434 - 5,172 SF

Lease Rate: \$12.00 SF/yr (MG)

Year Built: 1985

Building Size: 22,344 SF

Renovated: 2015

Market: Jacksonville

Submarket: Southside

PROPERTY OVERVIEW

Building 4 is a 22,344 square foot multi-tenant office property in a campus style office park. Salisbury Lakes Business Park is located within Southpoint Business Park, one of Jacksonville's top locations for office. In the heart of Jacksonville's suburban office market, the property offers close proximity to major roadways (I-95, US-1 and J. Turner Butler Blvd), St. Vincent's Hospital, numerous restaurants, banks and shopping. Building 4 has spaces available ranging from 1438 SF up to maximum contiguous 10,165 SF contiguous. This property is ideal for professional office users and call centers.

AVAILABLE SPACES

SPACE	LEASE RATE	SIZE (SF)
Suite 403	\$12.00 SF/yr	2,434 - 5,172 SF
Suite 406	\$12.00 SF/yr	2,738 - 5,172 SF

JOANN LYLE VASHA CARTER

904.377.0890 202.905.8578

jlyle@svrcom.com vcarter@svrcom.com

4237 SALISBURY RD - BUILDING 4

4237 SALISBURY ROAD, JACKSONVILLE, FL 32216



JOANN LYLE **VASHA CARTER**
904.377.0890 202.905.8578
jlyle@svrcom.com vcarter@svrcom.com

4237 SALISBURY RD - BUILDING 4

4237 SALISBURY ROAD, JACKSONVILLE, FL 32216



JOANN LYLE **VASHA CARTER**

904.377.0890 202.905.8578

jlyle@svrcom.com vcarter@svrcom.com

4237 SALISBURY RD - BUILDING 4

4237 SALISBURY ROAD, JACKSONVILLE, FL 32216

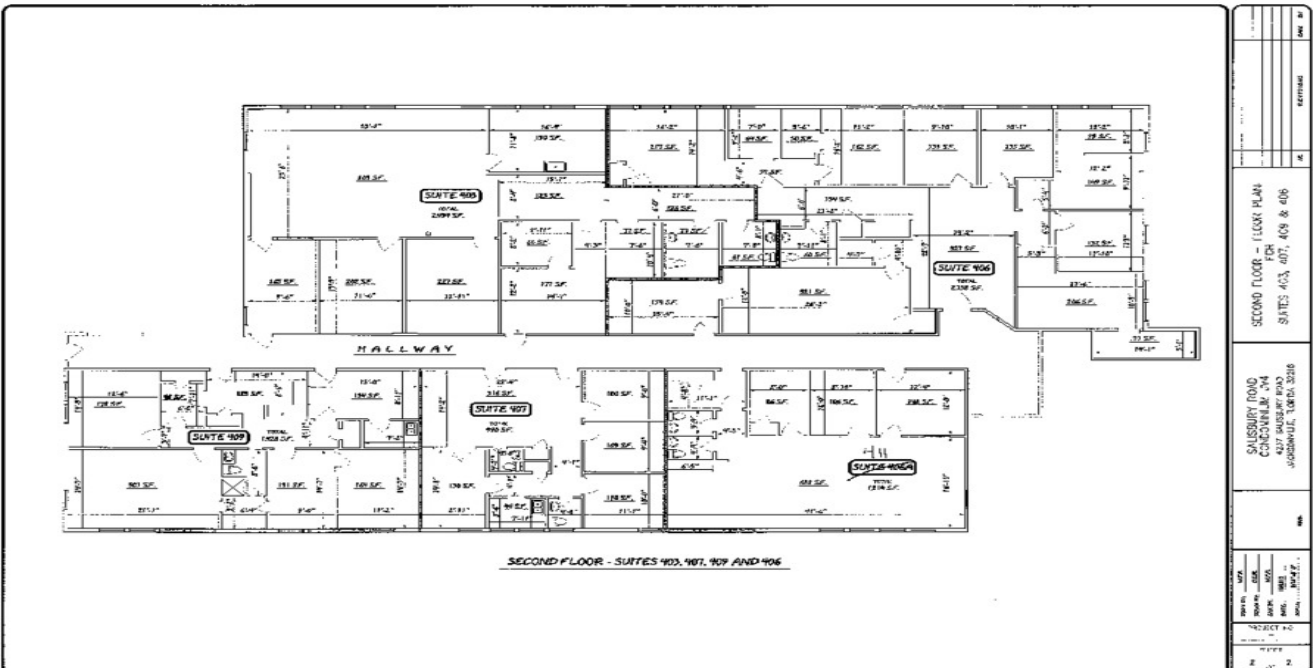
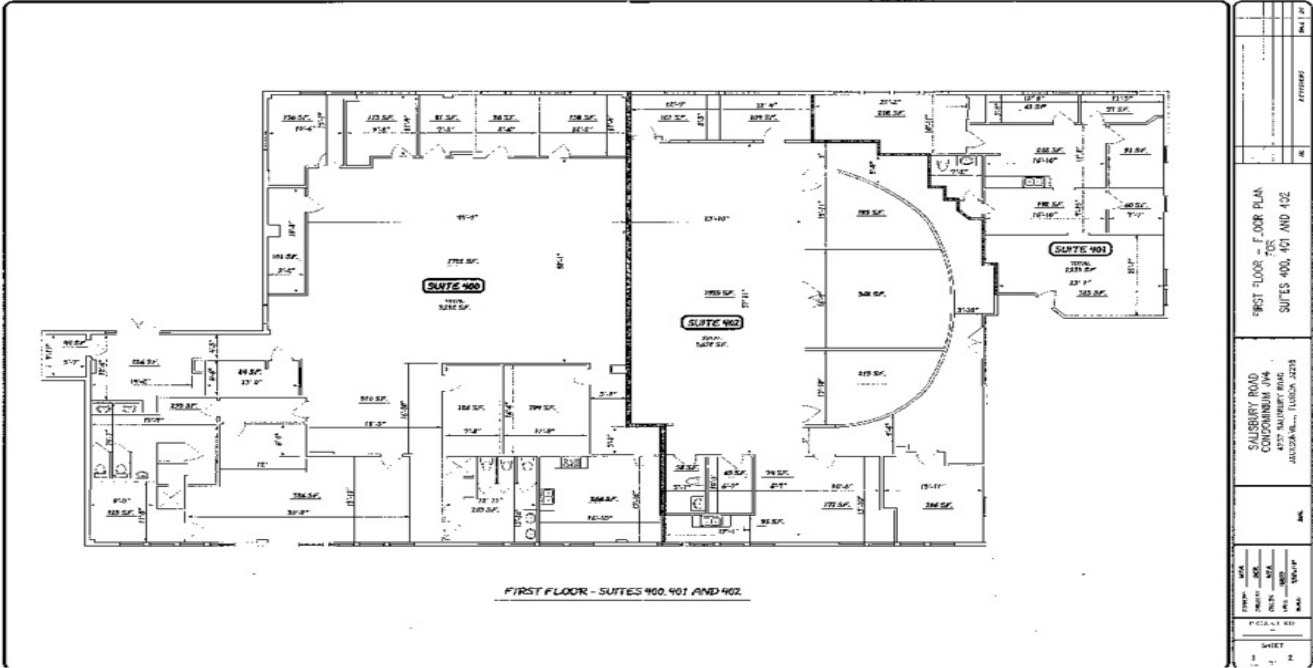

JOANN LYLE VASHA CARTER
 904.377.0890 202.905.8578
 jlyle@svrcom.com vcarte@svrcom.com



4237 SALISBURY RD - BUILDING 4

4237 SALISBURY ROAD, JACKSONVILLE, FL 32216

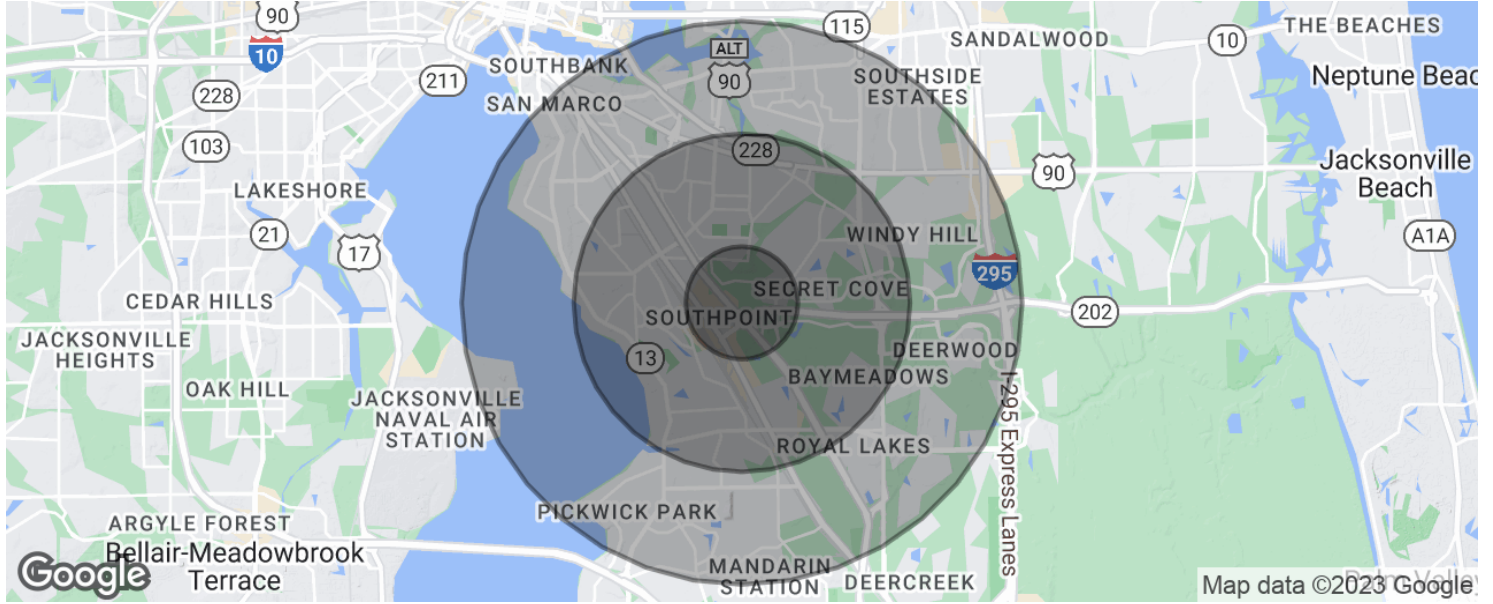

POPULATION	1 MILE	3 MILES	5 MILES
Total population	6,359	62,735	163,713
Median age	37.0	36.0	35.3
Median age (Male)	34.3	33.6	34.1
Median age (Female)	40.1	39.2	37.1
HOUSEHOLDS & INCOME	1 MILE	3 MILES	5 MILES
Total households	2,538	26,359	68,922
# of persons per HH	2.5	2.4	2.4
Average HH income	\$55,044	\$59,415	\$63,545
Average house value	\$201,358	\$209,698	\$250,128

* Demographic data derived from 2020 ACS - US Census

JOANN LYLE **VASHA CARTER**

904.377.0890 202.905.8578

jlyle@svrcom.com vcarter@svrcom.com

