

10,000 SF - 139,548 SF AVAILABLE FOR LEASE

2170 QUEENSWAY DRIVE

BURLINGTON, ONTARIO



BUILDING HIGHLIGHTS

**6 INTERIOR TL & 2 DI
SHIPPING**

**20' 4"
CLEAR HEIGHT**

**GE2
ZONING**

**\$11.50 PSF GROSS
LEASE RATE**

COMMENTS

- Perfect overflow storage space in future redevelopment property bordering the Burlington GO Station.
- Over 1 acre of additional land can be made available at additional cost.
- Minutes to Hwy 403 and abundant amenities.
- Flexible term-lengths.
- Space to be shared or demised with chain-link fence.
- Crane infrastructure can potentially be made available for full building tenant
- Shared access to 6 interior truck-level docks serviced by 3 oversized drive-in doors.
- Office space available with shared amenities (kitchenette/ lunchroom/ washrooms w. showers)



FLOOR PLAN

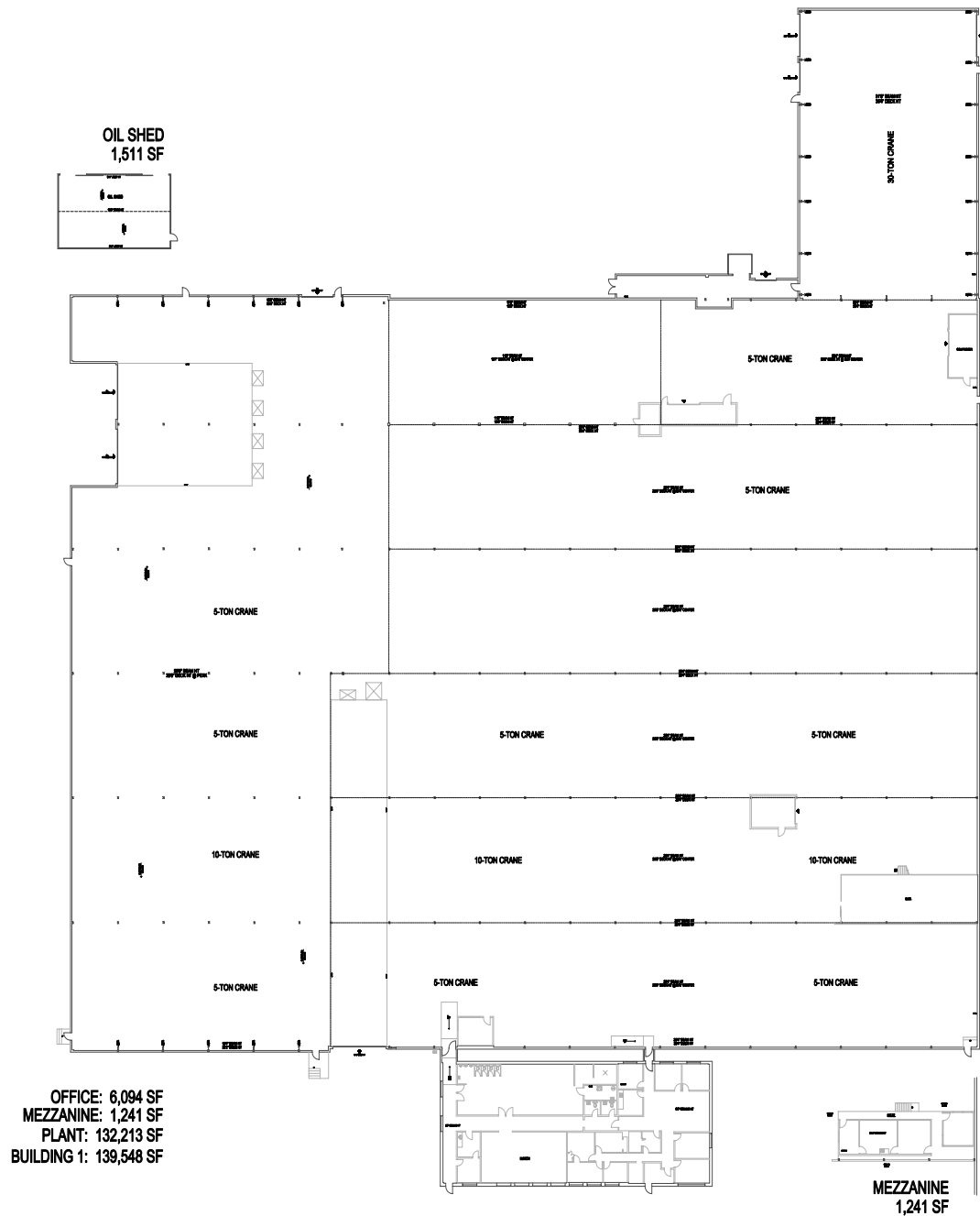

ZONING

According to municipal records the subject property is zoned GE2. Sample permitted uses in a GE2 zone include, but not limited to:

- Accessory dwelling unit (for security or maintenance)
- All office uses
- Banks, trust companies, credit unions
- Car wash
- Computer hardware and software
- Convenience store
- Convenience restaurant
- Clothing industries
- Electrical Products industries
- Fast food restaurant
- Information and data processing
- Knowledge based & high technology
- Leather and textile industries
- Machinery and equipment
- Medical marihuana production facility
- Motor vehicle garage
- Motor vehicle service station
- Nursery or garden center
- Office Furniture and equipment
- Other service commercial uses
- Pharmaceuticals and medicines
- Public transportation
- Standard restaurant with dance floor
- Storage locker facility
- Veterinary Service
- Recreational establishment
- Research and development
- Retail brewery
- Warehouse and logistics

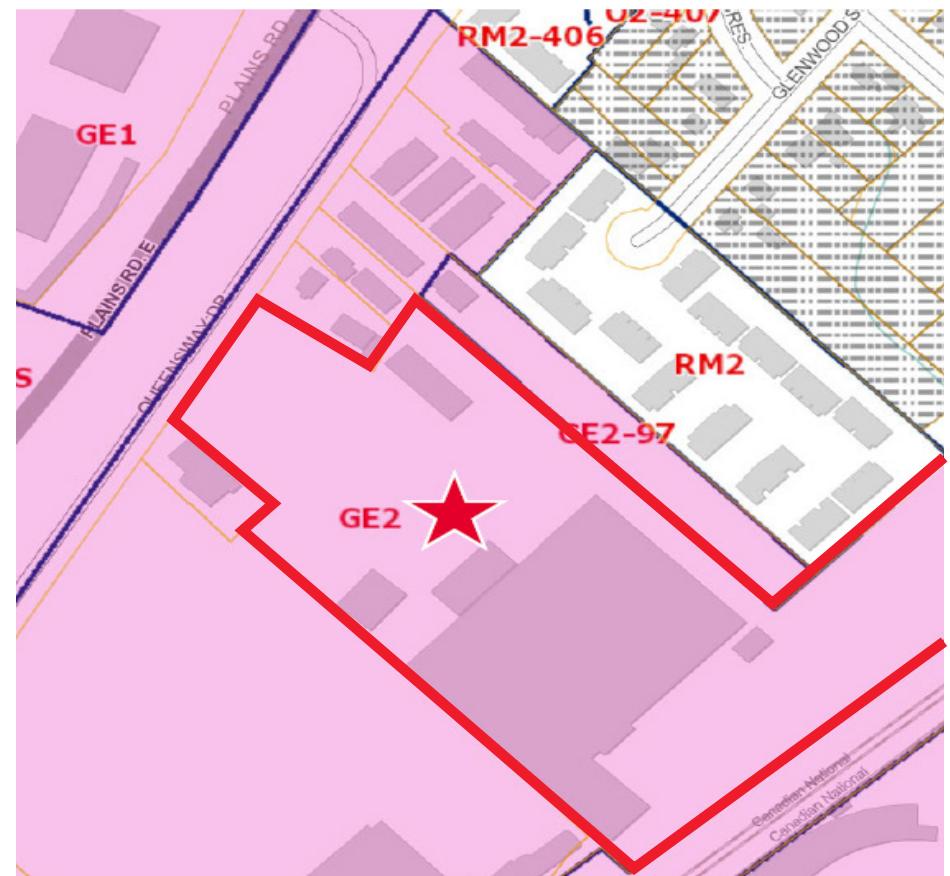

PROPERTY IMAGES



PROPERTY AERIAL



AMENITIES MAP

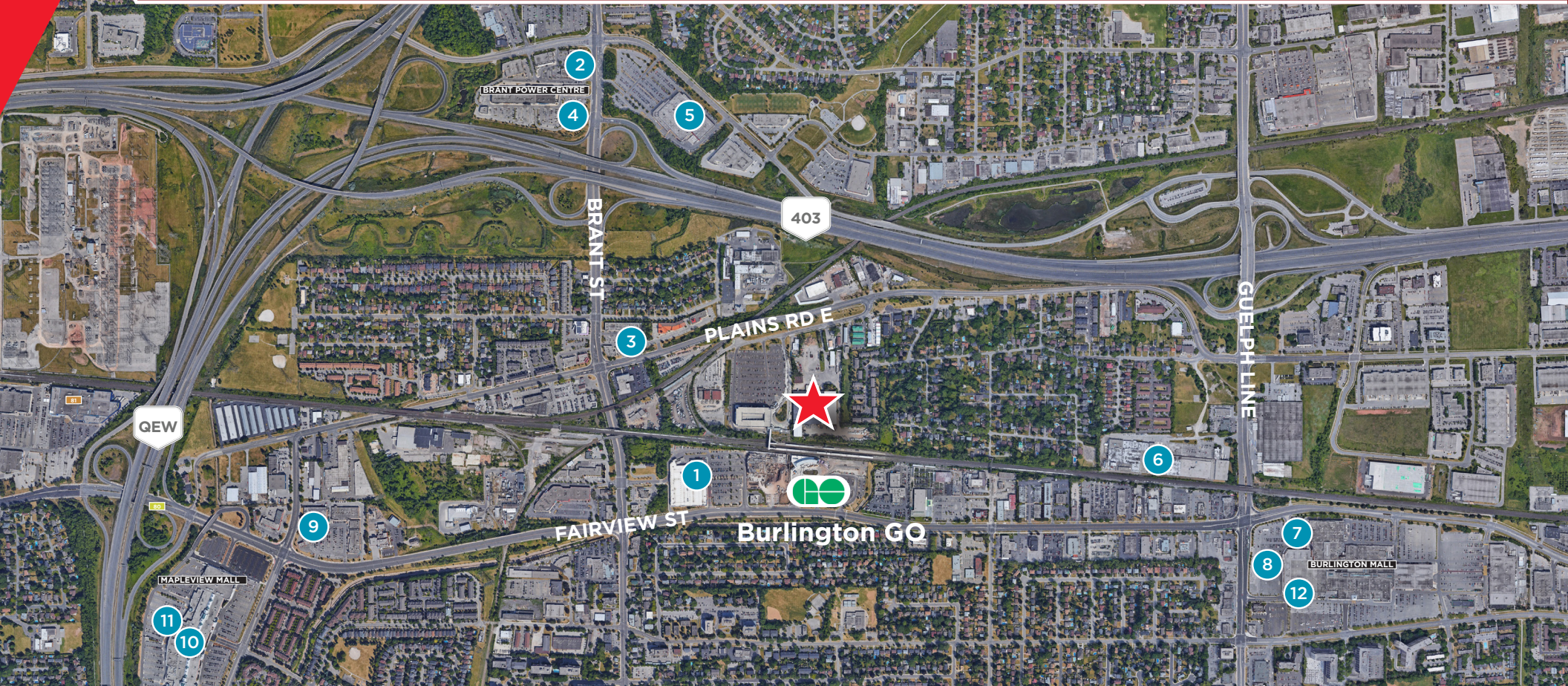

LEGEND | AMENITIES

- | | | | |
|----------------|--------------|-------------|------------------------|
| 1 Walmart | 4 Milestones | 7 Kelseys | 10 Turtle Jacks |
| 2 Swiss Chalet | 5 Costco | 8 Five Guys | 11 Earls Kitchen + Bar |
| 3 Tim Hortons | 6 Scaddabush | 9 Longos | 12 Starbucks |

FOR MORE INFORMATION, PLEASE CONTACT:

KYLE KERR

Associate Vice President

+1 905 501 6406

kyle.kerr@cushwake.com



©2025 Cushman & Wakefield. All rights reserved. The information contained in this communication is strictly confidential. This information has been obtained from sources believed to be reliable but has not been verified. NO WARRANTY OR REPRESENTATION, EXPRESS OR IMPLIED, IS MADE AS TO THE CONDITION OF THE PROPERTY (OR PROPERTIES) REFERENCED HEREIN OR AS TO THE ACCURACY OR COMPLETENESS OF THE INFORMATION CONTAINED HEREIN, AND SAME IS SUBMITTED SUBJECT TO ERRORS, OMISSIONS, CHANGE OF PRICE, RENTAL OR OTHER CONDITIONS, WITHDRAWAL WITHOUT NOTICE, AND TO ANY SPECIAL LISTING CONDITIONS IMPOSED BY THE PROPERTY OWNER(S). ANY PROJECTIONS, OPINIONS OR ESTIMATES ARE SUBJECT TO UNCERTAINTY AND DO NOT SIGNIFY CURRENT OR FUTURE PROPERTY PERFORMANCE.

