

Available SF 4,320 SF

Industrial For Lease

Building Size 24,305 SF



Property Name: Patata Business Park
Address: 4901 Patata St, Bldg 3, Unit 303-304, Cudahy, CA 90201
Cross Streets: Patata St/Atlantic Ave

Excellent Warehousing or Manufacturing Space
 Renovated Interior
 Completed Enhancements Including: Fresh Exterior Paint
 Improved Lighting and Landscaping
 24-hour Security Camera Monitoring

Lease Rate/Mo:	TBD	Sprinklered:	Yes	Office SF / #:	1,000 SF
Lease Rate/SF:	TBD	Clear Height:	16'	Restrooms:	4
Lease Type:	Gross	GL Doors/Dim:	2	Office HVAC:	Heat & AC
Available SF:	4,320 SF	DH Doors/Dim:	0	Finished Ofc Mezz:	0 SF
Minimum SF:	4,320 SF	A: 200 V: 240 O: 3 W: 4		Include In Available:	No
Prop Lot Size:	POL	Construction Type:	TILT UP	Unfinished Mezz:	0 SF
Term:	Acceptable to Owner	Const Status/Year Blt:	Existing / 1987	Include In Available:	No
Sale Price:	NFS	Whse HVAC:		Possession:	Now
Sale Price/SF:	NFS	Parking Spaces: 10 / Ratio: 2.3:1		Vacant:	Yes
Taxes:		Rail Service:	No	To Show:	Call broker
Yard:	Fenced	Specific Use:	Warehouse/Distribution	Market/Submarket:	Commerce/Vernon
Zoning:	LI			APN#:	6224-034-033
Listing Company:	CBRE - El Segundo				
Agents:	Matthew Tuinstra 310-363-4873 , Cameron Merrill 310-463-1317				
Listing #:	44486817	Listing Date:	03/10/2026	FTCF:	CB250N000S000
Notes:	All measurements are approximate. Lessee to verify all information.				



FOR LEASE

CBRE

Patata Business Park | 4901 Patata Street
Unit 303-304 | 4,320 SF

Site Plan

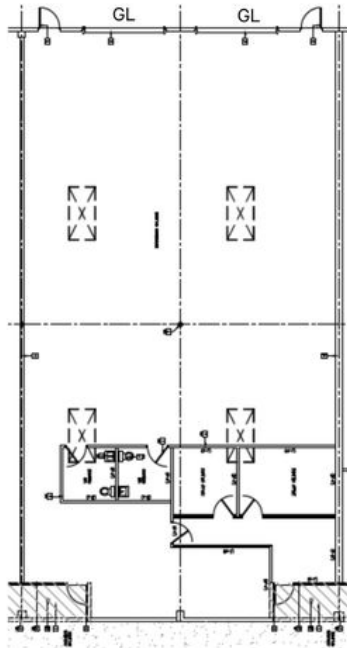

Contact Us

Matthew Tuinstra

Vice President

+1 310 363 4873

Matthew.Tuinstra@cbre.com

Lic. 022111194

Cameron Merrill

Executive Vice President

+1 310 363 4799

Cameron.Merrill@cbre.com

Lic. 01392623

© 2026 CBRE, Inc. All rights reserved. This information has been obtained from sources believed reliable, but has not been verified for accuracy or completeness. You should conduct a careful, independent investigation of the property and verify all information. Any reliance on this information is solely at your own risk. CBRE and the CBRE logo are service marks of CBRE, Inc. All other marks displayed on this document are the property of their respective owners, and the use of such logos does not imply any affiliation with or endorsement of CBRE. Photos herein are the property of their respective owners. Use of these images without the express written consent of the owner is prohibited.



Matthew Tuinstra

matthew.tuinstra@cbre.com

714-393-7753