

# 1937 Triumph Street

Vancouver, BC

SUMMER 2025 COMPLETION



**Contact**

**Ed Ferreira**  
Personal Real Estate Corporation  
Senior Vice President  
ed.ferreira@cbre.com  
604 662 5122

**Jordan Coulter**  
Associate Vice President  
jordan.coulter@cbre.com  
604 662 5574

**Darren Starek**  
Senior Vice President  
darren.starek@cbre.com  
604 662 5175



### Property Details



**Address**

1937 Triumph Street, Vancouver



**Available Area**

|                   |                 |
|-------------------|-----------------|
| Ground Floor      | 4,770 SF        |
| Second Floor #201 | 2,640 SF        |
| #202              | 1,924 SF        |
| <b>Total</b>      | <b>9,334 SF</b> |



**Availability**

Summer 2025



**Basic Rent**

Contact Listing Agents



**Additional Rent**

\$11.00 PSF (estimated)



**Parking**

|                   |                      |
|-------------------|----------------------|
| Ground Floor      | 2 underground stalls |
| Second Floor #201 | 1 underground stall  |
| #202              | 1 underground stall  |



**Zoning**

I-2 Light Industrial

Exceptional opportunity to lease ground and second floor light industrial units in a convenient and rapidly growing location

## GROUND FLOOR



### Space Features

- + New construction
- + 17' high ceilings (approximately)
- + Oversized double pane windows
- + Sprinklered
- + 3 phase electrical services
- + Fan coil HVAC unit
- + Secured underground parking
- + Shared grade loading at lane

### Floor Plan

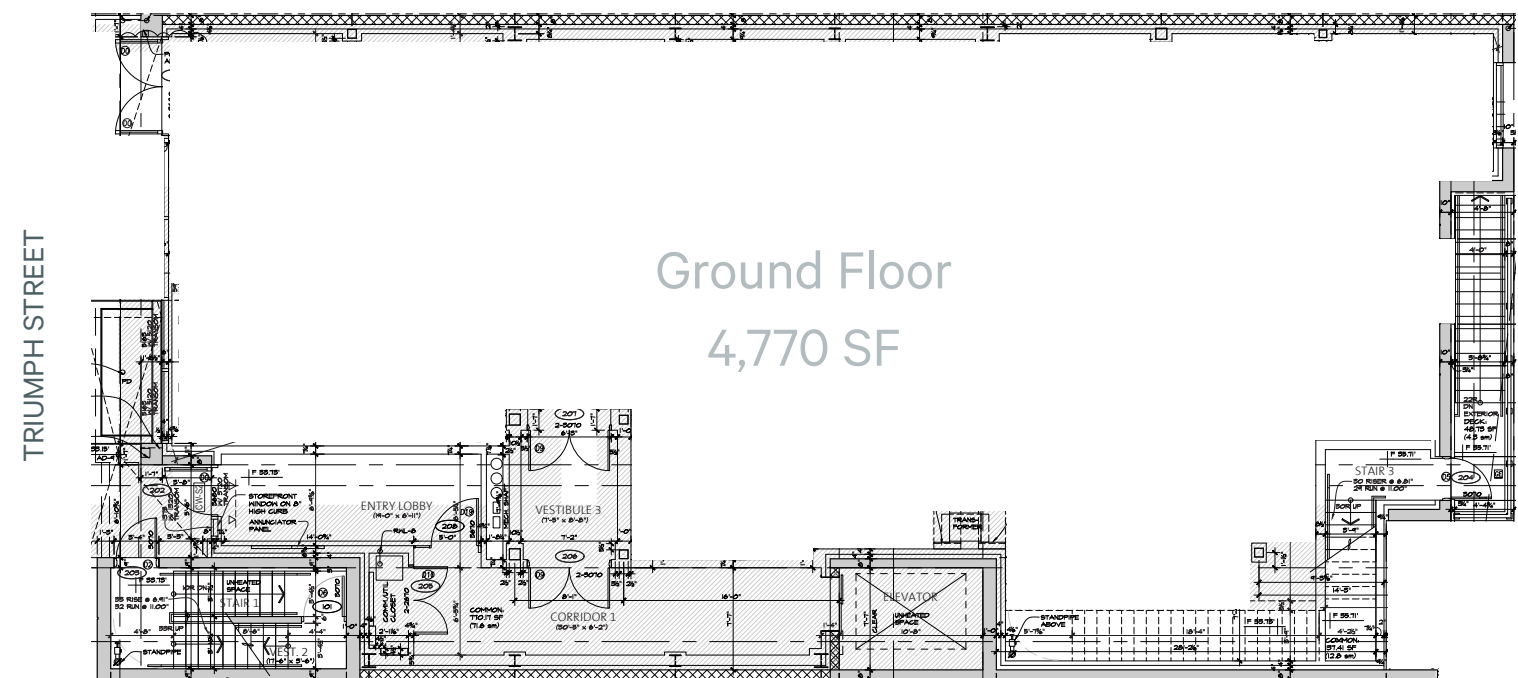

\*not to scale

# Light Industrial Space | For Lease

1937 Triumph Street  
Vancouver, BC

# Light Industrial Space | For Lease

1937 Triumph Street  
Vancouver, BC



## SECOND FLOOR

### Space Features

- + New construction
- + High ceilings
- + Oversized double pane windows
- + Sprinklered
- + Fan coil HVAC unit
- + Secured underground parking
- + Shared grade loading at lane

### Floor Plan

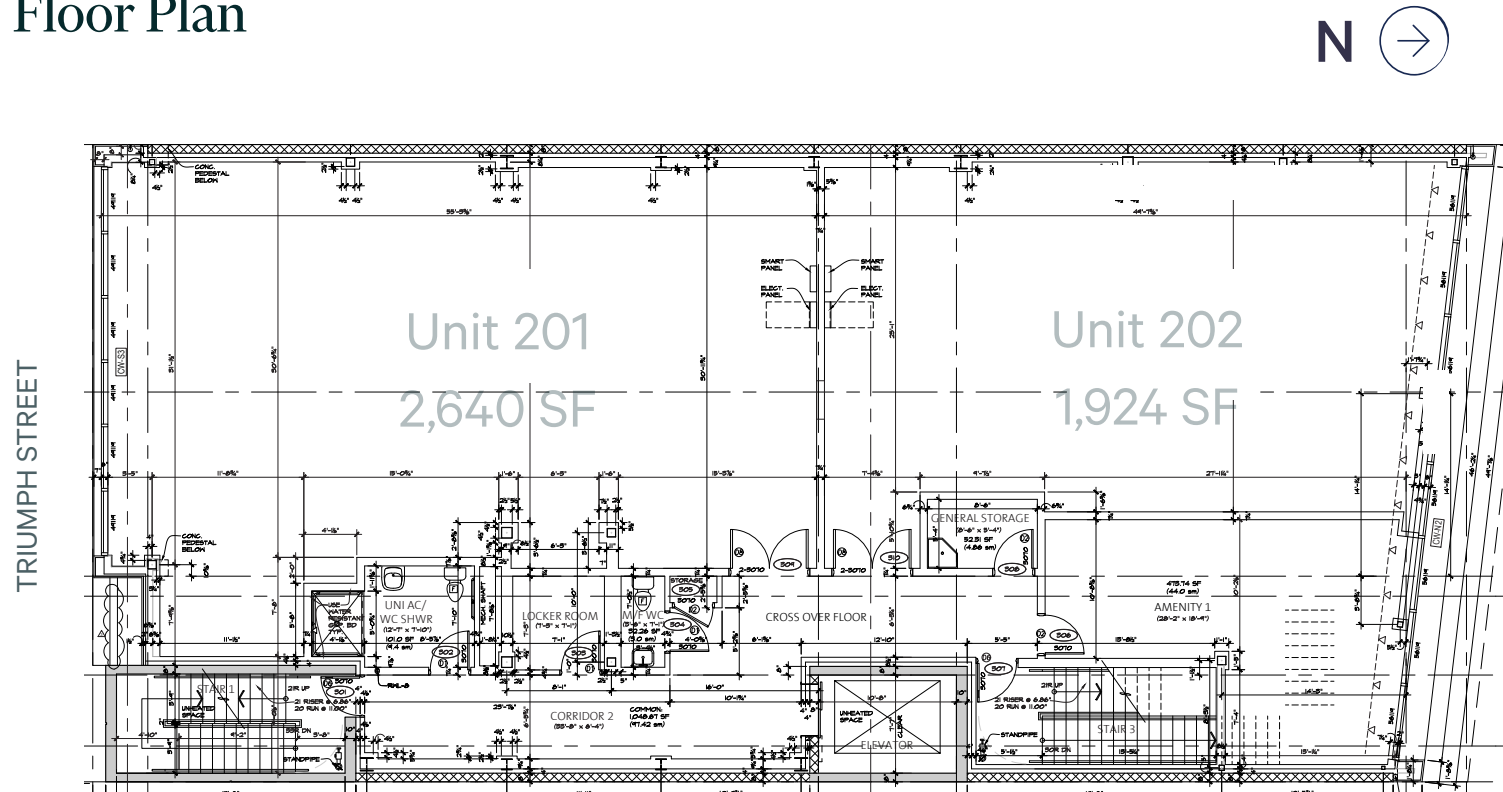

\*not to scale

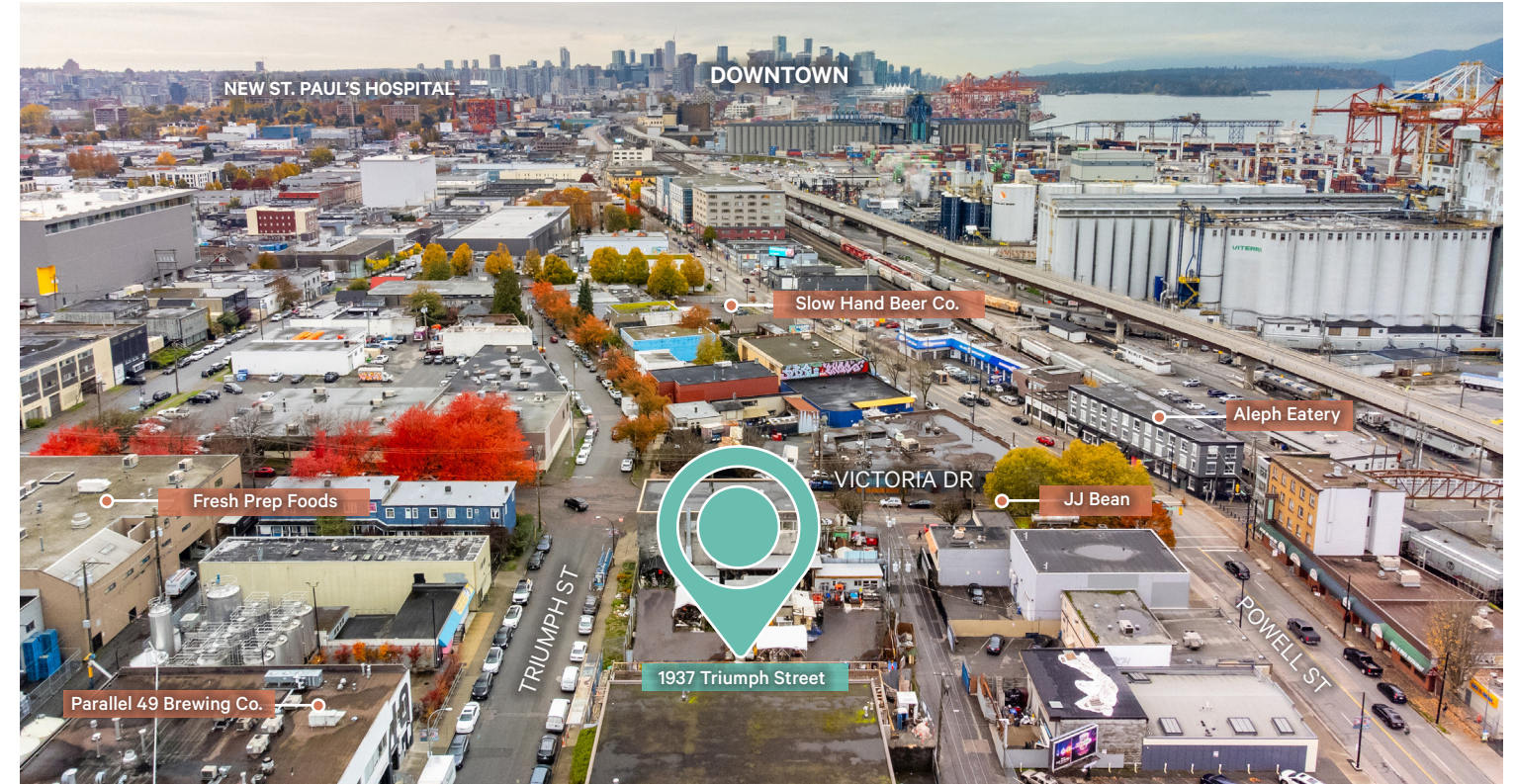

### Prime Location

|                       |               |                |                            |
|-----------------------|---------------|----------------|----------------------------|
| <b>10 MINS</b>        | <b>5 MINS</b> | <b>10 MINS</b> | <b>5 MINS</b>              |
| TO DOWNTOWN VANCOUVER | TO HIGHWAY 1  | TO NORTH SHORE | TO NEW ST. PAUL'S HOSPITAL |

### Contact

**Ed Ferreira**  
Personal Real Estate Corporation  
Senior Vice President  
Industrial Properties  
ed.ferreira@cbre.com  
604 662 5122

**Jordan Coulter**  
Associate Vice President  
Industrial Properties  
jordan.coulter@cbre.com  
604 662 5574

**Darren Starek**  
Senior Vice President  
Industrial Properties  
darren.starek@cbre.com  
604 662 5175

This disclaimer shall apply to CBRE Limited, Real Estate Brokerage, and to all other divisions of the Corporation, to include all employees and independent contractors ("CBRE"). The information set out herein, including, without limitation, any projections, images, opinions, assumptions and estimates obtained from third parties (the "Information") has not been verified by CBRE, and CBRE does not represent, warrant or guarantee the accuracy, correctness and completeness of the Information. CBRE does not accept or assume any responsibility or liability, direct or consequential, for the Information or the recipient's reliance upon the Information. The recipient of the Information should take such steps as the recipient may deem necessary to verify the Information prior to placing any reliance upon the Information. The Information may change and any property described in the Information may be withdrawn from the market at any time without notice or obligation to the recipient from CBRE. CBRE and the CBRE logo are the service marks of CBRE Limited and/or its affiliated or related companies in other countries. All other marks displayed on this document are the property of their respective owners. All Rights Reserved.

Mapping Sources: Canadian Mapping Services canadamapping@cbre.com; DMTI Spatial, Environics Analytics, Microsoft Bing, Google Earth.