



**EVOLVE**  
RETAIL ADVISORS

# END-CAP DRIVE-THRU OPPORTUNITY



**SUBLEASE OPPORTUNITY | OFFERING MEMORANDUM**

## Jack In The Box

8136 TELEGRAPH BLVD, DOWNEY, CA 90240



# Available For Sublease

## Property Highlights

- Currently Jack In The Box
- *End-cap with Drive-Thru*
- Ideal for QSR, Coffee, Bank
- Sublease through 5/13/2029 with Options
- Delivered Vacant

**±2,030**

Store Size (SF)

**±30,000**

VPD

**Call for Pricing**

and more information



# 8136 TELEGRAPH BLVD, DOWNEY, CA



POPULATION	1-MILE	3-MILE	5-MILE
2025 Population	22,953	199,320	617,985
HOUSEHOLDS	1-MILE	3-MILE	5-MILE
2025 Households	6,697	56,312	174,235
INCOME	1-MILE	3-MILE	5-MILE
Avg Household Income	\$102,680	\$94,260	\$89,611

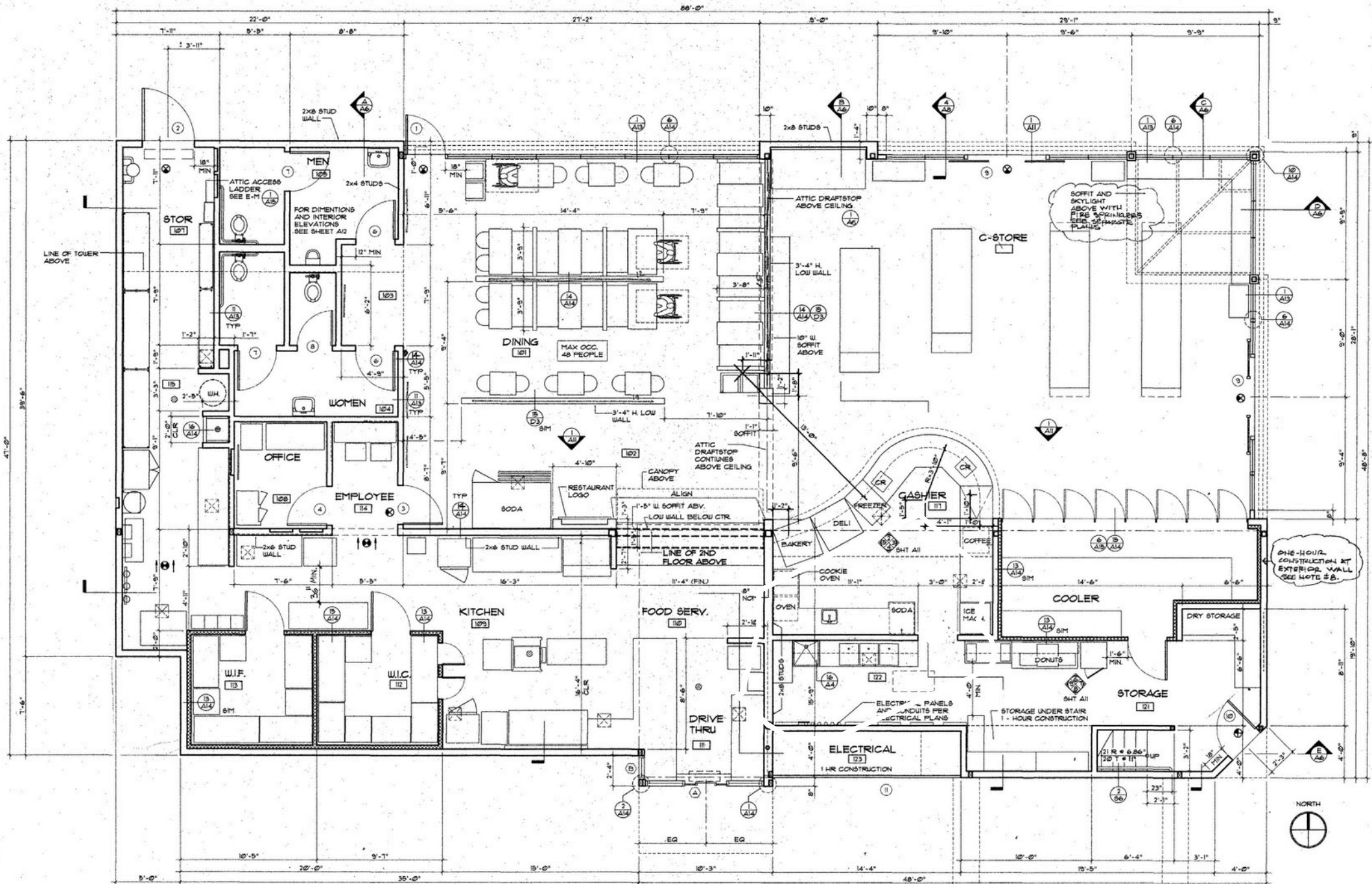



## **CONTACT EXCLUSIVE SUB-LISTING AGENT:**

**SCOTT LIFSCHULTZ**

917.575.9894

[scott@evolveretailadvisors.com](mailto:scott@evolveretailadvisors.com)

License No. 01861113 (CA)

[www.evolveretailadvisors.com](http://www.evolveretailadvisors.com)

### **CONFIDENTIALITY AGREEMENT & DISCLAIMER**

This Leasing Package has been prepared for informational purposes only and may not include all information desired by prospective lessees. While the information is believed to be reliable, no representation or warranty, express or implied, is made as to its accuracy or completeness. Prospective lessees should conduct their own independent investigation and due diligence. Owner and Evolve Retail Advisors reserve the right, at their sole discretion, to reject any offers or terminate discussions at any time without notice.