

the
place.

TO LET

3,500 – 8,654 sq ft



Fitted Suites



On-site Parking



Communal terrace

The Place, Maidenhead, SL6 1AF



Description

The Place is a contemporary office building in Maidenhead, designed to elevate your workspace experience. Enjoy flexible office solutions, enhanced well-being amenities, and a stunning outdoor environment overlooking Maidenhead's Waterside Quarter and The Amphitheatre. Our newly renovated reception area provides a welcoming space for both staff and visitors. With a variety of office suites to suit businesses of all sizes, The Place is ideally located to meet the demands of today's modern workplace, offering excellent transportation links for easy commuting with ample parking on site.

Accommodation

The Place comprises 3 floors of fully fitted workspace with the below floor area

Floor	Space
Second Floor South	5,115 sq ft
Second Floor North	3,549 sq ft
Total	8,654 sq ft



Specification



-  Fitted Suites available
-  Formal & informal meeting spaces
-  Kitchen and break out facilities
-  Superfast broadband
-  Brand new climate control system
-  Lift access
-  Unrivalled transport connectivity
-  Fully DDA compliant throughout
-  Fully staffed reception area
-  Secure cycle storage
-  On-site parking
-  24-hour security monitoring
-  Health club nearby
-  Shops & restaurants nearby



Viewings & Enquiries: 0800 012 9088



5 mins drive to
M4 J 8/9



8 mins walk to
train station



25 mins drive to
Heathrow Airport

Location

The Place, on Bridge Avenue, just off the High Street. This prime location offers seamless transport links for your team and clients. Ample on-site parking eliminates commuting hassles.

The Place, Maidenhead, SL6 1AF



4 MINS / 2 MILES TO M4 J8/9

READING

MAIDENHEAD

A308

TRAVELodge HOTEL

ODEON

DAVID LLOYD LEISURE



ONE MAIDENHEAD REDEVELOPMENT



NICHOLSON QUARTER



M&S FOOD

WINDSOR

AMPHITHEATRE

HIGH STREET

COPPA CLUB



SAINSBURY'S



BRIDGE AVENUE

BRIDGE STREET

WATERSIDE QUARTER DEVELOPMENT

A4

WAITROSE

SLOUGH & LONDON

TO RIVER THAMES



Available Space: 3,500 sq ft to 8,654 sq ft

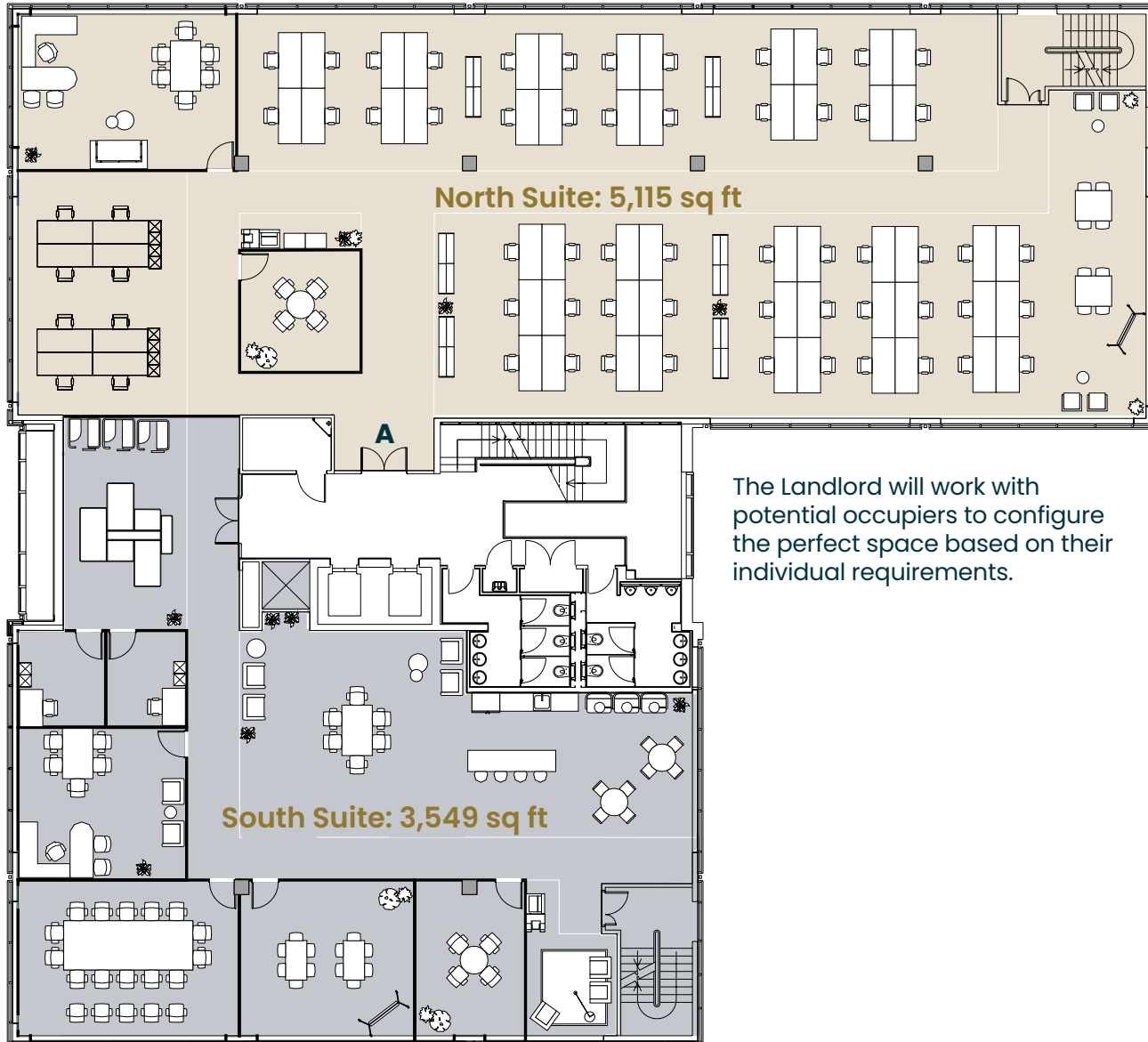

The Landlord will work with potential occupiers to configure the perfect space based on their individual requirements.



Further Information

Terms

The offices are available to let either as a whole or on a floor by floor basis by way of new effective FRI leases for a term to be agreed. Rent upon application.

EPC

The property has been assess to have an EPC rating of B. A full copy of the certificate is available upon request.

IMPORTANT NOTICE: Seneca Property IIIA Ltd gives notice to anyone who may read these particulars as follows:

1. These particulars are prepared for the guidance only of prospective purchasers. They are intended to give a fair overall description of the property but are not intended to constitute part of an offer or contract.
2. Any information contained herein (whether in the text, plans or photographs) is given in good faith but should not be relied upon as being a statement or representation of fact.
3. Nothing in these particulars shall be deemed to be a statement that the property is in good condition or otherwise nor that any services or facilities are in good working order.
4. The photographs appearing in this brochure show only certain parts and aspects of the property at the time when the photographs were taken. Certain aspects may have changed since the photographs were taken and it should not be assumed that the property remains precisely as displayed in the photographs. Furthermore no assumptions should be made in respect of parts of the property which are not shown in the photographs.
5. Any areas, measurements or distances referred to herein are approximate only.
6. Where there is reference in these particulars to the fact that alterations have been carried out or that a particular use is made of any part of the property this is not intended to be a statement that any necessary planning, building regulations or other consents have been obtained and these matters must be verified by any intending purchaser.
7. Descriptions of a property are inevitably subjective and the descriptions contained herein are used in good faith as an opinion and not by way of statement of fact.

Published December 2024.

the

place



Owned and managed by



Contact: Paul Fitzsimmons
0800 012 9088

**Lambert
Smith
Hampton**
01628 676 001

Jennifer Lamb
jhlamb@lsh.co.uk
07917 217 182

Archie Chitty
achitty@lsh.co.uk
07544 801 888

theplace-maidenhead.co.uk