

Convene 30 S 17th Street

30 S 17th Street, Philadelphia, PA 19103

MEETINGS & EVENTS



Convene 30 S 17th Street is located in Center City Philadelphia in close proximity to City Hall and the Pennsylvania Convention Center. Spanning 29,000 square-feet across the 13th and 14th floors of this 20-story building, the venue boasts floor-to-ceiling windows offering incredible views of the surrounding city. With 10 meeting rooms, the largest of which can accommodate 315 guests, this location is ideal for conferences with breakout space and corporate offsites.

The design of Convene 30 S 17th Street is inspired by the city's history and folklore with geometric patterns throughout meant to pay homage to Philadelphia's grid system while jagged edges represent lightning bolts. Not to be outdone, the building lobby features a Lichtenstein sculpture and acclaimed art pieces from a private collection. Convene 30 S 17th Street provides a white box space allowing for client and event branding opportunities, catering with dining private to each event, in-room A/V technology supported by an on-site team, and dedicated hospitality resources.

There are paid parking options nearby and the location is also accessible via Amtrak, SEPTA, and PATCO.

10
MEETING ROOMS

350
FULL BUYOUT CAPACITY

29,000
SQUARE FEET



HIGH SPEED
WIFI



STATE OF THE ART
TECHNOLOGY



FLEXIBLE MEETING
& EVENT SPACE



EVENT PLANNING
SERVICES



ON-SITE
GOURMET CHEF



UNLIMITED ON-SITE
DRINKS & SNACKS



This collateral is based on the latest information reasonably available and may be updated on a periodic basis. Please check with your Convene Account Manager for the latest information.

convene

CONVENE.COM | 888-730-7307

Convene 30 S 17th Street

MEETINGS & EVENTS

30 S 17th Street, Philadelphia, PA 19103

Floorplan & capacities

13TH FLOOR

LEGEND

- BATHROOMS
- PRINTER ROOM
- PHONE ROOM
- COAT CLOSET
- RESPITE ROOM
- ENTRANCE
- ELEVATOR

GENERAL ACCESS

- BATHROOMS & RESPITES

MEETING & EVENT ACCESS

- GALLERY SPACE
- MEETING ROOMS
- NOURISH

WORKPLACE ACCESS

- WORKSUITES
- INTERNAL SUITE
- NOURISH
- COMMON SPACE
- MEETING ROOMS



	DIMENSION [FT]	AREA [SQ FT]	CEILING HT [FT]	RECEPTION (MAX CAPACITY)	THEATER	CLASSROOM	ROUNDS [8-TOP]	U-SHAPE	CONFERENCE	PODS [6-TOP]
Forum	81' x 42'	3,495'	13'	350	315	150	168	-	-	144
Forum with Stage	81' x 42'	3,495'	13'	350	272	150	160	-	-	144
Forum North	40' x 40'	1,760'	13'	-	144	60	72	39	24	72
Forum North with Stage	40' x 40'	1,760'	13'	-	136	48	64	-	-	72
Forum South	40' x 40'	1,735'	13'	-	144	72	72	39	24	72
Forum South with Stage	40' x 40'	1,735'	13'	-	128	60	72	-	-	72
Franklin Square	80' x 25'	2,000'	13'	150	-	-	-	-	-	-

TPA may be required for some meeting room layouts

Convene 30 S 17th Street

MEETINGS & EVENTS

30 S 17th Street, Philadelphia, PA 19103

Floorplan & capacities

14TH FLOOR

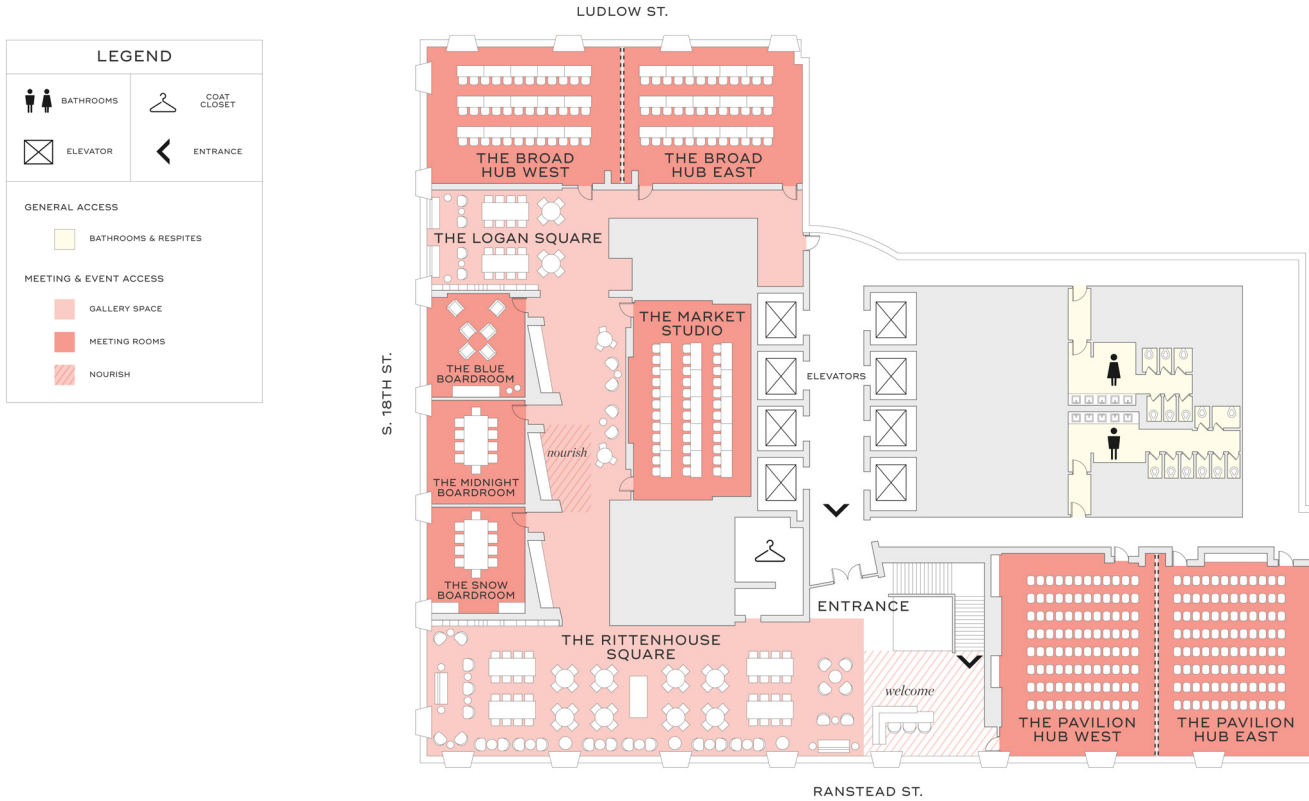

	DIMENSION [FT]	AREA [SQ FT]	CEILING HT [FT]	RECEPTION (MAX OCCUPANCY)	THEATER	CLASSROOM	ROUNDS [8-TOP]	U-SHAPE	CONFERENCE	PODS [6-TOP]
Broad Hub	69' x 26'	1,777'	9'	140	110	60	56	30	44	48
Broad Hub West	36' x 26'	921'	9'	50	56	30	24	18	12	24
Broad Hub East	33' x 26'	856'	9'	50	48	36	24	16	12	16
Midnight Boardroom	19' x 18'	354'	9'	-	-	-	-	-	10	-
Blue Boardroom	19' x 18'	344'	9'	18	18	8	8	6	4	6
Snow Boardroom	19' x 18'	361'	9'	-	-	-	-	-	10	-
Market Studio	22' x 37'	847'	9'	55	55	30	32	18	21	24
Pavillion Hub	58' x 36'	2,237'	9'	182	182	80	112	30	36	72
Pavillion Hub West	28' x 38'	1,136'	9'	91	91	32	48	22	16	24
Pavillion Hub East	29' x 36'	1,101'	9'	96	96	32	48	24	16	24
Rittenhouse Square	80' x 24'	2,021'	9'	130	-	-	-	-	-	-
Logan Square	26' x 19'	670'	9'	20	-	-	-	-	-	-

TPA may be required for some meeting room layouts

This collateral is based on the latest information reasonably available and may be updated on a periodic basis. Please check with your Convene Account Manager for the latest information.

convene

CONVENE.COM | 888-730-7307