

Property Key

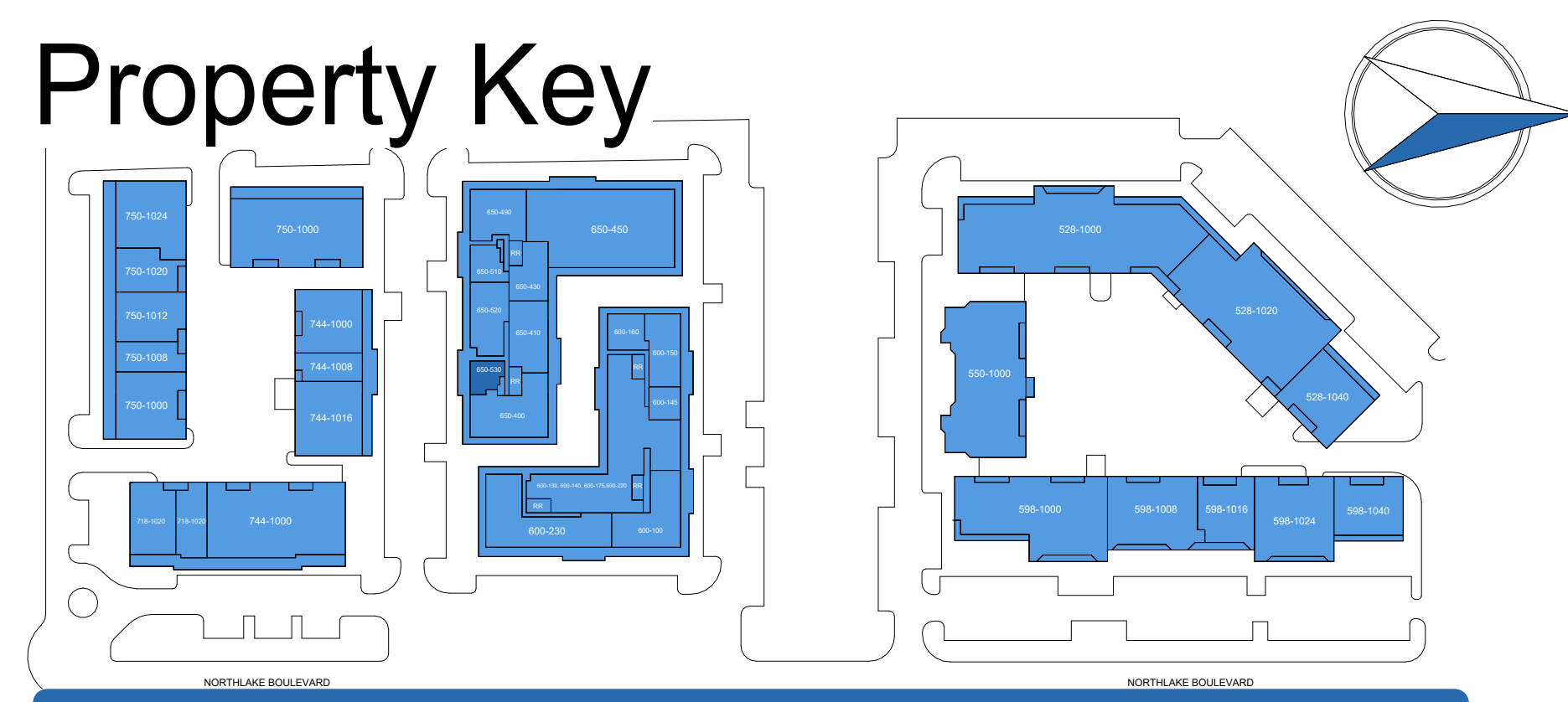

Alt Springs As Built Marketing Package

650 Northlake Blvd, Alt Springs, FL 32701, US

Building: 650

Suite: 530

Sheet **E1**

Scale: Not to Scale
Sheet Size: 42" x 30"
Not For Construction



BAY SPACE

Usable Square Foot Analysis

Office Area	872	87%
Warehouse Area	135	13%
Total Area	1,007	

Building Information

Deck Height:	N/A	
Clear Height:	8' - 6"	
Ceiling Height:	8' - 6"	
Sprinklered:	<input checked="" type="checkbox"/> Yes	<input type="checkbox"/> No
Mechanical Area:	11 SQFT	

