

DANIA BEACH MARINE & DESIGN CENTER

1200-1340 STIRLING RD, DANIA BEACH, FL 33004

1340 #8A&B



BULLETS HEADLINE

- 5,000 SF
- +/- 450 SF of 2 air-conditioned offices
- 4 Dock Doors 10' x 12'
- 2 Private restrooms
- 17' clear ceiling
- Great storage bay
- Impact windows and doors
- On site leasing and management
- East access to I-95 just S of I-595
- CAM includes water and trash



MATT JONES

Senior Vice President
Direct: 954.921.6673 | Cell: 954.682.6288
matt@levyrai.com



DANIA BEACH MARINE & DESIGN CENTER

1200-1340 STIRLING RD, DANIA BEACH, FL 33004

1340 #8A&B FLOOR PLAN

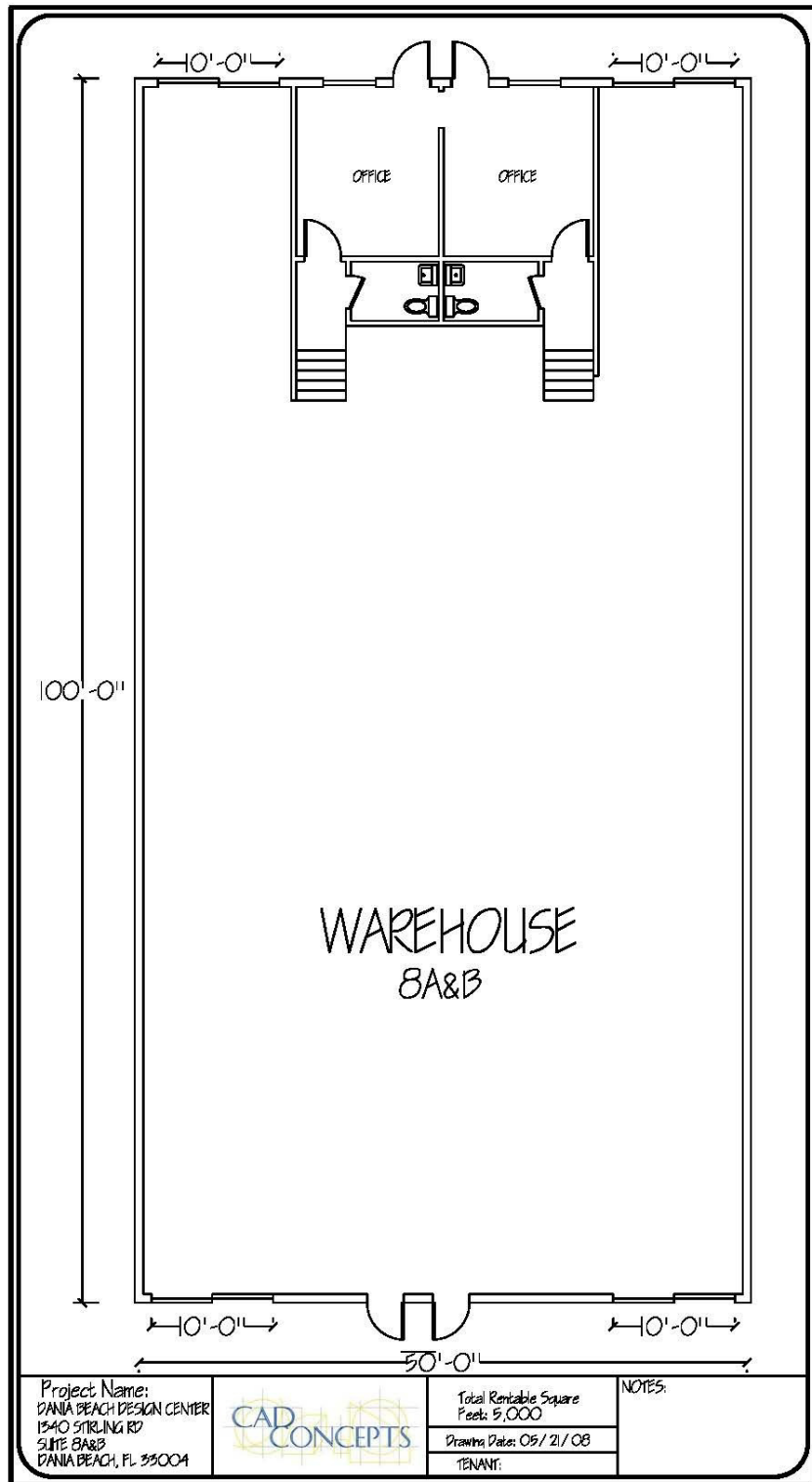

Project Name:
 DANIA BEACH DESIGN CENTER
 1340 STIRLING RD
 SUITE 8A&B
 DANIA BEACH, FL 33004



Total Rentable Square
 Feet: 5,000
 Drawing Date: 09/21/08
 TENANT:

NOTES:

MATT JONES

Senior Vice President
 Direct: 954.921.6673 | Cell: 954.682.6288
 matt@levyrai.com

