

FOR LEASE
±4,200 SF WAREHOUSE SPACE AVAILABLE

718 E. EDNA PLACE
Covina, CA 91723

**RATE JUST
REDUCED!**



- Edna Place Frontage
- Suite A - ±4,200 SF
- Three (3) Private Offices
- Two (2) Ground Level Doors
- 200 Amps (Verify)
- Ideal for Light Manufacturing Uses
- Excellent Access to the I-210, I-10, CA-57, CA-39 Freeways

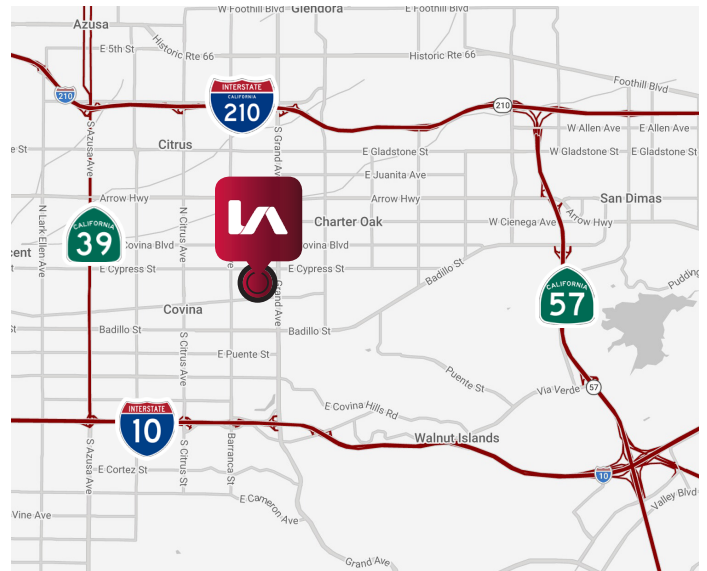

JUSTIN LEWOOD
D (909) 373-2989
jleewood@lee-assoc.com
DRE #01837452

LEE & ASSOCIATES - ONTARIO
Corporate ID: 00976995

LEE & ASSOCIATES
COMMERCIAL REAL ESTATE SERVICES

lee-associates.com

All information furnished regarding property for sale, rental or financing is from sources deemed reliable, but no warranty or representation is made to the accuracy thereof and same is submitted to errors, omissions, change of price, rental or other conditions prior to sale, lease or financing or withdrawal without notice. No liability of any kind is to be imposed on the broker herein.

FOR LEASE

±4,200 SF WAREHOUSE SPACE AVAILABLE

718 E. EDNA PLACE

Covina, CA 91723

FLOOR PLAN

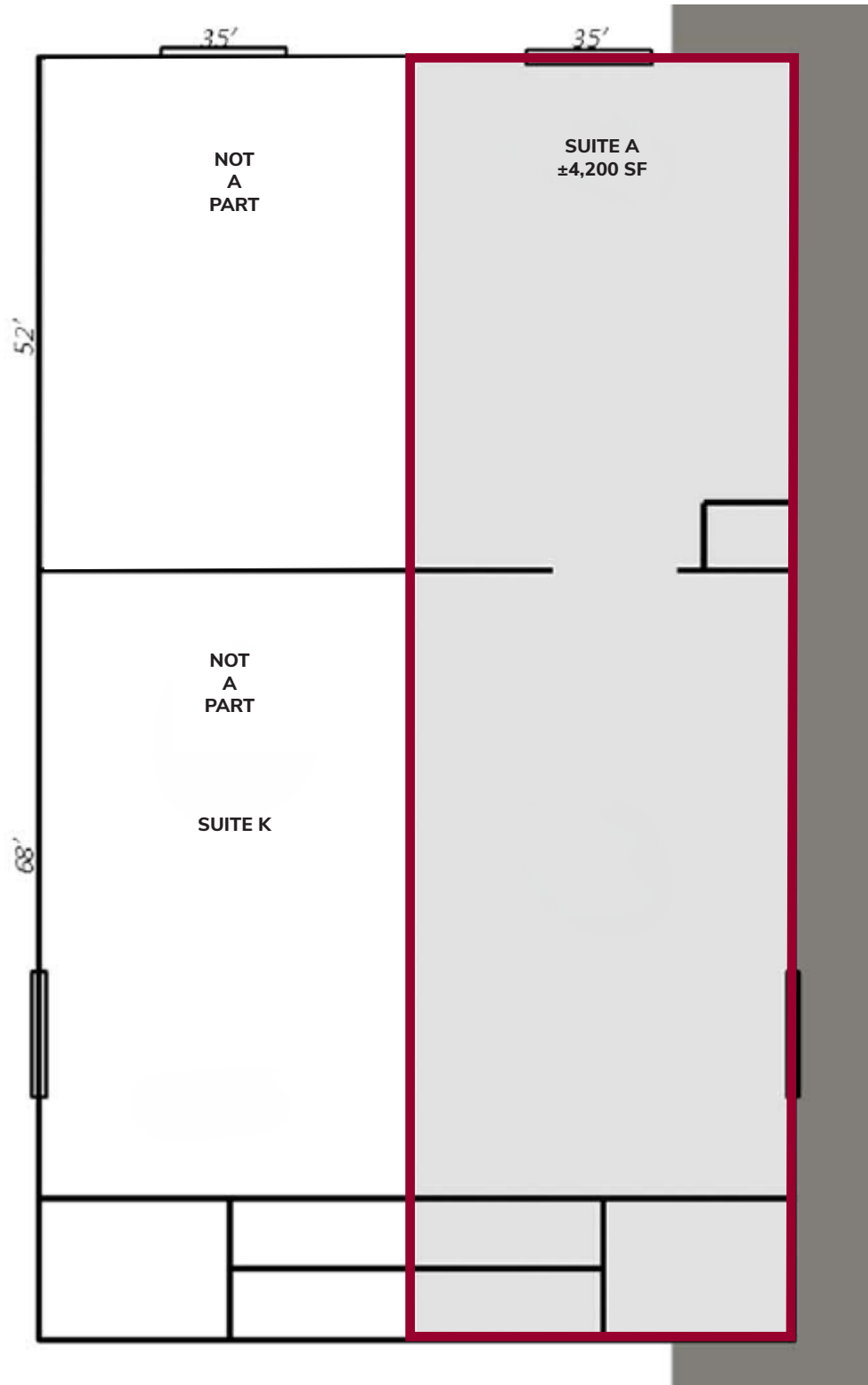

JUSTIN LEEWOOD

D (909) 373-2989

jleewood@lee-assoc.com

DRE #01837452

LEE & ASSOCIATES - ONTARIO

Corporate ID: 00976995

LEE & ASSOCIATES

COMMERCIAL REAL ESTATE SERVICES