

±2,080 SF - ±10,400 SF INDUSTRIAL UNITS

City of Fontana

NEW CONSTRUCTION | UNITS NEVER BEEN OCCUPIED

15252 VALLEY BLVD. FONTANA, CA 92335

FOR LEASE



Property Highlights

- ±2,080 SF - ±10,400 SF Available
- Units Can Be Combined
- 20' Clear Height
- One (1) Ground-Level Loading Door Per Unit
- 3.0 / 1,000 SF Parking Ratio
- Zoning:
Southwest Industrial Park Specific Plan (SWIP)

PERMITTED USES:

Warehouse / Distribution / Light Manufacturing /
Research & Development



LEE & ASSOCIATES
COMMERCIAL REAL ESTATE SERVICES

PAT BOGAN
Senior Vice President | LIC ID 01215727
pbogan@lee-associates.com
909.245.1480

STEVE COULTER
Senior Vice President | LIC ID 01229849
scoulter@lee-associates.com
909.287.3488

CARLOS LEYVA
LIC ID 02121441
cleyva@lee-associates.com
714.718.3982

JAMIE SCOTT
LIC ID 02228289
jscott@lee-associates.com
714.343.1999

±2,080 SF - ±10,400 SF INDUSTRIAL UNITS

City of Fontana

NEW CONSTRUCTION | UNITS NEVER BEEN OCCUPIED

15252 VALLEY BLVD. FONTANA, CA 92335

Property Site Plan

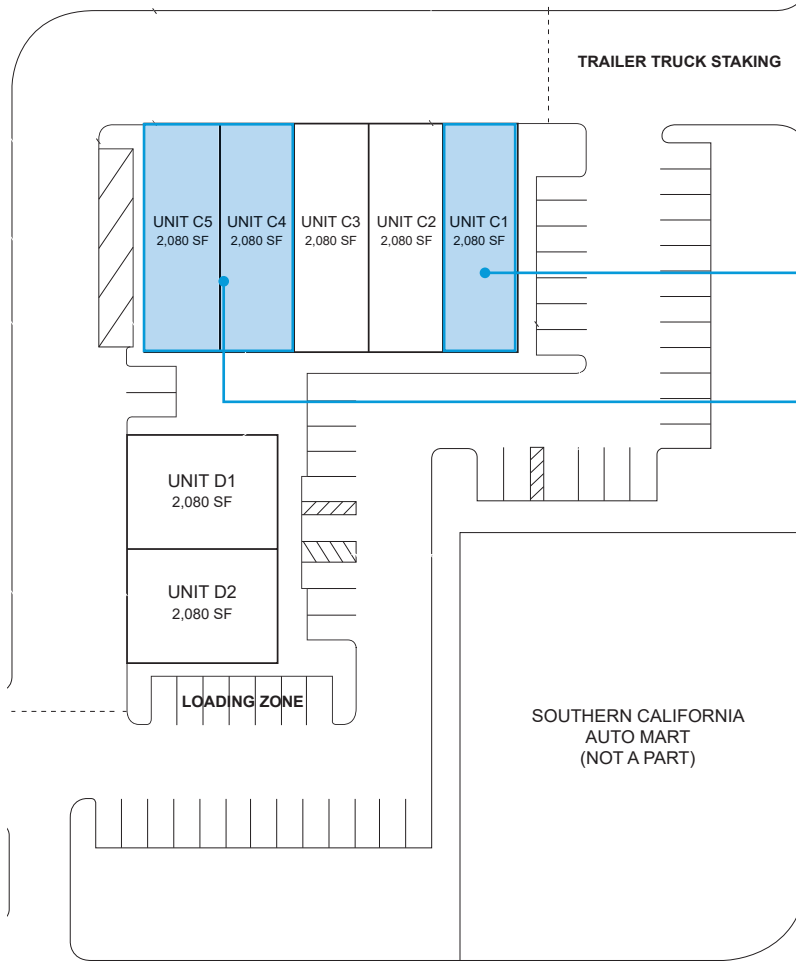

Unit Sizing Options

- ±2,080 SF
Individual Unit
- ±4,160 SF
Two Combined Units
- ±6,240 SF
Three Combined Units
- ±8,320 SF
Four Combined Units
- ±10,400 SF
Five Combined Units
(Entire Building C)

VALLEY BLVD

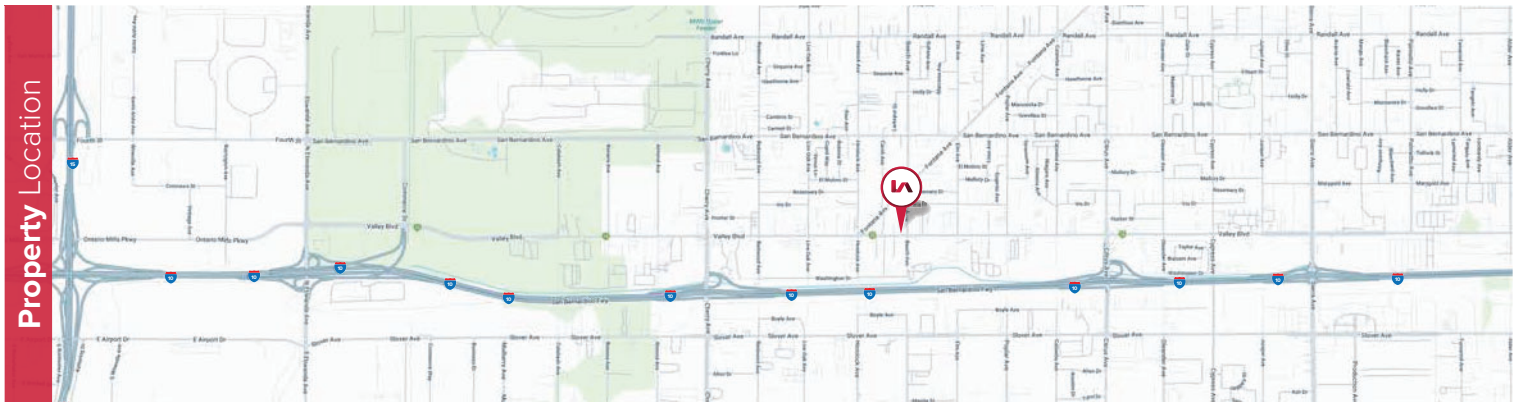

PAT BOGAN
Senior Vice President | LIC ID 01215727
pbogan@lee-associates.com
909.245.1480

STEVE COULTER
Senior Vice President | LIC ID 01229849
scoulter@lee-associates.com
909.287.3488

CARLOS LEYVA
LIC ID 0212441
cleyva@lee-associates.com
714.718.3982

JAMIE SCOTT
LIC ID 02228289
jscott@lee-associates.com
714.343.1999

±2,080 SF - ±10,400 SF INDUSTRIAL UNITS

City of Fontana

NEW CONSTRUCTION | UNITS NEVER BEEN OCCUPIED

15252 VALLEY BLVD. FONTANA, CA 92335

Property Floor Plan

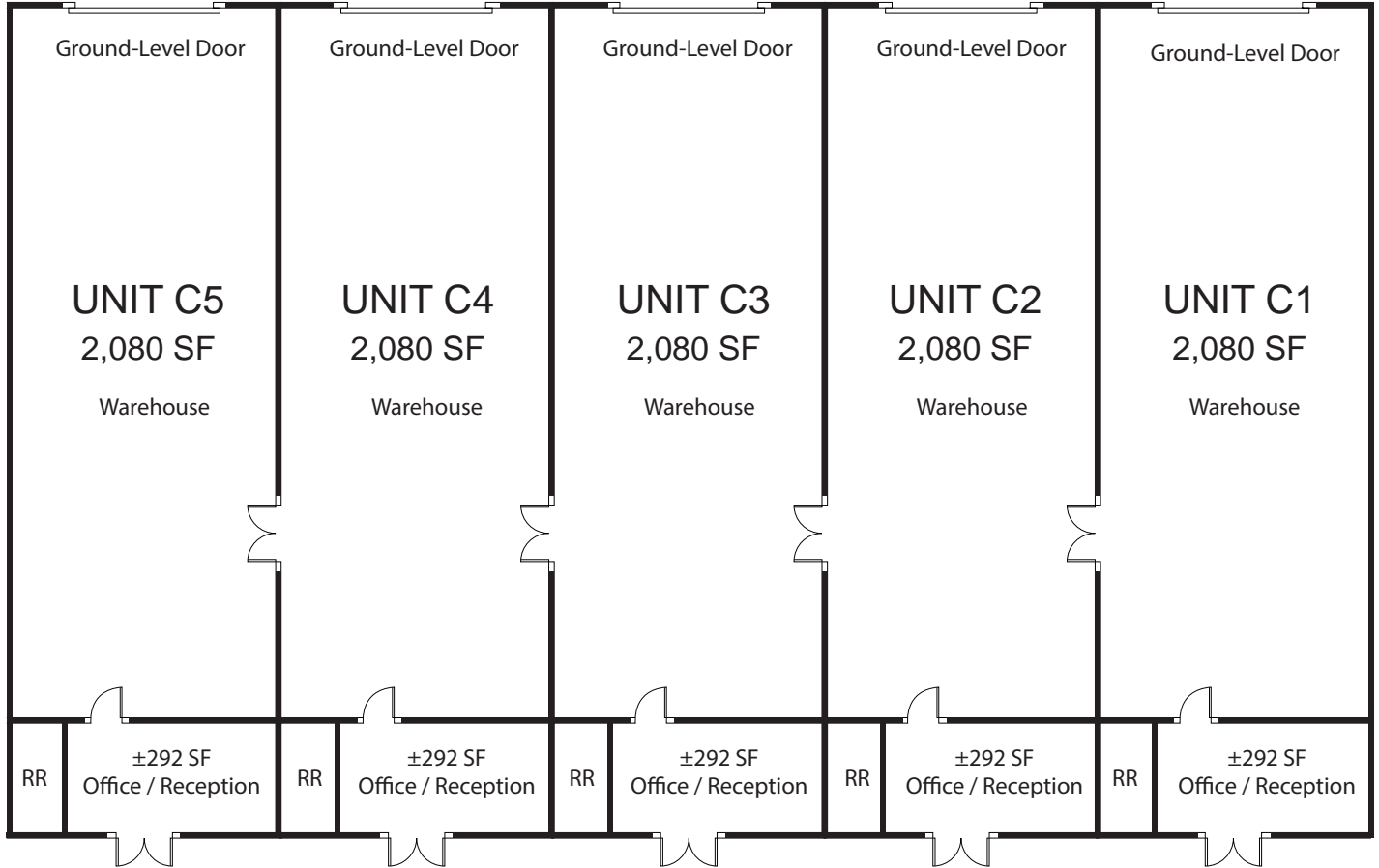

PAT BOGAN
Senior Vice President | LIC ID 01215727
pbogan@lee-associates.com
909.245.1480

STEVE COULTER
Senior Vice President | LIC ID 01229849
scoulter@lee-associates.com
909.287.3488

CARLOS LEYVA
LIC ID 02121441
cleyva@lee-associates.com
714.718.3982

JAMIE SCOTT
LIC ID 02228289
jscott@lee-associates.com
714.343.1999