

DEMOLITION PLAN

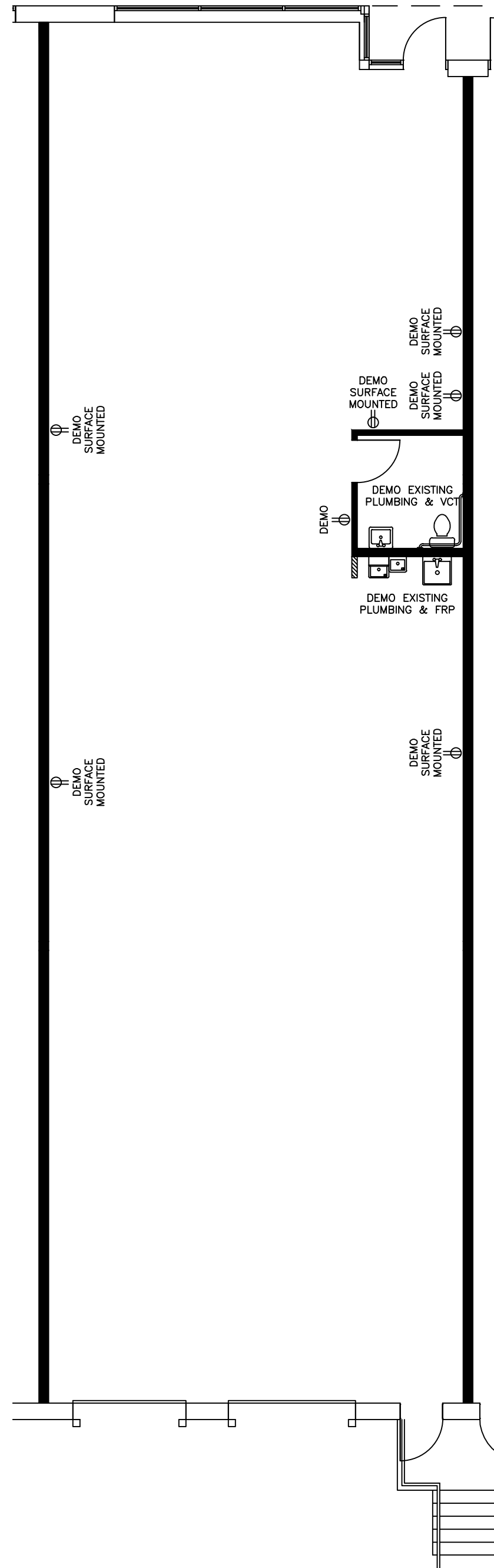

CONSTRUCTION PLAN

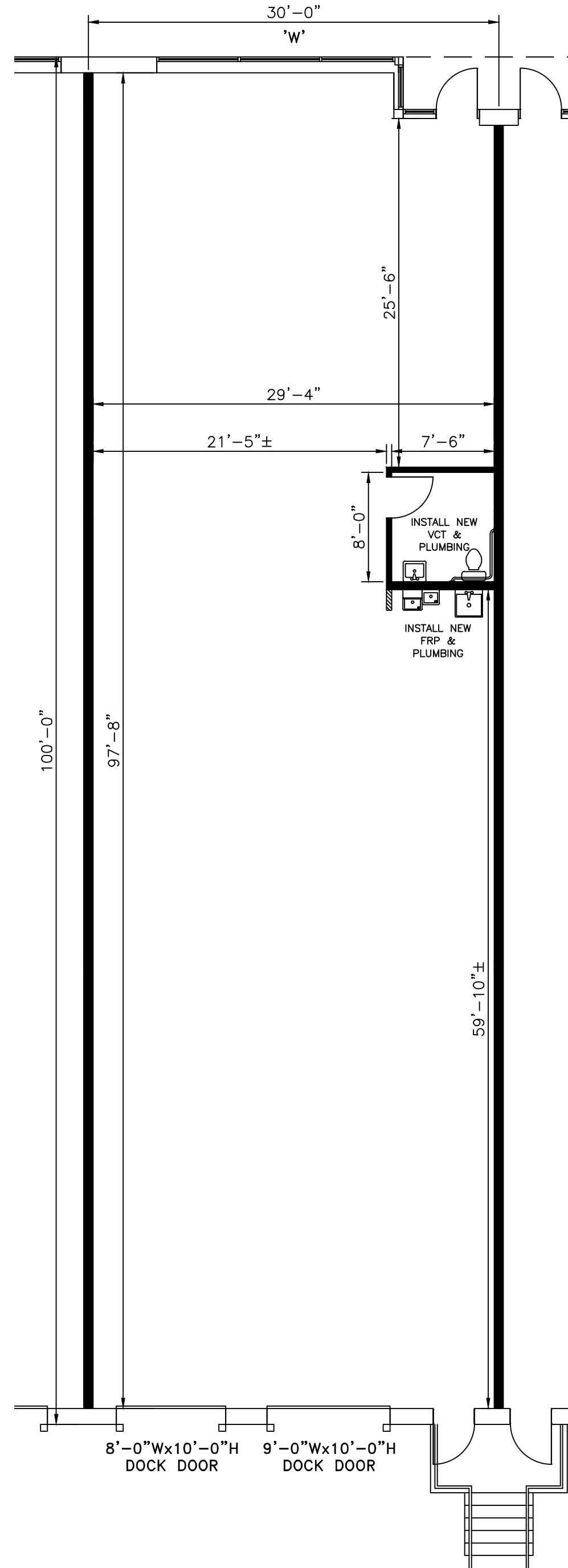

DEMOLITION NOTES:

1. DEMO EXISTING PLUMBING
2. DEMO EXISTING FRP BOARDS AT JAN. SINK
3. REMOVE ALL DAMAGE (INCLUDING WATER & MOLD) DRYWALL
4. DEMO OUTLETS AND CONDUIT AS SHOWN ON THE DEMOLITION PLAN
5. DEMO EXISTING VCT & COVE BASE
6. DEMO EXISTING DAMAGED DOCK BUMPERS

GENERAL NOTES:

1. CHECK ALL EXISTING LIGHTS AND EMERGENCY LIGHTS TO MAKE SURE THEY ARE SJP STANDARDS. REPLACE TO SJP STANDARDS IF NEEDED
2. NEW PLUMBING PER SJP STANDARD FIXTURES
3. NEW FRP AT JAN. SINK PER SJP STANDARD
4. INSTALL NEW DOCK BUMPERS
5. REPLACE WATER DAMAGE & ALL OTHER DAMAGED DRYWALL
6. INSTALL NEW VCT, 12"x12" ARMSTRONG VCT
COLOR: #51875, MID GRAYED BLUE
7. INSTALL NEW COVE BASE, 4"H JOHNSONITE
COLOR: #20, CHARCOAL
8. PAINT WAREHOUSE PARTITIONS TO 10'-0"off (TAPE COAT) & INCLUDING THE EXTERIOR RESTROOM PARTITIONS & LOW PARTITION (FINISHED)
COLOR: #100, SUPER WHITE
9. PAINT RESTROOM PARTITIONS, DOOR FRAME & DOORS, SEE COLORS ON A.2
10. TALK TO PROPERTY MANAGEMENT ABOUT REAR STAIRS (TO MATCH SURE THEY ARE ON THE REPAIR LIST)

NOTE: THIS SPACE PLAN IS SUBJECT TO EXISTING FIELD CONDITIONS.

THIS DRAWING IS PROPRIETARY AND THE EXCLUSIVE PROPERTY OF ST. JOHN PROPERTIES, INC. ANY DUPLICATION, DISTRIBUTION, OR OTHER UNAUTHORIZED USE IS STRICTLY PROHIBITED.

SOME ITEMS SHOWN ON THIS PLAN ARE FOR LAYOUT AND PERMITTING PURPOSES ONLY. ST. JOHN PROPERTIES IS NOT RESPONSIBLE FOR PROVIDING OR INSTALLING APPLIANCES, PHONES, COMPUTER WIRING, SECURITY, FURNITURE, SYSTEM FURNITURE, SHELVING, EQUIPMENT AND/OR CUSTOM BUILT-INS. POWER IS 200AMPS PER BAY. FLOOR PLAN MAY BE FIELD ADJUSTED DUE TO EXISTING CONDITIONS NOT SHOWN ON THE PLAN.

CONSTRUCTION PLAN

SCALE: 1/8"=1'-0"
DRAWN: CET
DATE: 7/16/2025
CADFILE: 8420_W_
WHITEBOX

WHITEBOX
8420 GAS HOUSE PIKE
SUITE 'W'
RIVERSIDE TECHNOLOGY PARK
FREDERICK, MD 21701



ST. JOHN PROPERTIES
5104 PEGASUS COURT
SUITE 'A'
FREDERICK, MD 21704
OFFICE: (301) 682-9215

DEMOLITION & CONSTRUCTION PLAN
TOTAL: 3,000 SQ.FT.
WHSE: 3,000 SQ.FT.

DRAWING NO.
A.1