

# 30012

IVY GLENN, LAGUNA NIGUEL

**FOR LEASE**



**LA** LEE &  
ASSOCIATES  
COMMERCIAL REAL ESTATE SERVICES

**OC**  
OFFICE GROUP

**ALLEN BASSO**  
Senior Vice President  
Lic. #01298152  
949.790.3130  
abasso@leeirvine.com

**ERIC DARNELL**  
Senior Vice President  
Lic. #01888743  
949.460.3681  
edarnell@leeirvine.com

**KYLEE KING**  
Vice President  
Lic. #02101275  
949.790.3108  
kking@leeirvine.com

## PROPERTY FEATURES

- ±25,865 SF Freestanding Two-Story Office Building
- Excellent Glass Line and Natural Light
- Beautifully Maintained and Professionally Managed
- Ample Free Surface Parking with 100 Surface Stalls
- Walk to a Variety of Retail, Dining and Residential
- Minutes from High End Coastal Communities
- Near Planned Site of Laguna Niguel City Center

**LEASE RATE: \$2.75 PSF FULL SERVICE GROSS**



# FIRST FLOOR FLOORPLAN

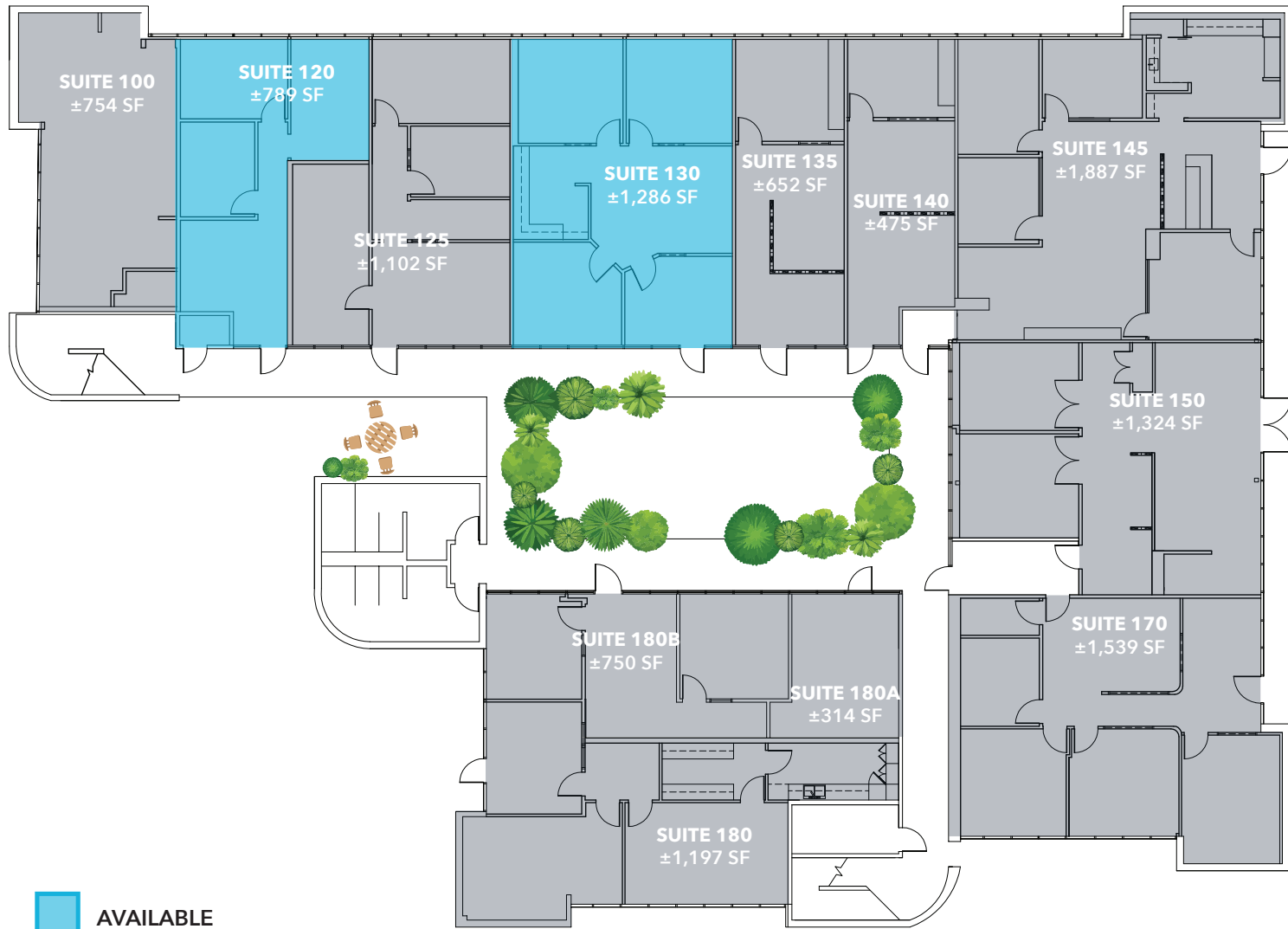

LEASED

AVAILABLE

