



Keegan & Coppin
COMPANY, INC.

FOR LEASE

620 CARLSON COURT
ROHNERT PARK, CA

Warehouse Storage Space
for Lease



Go beyond broker.

REPRESENTED BY:

MATT STORMS, PARTNER
LIC # 01233478 (415) 461-1010, EXT 123
MSTORMS@KEEGANCOPPIN.COM

DEMI BASILIADES, SREA
LIC # 02080190 (707) 664-1400, EXT 305
DBASILIADES@KEEGANCOPPIN.COM



WAREHOUSE STORAGE SPACE FOR LEASE



620 CARLSON COURT
ROHNERT PARK, CA

WAREHOUSE STORAGE SPACE FOR LEASE

PROPERTY INFORMATION

HIGHLIGHTS

- Rack System in Place
- Drive Through Access
- 17 Foot Clear Height
- Fenced Yard
- Roll Up Doors
- Sprinklered
- Industrial Zoning

WAREHOUSE SPACE

Unit B: 6,243+/- sq ft

DESCRIPTION

Perfect high cube storage space.

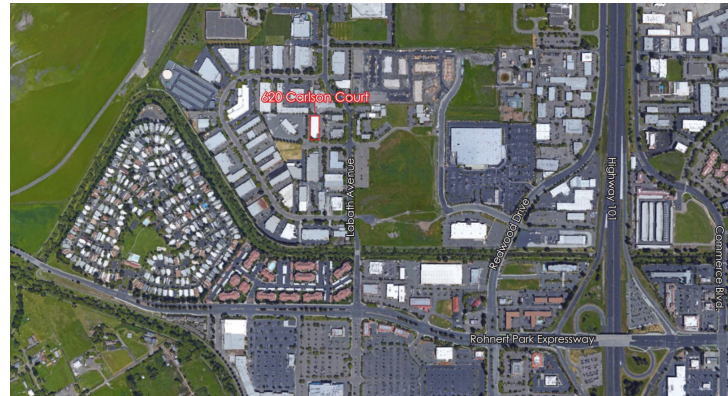

LEASE TERMS

Size

6,243+/- sq ft

Rate

\$1.00 per sq ft

Terms

Industrial Gross

Parking

10 parking spots

Keegan & Coppin Co., Inc.
 101 Larkspur Landing Circle, Ste. 112
 Larkspur, CA 94939
 www.keegancoppin.com
 (415) 461-1010

The above information, while not guaranteed, has been secured from sources we believe to be reliable. Submitted subject to error, change or withdrawal. An interested party should verify the status of the property and the information herein.

REPRESENTED BY:

MATT STORMS, PARTNER
 LIC # 01233478 (415) 461-1010, EXT 123
 MSTORMS@KEEGANCOPPIN.COM

DEMI BASILIADES, SREA
 LIC # 02080190 (707) 664-1400, EXT 305
 DBASILIADES@KEEGANCOPPIN.COM



FLOOR PLAN



620 CARLSON COURT
ROHNERT PARK, CA

**WAREHOUSE STORAGE
SPACE FOR LEASE**

UNIT B (BAYS 3 & 4)
6,243+/- SQ FT

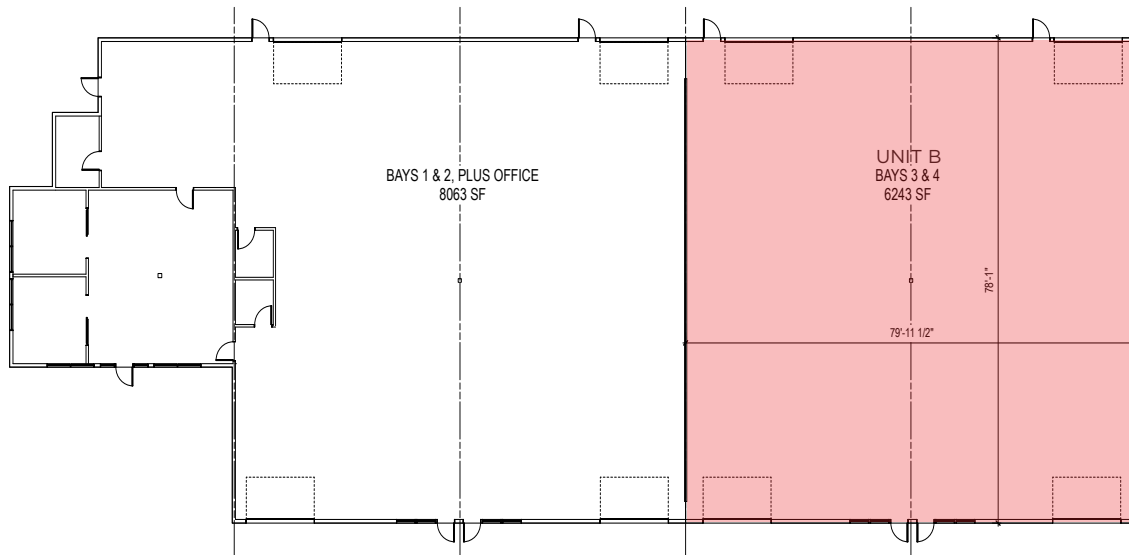

REPRESENTED BY:

MATT STORMS, PARTNER
KEEGAN & COPPIN CO., INC.
LIC # 01233478 (415) 461-1010, EXT 123
MSTORMS@KEEGANCOPPIN.COM

DEMI BASILIADES, SREA
KEEGAN & COPPIN CO., INC.
LIC # 02080190 (707) 664-1400, EXT 305
DBASILIADES@KEEGANCOPPIN.COM