



1922 N. Helm Avenue, Fresno, CA

# Office/Warehouse Space Available **For Sublease**

## Fresno Airport Business Park

- Approximately ±12,265 SF available
- Building fully sprinklered
- Fresno Airport area
- Walking distance to Air Terminal
- Near hotels, restaurants & services
- Near Freeway 180/168 on/off ramps

Accelerating success.

Asking:

# \$1.10

PSF, Modified Gross  
(Plus Utilities & Janitorial Service)

**Bobby Fena** SIOR

+1 559 256 2436

bobby.fena@colliers.com

DRE #00590204

**Beau Plumlee**

+1 559 256 2443

beau.plumlee@colliers.com

DRE #01269167



# Floor Plan

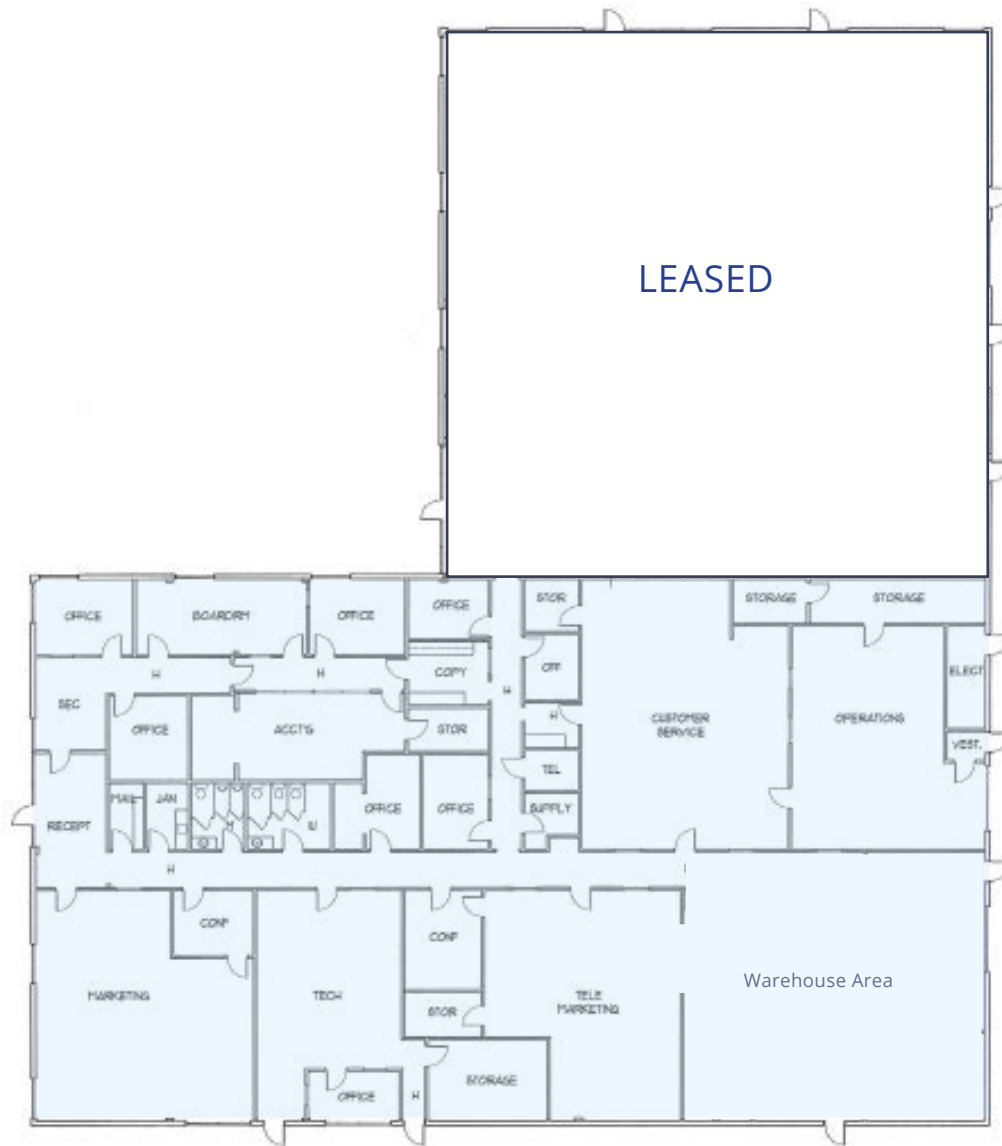

## Amenities

- Office build-out
- Acoustical ceiling system
- Recessing lighting
- Fire sprinklers
- Good access
- Concrete masonry construction
- Easy accessible parking

1922 N. Helm Ave.  
Fresno, California

## Property Summary

Building Size: ±12,265 SF

Zoning: IL (Light Industrial - Business Park),  
City of Fresno

Lease Rate: \$1.10 PSF, per month,  
Modified Gross

Available: Immediately

Parking: On-site parking in several areas

This document has been prepared by Colliers for advertising and general information only. Colliers makes no guarantees, representations or warranties of any kind, expressed or implied, regarding the information including, but not limited to, warranties of content, accuracy and reliability. Any interested party should undertake their own inquiries as to the accuracy of the information. Colliers excludes unequivocally all inferred or implied terms, conditions and warranties arising out of this document and excludes all liability for loss and damages arising there from. This publication is the copyrighted property of Colliers and/or its licensor(s). Copyright © 2024. All rights reserved. This communication is not intended to cause or induce breach of an existing listing agreement. Colliers Tingey International, Inc.

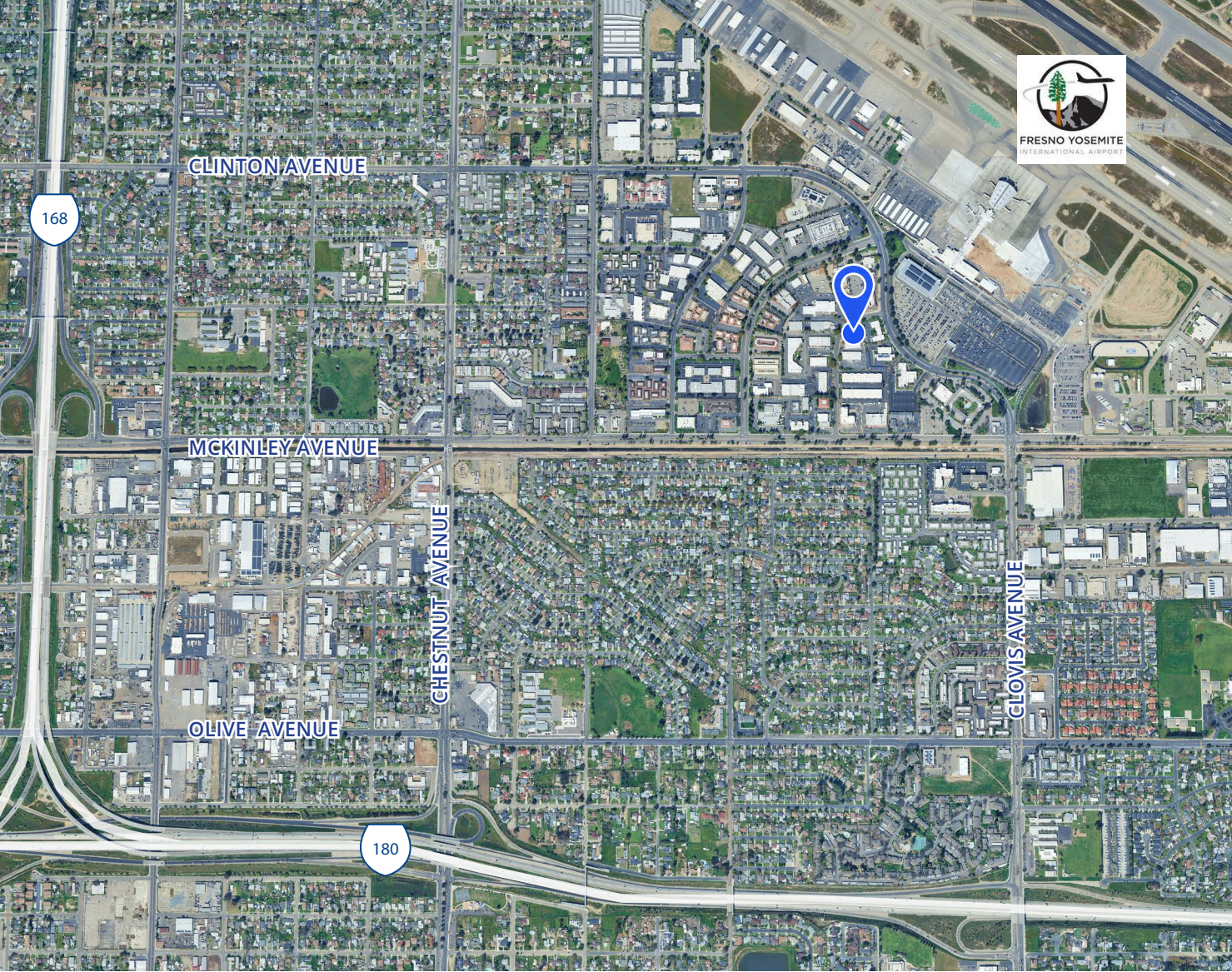

For Sublease



1922  
N. Helm Avenue  
Fresno, California

**Bobby Fena** <sup>SIOR</sup>  
+1 559 256 2436  
bobby.fena@colliers.com  
DRE #00590204

**Beau Plumlee**  
+1 559 256 2443  
beau.plumlee@colliers.com  
DRE #01269167

**Colliers**  
7485 N. Palm Ave., #110  
Fresno, California 93711  
+1 559 221 1271

This document has been prepared by Colliers for advertising and general information only. Colliers makes no guarantees, representations or warranties of any kind, expressed or implied, regarding the information including, but not limited to, warranties of content, accuracy and reliability. Any interested party should undertake their own inquiries as to the accuracy of the information. Colliers excludes unequivocally all inferred or implied terms, conditions and warranties arising out of this document and excludes all liability for loss and damages arising there from. This publication is the copyrighted property of Colliers and/or its licensor(s). Copyright © 2024. All rights reserved. This communication is not intended to cause or induce breach of an existing listing agreement. Colliers Tingey International, Inc.

