

# MERCURY TECH CENTER

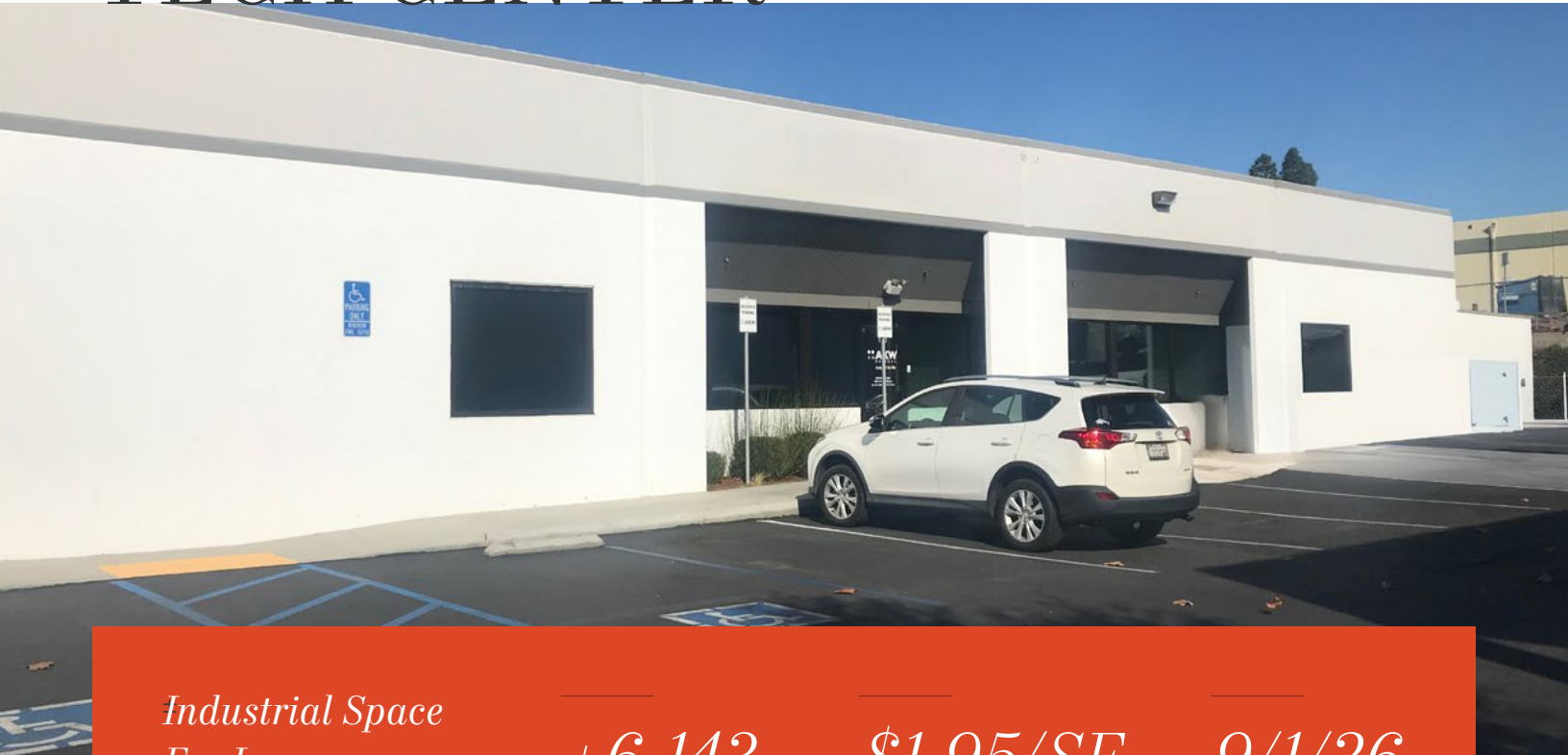

*Industrial Space  
For Lease*

**±6,143**  
AVAILABLE SF

**\$1.95/SF**  
LEASE RATE (NNN \$0.61)

**9/1/26**  
AVAILABLE DATE

±6,143 SF available

Approximately 25% office and 75% HVAC  
warehouse/ R&D area

One (1) grade level roll up door and one (1) glassed in  
grade level door

Walking distance to abundant retail amenities

Fully sprinklered

Robust fiber to project

Abundant on-site and street parking

IS-1-1 zoning allows variety of uses

Lease Rate: \$1.95/SF NNN (\$0.61/SF)

**MICKEY MORERA**  
858.369.3030  
mickey.morera@kidder.com  
LIC N° 00950071

**JAMES DUNCAN**  
858.369.3015  
james.duncan@kidder.com  
LIC N° 01253770

**DANNA TIU**  
858.369.3004  
danna.tiu@kidder.com  
LIC N° 02153012

**KIDDER.COM**

This information supplied herein is from sources we deem reliable. It is provided without any representation, warranty, or guarantee, expressed or implied as to its accuracy. Prospective Buyer or Tenant should conduct an independent investigation and verification of all matters deemed to be material, including, but not limited to, statements of income and expenses. Consult your attorney, accountant, or other professional advisor.

# SITE PLAN

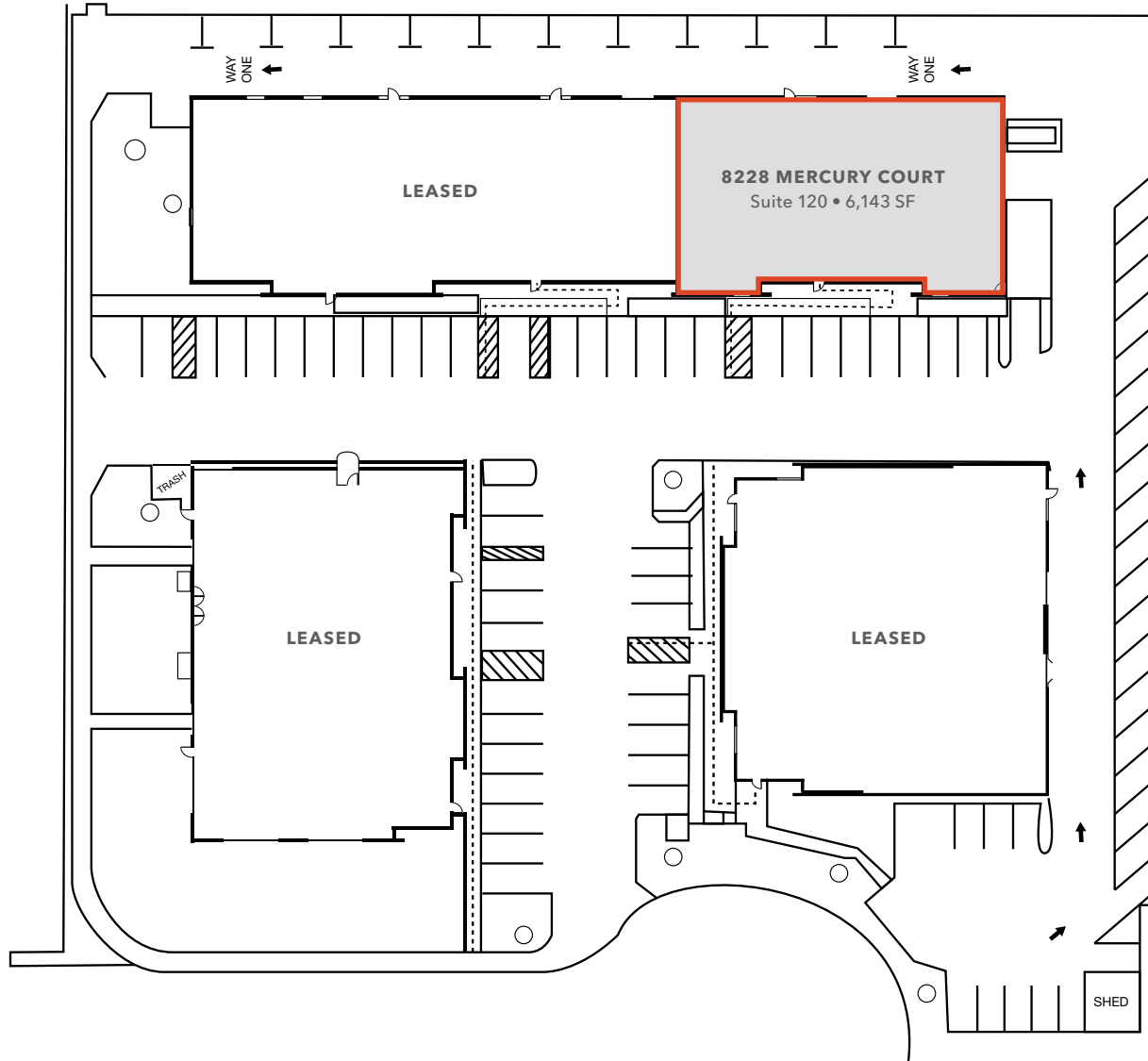

## SUITE AVAILABILITY

	Total SF	Office	Warehouse	Monthly Base Rent	NNN	Date Available
SUITE 120	6,143	25%	75%	\$1.95/SF	\$0.61 PSF	9/1/2026

**MICKEY MORERA**  
 858.369.3030  
 mickey.morera@kidder.com  
 LIC N° 00950071

**JAMES DUNCAN**  
 858.369.3015  
 james.duncan@kidder.com  
 LIC N° 01253770

**DANNA TIU**  
 858.369.3004  
 danna.tiu@kidder.com  
 LIC N° 02153012

## KIDDER.COM



This information supplied herein is from sources we deem reliable. It is provided without any representation, warranty, or guarantee, expressed or implied as to its accuracy. Prospective Buyer or Tenant should conduct an independent investigation and verification of all matters deemed to be material, including, but not limited to, statements of income and expenses. Consult your attorney, accountant, or other professional advisor.

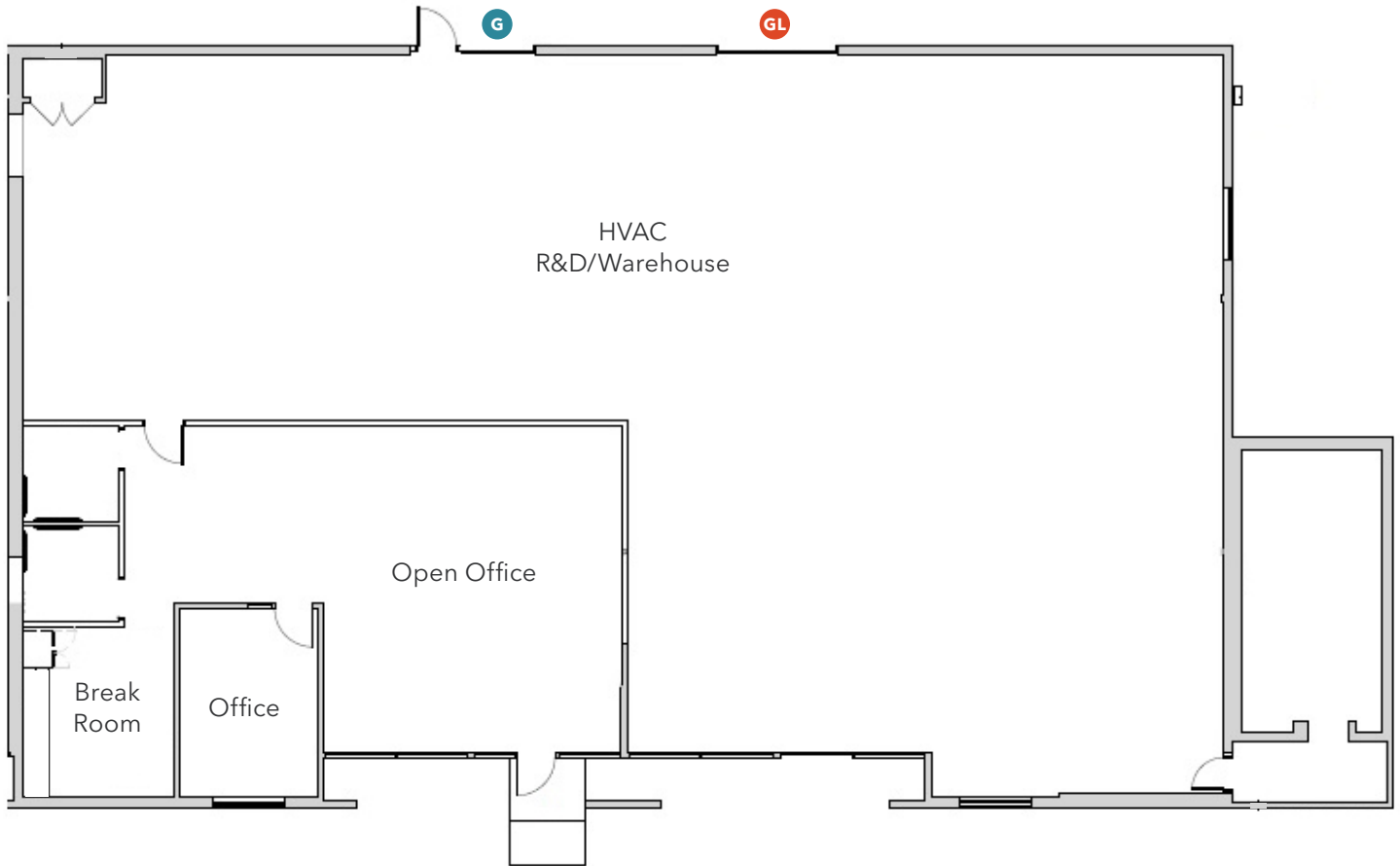

# SUITE 120 | FLOOR PLAN



## LEGEND

-  Grade Level Door
-  Glassed In Grade Level Door

**MICKEY MORERA**  
858.369.3030  
mickey.morera@kidder.com  
LIC N° 00950071

**JAMES DUNCAN**  
858.369.3015  
james.duncan@kidder.com  
LIC N° 01253770

**DANNA TIU**  
858.369.3004  
danna.tiu@kidder.com  
LIC N° 02153012

**KIDDER.COM**

This information supplied herein is from sources we deem reliable. It is provided without any representation, warranty, or guarantee, expressed or implied as to its accuracy. Prospective Buyer or Tenant should conduct an independent investigation and verification of all matters deemed to be material, including, but not limited to, statements of income and expenses. Consult your attorney, accountant, or other professional advisor.



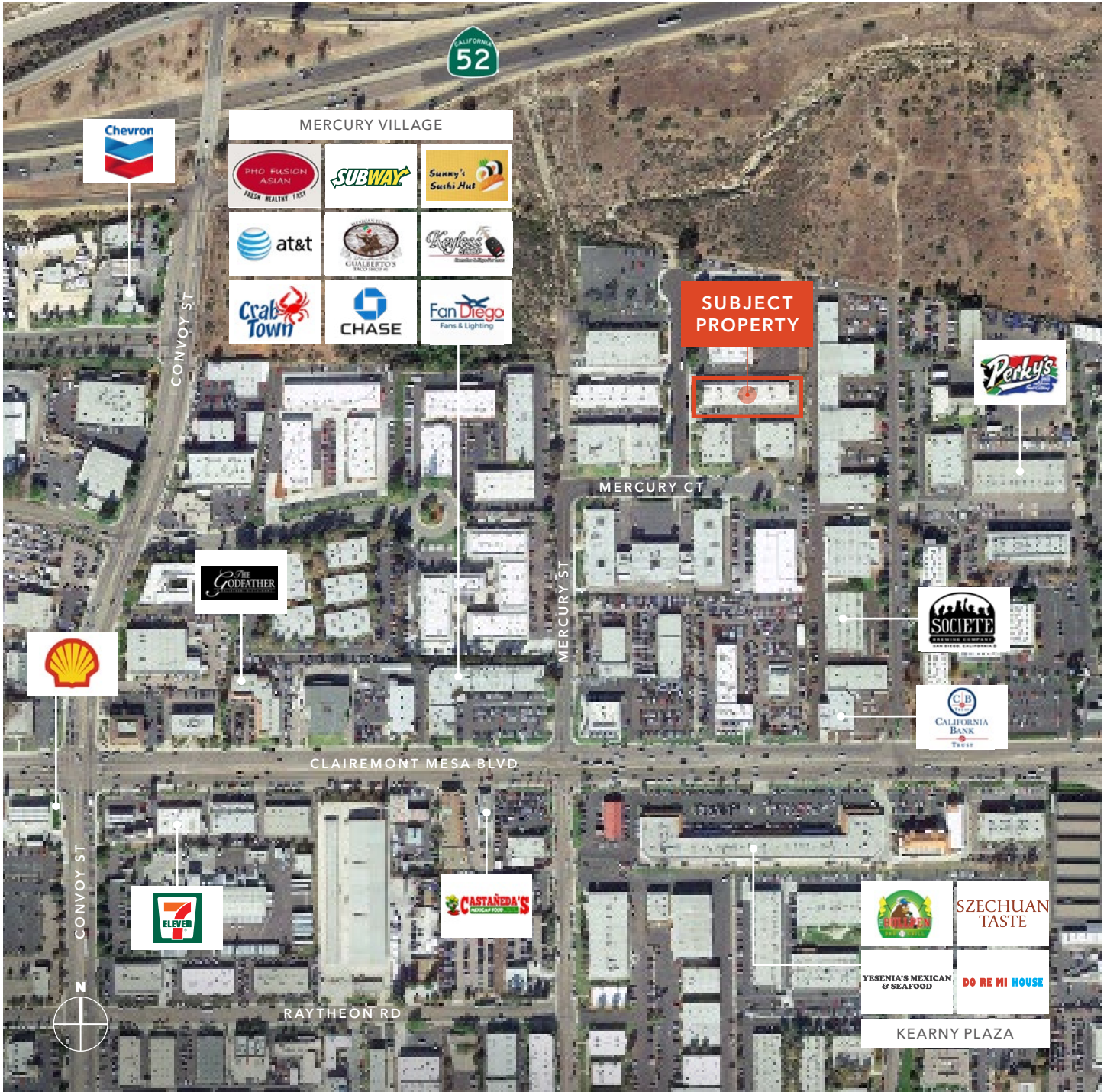

**MICKEY MORERA**  
 858.369.3030  
 mickey.morera@kidder.com  
 LIC N° 00950071

**JAMES DUNCAN**  
 858.369.3015  
 james.duncan@kidder.com  
 LIC N° 01253770

**DANNA TIU**  
 858.369.3004  
 danna.tiu@kidder.com  
 LIC N° 02153012

**KIDDER.COM**

This information supplied herein is from sources we deem reliable. It is provided without any representation, warranty, or guarantee, expressed or implied as to its accuracy. Prospective Buyer or Tenant should conduct an independent investigation and verification of all matters deemed to be material, including, but not limited to, statements of income and expenses. Consult your attorney, accountant, or other professional advisor.

