



BUILDING B

CASTLE MEADOW CAMPUS

Castle Meadow Road | Nottingham | NG2 1AB

Prime office accommodation
Ready for tenant fit-out

PRELIMINARY
DETAILS

AVAILABLE
FROM 2026
TO LET

NG Chartered
Surveyors

BL★CKSTAR
ADVISORY
STRATEGIC REAL ESTATE ADVICE

 University of
Nottingham
UK | CHINA | MALAYSIA

Capable of single or multiple occupation | Suites from 372 sq m (4,000 sq ft) to 6,975 sq m (75,000 sq ft)

LOCATION

Castle Meadow Campus is conveniently located just south of Nottingham city centre's retail core and close to Nottingham Train Station, NET Tram Terminus and Broad Marsh Bus Station. The Campus is well situated for the inner ring road providing access to J24 (via the A453) and J25 (via the A610) of the M1 motorway.

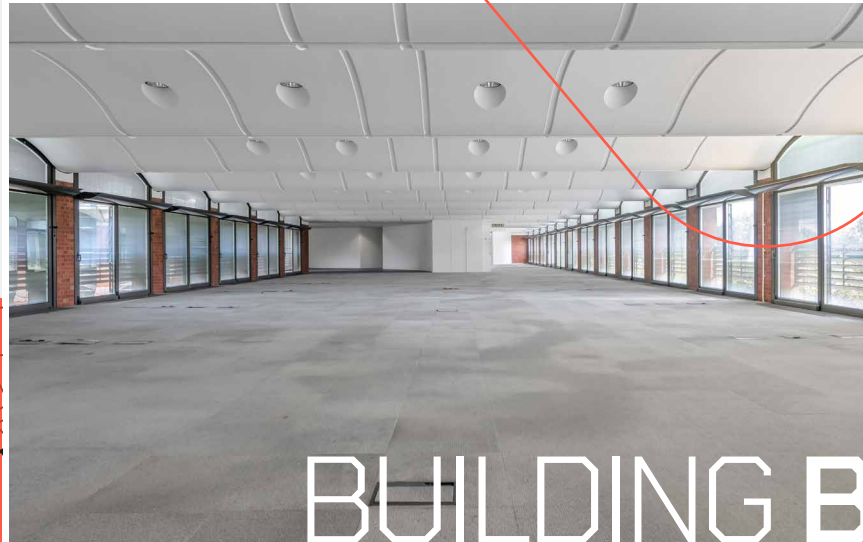
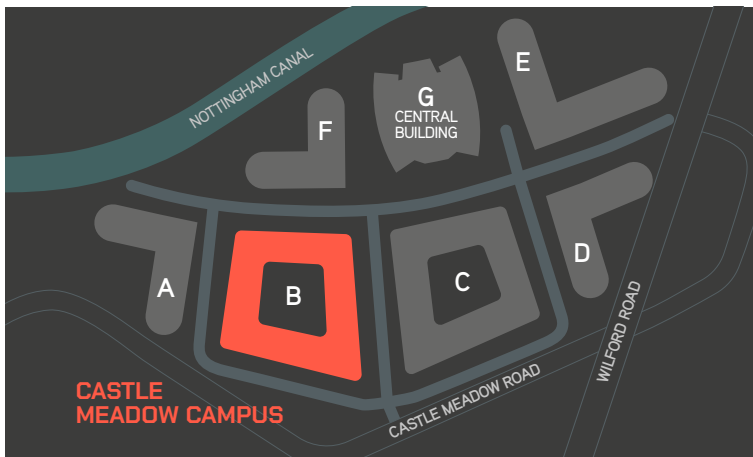
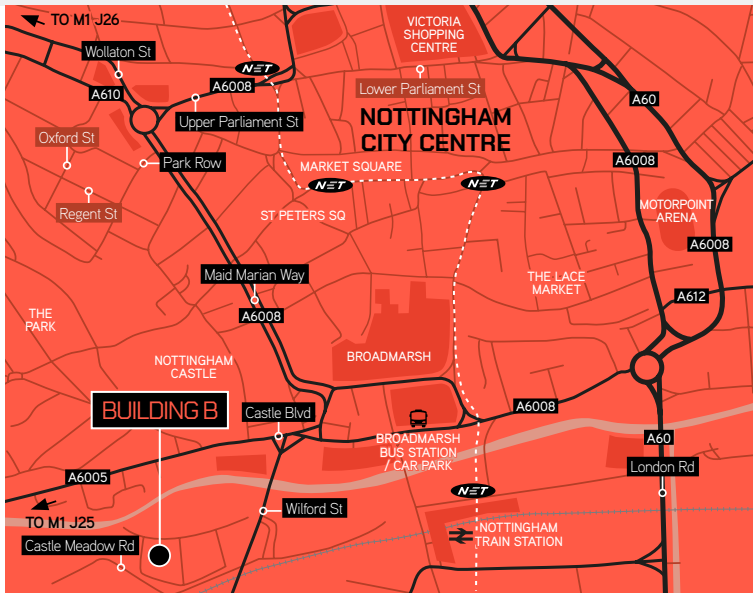

DESCRIPTION

Building B was completed in 1994 and has previously been occupied by HM Revenue & Customs and The University of Nottingham. The space is currently stripped back and available immediately for any incoming tenant to undertake their own bespoke fit out.

**Suites from
372 - 6,975 sq m**
(4,000 - 75,000 sq ft)

Castle Meadow Campus now benefits from the fully refurbished Central Building operated by Nottingham Ventures providing a bookable event space, conferencing facilities, immersive room, restaurant, café and seminar rooms.

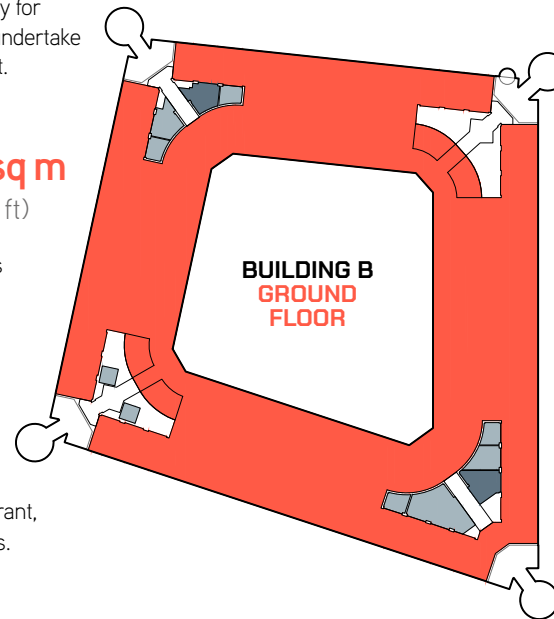

VIEWING

For further information contact the joint letting agents



THOMAS SZYMKIW
07564 580 300
thomas@ng-cs.com

RICHARD SUTTON
07977 121 340
richards@ng-cs.com

CHARLOTTE STEGGLES
07954 996 197
charlotte@ng-cs.com



TIM GARRATT
07775 845 331
tim@blackstaradvisory.com

PROPERTY MISDESCRIPTION ACT 1. All statements contained in these particulars as to this property are made without responsibility on part of NG Chartered Surveyors, their joint agent or the Vendor or Lessors. All statements are made subject to contract and form no part of any contract or warranty. 2. These particulars have been prepared in good faith, to give a fair overall view of the property. If any points are particularly relevant to your interest in the property, please ask for further information and verification. These particulars are believed to be correct, but their accuracy is not guaranteed. 3. Nothing in these particulars shall be deemed to be a statement that the property is in good structural condition or otherwise, nor that any services or appliances, equipment or facilities are in good working order. All information on the availability or service installations is based on the information supplied by the vendor or lessor. Prospective purchasers should satisfy themselves on such matters prior to the purchase. 4. The photograph/s depicts only certain parts of the property. It should not be assumed that any contents or furnishings, furniture etc in the photograph are included within the sale. It should not be assumed that the property remains as displayed within the photographs. No assumption should be made with regard to parts of the property that have not been photographed. 5. All dimensions, distances and floor areas are approximate. Any plan areas and measurements shown are based upon the Modern Ordnance Survey Group Plans and there may be some discrepancy with the title deeds. The areas are given as a guide only. If such details are fundamental to a purchase, purchasers must rely on their own enquiries. 6. Descriptions of the property are subjective and are used in good faith as an opinion and not a statement of fact. Please make further specific enquiries to ensure that all descriptions are likely to match any expectations you may have of the property. 7. Information on Town and Country Planning matters and Rating matters has been obtained by verbal enquiry only from the appropriate Local Authority. Prospective purchasers are recommended to obtain written verification thereof. October 2025.

Created by CARVE carve-design.co.uk 17/375/3