

22
22

PONCE

DE LEON

2nd 4th & 6th
FLOOR

2222 PONCE DE LEON BLVD.
CORAL GABLES, FL 33134

NEWMARK | **wework**



Enjoy enviable outdoor space and the best of historic Coral Gables at 2222 Ponce de Leon Boulevard.



Built in 1976 and renovated in 2018, 2222 Ponce de Leon Boulevard is a 7-story space of which WeWork occupies the top 6 floors.



Members of this custom-designed WeWork location can enjoy the bespoke terrazzo bar and expansive outdoor terrace.



This dog-friendly space offers a range of member amenities, including impressive event space, convenient on-site bike storage, and car parking with access to car charging stations.



The surrounding neighborhood features lush foliage, delicious dining, and unmissable landmarks, including the Biltmore Hotel and Venetian Pool.



As well as on-site parking, this location offers convenient access to public transportation at nearby Douglas Road and Coconut Grove stations, with Miami International Airport only a 13-minute drive away.

2nd Floor

SUITE: 02-101

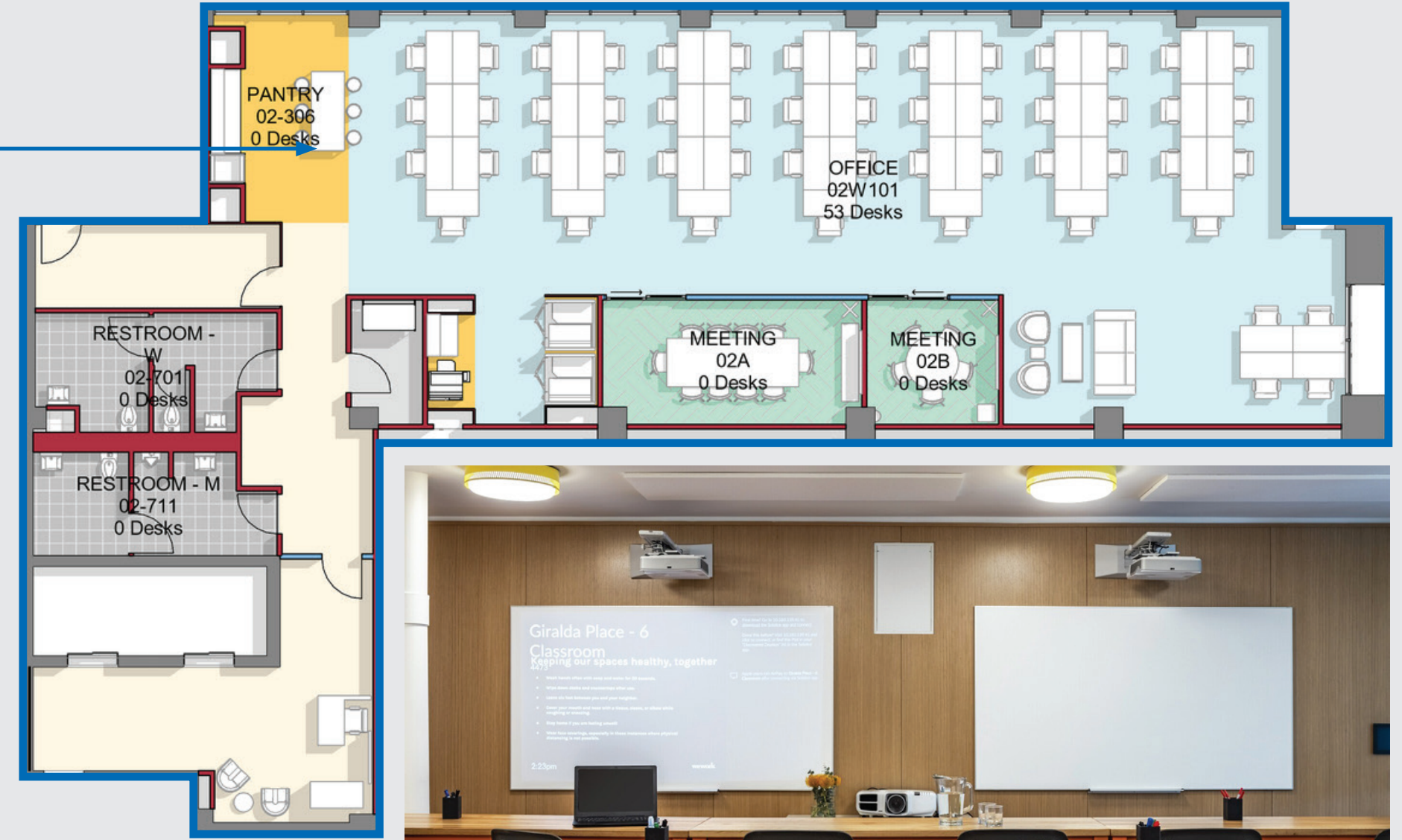

Floor	2
RSF	4,128
Layout	Large Office*
Rental Rate	Negotiable

*Access to additional shared amenities and conference rooms.

4th Floor

SUITE: 04-100



Floor	4
RSF	6,987
Layout	Large Office*
Rental Rate	Negotiable



*Access to additional shared amenities and conference rooms.

6th Floor

SUITE: 06-100



Floor	6
RSF	6,887
Layout	Large Office*
Rental Rate	Negotiable



*Access to additional shared amenities and conference rooms.

2222 PONCE

DE LEON

2nd 4th & 6th

FLOOR

2222 PONCE DE LEON BLVD.
CORAL GABLES, FL 33134

NEWMARK | **wework**

CONTACTS

MATT HIMMELSBACH

Managing Director

t 413-847-6767

Matt.Himmelsbach@nmrk.com

JEREMY HAKALA

Senior Managing Director

t 770-309-1796

Jeremy.Hakala@nmrk.com

BRANDON SHORES

Director

t 321-917-8753

Brandon.Shores@nmrk.com