

FOR LEASE



## 107 S B Street — Suite 200

San Mateo, California | Second Floor Office

<p>AVAILABLE SPACE</p> <p>Rentable Sq Ft <b>±2,311 RSF</b></p>	<p>FLOOR</p> <p>Direct Access <b>Second Floor</b></p>	<p>SPACE TYPE</p> <p>Open + Private <b>Creative Office</b></p>	<p>AVAILABILITY</p> <p>Move-in Ready <b>Immediate</b></p>
--	---	--	---

### PROPERTY OVERVIEW

Suite 200 at 107 S B Street offers ±2,311 rentable square feet of contemporary second-floor office space in the heart of downtown San Mateo. The suite features an open-plan work area, two private offices, a server/storage room, and a striking exposed-brick wall that runs the full length of the space — creating a distinctive creative environment while retaining a clean, professional finish with new LVT flooring throughout.

The building is ideally situated just steps from the Caltrain station and the amenities of B Street and Third Avenue, providing excellent accessibility for both employees and clients throughout the Bay Area. The building is immediately adjacent to the City of San Mateo 4-story public parking garage.

### SPACE HIGHLIGHTS

- New luxury vinyl tile (LVT) flooring throughout
- Two private offices + dedicated server/IT room
- Flexible open office layout — configure to your needs
- Exposed brick accent wall — full length of suite
- Abundant natural light with street-facing windows
- Steps to Caltrain, restaurants, and downtown San Mateo



**Marty Smith**  
President



t: 650-269-8117 | e: [msmith@westvalecre.com](mailto:msmith@westvalecre.com)  
San Francisco, California  
License #00820806



Open Office Area — Exposed Brick Wall and High Ceilings



Brick Wall Elevation — Natural Light Windows



Open Floor Plan — Multiple Configuration Options

**SUITE DETAILS**

<b>Address:</b>	107 S B Street, Suite 200, San Mateo, CA 9440	<b>Available Area:</b>	±2,311 Rentable Square Feet
<b>Floor:</b>	Second Floor	<b>Space Type:</b>	Creative / Professional Office
<b>Asking Rate:</b>	\$3.75 psf per month	<b>Lease Type:</b>	Full Service Gross
<b>Term:</b>	Negotiable	<b>Parking:</b>	Street and next door public garage
<b>Utilities:</b>	Not included in lease rate	<b>Availability:</b>	Immediately Available

**SUITE 200 — FLOOR PLAN (±2,311 RSF)**

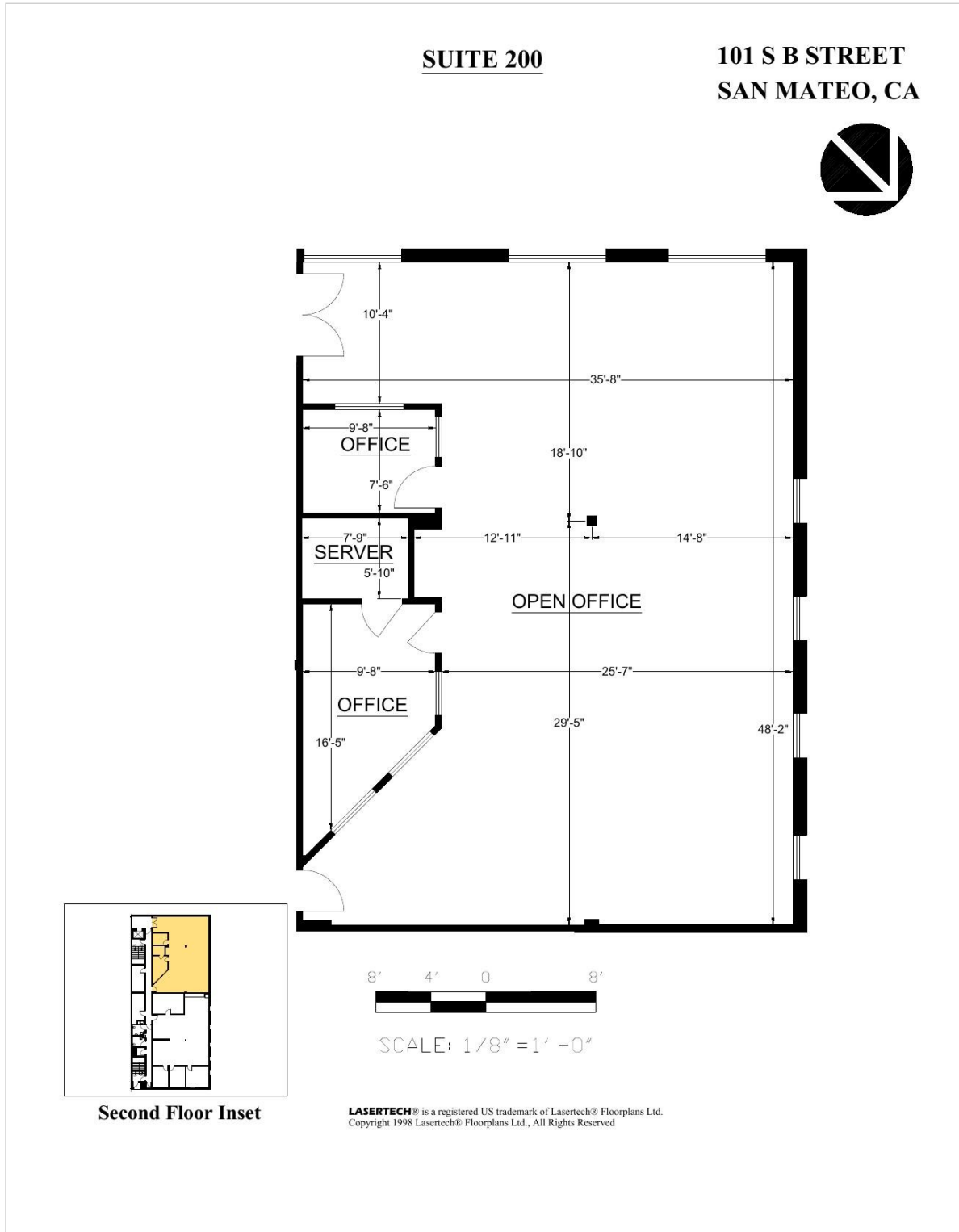

**CONTACT LEASING AGENT**

**Marty Smith, Principal**

Westvale Commercial Real Estate, Inc. | [msmith@westvalecre.com](mailto:msmith@westvalecre.com) | (650) 269-8117

**DOWNTOWN SAN MATEO — LOCATION OVERVIEW**

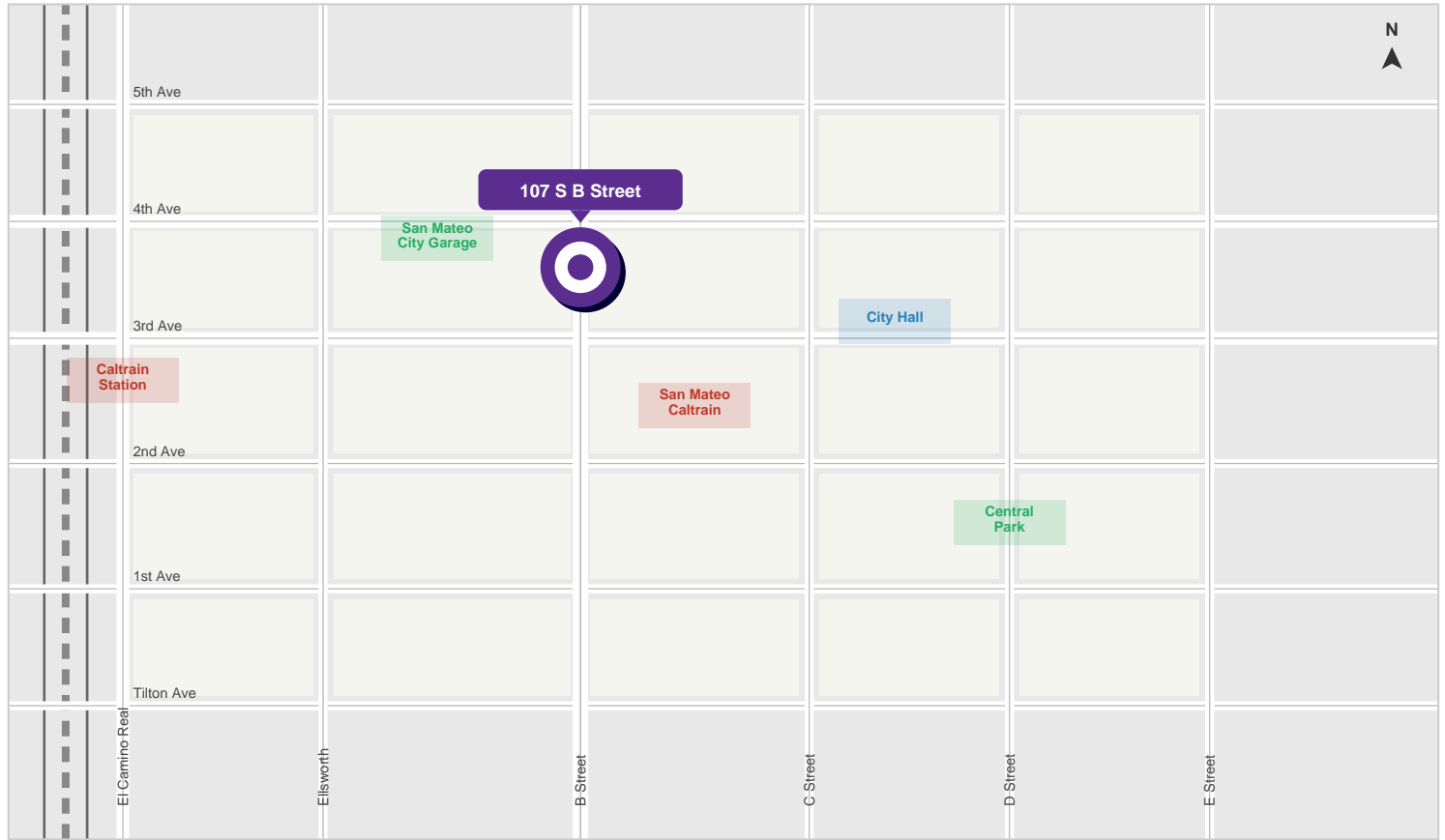

**LOCATION HIGHLIGHTS**

**TRANSIT**

- Caltrain — 2 min walk
- SamTrans Bus Lines — steps away
- Easy Highway 101 access
- SFO Airport — 12 min drive

**DINING & RETAIL**

- 3rd Avenue dining corridor
- B Street restaurants & cafes
- Downtown San Mateo retail
- Weekly Farmers Market nearby

**AMENITIES**

- City of San Mateo public garage
- Central Park — 5 min walk
- Multiple hotels nearby
- Financial district services

All information contained in this brochure is provided without any representation or warranty, express or implied, as to its accuracy or completeness. Interested parties must conduct their own independent investigation, review, and verification of all facts and figures.