

Light Industrial/Flex Space | For Lease

Woodlake Business Park

251 Lathrop Way | Sacramento, CA 95815



Property Features

- Total Available: ±8,100 SF
- Office: ±6,100 SF
- Warehouse: ±2,000 SF
- GL Door: One (1)
- Light Industrial/Flex space
- Abundant, on-site parking adjacent to building entrances
- Minutes to Sacramento's Central Business District and Midtown Submarket
- Proximity to over 30 restaurants and 2.8M SF of retail shopping
- Bike to work using the American River Parkway

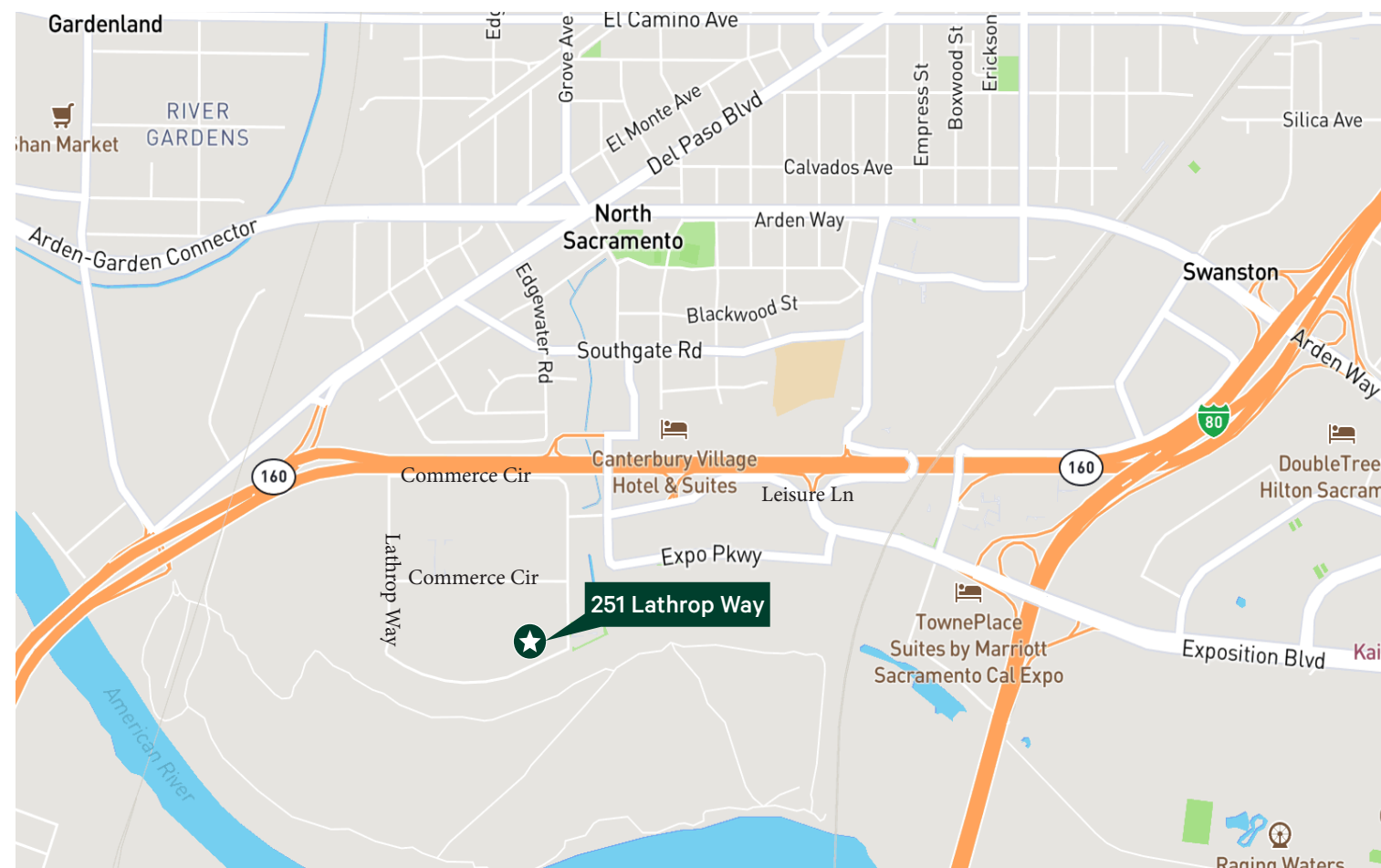

Floor Plan

Suite E & D ±8,100 SF

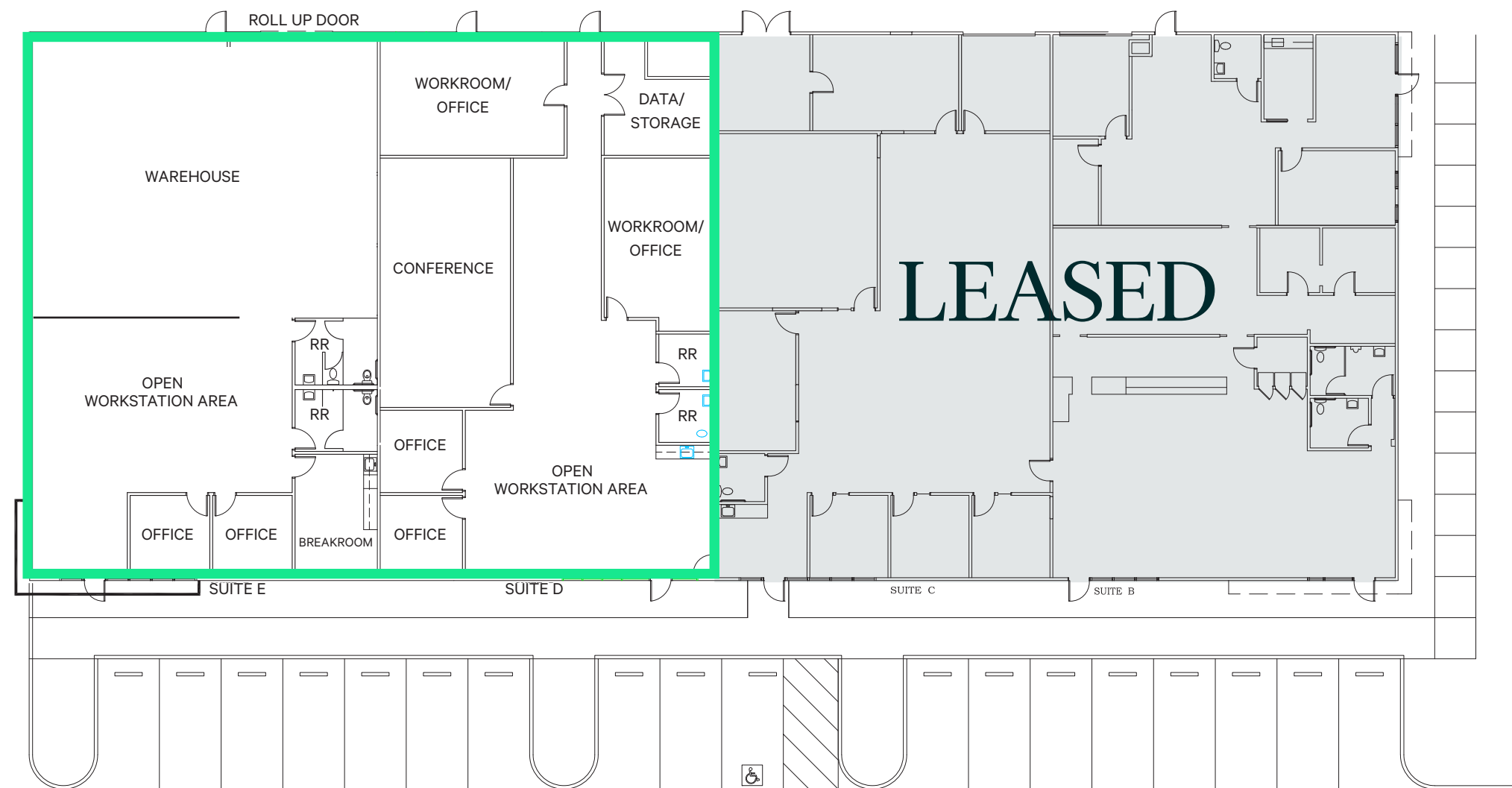

FLOOR PLANS ARE NOT TO SCALE ALL DIMENSIONS ARE APPROXIMATE.

Woodlake Business Park

251 Lathrop Way, Suite D & E | Sacramento, CA 95815

Contact Us:

Todd Sanfilippo, SIOR

Executive Vice President

+1 916 847 3206

todd.sanfilippo@cbre.com

Lic. 01045162

Matt Susac

First Vice President

+1 916 781 4832

matt.susac@cbre.com

Lic. 01979110

Walter Smyth

Senior Vice President

+1 916 781 4843

walter.smyth@cbre.com

Lic. 00956946

Tony Whittaker

Senior Vice President

+1 916 492 6914

tony.whittaker@cbre.com

Lic. 01780828